

A1 SIZE 594mm x 841mm

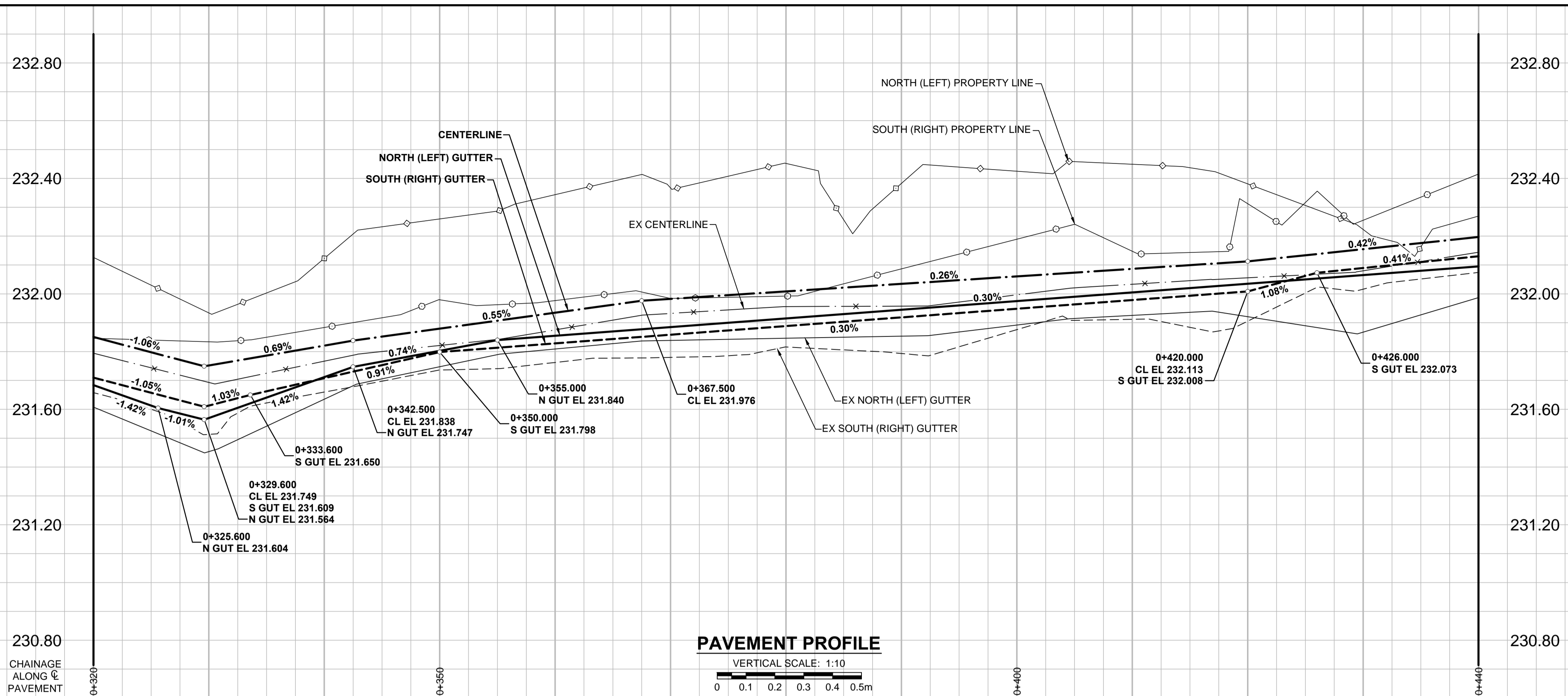

PAVEMENT PROFILE

VERTICAL SCALE: 1:10

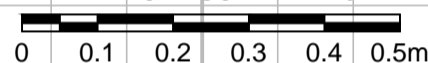

FILE NAME: W150003-Hawkins-PP-03.dwg, Saved By: diane

PLOT: 4/29/2015 6:07:49 PM

HAWKINS CRESCENT (N LEG)

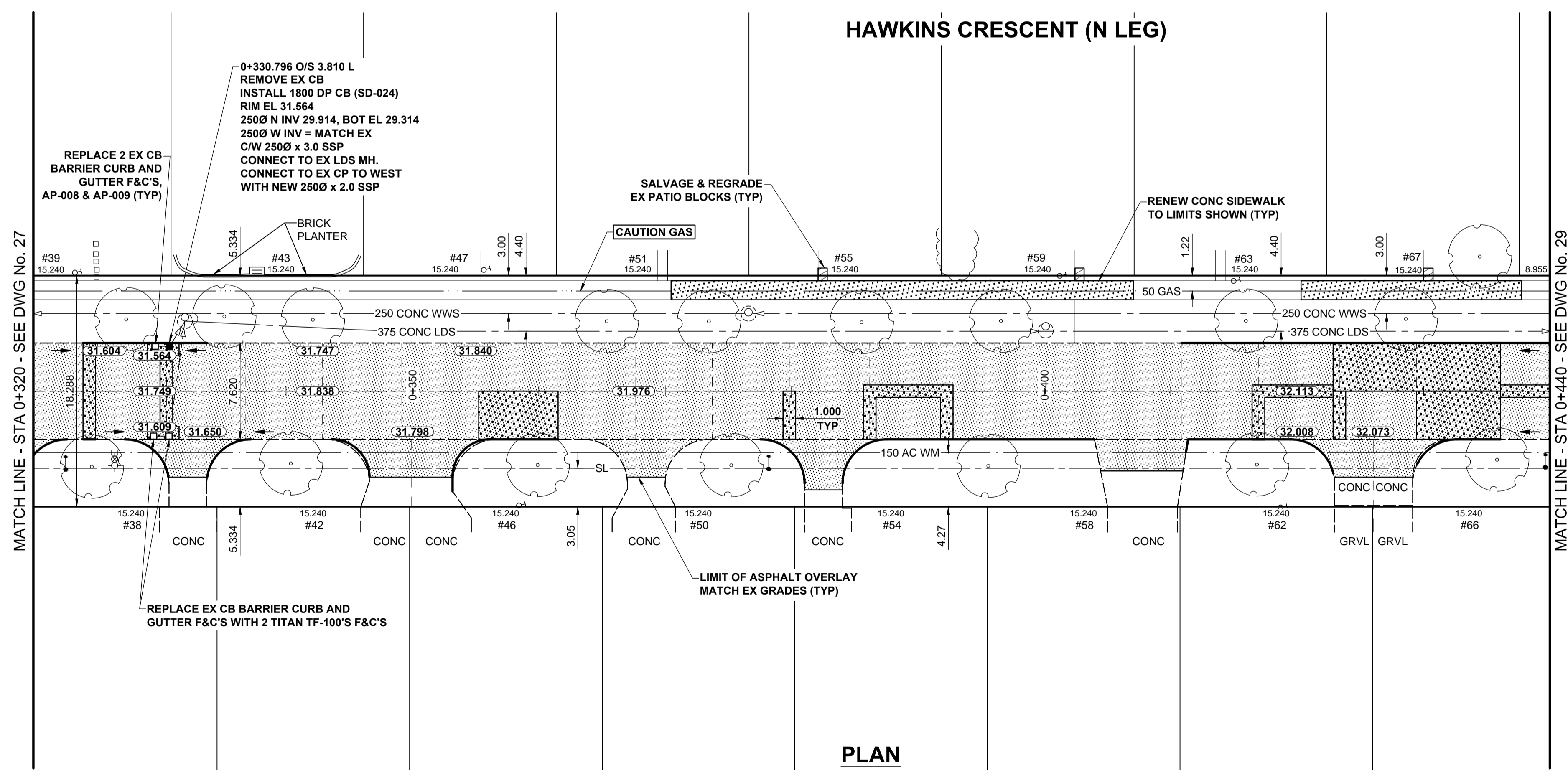
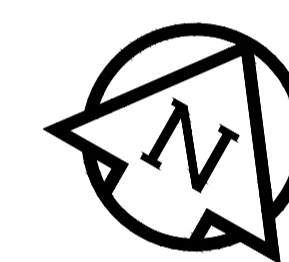

PLAN

SCALE: 1:250

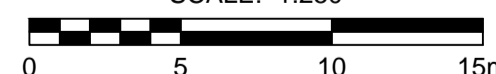

NOTES

- ADJUST MH AND CB RIMS TO NEW GRADES.
- LAMP STANDARDS, HYDRO POLES, AND ANCHORS THAT REQUIRE TEMPORARY SUPPORT, REMOVAL OR REPLACEMENT, TO BE DONE SO AT THE EXPENSE OF THE CONTRACTOR AS NECESSARY.
- CONTRACTOR TO REGRADE/RENEW EXISTING PRIVATE SIDEWALKS TO LIMITS AS SHOWN. SIDEWALKS TO BE RENEWED WITH CONCRETE UNLESS NOTED OTHERWISE.
- CONTRACTOR TO TAKE PRECAUTIONARY STEPS TO PROTECT EXISTING TREES WITHIN THE LIMITS OF CONSTRUCTION FROM DAMAGE FROM CONSTRUCTION ACTIVITIES AS OUTLINED IN THE SPECIFICATIONS.
- CONTRACTOR TO CONFIRM THE LOCATION OF ALL UTILITIES/SERVICES IN THE FIELD PRIOR TO CONSTRUCTION.
- MODIFIED BARRIER CURB TO BE USED AT ALL INTERSECTION RADII, BACK LANE RADII AND BULLNOSES.
- CONTRACTOR TO OVERLAY DRIVEWAYS TO ENSURE POSITIVE DRAINAGE TO NEW STREET GRADES. FINAL LIMITS TO BE DETERMINED IN THE FIELD BY CONTRACT ADMINISTRATOR.
- CB SD-023 & SD-024 OFFSETS ARE DIMENSIONED TO BOC. CB SD-025 OFFSETS ARE DIMENSIONED O/C.
- REFER TO BID OPPORTUNITY FOR DETAILS REGARDING TRAFFIC MANAGEMENT.
- ADD 200.000m TO ABBREVIATED ELEVATIONS TO OBTAIN GEODETIC ELEVATIONS.

CONTROL LINE - COORDINATES

NAME	NORTHING	EASTING
POT 0+100.000	9831.255	9684.671
PC 0+453.715	10006.067	9992.169

METRIC

WHOLE NUMBERS INDICATE MILLIMETRES
DECIMALIZED NUMBERS INDICATE METRES

EXISTING	LEGEND - PLAN	NEW	EXISTING	LEGEND - PLAN	NEW	EXISTING	LEGEND - PLAN	NEW	
	GAS		MANHOLE		CONCRETE PAVEMENT		LOCATION APPROVED		GAS
	MTS		CATCH BASIN / CATCH PIT		CONC SIDEWALK / MEDIAN		SUPR. U/G STRUCTURES		HYDRO
	CATV / FIBRE OPTIC		CURB INLET WITH BOX		ASPHALT PAVEMENT		DATE COMMITTEE		TRAFFIC SIGNALS / PIT
	LAND DRAINAGE SEWER		TREE		PAVING STONE		NOTE:		LAND DRAINAGE SEWER
	SANITARY/COMBINED SEWER		TEST HOLE		GRAVEL		LOCATION APPROVED		SANITARY/COMBINED SEWER
	SEWER SERV/DRAINAGE CONN		PROPERTY LINE		RAMP CURB		LOCATION APPROVED		SEWER SERV/DRAINAGE CONN
	WATERMAIN		SURVEY BAR		PLANING / REMOVAL		LOCATION APPROVED		WATERMAIN
	SUBDRAIN		FENCE		LOCATION APPROVED		LOCATION APPROVED		SUBDRAIN
	DITCH		BOC / EDGE OF PAVEMENT		LOCATION APPROVED		LOCATION APPROVED		DITCH
	ELEVATION		ELEVATION		LOCATION APPROVED		LOCATION APPROVED		ELEVATION
	TRAFFIC SIGN		TRAFFIC SIGN		LOCATION APPROVED		LOCATION APPROVED		TRAFFIC SIGN

No.	REVISIONS	DATE	BY
B	ISSUED FOR TENDER	15/04/30	RPB
A	ISSUED FOR CITY REVIEW	15/04/28	RPB
No.	REVISIONS	YYMMDD	BY

DESIGNED BY	WRJ	CHECKED BY	RPB
DRAWN BY	DML	APPROVED BY	BWB
HOR. SCALE	1:250	RELEASED FOR CONSTRUCTION	
VERT. SCALE	1:10	DATE	15/04/28

PROFESSIONAL'S SEAL
PROVINCE OF MANITOBA
REGISTERED PROFESSIONAL ENGINEER
R.P. BRUCE

THE CITY OF WINNIPEG
PUBLIC WORKS DEPARTMENT
ENGINEERING DIVISION
2015 LOCAL STREET & ALLEY RENEWAL PROGRAM
HAWKINS CRESCENT
DAKOTA ST TO NOVAVISTA DR
REHABILITATION
HORIZONTAL AND VERTICAL ALIGNMENT
STA 0+320 TO STA 0+440

CITY DRAWING NUMBER: N/A
SHEET 28 OF 31
DRAWING No. 28
REV B

BID OPPORTUNITY No. 18-2015

APEGM
Certificate of Authorization
MORRISON HERSHFELD
No. 1736