

A1 SIZE 594mm x 841mm
PLOT: 4/29/2015 6:08:34 PM
FILE NAME: W150003-Hawkins-PP-04.dwg, Saved By: diane

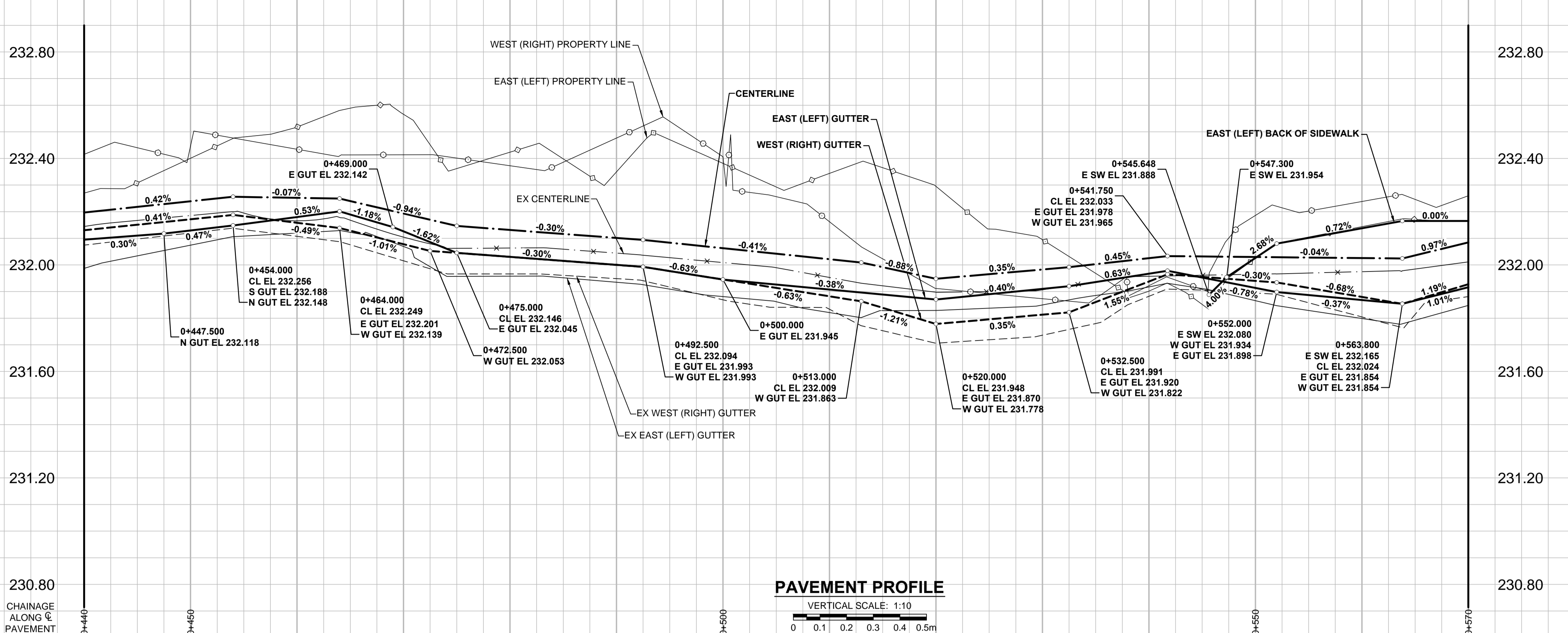

- NOTES**
- ADJUST MH AND CB RIMS TO NEW GRADES.
 - LAMP STANDARDS, HYDRO POLES, AND ANCHORS THAT REQUIRE TEMPORARY SUPPORT, REMOVAL OR REPLACEMENT, TO BE DONE SO AT THE EXPENSE OF THE CONTRACTOR AS NECESSARY.
 - CONTRACTOR TO REGRADE/RENEW EXISTING PRIVATE SIDEWALKS TO LIMITS AS SHOWN. SIDEWALKS TO BE RENEWED WITH CONCRETE UNLESS NOTED OTHERWISE.
 - CONTRACTOR TO TAKE PRECAUTIONARY STEPS TO PROTECT EXISTING TREES WITHIN THE LIMITS OF CONSTRUCTION FROM DAMAGE FROM CONSTRUCTION ACTIVITIES AS OUTLINED IN THE SPECIFICATIONS.
 - CONTRACTOR TO CONFIRM THE LOCATION OF ALL UTILITIES/SERVICES IN THE FIELD PRIOR TO CONSTRUCTION.
 - MODIFIED BARRIER CURB TO BE USED AT ALL INTERSECTION RADII, BACK LANE RADII AND BULLNOSES.
 - CONTRACTOR TO OVERLAY DRIVEWAYS TO ENSURE POSITIVE DRAINAGE TO NEW STREET GRADES. FINAL LIMITS TO BE DETERMINED IN THE FIELD BY CONTRACT ADMINISTRATOR.
 - CB SD-023 & SD-024 OFFSETS ARE DIMENSIONED TO BOC. CB SD-025 OFFSETS ARE DIMENSIONED O.C.
 - REFER TO BID OPPORTUNITY FOR DETAILS REGARDING TRAFFIC MANAGEMENT.
 - ADD 200.000m TO ABBREVIATED ELEVATIONS TO OBTAIN GEODETIC ELEVATIONS.

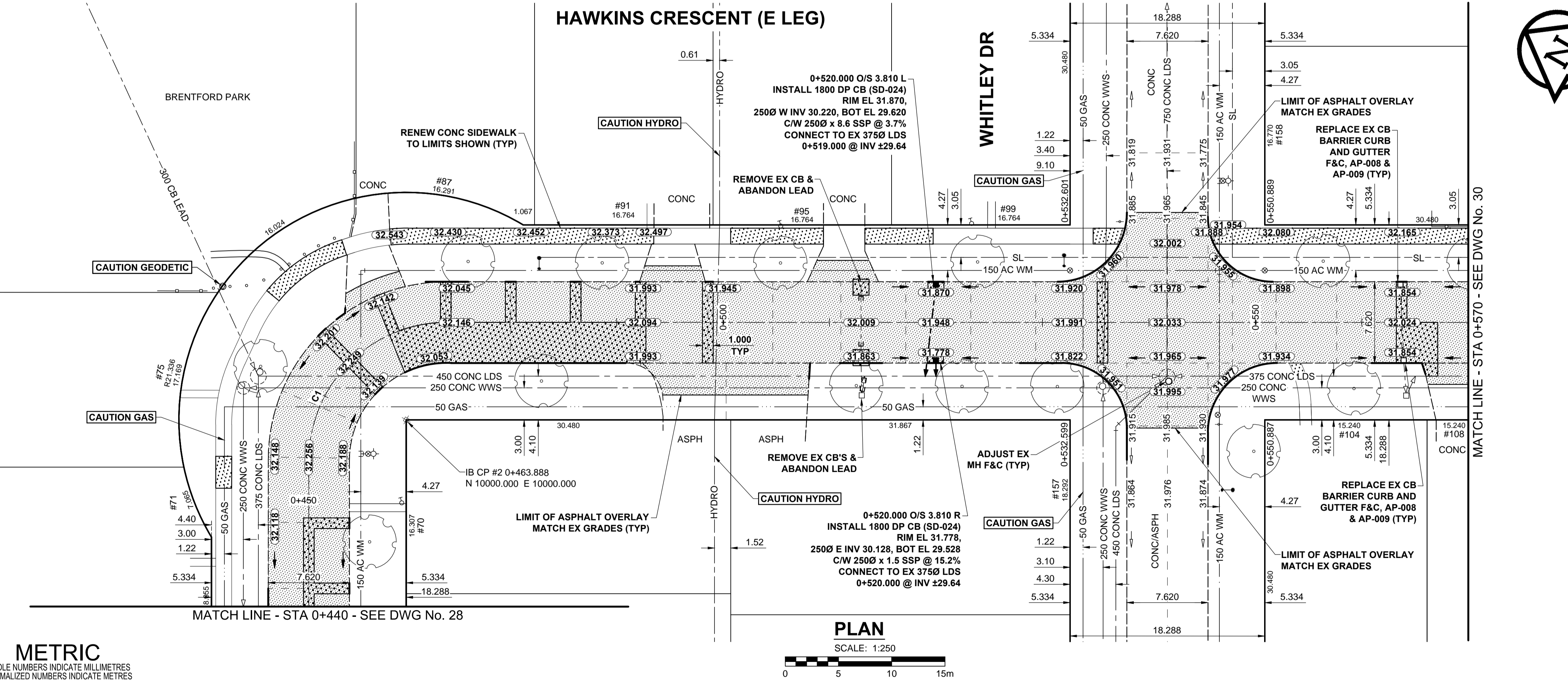

CONTROL LINE - COORDINATES		
NAME	NORTHING	EASTING
POT 0+100.000	9831.257	9684.671
PC 0+453.715	10006.067	9992.169
PT 0+474.062	10001.209	10009.832
POT 0+780.000	9735.262	10161.064

CONTROL LINE - CURVES				
CURVE	RADIUS	LENGTH	DELTA	TANGENT
C1	12.954	20.347	89°59'35"	12.952

METRIC
WHOLE NUMBERS INDICATE MILLIMETRES
DECIMALIZED NUMBERS INDICATE METRES

EXISTING	LEGEND - PLAN	NEW	EXISTING	LEGEND - PLAN	NEW	EXISTING	LEGEND - PLAN	NEW	
	GAS		MANHOLE		CONCRETE PAVEMENT		LOCATION APPROVED		GAS
	MTS		CATCH BASIN / CATCH PIT		CONC SIDEWALK / MEDIAN		UNDERGROUND STRUCTURES		HYDRO
	HYDRO		CURB INLET WITH BOX		ASPHALT PAVEMENT		DATE		CATV / FIBRE OPTIC
	CATV / FIBRE OPTIC		TREE		PAVING STONE		NOTE:		TRAFFIC SIGNALS / PIT
	TRAFFIC SIGNALS / PIT		TEST HOLE		GRAVEL		LOCATION APPROVED		LAND DRAINAGE SEWER
	LAND DRAINAGE SEWER		PROPERTY LINE		RAMP CURB		LOCATION APPROVED		SANITARY/COMBINED SEWER
	SANITARY/COMBINED SEWER		SURVEY BAR		PLANING / REMOVAL		LOCATION APPROVED		SEWER SERV/DRAINAGE CONN
	SEWER SERV/DRAINAGE CONN		FENCE		LOCATION APPROVED		LOCATION APPROVED		WATERMAIN
	WATERMAIN		BOC / EDGE OF PAVEMENT		LOCATION APPROVED		LOCATION APPROVED		SUBDRAIN
	SUBDRAIN		ELEVATION		LOCATION APPROVED		LOCATION APPROVED		DITCH
	DITCH		TRAFFIC SIGN		LOCATION APPROVED		LOCATION APPROVED		EXISTING

GBM 62-024	15/04/30	RPB
ELEV 232.503	15/04/28	RPB
No. REVISIONS	YYMMDDI	BY

DESIGNED BY	WRJ
CHECKED BY	RPB
DRAWN BY	DML
APPROVED BY	BWB
HOR. SCALE	1:250
VERT. SCALE	1:10
DATE	15/04/28

PROFESSIONAL'S SEAL
PROVINCE OF MANITOBA
REGISTERED PROFESSIONAL ENGINEER
R.P. BRUCE
CONSULTANT DRAWING No. W150003-Hawkins-PP-04.dwg

THE CITY OF WINNIPEG
PUBLIC WORKS DEPARTMENT
ENGINEERING DIVISION

2015 LOCAL STREET & ALLEY RENEWAL PROGRAM
HAWKINS CRESCENT
DAKOTA ST TO NOVAVISTA DR
REHABILITATION
HORIZONTAL AND VERTICAL ALIGNMENT
STA 0+440 TO STA 0+570

CITY DRAWING NUMBER	N/A
SHEET	29 OF 31
DRAWING No.	29
REV	B

Certificate of Authorization
MORRISON HERSHFELD
No. 1736
BID OPPORTUNITY No. 18-2015