

A1 SIZE 594mm x 841mm

PLOT: 3/31/2015 11:38:18 AM

FILE NAME: W150004-McLeod-PP-06.dwg Saved By: diane

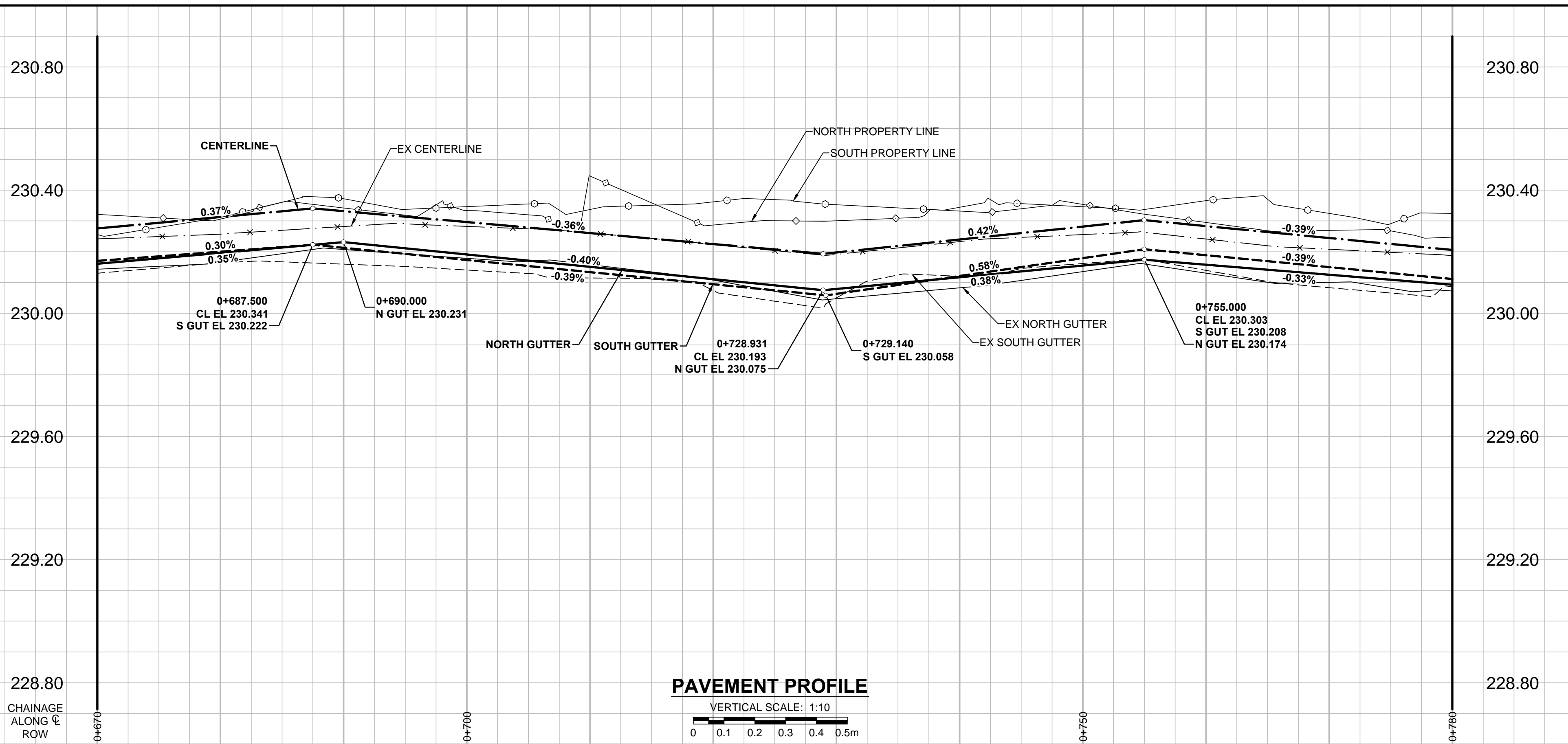

PAVEMENT PROFILE
VERTICAL SCALE: 1:10

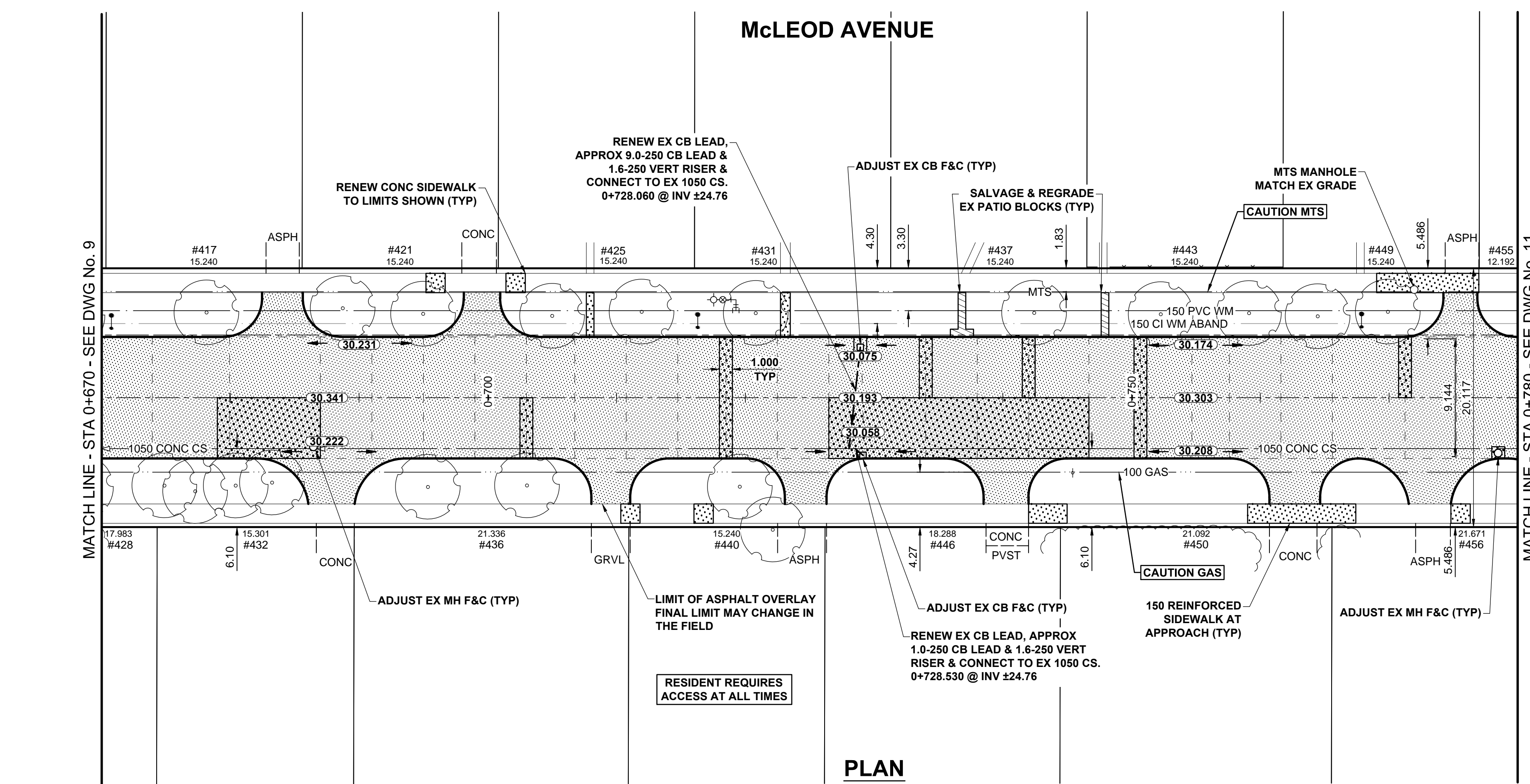

PLAN
SCALE: 1:250

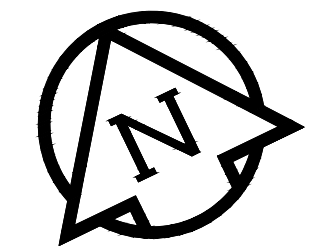

- NOTES**
- ADJUST MH AND CB RIMS TO NEW GRADES.
 - LAMP STANDARDS, HYDRO POLES, AND ANCHORS THAT REQUIRE TEMPORARY SUPPORT, REMOVAL OR REPLACEMENT, TO BE DONE SO AT THE EXPENSE OF THE CONTRACTOR AS NECESSARY.
 - CONTRACTOR TO REGRADE/RENEW EXISTING PRIVATE SIDEWALKS TO LIMITS AS SHOWN. SIDEWALKS TO BE RENEWED WITH CONCRETE UNLESS NOTED OTHERWISE.
 - CONTRACTOR TO TAKE PRECAUTIONARY STEPS TO PROTECT EXISTING TREES WITHIN THE LIMITS OF CONSTRUCTION FROM DAMAGE FROM CONSTRUCTION ACTIVITIES AS OUTLINED IN THE SPECIFICATIONS.
 - CONTRACTOR TO CONFIRM THE LOCATION OF ALL UTILITIES/SERVICES IN THE FIELD PRIOR TO CONSTRUCTION.
 - MODIFIED BARRIER CURB TO BE USED AT ALL INTERSECTION RADII, BACK LANE RADII AND BULLNOSES.
 - CONTRACTOR TO OVERLAY DRIVEWAYS TO ENSURE POSITIVE DRAINAGE TO NEW STREET GRADES. FINAL LIMITS TO BE DETERMINED IN THE FIELD BY CONTRACT ADMINISTRATOR.
 - CB SD-023 & SD-024 OFFSETS ARE DIMENSIONED TO BOC. CB SD-025 OFFSETS ARE DIMENSIONED O/C.
 - ADD 200.000m TO ABBREVIATED ELEVATIONS TO OBTAIN GEODETIC ELEVATIONS.
 - REFER TO BID OPPORTUNITY FOR DETAILS REGARDING TRAFFIC MANAGEMENT.

METRIC
WHOLE NUMBERS INDICATE MILLIMETRES
DECIMALIZED NUMBERS INDICATE METRES

---	GAS	○	MANHOLE	●	CONCRETE PAVEMENT	---	LOCATION APPROVED
---	MTS	□	CATCH BASIN / CATCH PIT	■	CONC SIDEWALK / MEDIAN	---	UNDERGROUND STRUCTURES
---	HYDRO	△	CURB INLET WITH BOX	▲	ASPHALT PAVEMENT	---	DATE
---	CATV / FIBRE OPTIC	○	TREE	○	PAVING STONE	---	COMMITTEE
---	TRAFFIC SIGNALS / PIT	○	TEST HOLE	○	GRAVEL	---	NOTE:
---	LAND DRAINAGE SEWER	---	PROPERTY LINE	---	RAMP CURB	---	LOCATION OF UNDERGROUND STRUCTURES
---	SANITARY/COMBINED SEWER	---	SURVEY BAR	---	PLANING / REMOVAL	---	AS SHOWN ARE BASED ON THE BEST
---	SEWER SERV/DRAINAGE CONN	---	FENCE	---	---	---	INFORMATION AVAILABLE. BUT NO
---	WATERMAIN	---	BOC / EDGE OF PAVEMENT	---	---	---	GUARANTEE IS GIVEN THAT ALL EXISTING
---	SUBDRAIN	---	ELEVATION	---	---	---	UTILITIES ARE SHOWN OR THAT THE GIVEN
---	DITCH	---	TRAFFIC SIGN	---	---	---	LOCATIONS ARE EXACT. CONFIRMATION OF
---	EXISTING	---	---	---	---	---	EXISTENCE AND EXACT LOCATION OF ALL
---	LEGEND - PLAN	---	---	---	---	---	SERVICES MUST BE OBTAINED FROM THE
---	NEW	---	---	---	---	---	INDIVIDUAL UTILITIES BEFORE PROCEEDING
---	---	---	---	---	---	---	WITH CONSTRUCTION.
---	---	---	---	---	---	---	---

GBM 12-038	S/W. Cor. Melness Bay & McLeod Ave. 75m on top of 300m dia. x 2.4 m dia.
ELEV 230.273	306.03 m N. of N. end & 107 m E. of E. end of No. 1 Melness Bay, or 6.1 m N.
	of S.L. of McLeod Ave. produced from the E. & 6.6 m E. of W.L. of Railway St.
B	ISSUED FOR TENDER 15/03/16 RPB
A	ISSUED FOR CITY REVIEW 15/03/16 RPB
No.	REVISIONS YYMMDDI BY

MORRISON HERSHFELD

DESIGNED BY RPB CHECKED BY WRJ
DRAWN BY DML APPROVED BY BWB

HOR. SCALE 1:250
VERT. SCALE 1:10

DATE 15/03/16

PROFESSIONAL'S SEAL
PROVINCE OF MANITOBA
REGISTERED PROFESSIONAL ENGINEER
R.P. BRUCE
CONSULTANT DRAWING No. W150004 McLeod-PP-06.dwg

THE CITY OF WINNIPEG
PUBLIC WORKS DEPARTMENT
ENGINEERING DIVISION

2015 LOCAL STREET & ALLEY RENEWAL PROGRAM
McLEOD AVENUE
HENDERSON HWY TO MELNESS BAY
REHABILITATION
HORIZONTAL AND VERTICAL ALIGNMENT
STA 0+670 TO STA 0+780

CITY DRAWING NUMBER N/A
SHEET 10 OF 39
DRAWING No. REV 10 B

BID OPPORTUNITY No. 19-2015