

A1 SIZE 594mm x 841mm

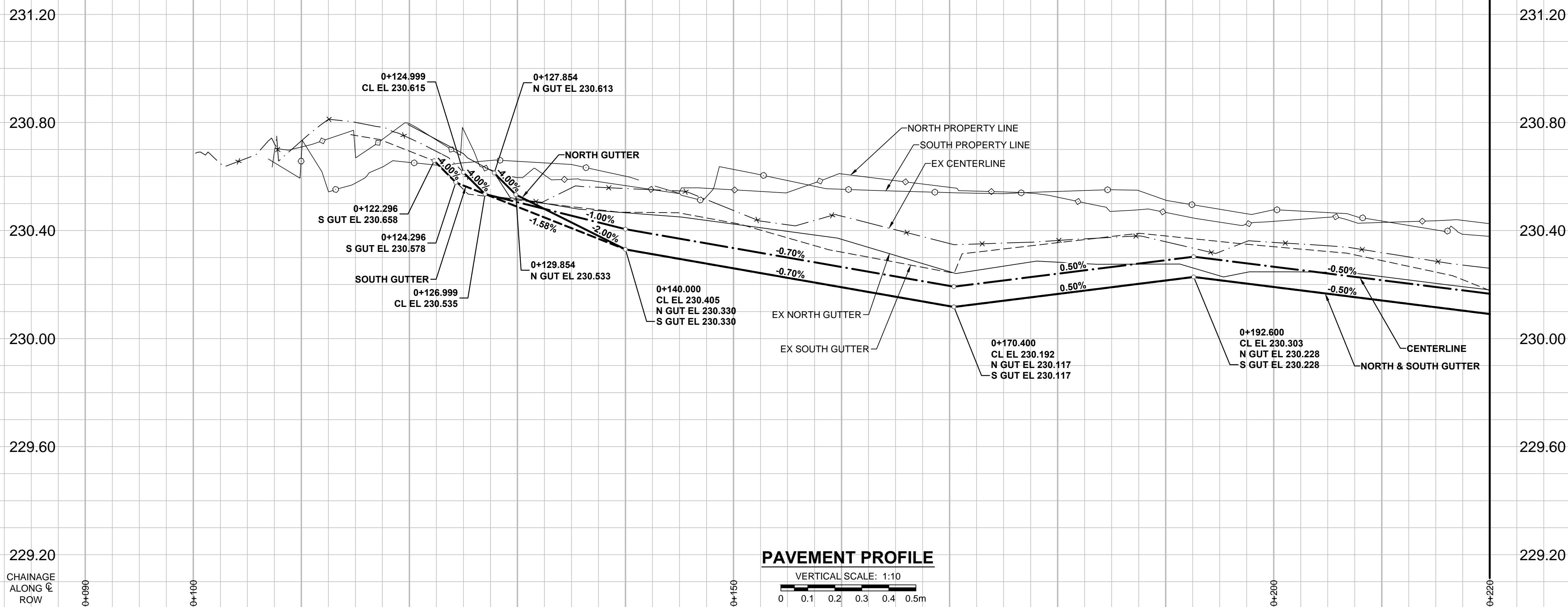

- NOTES**
- ADJUST MH AND CB RIMS TO NEW GRADES.
 - LAMP STANDARDS, HYDRO POLES, AND ANCHORS THAT REQUIRE TEMPORARY SUPPORT, REMOVAL OR REPLACEMENT, TO BE DONE SO AT THE EXPENSE OF THE CONTRACTOR AS NECESSARY.
 - CONTRACTOR TO REGRADE/RENEW EXISTING PRIVATE SIDEWALKS TO LIMITS AS SHOWN. SIDEWALKS TO BE RENEWED WITH CONCRETE UNLESS NOTED OTHERWISE.
 - CONTRACTOR TO TAKE PRECAUTIONARY STEPS TO PROTECT EXISTING TREES WITHIN THE LIMITS OF CONSTRUCTION FROM DAMAGE FROM CONSTRUCTION ACTIVITIES AS OUTLINED IN THE SPECIFICATIONS.
 - CONTRACTOR TO CONFIRM THE LOCATION OF ALL UTILITIES/SERVICES IN THE FIELD PRIOR TO CONSTRUCTION.
 - MODIFIED BARRIER CURB TO BE USED AT ALL INTERSECTION RADII, BACK LANE RADII AND BULLNOSES.
 - CB SD-023 & SD-024 OFFSETS ARE DIMENSIONED TO BOC. CB SD-025 OFFSETS ARE DIMENSIONED O/C.
 - ADD 200.000m TO ABBREVIATED ELEVATIONS TO OBTAIN GEODETIC ELEVATIONS.
 - IN GENERAL, PAVEMENT AND SIDEWALK AREAS TO BE REMOVED. MATCH RECONSTRUCTION LIMITS.
 - REFER TO BID OPPORTUNITY FOR DETAILS REGARDING TRAFFIC MANAGEMENT.

PAVEMENT PROFILE
VERTICAL SCALE: 1:10
0 0.1 0.2 0.3 0.4 0.5m

FILE NAME: W150004-Neil-PP-01.dwg, Saved By: diane

PLOT: 3/31/2015 11:41:30 AM

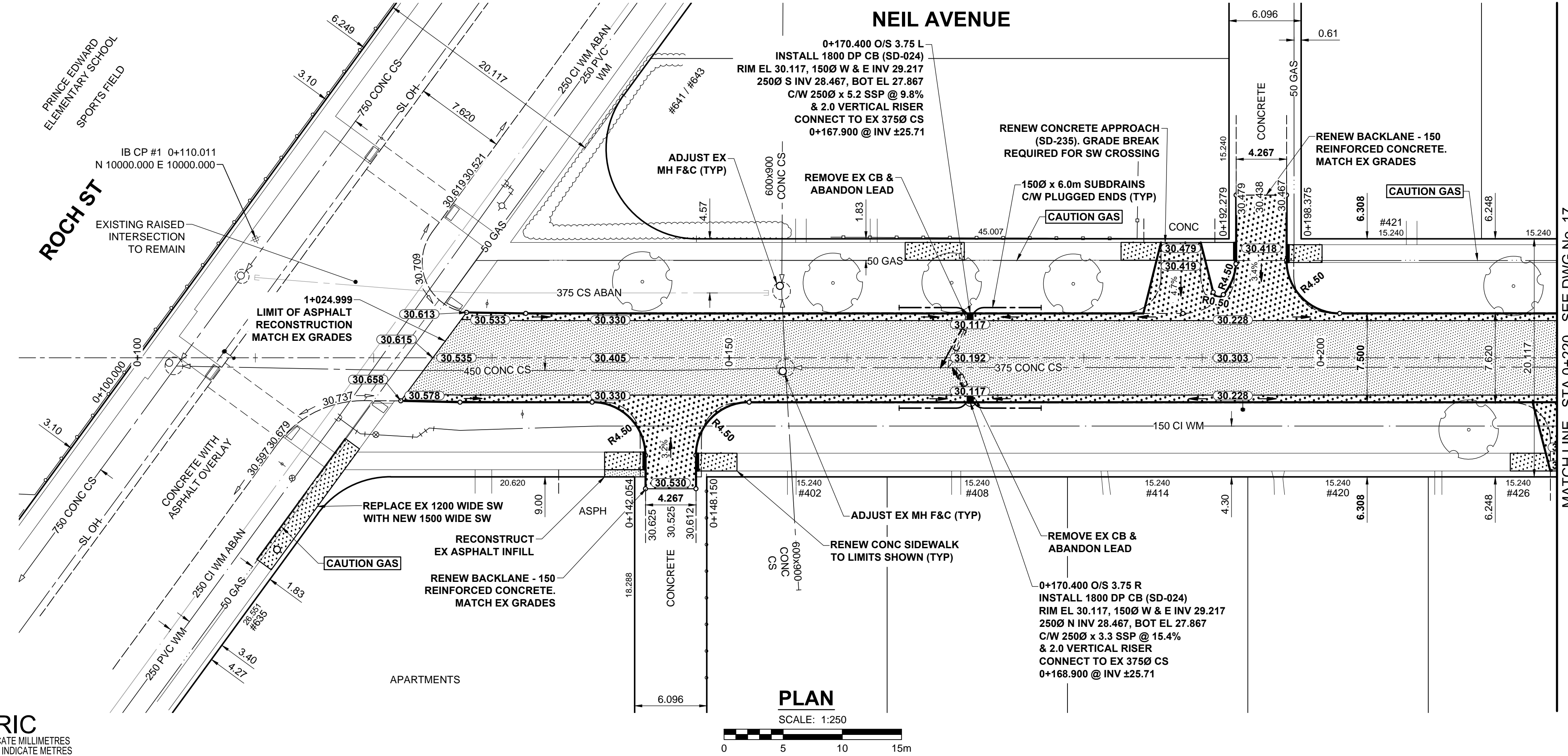

MATCH LINE - STA 0+220 - SEE DWG No. 17

CONTROL LINE - COORDINATES

NAME	NORTHING	EASTING
POT 0+110.000	9990.950	9995.611
POT 0+480.000	9829.864	10328.704

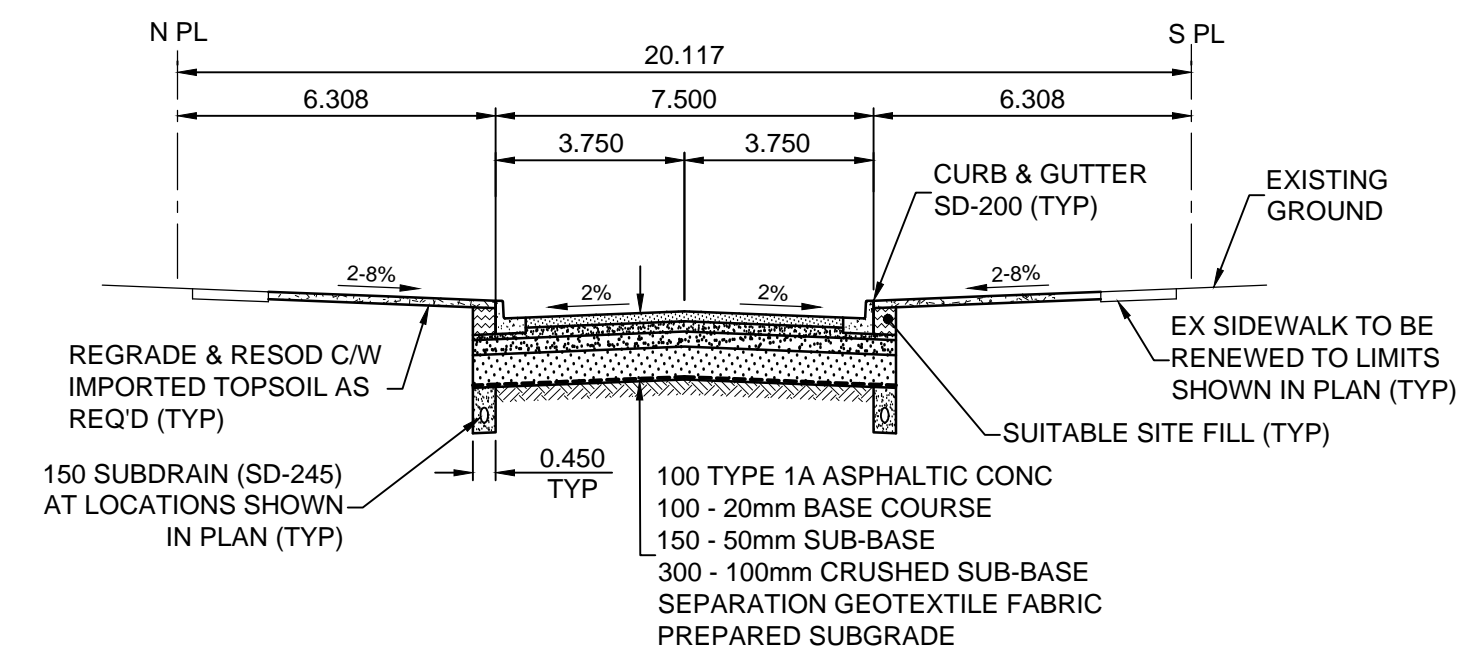

TYPICAL PAVEMENT SECTION
ASPHALT PAVEMENT STRUCTURE
SCALE: NTS

METRIC
WHOLE NUMBERS INDICATE MILLIMETRES
DECIMALIZED NUMBERS INDICATE METRES

PLAN
SCALE: 1:250
0 5 10 15m

EXISTING	LEGEND - PLAN	NEW	EXISTING	LEGEND - PLAN	NEW	EXISTING	LEGEND - PLAN	NEW	
	GAS		MANHOLE		CONCRETE PAVEMENT		LOCATION APPROVED		GAS
	MTS		CATCH BASIN / CATCH PIT		CONC SIDEWALK / MEDIAN		UNDERGROUND STRUCTURES		HYDRO
	CATV / FIBRE OPTIC		CURBINLET WITH BOX		ASPHALT PAVEMENT		SUPR. UG STRUCTURES		TRAFFIC SIGNALS / PIT
	LAND DRAINAGE SEWER		TREE		PAVING STONE		DATE		SANITARY / COMBINED SEWER
	SEWER SERV/DRAINAGE CONN		TEST HOLE		GRAVEL		COMMITTEE		SEWER SERV/DRAINAGE CONN
	WATERMAIN		PROPERTY LINE		RAMP CURBINLET		NOTE:		WATERMAIN
	SUBDRAIN		SURVEY BAR		PLANING / REMOVAL		LOCATION APPROVED		SUBDRAIN
	DITCH		FENCE		LOCATION APPROVED		LOCATION APPROVED		DITCH
	EXISTING		BOC / EDGE OF PAVEMENT		LOCATION APPROVED		LOCATION APPROVED		EXISTING
	LEGEND - PLAN		ELEVATION		LOCATION APPROVED		LOCATION APPROVED		LEGEND - PLAN
	NEW		TRAFFIC SIGN		LOCATION APPROVED		LOCATION APPROVED		NEW

GBM 12-062
ELEV 230.128

N.E. Cor. Watt St. & Kimberly Ave., T44, on top of 0.05 m dia. x 2.4 non pipe, 0.3 m W. of E.L. of Watt St. & on N.E. of Kimberly Ave.

No.	REVISIONS	DATE	BY
B	ISSUED FOR TENDER	15/03/16	RPB
A	ISSUED FOR CITY REVIEW	15/03/16	RPB
		YYMMDD	

MORRISON HERSHFELD

DESIGNED BY	RPB	CHECKED BY	WRJ
DRAWN BY	DML	APPROVED BY	BWB
HOR. SCALE	1:250	RELEASED FOR CONSTRUCTION	
VERT. SCALE	1:10		
DATE	15/03/16	DATE	

PROFESSIONAL'S SEAL
PROVINCE OF MANITOBA
REGISTERED PROFESSIONAL ENGINEER
R.P. BRUCE
CONSULTANT DRAWING No. W150004-Neil-PP-01.dwg

THE CITY OF WINNIPEG
PUBLIC WORKS DEPARTMENT
ENGINEERING DIVISION
2015 LOCAL STREET & ALLEY RENEWAL PROGRAM
NEIL AVENUE
ROCH ST TO WATT ST
ASPHALT RECONSTRUCTION
HORIZONTAL AND VERTICAL ALIGNMENT
STA 0+090 TO STA 0+220

CITY DRAWING NUMBER N/A
SHEET 16 OF 39
DRAWING No. 16
REV B

BID OPPORTUNITY No. 19-2015