

A1 SIZE 594mm x 841mm  
PLOT: 3/31/2015 11:44:30 AM  
FILE NAME: W150004-Reay-PP-03.dwg, Saved By: diane

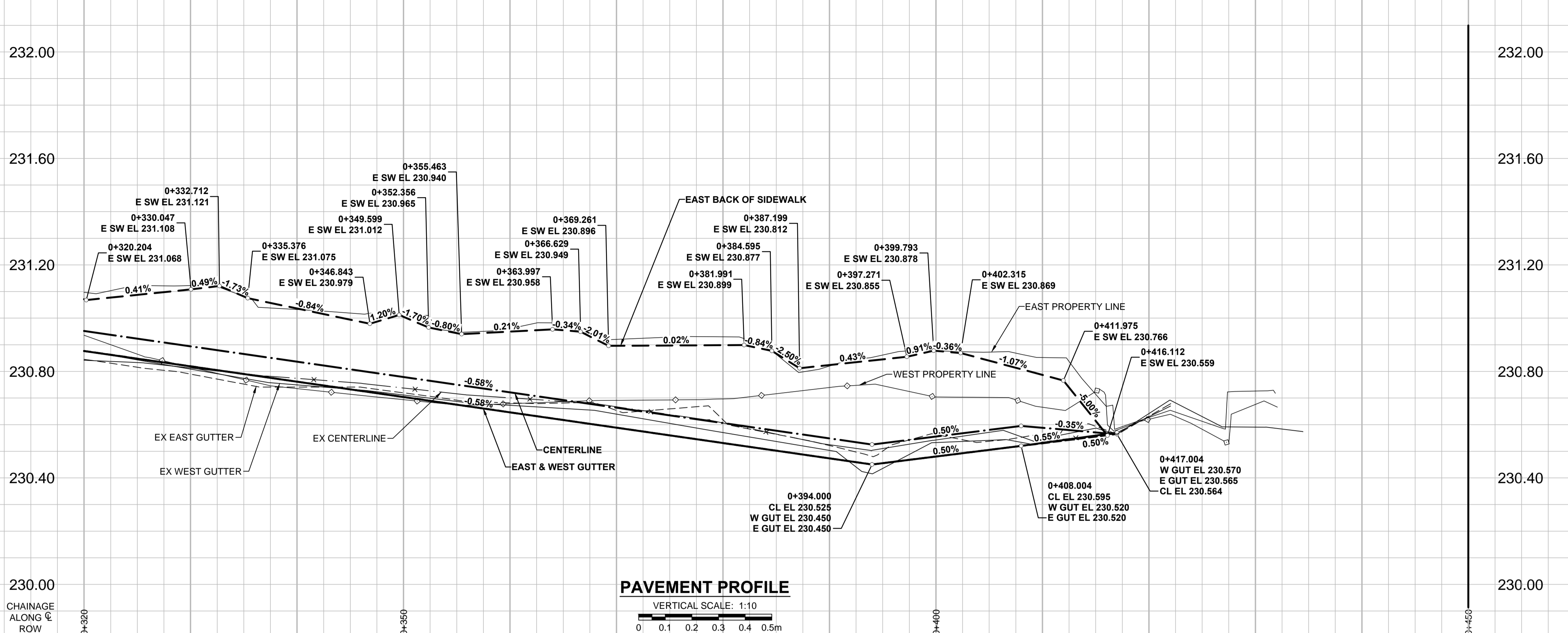

- NOTES**
- ADJUST MH AND CB RIMS TO NEW GRADES.
  - LAMP STANDARDS, HYDRO POLES, AND ANCHORS THAT REQUIRE TEMPORARY SUPPORT, REMOVAL OR REPLACEMENT, TO BE DONE SO AT THE EXPENSE OF THE CONTRACTOR AS NECESSARY.
  - CONTRACTOR TO REGRADE/RENEW EXISTING PRIVATE SIDEWALKS TO LIMITS AS SHOWN. SIDEWALKS TO BE RENEWED WITH CONCRETE UNLESS NOTED OTHERWISE.
  - CONTRACTOR TO TAKE PRECAUTIONARY STEPS TO PROTECT EXISTING TREES WITHIN THE LIMITS OF CONSTRUCTION FROM DAMAGE FROM CONSTRUCTION ACTIVITIES AS OUTLINED IN THE SPECIFICATIONS.
  - CONTRACTOR TO CONFIRM THE LOCATION OF ALL UTILITIES/SERVICES IN THE FIELD PRIOR TO CONSTRUCTION.
  - MODIFIED BARRIER CURB TO BE USED AT ALL INTERSECTION RADII, BACK LANE RADII AND BULLNOSES.
  - IN GENERAL, PAVEMENT AND SIDEWALK AREAS TO BE REMOVED. MATCH RECONSTRUCTION LIMITS.
  - CB SD-023 & SD-024 OFFSETS ARE DIMENSIONED TO BOC. CB SD-025 OFFSETS ARE DIMENSIONED O.C.
  - ADD 200.000m TO ABBREVIATED ELEVATIONS TO OBTAIN GEODETIC ELEVATIONS.
  - REFER TO BID OPPORTUNITY FOR DETAILS REGARDING TRAFFIC MANAGEMENT.

**CONTROL LINE - COORDINATES**

NAME	NORTHING	EASTING
POT 0+090.000	9682.310	10048.205
PC 0+196.660	9785.914	10073.558
PT 0+335.775	9920.508	10055.096
POT 0+440.000	10011.335	10003.978

**CONTROL LINE - CURVES**

CURVE	RADIUS	LENGTH	DELTA	TANGENT
C1	184.846	139.115	43°07'15"	73.038

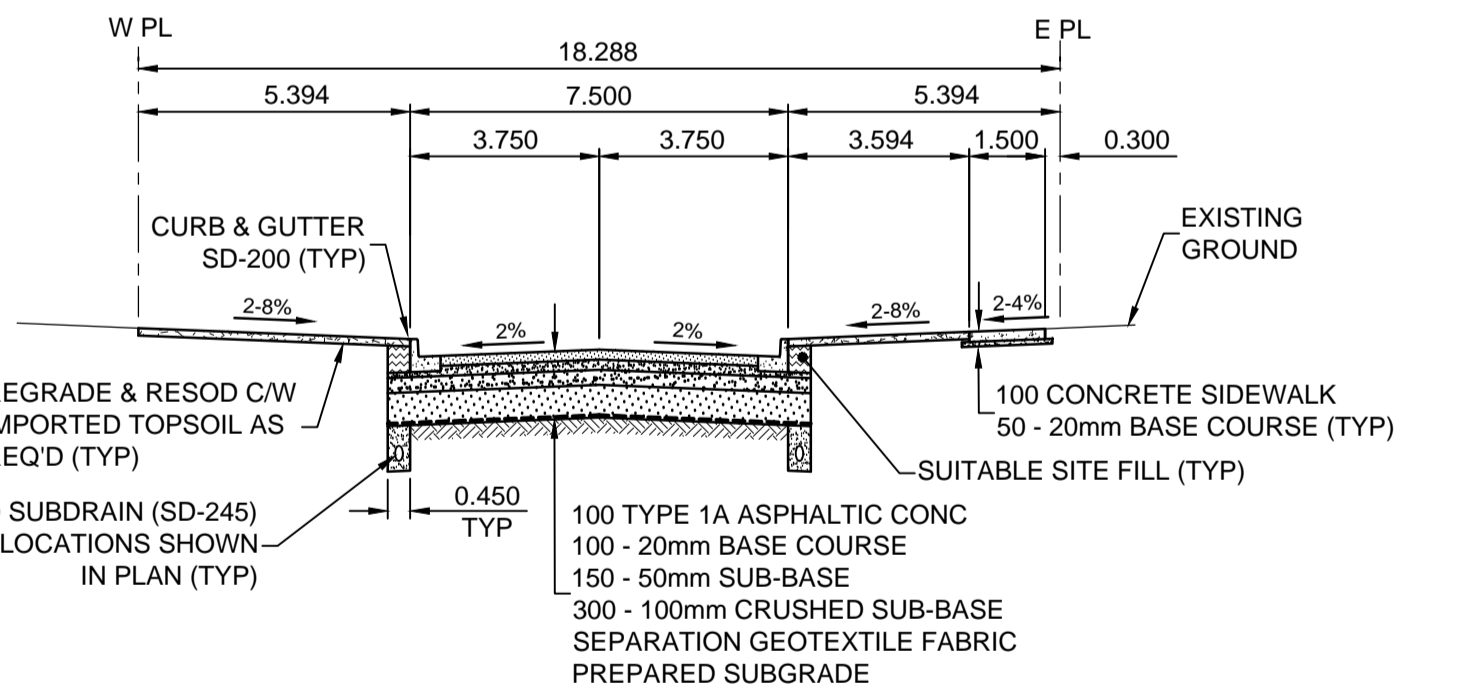
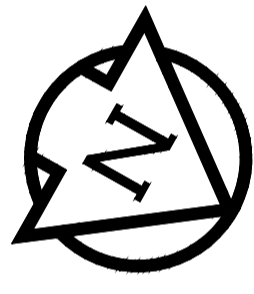
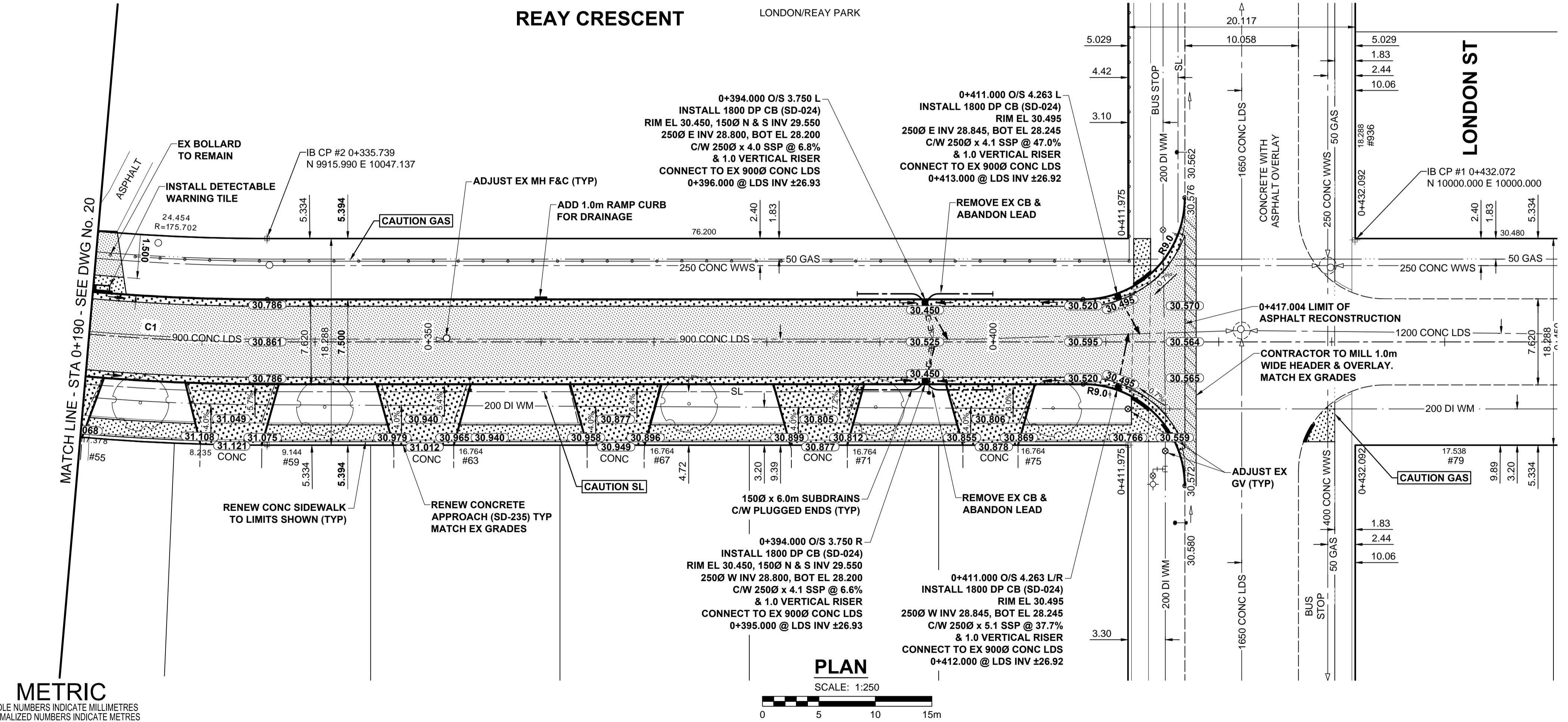

**TYPICAL PAVEMENT SECTION**  
ASPHALT PAVEMENT STRUCTURE  
SCALE: NTS

**METRIC**  
WHOLE NUMBERS INDICATE MILLIMETRES  
DECIMALIZED NUMBERS INDICATE METRES

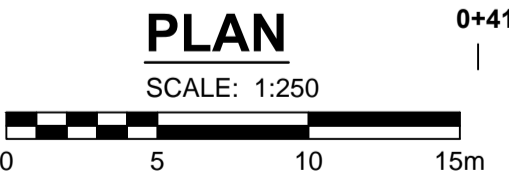

EXISTING	LEGEND - PLAN	NEW	EXISTING	LEGEND - PLAN	NEW	EXISTING	LEGEND - PLAN	NEW	
	GAS		MANHOLE		CONCRETE PAVEMENT		LOCATION APPROVED		UNDERGROUND STRUCTURES
	MTS		CATCH BASIN / CATCH PIT		CONC SIDEWALK / MEDIAN		SUPR. U/G STRUCTURES		DATE
	HYDRO		CURB INLET WITH BOX		ASPHALT PAVEMENT		COMMITTEE		NOTE:
	CATV / FIBRE OPTIC		TREE		PAVING STONE		LOCATION OF UNDERGROUND STRUCTURES		AS SHOWN ARE BASED ON THE BEST INFORMATION AVAILABLE. BUT NO
	TRAFFIC SIGNALS / PIT		TEST HOLE		GRAVEL		GUARANTEE IS GIVEN THAT ALL EXISTING		UTILITIES ARE SHOWN OR THAT THE GIVEN
	LAND DRAINAGE SEWER		PROPERTY LINE		RAMP CURB		LOCATIONS ARE EXACT. CONFIRMATION OF		EXISTENCE AND EXACT LOCATION OF ALL
	SANITARY/COMBINED SEWER		SURVEY BAR		PLANING / REMOVAL		SERVICES MUST BE OBTAINED FROM THE		INDIVIDUAL UTILITIES BEFORE PROCEEDING
	SEWER SERV/DRAINAGE CONN		FENCE		EXISTING		WITH CONSTRUCTION.		ISSUED FOR TENDER
	WATERMAIN		BOC / EDGE OF PAVEMENT		ISSUED FOR CITY REVIEW		REVISIONS		DATE
	SUBDRAIN		ELEVATION		ISSUED FOR TENDER		DATE		SCALE
	DITCH		TRAFFIC SIGN		ISSUED FOR TENDER		DATE		SCALE

GBM 11-024 S.W. Cor. London St. & Reay Cres.  
ELEV 230.592 1.83m, on top of 0.05 m dia. x 2.4 m iron pipe,  
4.2 m E. of W. L. of London St. & on S.L. of Reay Cres.

No.	REVISIONS	DATE	BY
B	ISSUED FOR TENDER	15/03/16	RPB
A	ISSUED FOR CITY REVIEW	15/03/16	RPB

**MORRISON HERSHFELD**

DESIGNED BY	RPB	CHECKED BY	WRJ
DRAWN BY	DML	APPROVED BY	BWB
HOR. SCALE	1:250	RELEASED FOR CONSTRUCTION	
VERT. SCALE	1:10	DATE	15/03/16

PROFESSIONAL'S SEAL  
PROVINCE OF MANITOBA  
REGISTERED PROFESSIONAL ENGINEER  
**R.P. BRUCE**  
CONSULTANT DRAWING No. W150004 Reay-PP-03.dwg

**THE CITY OF WINNIPEG**  
PUBLIC WORKS DEPARTMENT  
ENGINEERING DIVISION  
2015 LOCAL STREET & ALLEY RENEWAL PROGRAM  
**REAY CRESCENT**  
ANTRIM RD TO LONDON ST  
ASPHALT RECONSTRUCTION  
HORIZONTAL AND VERTICAL ALIGNMENT  
STA 0+320 TO STA 0+450

CITY DRAWING NUMBER	N/A
SHEET	21 OF 39
DRAWING No.	21
REV	B

BID OPPORTUNITY No. 19-2015