

A1 SIZE 594mm x 841mm

PLOT: 3/31/2015 11:49:13 AM

FILE NAME: W150004-Ravenhill-PP-06.dwg Saved By: dlane

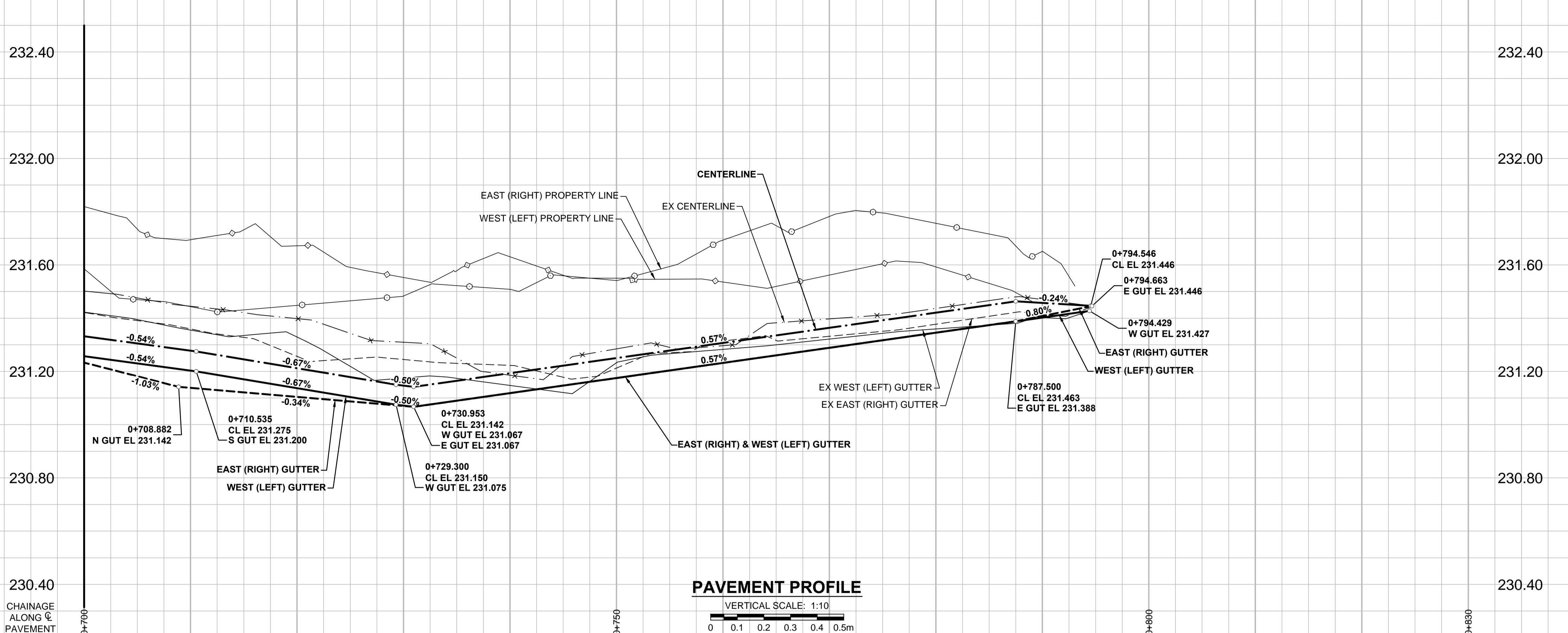

- NOTES**
- ADJUST MH AND CB RIMS TO NEW GRADES.
  - LAMP STANDARDS, HYDRO POLES, AND ANCHORS THAT REQUIRE TEMPORARY SUPPORT, REMOVAL OR REPLACEMENT, TO BE DONE SO AT THE EXPENSE OF THE CONTRACTOR AS NECESSARY.
  - CONTRACTOR TO REGRADE/RENEW EXISTING PRIVATE SIDEWALKS TO LIMITS AS SHOWN. SIDEWALKS TO BE RENEWED WITH CONCRETE UNLESS NOTED OTHERWISE.
  - CONTRACTOR TO TAKE PRECAUTIONARY STEPS TO PROTECT EXISTING TREES WITHIN THE LIMITS OF CONSTRUCTION FROM DAMAGE FROM CONSTRUCTION ACTIVITIES AS OUTLINED IN THE SPECIFICATIONS.
  - CONTRACTOR TO CONFIRM THE LOCATION OF ALL UTILITIES/SERVICES IN THE FIELD PRIOR TO CONSTRUCTION.
  - MODIFIED BARRIER CURB TO BE USED AT ALL INTERSECTION RADII, BACK LANE RADII AND BULLNOSES.
  - CB SD-023 & SD-024 OFFSETS ARE DIMENSIONED TO BOC. CB SD-025 OFFSETS ARE DIMENSIONED O/C.
  - ADD 200.00m TO ABBREVIATED ELEVATIONS TO OBTAIN GEODETIC ELEVATIONS.
  - IN GENERAL, PAVEMENT AND SIDEWALK AREAS TO BE REMOVED. MATCH RECONSTRUCTION LIMITS.
  - REFER TO BID OPPORTUNITY FOR DETAILS REGARDING TRAFFIC MANAGEMENT.

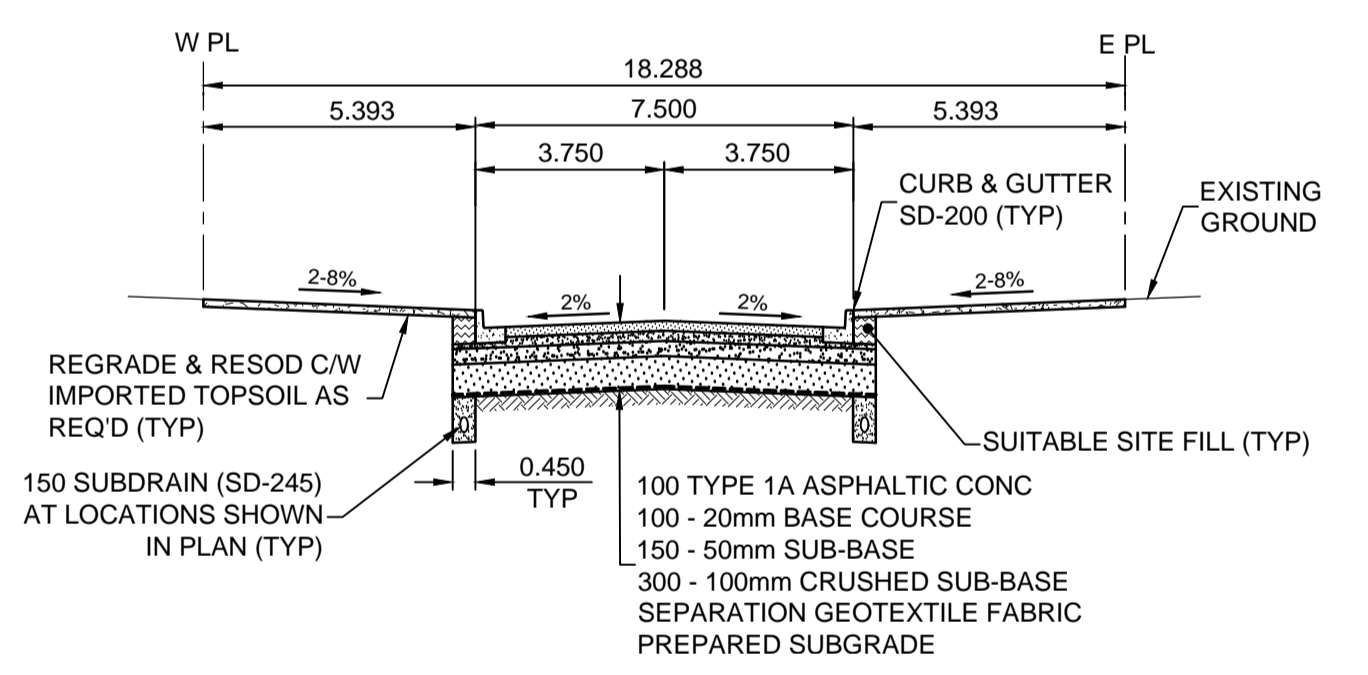
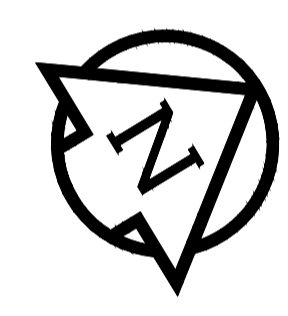
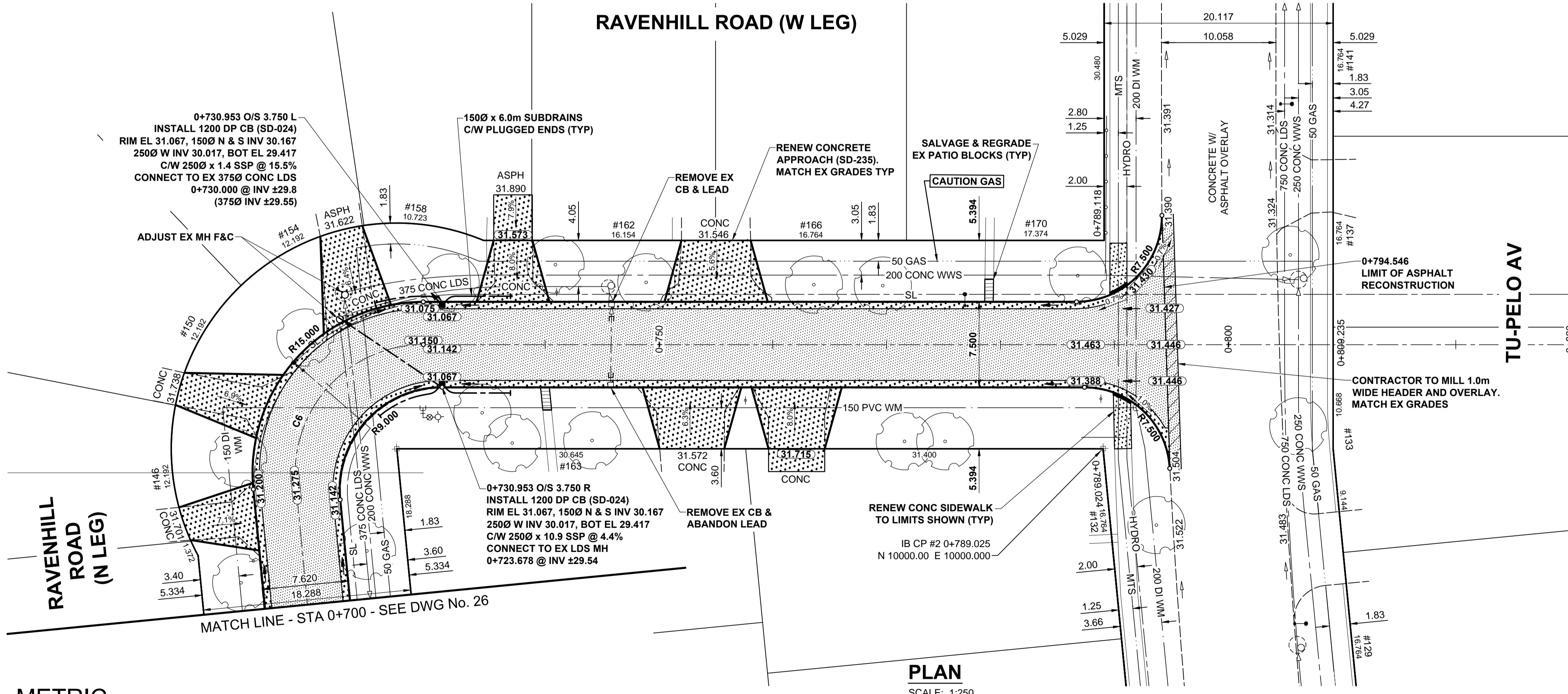

CONTROL LINE - COORDINATES		
NAME	NORTHING	EASTING
PT 0+587.404	9884.252	10076.801
PC 0+710.535	9937.735	9965.891
PT 0+729.300	9953.716	9961.166
POT 0+800.000	10014.117	9997.911

CONTROL LINE - CURVES				
CURVE	RADIUS	LENGTH	DELTA	TANGENT
C6	11.250	18.765	95°34'10"	12.400

**METRIC**  
WHOLE NUMBERS INDICATE MILLIMETRES  
DECIMALIZED NUMBERS INDICATE METRES

EXISTING	LEGEND - PLAN	NEW	EXISTING	LEGEND - PLAN	NEW	EXISTING	LEGEND - PLAN	NEW
	GAS		MANHOLE		CONCRETE PAVEMENT		LOCATION APPROVED	
	MTS		CATCH BASIN / CATCH PIT		CONC SIDEWALK / MEDIAN		UNDERGROUND STRUCTURES	
	HYDRO		CURB INLET WITH BOX		ASPHALT PAVEMENT		SUPR. U/G STRUCTURES	DATE COMMITTEE
	CATV / FIBRE OPTIC		TREE		PAVING STONE		NOTE:	LOCATION OF UNDERGROUND STRUCTURES AS SHOWN ARE BASED ON THE BEST INFORMATION AVAILABLE. BUT NO GUARANTEE IS GIVEN THAT ALL EXISTING UTILITIES ARE SHOWN OR THAT THE GIVEN LOCATIONS ARE EXACT. CONFIRMATION OF EXISTENCE AND EXACT LOCATION OF ALL SERVICES MUST BE OBTAINED FROM THE INDIVIDUAL UTILITIES BEFORE PROCEEDING WITH CONSTRUCTION.
	TRAFFIC SIGNALS / PIT		TEST HOLE		GRAVEL			
	LAND DRAINAGE SEWER		PROPERTY LINE		RAMP CURB			
	SANITARY/COMBINED SEWER		SURVEY BAR		PLANING / REMOVAL			
	SEWER SERV/DRAINAGE CONN		FENCE					
	WATERMAIN		BOC / EDGE OF PAVEMENT					
	SUBDRAIN		ELEVATION					
	DITCH		TRAFFIC SIGN					

GBM 11-030	N.E. Cor. Louella St. & Tu-Pelo Ave. Tbl. on top of 0.05 m dia. x 2.4 m iron pipe, 2.8 m S. of N.L. of Tu-Pelo Ave. & on E.L. of Louella St.
ELEV 231.350	
B	ISSUED FOR TENDER 15/03/16 JGK
A	ISSUED FOR CITY REVIEW 15/03/16 JGK
No.	REVISIONS YYMMDDI BY

DESIGNED BY	JGK
CHECKED BY	RPB
DRAWN BY	DML
APPROVED BY	BWB
HOR. SCALE	1:250
VERT. SCALE	1:10
DATE	15/03/16

PROFESSIONAL'S SEAL  
PROVINCE OF MANITOBA  
REGISTERED PROFESSIONAL ENGINEER  
**J.G. KENNEDY**  
Member 23226  
CONSULTANT DRAWING No. W150004-Ravenhill-PP-06.dwg

**THE CITY OF WINNIPEG**  
PUBLIC WORKS DEPARTMENT  
ENGINEERING DIVISION

**2015 LOCAL STREET & ALLEY RENEWAL PROGRAM**  
**RAVENHILL ROAD**  
ANTRIM RD TO TU-PELO AV  
ASPHALT RECONSTRUCTION  
HORIZONTAL AND VERTICAL ALIGNMENT  
STA 0+700 TO STA 0+830

CITY DRAWING NUMBER	N/A
SHEET	27 OF 39
DRAWING No.	27
REV	B

BID OPPORTUNITY No. 19-2015