

A1 SIZE 594mm x 841mm
PLOT: 3/31/2015 1:29:42 PM
FILE NAME: W150004-Bienvenue-PP-04.dwg Saved By: Diane

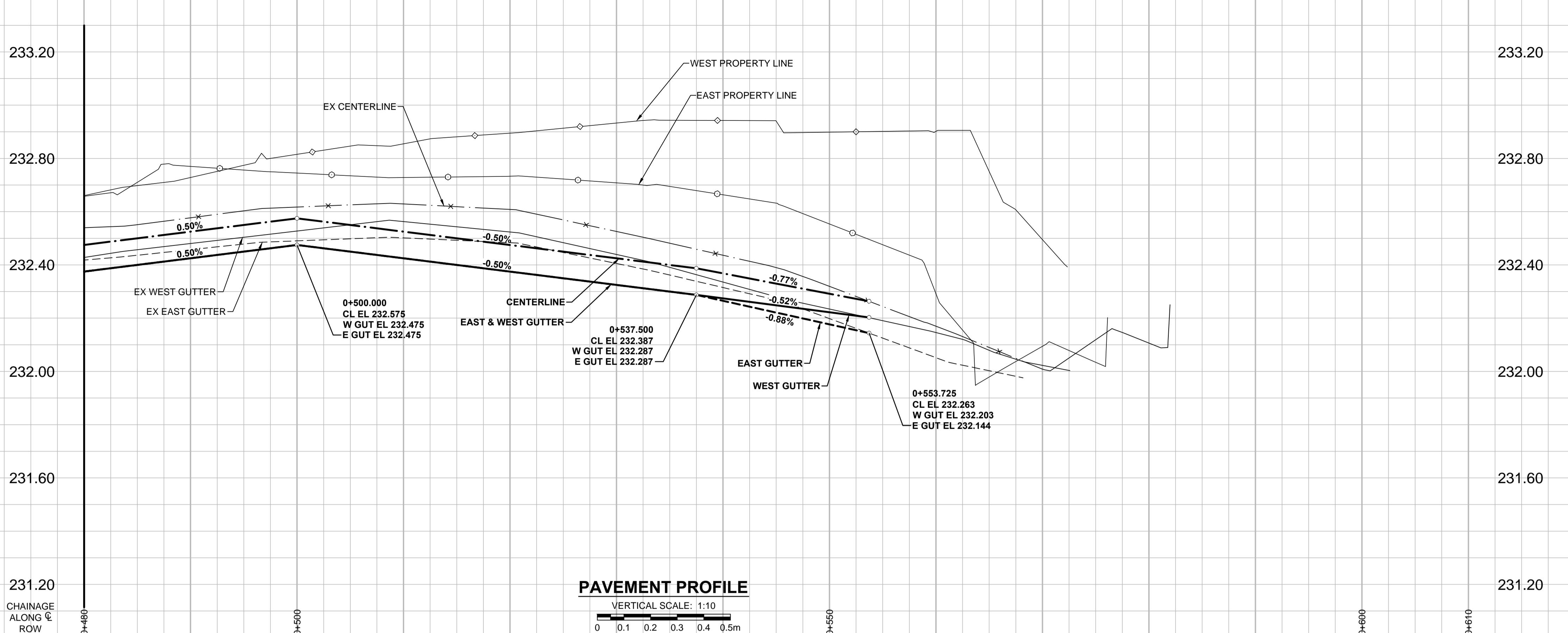

- NOTES**
- ADJUST MH AND CB RIMS TO NEW GRADES.
 - LAMP STANDARDS, HYDRO POLES, AND ANCHORS THAT REQUIRE TEMPORARY SUPPORT, REMOVAL OR REPLACEMENT, TO BE DONE SO AT THE EXPENSE OF THE CONTRACTOR AS NECESSARY.
 - CONTRACTOR TO REGRADE/RENEW EXISTING PRIVATE SIDEWALKS TO LIMITS AS SHOWN. SIDEWALKS TO BE RENEWED WITH CONCRETE UNLESS NOTED OTHERWISE.
 - CONTRACTOR TO TAKE PRECAUTIONARY STEPS TO PROTECT EXISTING TREES WITHIN THE LIMITS OF CONSTRUCTION FROM DAMAGE FROM CONSTRUCTION ACTIVITIES AS OUTLINED IN THE SPECIFICATIONS.
 - CONTRACTOR TO CONFIRM THE LOCATION OF ALL UTILITIES/SERVICES IN THE FIELD PRIOR TO CONSTRUCTION.
 - CB SD-023 & SD-024 OFFSETS ARE DIMENSIONED TO BOC. CB SD-025 OFFSETS ARE DIMENSIONED O.C.
 - ADD 200.000m TO ABBREVIATED ELEVATIONS TO OBTAIN GEODETIC ELEVATIONS.
 - IN GENERAL, PAVEMENT AND SIDEWALK AREAS TO BE REMOVED. MATCH RECONSTRUCTION LIMITS.
 - REFER TO BID OPPORTUNITY FOR DETAILS REGARDING TRAFFIC MANAGEMENT.

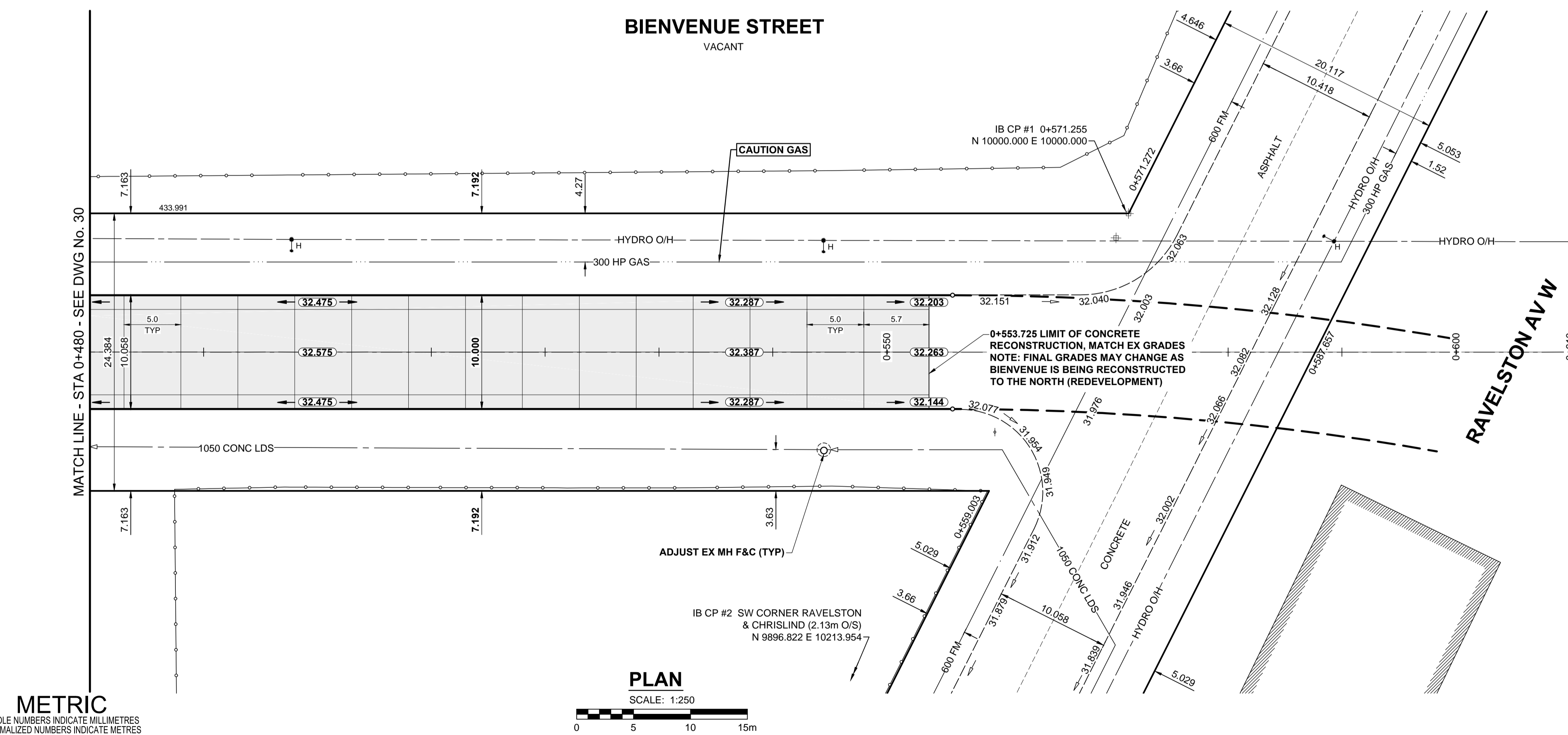

CONTROL LINE - COORDINATES

NAME	NORTHING	EASTING
POT 0+110.000	9539.016	10019.959
POT 0+580.000	10008.949	10012.035

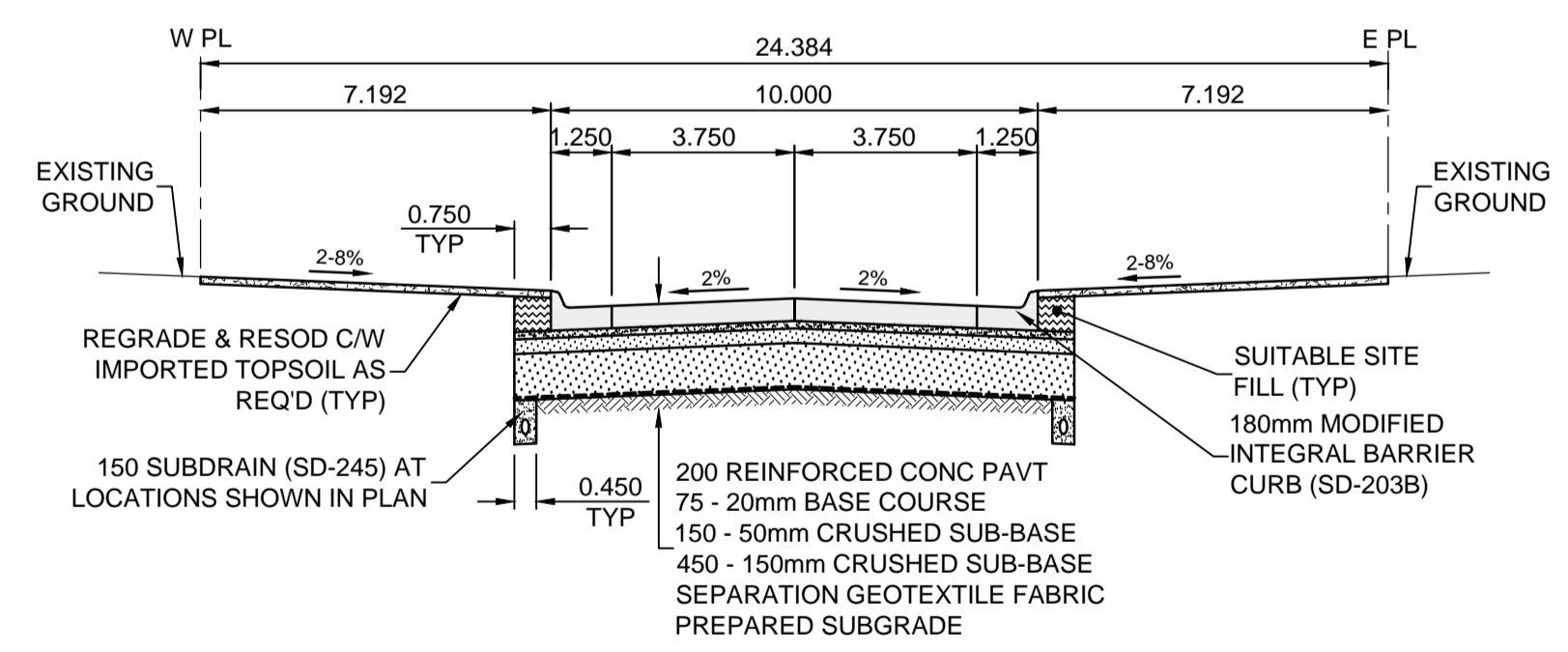

METRIC
WHOLE NUMBERS INDICATE MILLIMETRES
DECIMALIZED NUMBERS INDICATE METRES

	GAS		MANHOLE		CONCRETE PAVEMENT	<p>LOCATION APPROVED UNDERGROUND STRUCTURES</p> <p>SUPR. U/G STRUCTURES DATE COMMITTEE</p> <p>NOTE: LOCATION OF UNDERGROUND STRUCTURES AS SHOWN ARE BASED ON THE BEST INFORMATION AVAILABLE. BUT NO GUARANTEE IS GIVEN THAT ALL EXISTING UTILITIES ARE SHOWN OR THAT THE GIVEN LOCATIONS ARE EXACT. CONFIRMATION OF EXISTENCE AND EXACT LOCATION OF ALL SERVICES MUST BE OBTAINED FROM THE INDIVIDUAL UTILITIES BEFORE PROCEEDING WITH CONSTRUCTION.</p>
	MTS		CATCH BASIN / CATCH PIT		CONC SIDEWALK / MEDIAN	
	HYDRO		CURB INLET WITH BOX		ASPHALT PAVEMENT	
	CATV / FIBRE OPTIC		TREE		PAVING STONE	<p>GBM 29-005 N.E. Cor. Ravelston Ave. W. & C.N.R. Victoria Branch Line, 19 mm x 4.6 m I.B. in Valve Box in centre of Hydro Tower No. 17 on N. side of Ravelston Ave. W. & E. side of railway tracks in C.N.R. R.O.W.</p> <p>B ISSUED FOR TENDER 15/03/16 RPB</p> <p>A ISSUED FOR CITY REVIEW 15/03/16 RPB</p> <p>No. REVISIONS YYMMDDI BY</p>
	TRAFFIC SIGNALS / PIT		TEST HOLE		GRAVEL	
	LAND DRAINAGE SEWER		PROPERTY LINE		RAMP CURB	
	SANITARY/COMBINED SEWER		SURVEY BAR		PLANING / REMOVAL	
	SEWER SERV/DRAINAGE CONN		FENCE			
	WATERMAIN		BOC / EDGE OF PAVEMENT			
	SUBDRAIN		ELEVATION (33.100)			
	DITCH		TRAFFIC SIGN			
	EXISTING					
	LEGEND - PLAN					

DESIGNED BY	RPB	CHECKED BY	WRJ
DRAWN BY	DML	APPROVED BY	BWB
HOR. SCALE	1:250	RELEASED FOR CONSTRUCTION	
VERT. SCALE	1:10		
DATE	15/03/16	DATE	

MORRISON HERSHFIELD

PROFESSIONAL'S SEAL
PROVINCE OF MANITOBA
REGISTERED PROFESSIONAL ENGINEER
R.P. BRUCE

CONSULTANT DRAWING No.
W150004 Bienvenue-PP-04.dwg

THE CITY OF WINNIPEG
PUBLIC WORKS DEPARTMENT
ENGINEERING DIVISION

2015 LOCAL STREET & ALLEY RENEWAL PROGRAM
BIENVENUE STREET
REGENT AV W TO RAVELSTON AV W
CONCRETE RECONSTRUCTION
HORIZONTAL AND VERTICAL ALIGNMENT
STA 0+480 TO STA 0+610

CITY DRAWING NUMBER N/A
SHEET 31 OF 39
DRAWING No. REV 31 B

BID OPPORTUNITY No. 19-2015