

NOTE: CHAINAGES SHOWN ARE ALONG S. R. OF MARGARET AVENUE

MARGARET AVENUE

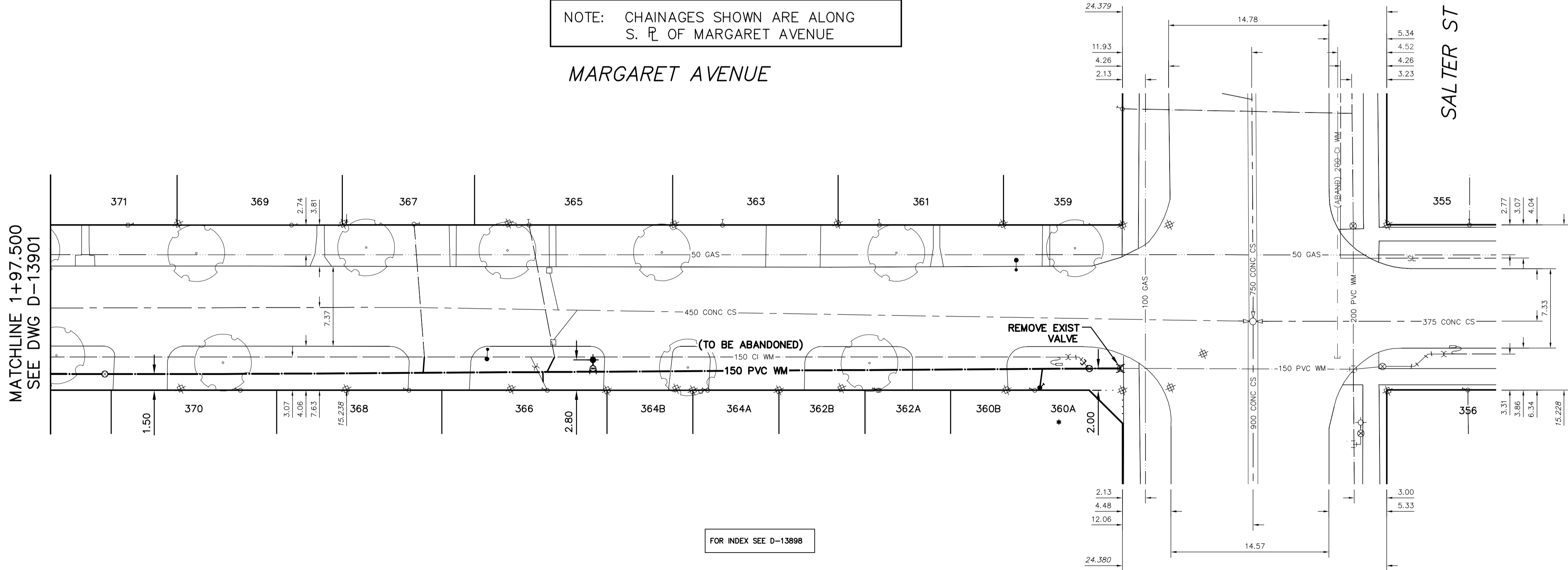

FOR INDEX SEE D-13898



WATER SERVICE INFORMATION

ADDRESS	SIZE (mm) MATERIAL (STREET)	SIZE (mm) (PROP.)	SHORT & LONG MEASUREMENT	CORP. LOCATION	REMARKS
371 MARGARET AV	-	-	2.3 W EL HSE	-	RECONNECT SERVICE
RESIDENTIAL	-	-	91.70 WWL SALTER ST	-	-
369 MARGARET AV	-	-	2.3 W EL HSE	-	RECONNECT SERVICE
RESIDENTIAL	-	-	76.61 WWL SALTER ST	-	-
367 MARGARET AV	20	20	3.3 W EL HSE	-	RECONNECT SERVICE
RESIDENTIAL	CU	-	65.32 WWL SALTER ST	1.0 E OF S/C	-
365 MARGARET AV	20	20	9.4 W EL HSE	-	RECONNECT SERVICE
RESIDENTIAL	CU	-	54.71 WWL SALTER ST	2.3 E OF S/C	-
363 MARGARET AV	-	-	8.6 W EL HSE	-	RECONNECT SERVICE
RESIDENTIAL	-	-	36.88 WWL SALTER ST	-	-
361 MARGARET AV	-	-	8.8 W EL HSE	-	RECONNECT SERVICE
RESIDENTIAL	-	-	22.40 WWL SALTER ST	-	-
359 MARGARET AV	20	20	4.8 W EL HSE	-	RECONNECT SERVICE
RESIDENTIAL	CU	CU	10.72>NNL MARGARET AV	0.4 S OF S/C	SERV. OFF SALTER ST
355 MARGARET AV	-	-	6.8 W EL HSE	-	RECONNECT SERVICE
RESIDENTIAL	-	-	7.62 WWL SALTER ST	-	-
370 MARGARET AV	-	-	1.1 W EL HSE	-	RECONNECT SERVICE
RESIDENTIAL	-	-	81.33 WWL SALTER ST	-	-
368 MARGARET AV	-	-	11.2 W EL HSE	-	RECONNECT SERVICE
RESIDENTIAL	-	-	65.79 WWL SALTER ST	-	-
366 MARGARET AV	20	20	3.4 W EL HSE	-	RECONNECT SERVICE
RESIDENTIAL	CU	-	53.03 WWL SALTER ST	1.5 W OF S/C	-
364 B MARGARET AV	-	-	4.4 W EL HSE	-	RECONNECT SERVICE
RESIDENTIAL	-	-	38.88 WWL SALTER ST	-	-
364 A MARGARET AV	-	-	3.8 W EL HSE	-	RECONNECT SERVICE
RESIDENTIAL	-	-	38.25 WWL SALTER ST	-	-
362 B MARGARET AV	-	-	3.9 W EL HSE	-	RECONNECT SERVICE
RESIDENTIAL	-	-	22.57 WWL SALTER ST	-	-
362 A MARGARET AV	-	-	3.7 W EL HSE	-	RECONNECT SERVICE
RESIDENTIAL	-	-	22.40 WWL SALTER ST	-	-
360 B MARGARET AV	-	-	3.5 W EL HSE	-	RECONNECT SERVICE
RESIDENTIAL	-	-	8.08 WWL SALTER ST	-	-
360 A MARGARET AV	-	-	3.5 W EL HSE	-	RENEW SERVICE TO R' W/20 CU
RESIDENTIAL	-	-	8.08 WWL SALTER ST	-	-

* SERVICES TO BE RENEWED TO R'. ALL OTHERS TO BE RECONNECTED

VALVES TO BE COUNTER-CLOCKWISE TO CLOSE (RED OPERATING NUT)

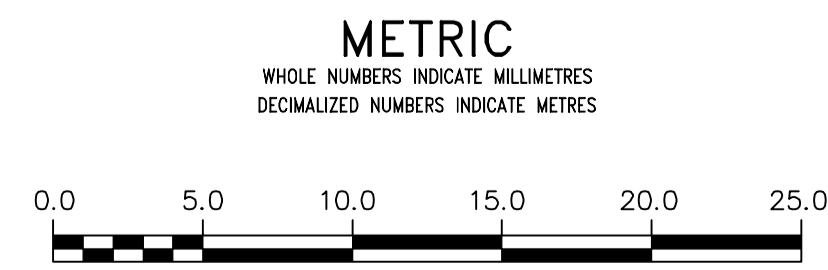

<p>WARNING</p> <p>IF POWER EQUIPMENT OR EXPLOSIVES ARE TO BE USED FOR EXCAVATION ON THIS PROJECT THE CONTRACTOR MUST:</p> <p>1) NOTIFY THE GAS COMPANY OF THE PROPOSED LOCATION OF EXCAVATION.</p> <p>2) TAKE PRECAUTION TO AVOID DAMAGE TO GAS COMPANY INSTALLATIONS.</p> <p>SEE PROVINCIAL REGULATION 21072 FOR DETAILS</p>	<p>LOCATION APPROVED UNDERGROUND STRUCTURES</p> <p>SUPV. U/G STRUCTURES COMMITTEE DATE</p> <p>NOTE:</p> <p>LOCATION OF UNDERGROUND STRUCTURES AS SHOWN ARE BASED ON THE BEST INFORMATION AVAILABLE BUT NO GUARANTEE IS GIVEN THAT ALL EXISTING UTILITIES ARE SHOWN OR THAT THE GIVEN LOCATIONS ARE EXACT. CONFIRMATION OF EXISTENCE AND EXACT LOCATION OF ALL SERVICES MUST BE OBTAINED FROM THE INDIVIDUAL UTILITIES BEFORE PROCEEDING WITH CONSTRUCTION.</p>	<p>B.M. ELEV.</p> <p>CONSTRUCTION COMPLETION DATE: YYYY MM DD</p>	<p>DESIGNED BY MK</p> <p>CHECKED BY SC</p> <p>DRAWN BY MA/RS</p> <p>APPROVED BY KZ</p> <p>SCALE: HORIZONTAL 1:250 VERTICAL 1:50</p> <p>RELEASED FOR CONSTRUCTION</p>	<p>ENGINEER'S SEAL</p> <p>ORIGINAL SIGNED BY K.R. ZUREK 15/03/18</p> <p>CONSULTANT DRAWING NUMBER</p>	<p>THE CITY OF WINNIPEG</p> <p>Winnipeg</p> <p>WATER AND WASTE DEPARTMENT</p> <p>ENGINEERING DIVISION</p> <p>2015 WATERMAIN RENEWALS</p> <p>MARGARET AVENUE</p> <p>SALTER STREET TO 110 W OF SALTER STREET</p>	<p>SHEET 3 OF 12</p> <p>CITY DRAWING NUMBER D-13900</p>