

Mar 12, 2015 - 11:20am  
 C:\Users\mmmm\Documents\Drawings\Construction\Drawings\Rehabilitation\551417\_C03-C05 Stapon Road Plan & Profile\_20150316.dwg - tab: C04

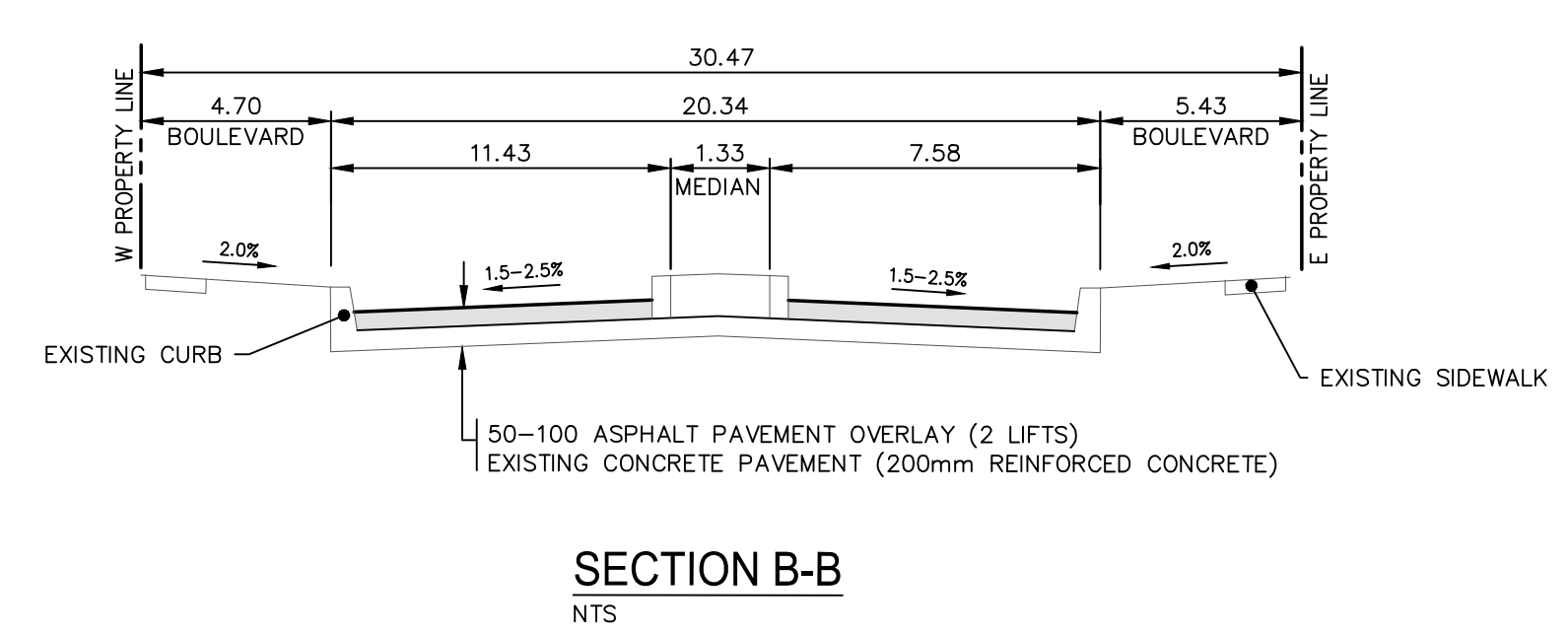
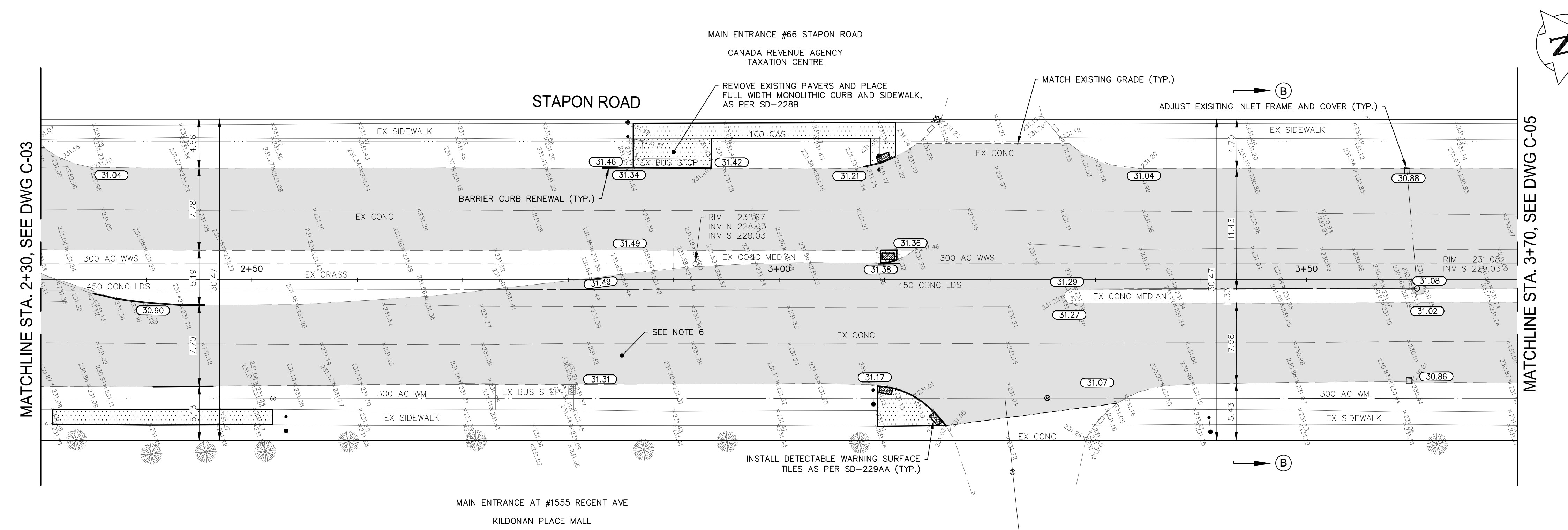
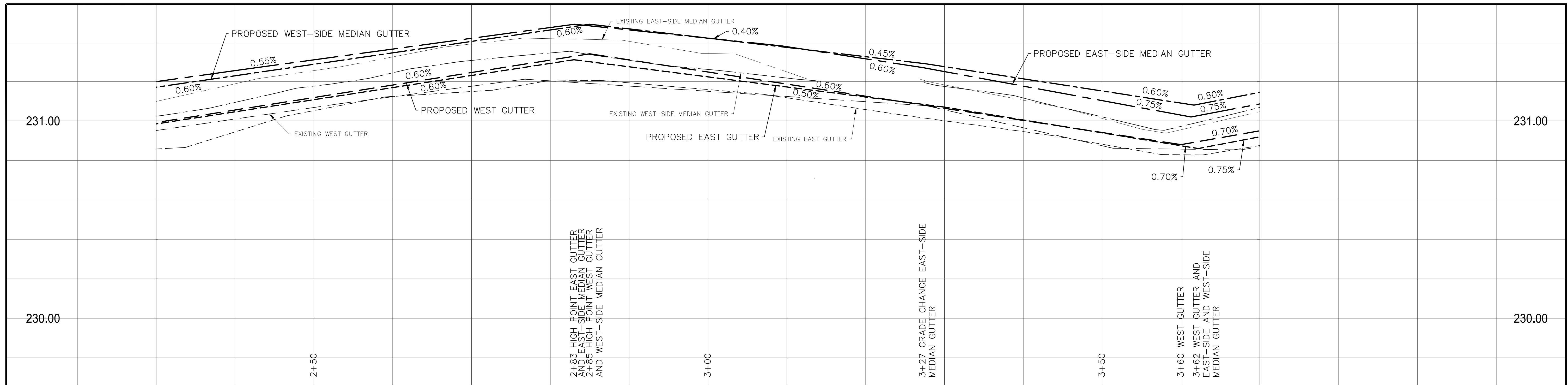

NOTE: These design documents are prepared solely for the use by the party with whom the design professional has entered into a contract and there are no representations of any kind made by the design professional to any party with whom the design professional has not entered into a contract.

LEGEND-PLAN	PROPOSED	EXISTING	LEGEND-PROFILE	PROPOSED	EXISTING
WATER MAIN	—	—	ANCHOR	—	—
LAND DRAINAGE SEWER	—	—	#111 CIVIC ADDRESS	—	—
WASTE WATER SEWER	—	—	IRON BAR	—	—
HYDRO	—	—	HYDRO POLE & LIGHT STANDARD	—	—
M.T.S.	—	—	LIGHT STANDARD	—	—
GAS	—	—	HYDRO POLE	—	—
SIGNALS	—	—	CURB RAMP	—	—
MANHOLE	—	—	EDGE OF SIDEWALK	—	—
CATCH BASIN	—	—	PROPERTY LINE	—	—
CURB INLET	—	—	EDGE OF ASPHALT	—	—
UTILITIES ADJUSTED	—	—	MODIFIED BARRIER CURB	—	—
PLUG	—	—	MODIFIED BARRIER CURB & GUTTER	—	—
HYDRANT	—	—	BARRIER CURB	—	—
VALVE	—	—	BARRIER CURB & GUTTER	—	—
CURB STOP	—	—	EDGE OF CONCRETE	—	—
GROUND GRADE	—	—	SIDEWALK	—	—
PAVEMENT GRADE	(31.00)	—	CONCRETE	—	—
LOT GRADE	[31.00]	—	ASPHALT	—	—
EXISTING	—	—	MILLED SURFACE	—	—
LEGEND-PLAN	PROPOSED	EXISTING	LEGEND-PROFILE	PROPOSED	EXISTING

LOCATIONS APPROVED UNDERGROUND STRUCTURES

SIGNED BY: \_\_\_\_\_ DATE: \_\_\_\_\_

NO. REVISIONS

LEGEND-PROFILE

WEST-SIDE MEDIAN  
EAST-SIDE MEDIAN  
ROADWAY CENTRE LINE  
WEST GUTTER  
EAST GUTTER  
WEST PROPERTY LINE  
EAST PROPERTY LINE

LOCATION OF UNDERGROUND STRUCTURES AS SHOWN ARE BASED ON THE BEST INFORMATION AVAILABLE BUT NO GUARANTEE IS GIVEN THAT ALL EXISTING UTILITIES ARE SHOWN OR THAT THE GIVEN LOCATIONS ARE EXACT CONFIRMATION OF EXISTENCE AND EXACT LOCATION OF ALL SERVICES MUST BE OBTAINED FROM THE INDIVIDUAL UTILITIES BEFORE PROCEEDING

G.B.M. - BENCHMARK LOCATION ON TOP OF BRASS CAP AT THE NORTHEAST CORNER OF REENDERS AND STAPON ROAD  
ELEV. 231.584

**MMM GROUP**

DESIGNED BY: SDG  
DRAWN BY: TR/VA  
CHECKED BY: -  
APPROVED BY: -  
RELEASED FOR CONSTRUCTION: -

HOR. SCALE: 1:250  
VERTICAL SCALE: 1:10

DATE: 12-DEC-2014

ENGINEERS SEAL

**R.M. BORODY**  
Member  
6179

CONSULTANT ACAD DWG. NO.  
5514117-C-04

**THE CITY OF WINNIPEG**  
PUBLIC WORKS DEPARTMENT  
ENGINEERING DIVISION

2015 STREET RENEWAL PROGRAM

STAPON ROAD - REGENT AVENUE WEST TO REENDERS DRIVE  
PAVEMENT REHABILITATION  
STA. 2+30 TO STA. 3+70

**METRIC**

WHOLE NUMBERS INDICATE MILLIMETRES  
DECIMALIZED NUMBERS INDICATE METRES

**APEGM**  
Certificate of Authorization  
MMM Group Limited  
No. 4531

CITY DRAWING NUMBER

SHEET 4 OF 17

BID NO. 24-2015

- NOTES:
- ALL WORK AND MATERIALS TO BE IN ACCORDANCE WITH THE LATEST REVISION OF THE CITY OF WINNIPEG STANDARD CONSTRUCTION SPECIFICATIONS.
  - ALL ROADWAY DIMENSIONS SHOWN ARE TO BACK OF CURB.
  - BOULEVARD RESTORATION TO BE SOD UNLESS OTHERWISE NOTED.
  - CURB 150mm REVEAL UNLESS OTHERWISE SHOWN.
  - ADD 200.00 TO ALL ELEVATIONS TO OBTAIN GEODETIC ELEVATIONS.
  - ADDITIONAL CURB RENEWALS, JOINT AND SLAB REPAIRS WILL BE IDENTIFIED PRIOR TO COMMENCING WORK ON THE PROJECT.