

Mar 12, 2015 - 11:36am  
 C:\Users\j351939\Documents\Drawings\Rehabilitation\551417-C11-C15 Des Meurons Plan & Profile\_20150212.dwg - lbc-02

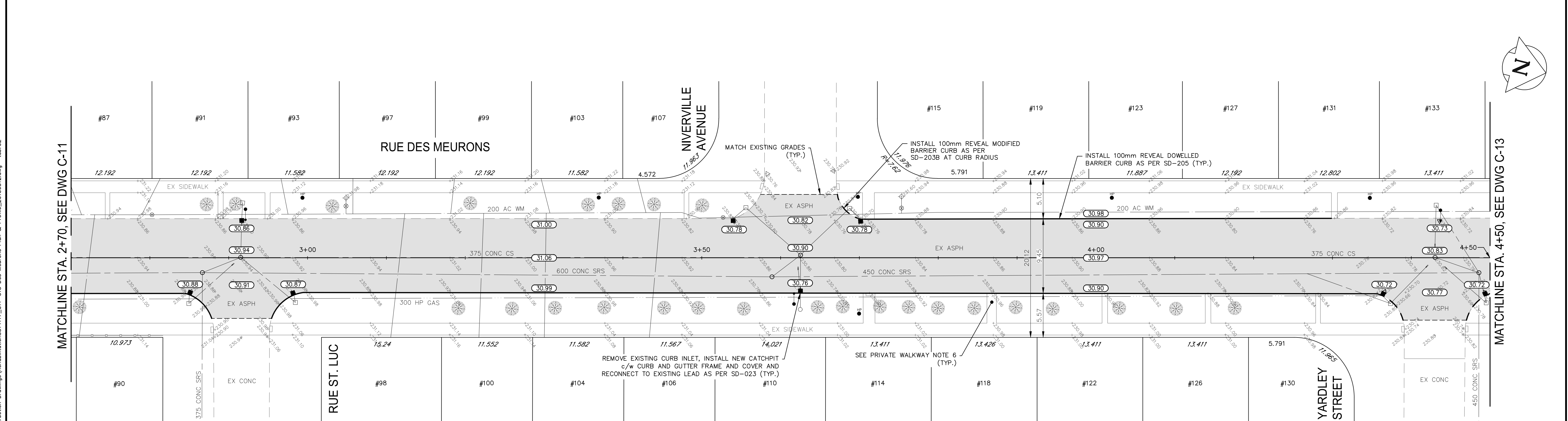

NOTE:  
 These design documents are prepared solely for the use by the party with whom the design professional has entered into a contract and there are no representations of any kind made by the design professional to any party with whom the design professional has not entered into a contract.

LEGEND-PLAN	PROPOSED	EXISTING	LEGEND-PROFILE	PROPOSED	EXISTING
WATER MAIN	—	—	ANCHOR	—	—
LAND DRAINAGE SEWER	—	—	#111 CIVIC ADDRESS	—	—
WASTE WATER SEWER	—	—	IRON BAR	—	—
HYDRO	—	—	HYDRO POLE & LIGHT STANDARD	—	—
M.T.S.	—	—	LIGHT STANDARD	—	—
GAS	—	—	HYDRO POLE	—	—
SIGNALS	—	—	CURB RAMP	—	—
MANHOLE	—	—	EDGE OF SIDEWALK	—	—
CATCH BASIN	—	—	PROPERTY LINE	—	—
CURB INLET	—	—	EDGE OF ASPHALT	—	—
UTILITIES ADJUSTED	—	—	MODIFIED BARRIER CURB	—	—
PLUG	—	—	MODIFIED BARRIER CURB & GUTTER	—	—
HYDRANT	—	—	BARRIER CURB	—	—
VALVE	—	—	BARRIER CURB & GUTTER	—	—
CURB STOP	—	—	EDGE OF CONCRETE	—	—
GROUND GRADE	—	—	SIDEWALK	—	—
PAVEMENT GRADE	—	—	ROADWAY CENTRE LINE	—	—
LOT GRADE	—	—	WEST GUTTER	—	—
EXISTING	—	—	EAST GUTTER	—	—
LEGEND-PLAN	—	—	WEST BACK OF SIDEWALK	—	—
PROPOSED	—	—	EAST BACK OF SIDEWALK	—	—
EXISTING	—	—	LEGEND-PROFILE	—	—
PROPOSED	—	—		—	—

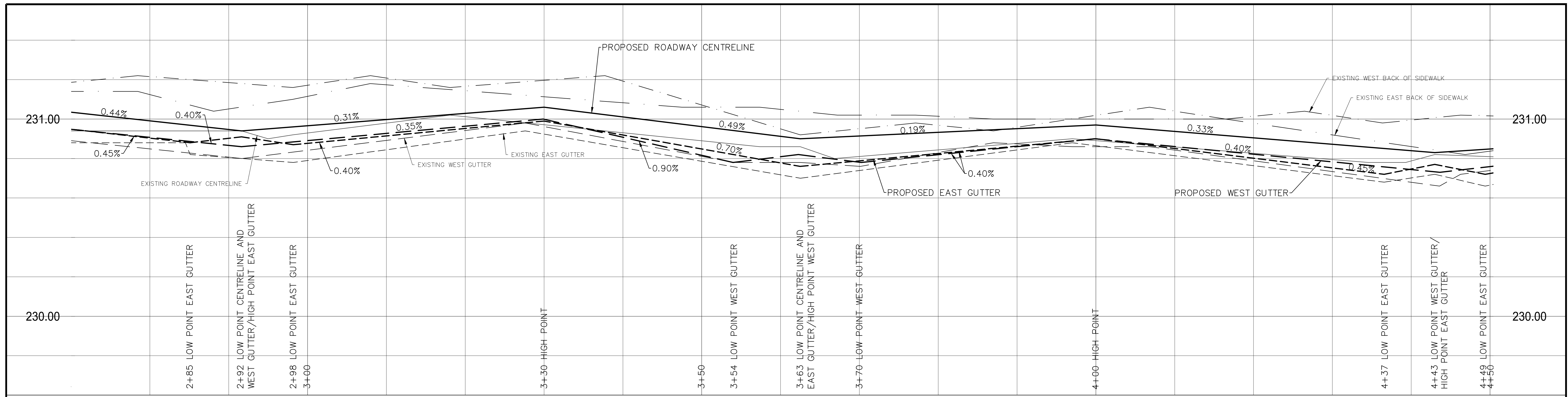
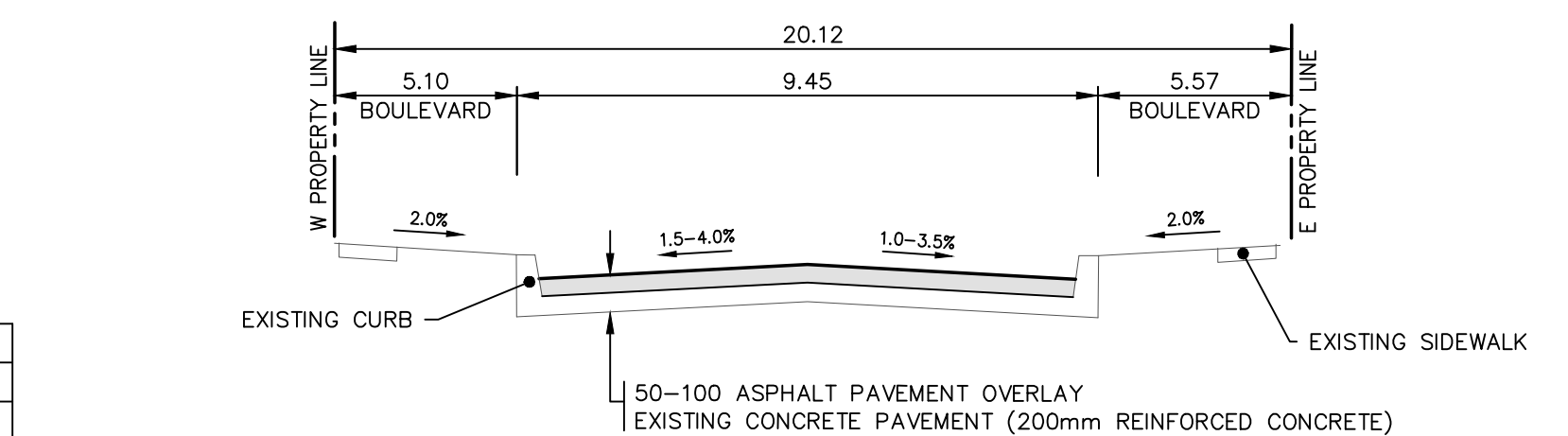

LOCATIONS APPROVED UNDERGROUND STRUCTURES

SIGNED BY: \_\_\_\_\_ DATE: \_\_\_\_\_

SUPV U/G STRUCTURES

LOCATION OF UNDERGROUND STRUCTURES AS SHOWN ARE BASED ON THE BEST INFORMATION AVAILABLE BUT NO GUARANTEE IS GIVEN THAT ALL EXISTING UTILITIES ARE SHOWN OR THAT THE GIVEN LOCATIONS ARE EXACT CONFIRMATION OF EXISTENCE AND EXACT LOCATION OF ALL SERVICES MUST BE OBTAINED FROM THE INDIVIDUAL UTILITIES BEFORE PROCEEDING

NO.	REVISIONS	DATE	BY
B	ISSUED FOR TENDER	16.03.15	SDG
A	ISSUED TO U/G STRUCTURES FOR REVIEW	19.02.15	SDG

NOTES:

- ALL WORK AND MATERIALS TO BE IN ACCORDANCE WITH THE LATEST REVISION OF THE CITY OF WINNIPEG STANDARD CONSTRUCTION SPECIFICATIONS.
- ALL ROADWAY DIMENSIONS SHOWN ARE TO BACK OF CURB.
- BOULEVARD RESTORATION TO BE 500 UNLESS OTHERWISE NOTED.
- ADD 200.00 TO ELEVATIONS TO OBTAIN GEODETIC ELEVATION.
- CURB 180MM REVEAL UNLESS OTHERWISE NOTED.
- ALL PRIVATE WALKWAYS TO BE ADJUSTED TO NEW TOP OF CURB ELEVATION, AS REQUIRED.
- ADDITIONAL SIDEWALK RENEWALS, JOINT AND SLAB REPAIRS WILL BE IDENTIFIED PRIOR TO COMMENCING WORK ON THE PROJECT.

**METRIC**  
 WHOLE NUMBERS INDICATE MILLIMETRES  
 DECIMALIZED NUMBERS INDICATE METRES

**APCM**  
 Certificate of Authorization  
**MMM Group Limited**  
 No. 4531

**MMMGROUP**

BENCHMARK LOCATION  
 ELEV. 232.148  
 LOCATED ON "O" ON OPEN ON FIRST HYDRANT SOUTH WEST OF CARRIER AVENUE AND RUE DES MEURONS.

MMMG Group Limited  
 Suite 111 - 93 Lombard Ave.  
 Winnipeg, MB R3B 3B1  
 t. 204.943.3178  
 f. 204.943.4948  
 www.mmm.ca

ENGINEERS SEAL  
**R.M. BORODY**  
 Member  
 6179  
 REGISTERED PROFESSIONAL ENGINEER

**THE CITY OF WINNIPEG**  
 PUBLIC WORKS DEPARTMENT  
 ENGINEERING DIVISION

2015 STREET RENEWAL PROGRAM

RUE DES MEURONS - CARRIER AVENUE TO HORACE STREET  
 STA. 2+70 TO STA. 4+50

PAVEMENT REHABILITATION

CITY DRAWING NUMBER  
 SHEET 12 OF 17

BID NO.  
 24-2015

CONSULTANT ACAD DWG. NO.  
 5514117-C-12

DESIGNED BY: RE  
 CHECKED BY: SDG  
 DRAWN BY: TR/HK  
 APPROVED BY: -  
 RELEASED FOR CONSTRUCTION  
 DATE: 11-NOV-2014