



THE CITY OF WINNIPEG

WATER AND WASTE DEPARTMENT
ENGINEERING DIVISION

2015 WATERMAIN RENEWALS & ASSOCIATED WORKS

CONTRACT NO. 2
BID OPPORTUNITY 246-2015

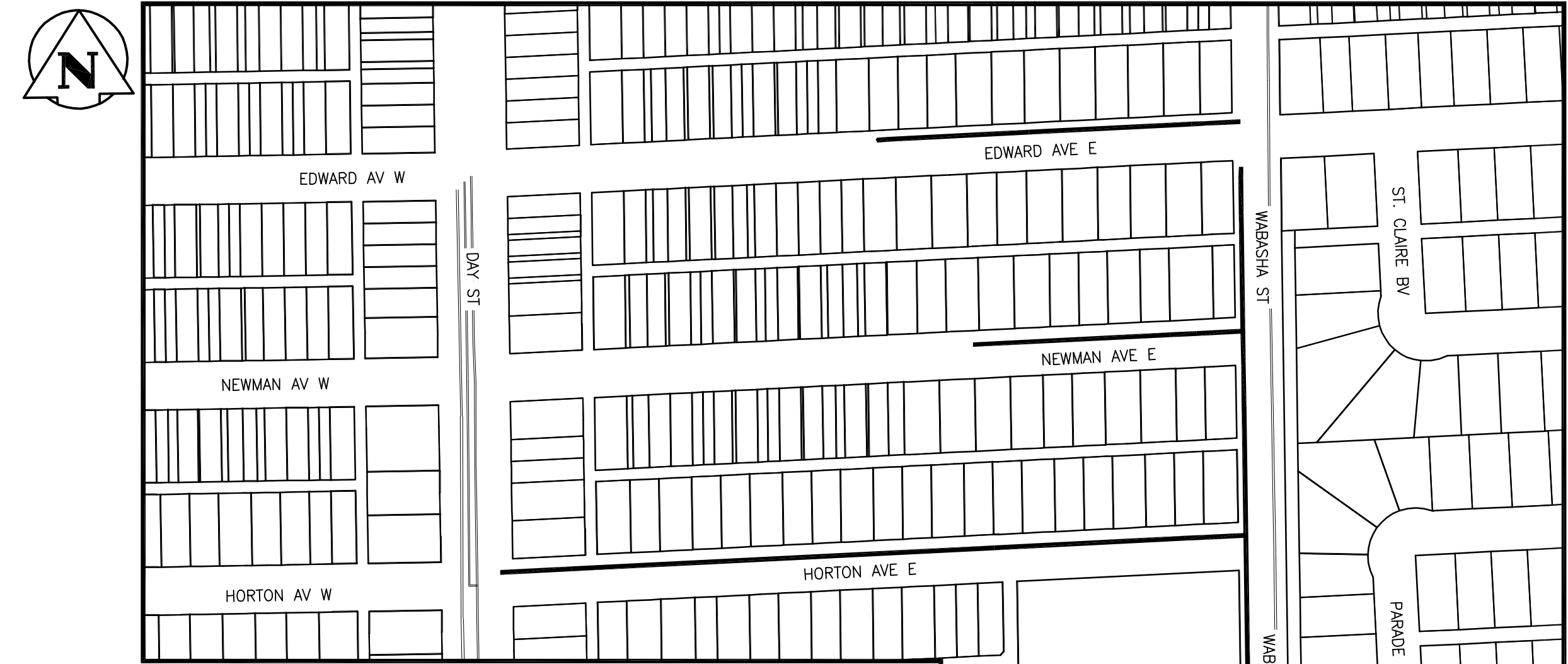

HORTON AVENUE EAST - 10 EEL OF DAY STREET TO 110 EEL OF DAY STREET
HORTON AVENUE EAST - 110 EEL OF DAY STREET TO 90 WML OF WABASHA STREET
HORTON AVENUE EAST - 90 WML OF WABASHA STREET TO WABASHA STREET
NEWMAN AVENUE EAST - 110 WML OF WABASHA STREET TO WABASHA STREET
EDWARD AVENUE EAST - 150 WML OF WABASHA STREET TO 70 WML OF WABASHA STREET
EDWARD AVENUE EAST - 70 WML OF WABASHA STREET TO WABASHA STREET



WABASHA STREET - HAROLD AVENUE E TO 110 NNL HAROLD AVENUE E
WABASHA STREET - 110 NNL HAROLD AVENUE E TO 50 NNL HORTON AVENUE E
WABASHA STREET - 50 NNL HORTON AVENUE E TO 2 SSL OF EDWARD AVENUE E

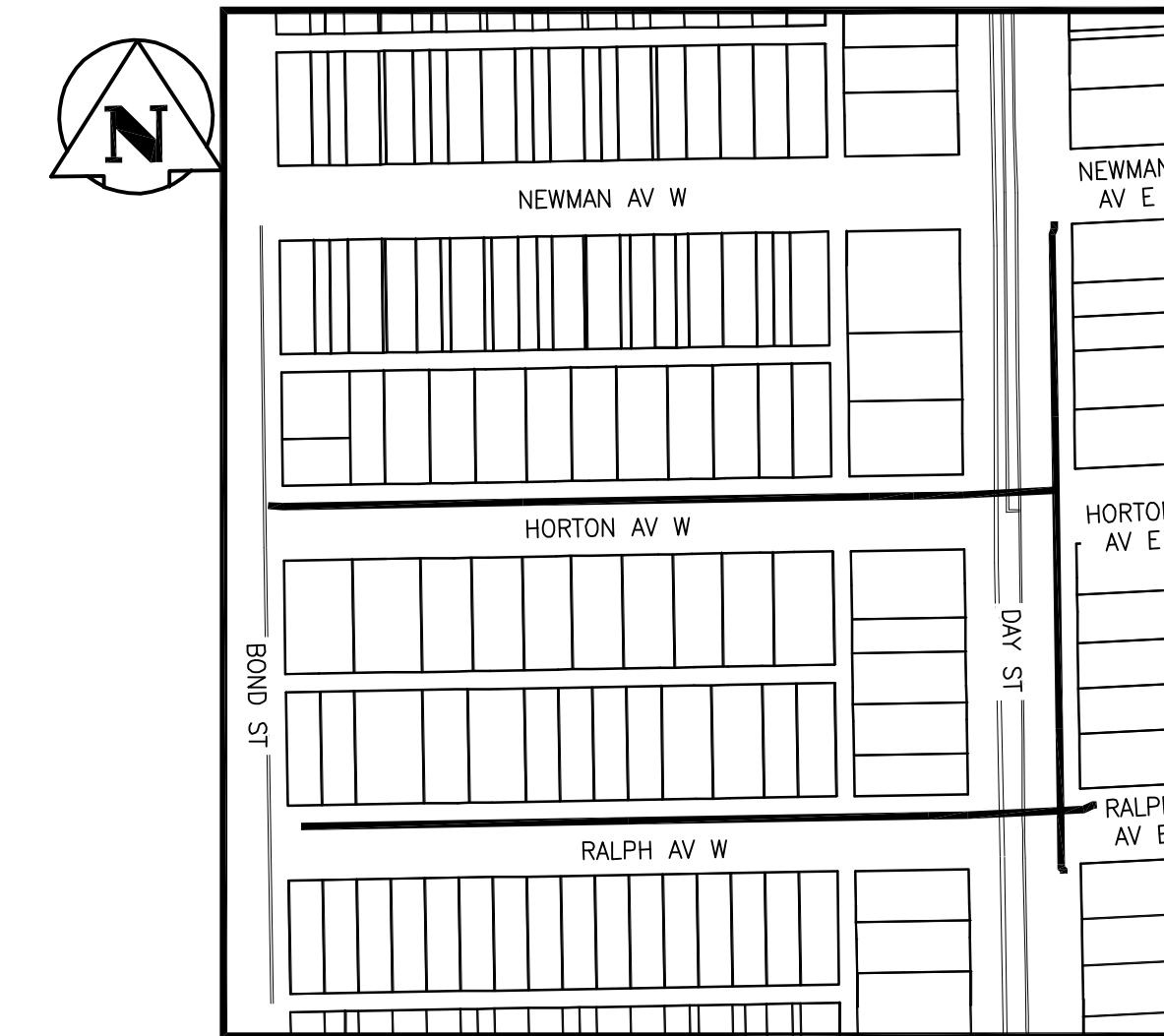

RALPH AVENUE WEST - BOND STREET TO 100 EEL BOND STREET
RALPH AVENUE WEST - 100 EEL BOND STREET TO DAY STREET
DAY STREET - RALPH AVENUE EAST TO 15 NNL OF HORTON AVENUE
DAY STREET - 15 NNL OF HORTON AVENUE TO NEWMAN AVENUE EAST
HORTON AVENUE WEST - BOND STREET TO 100 EEL BOND STREET
HORTON AVENUE WEST - 100 EEL BOND STREET TO 10 EEL OF DAY STREET

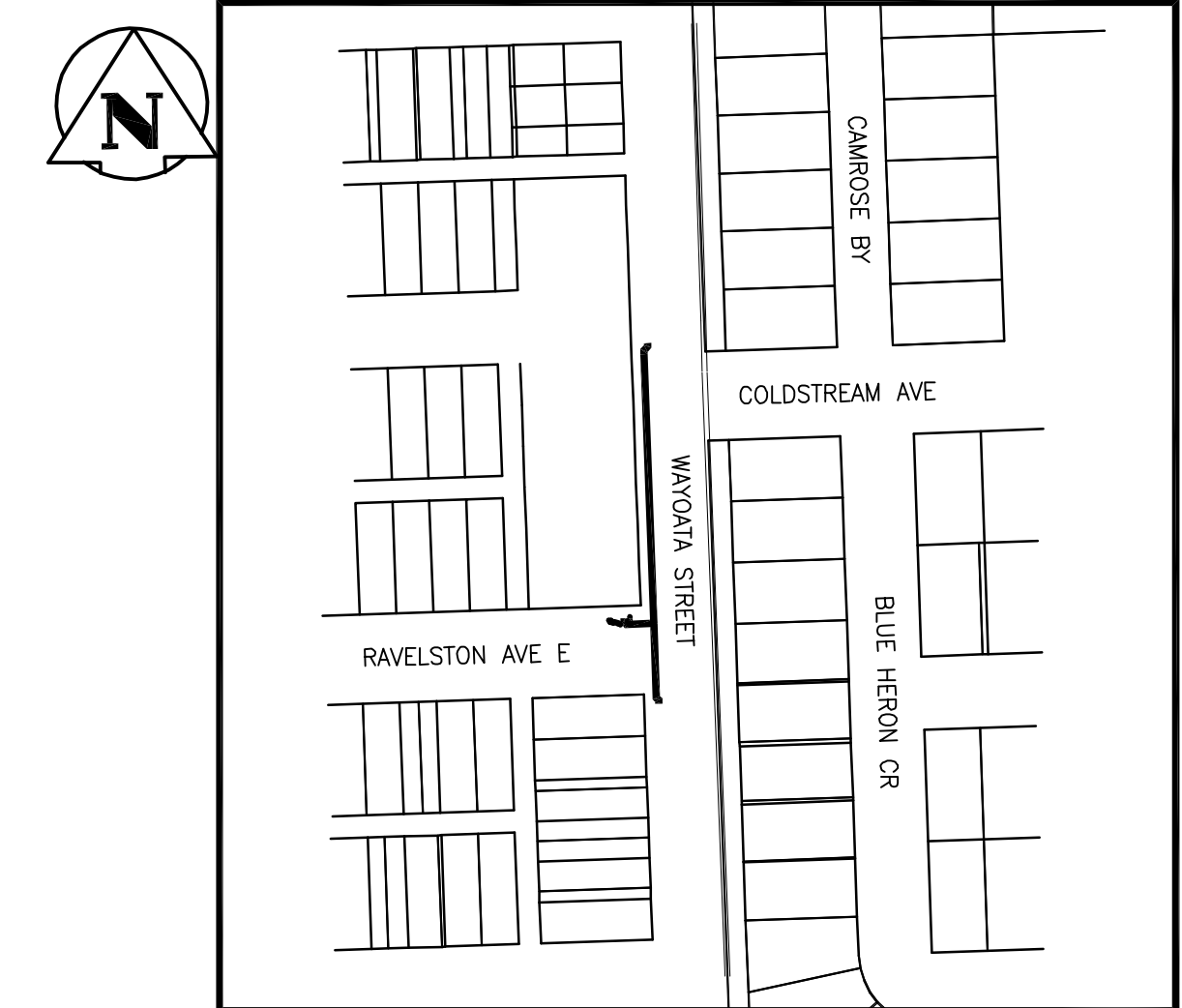

WAYOATA STREET - RAVELSTON AVENUE E TO COLDSTREAM AVENUE

KEY MAPS

