

WATER SERVICE INFORMATION

ADDRESS	SIZE (mm) MATERIAL (STREET)	SIZE (mm) MATERIAL (PROP.)	SHORT & LONG MEASUREMENT	CORP. LOCATION	REMARKS
160 NEWMAN AVE E RESIDENTIAL	20	CU	4.27 EWL HSE 8.85 FROM HSE FRONT	-	RECONNECT SERVICE
163 NEWMAN AVE E RESIDENTIAL	20	CU	1.22 EWL OF HSE 10.19 FROM HSE FRONT	-	RECONNECT SERVICE
162 EDWARD AVE E RESIDENTIAL	12	LEAD	2.44 EWL OF HSE 7.50 FROM HSE FRONT	-	RECONNECT SERVICE
163 EDWARD AVE E RESIDENTIAL	12	LEAD	2.74 BEL OF HSE 0.79 IN ON PROPERTY	-	RECONNECT SERVICE

* SERVICES TO BE RENEWED TO P/L ALL OTHERS TO BE RECONNECTED

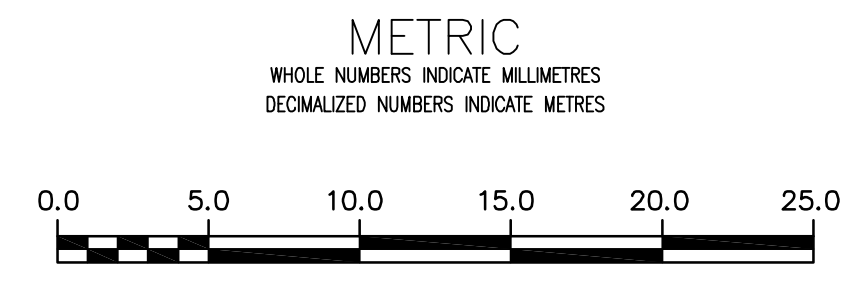
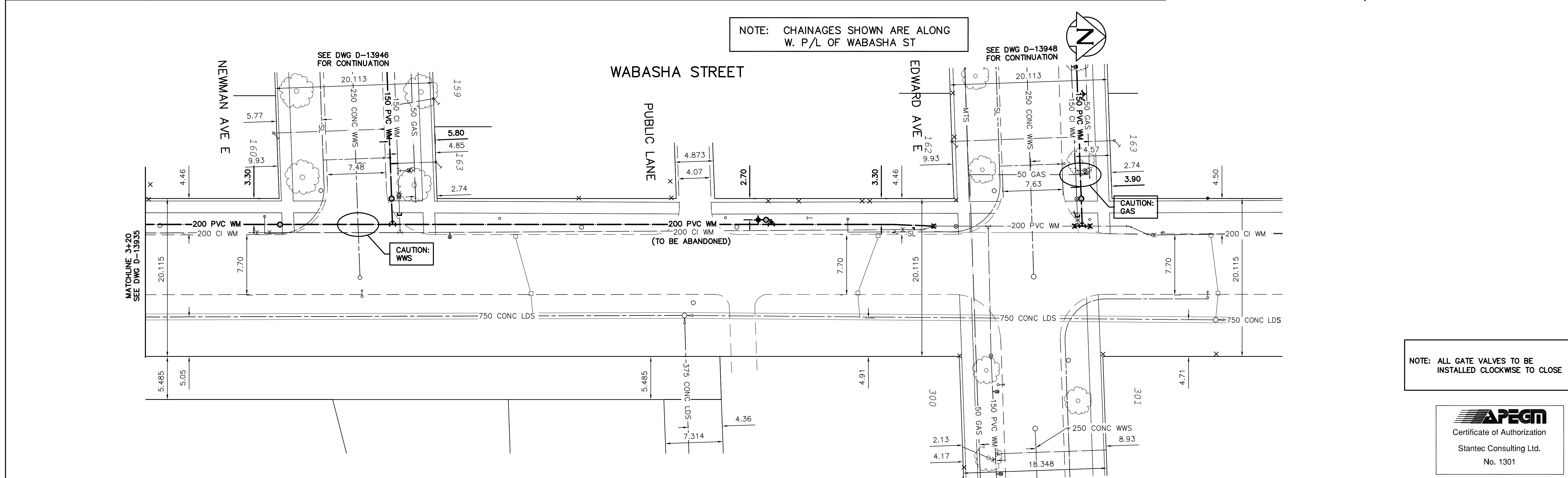

WARNING

IF POWER EQUIPMENT OR EXPLOSIVES ARE TO BE USED FOR EXCAVATION ON THIS PROJECT THE CONTRACTOR MUST:

- 1) NOTIFY THE GAS COMPANY OF THE PROPOSED LOCATION OF EXCAVATION.
- 2) TAKE PRECAUTION TO AVOID DAMAGE TO GAS COMPANY INSTALLATIONS.

SEE PROVINCIAL REGULATION 210/72 FOR DETAILS

LOCATION APPROVED
UNDERGROUND STRUCTURES

SUPV. U/G STRUCTURES COMMITTEE DATE

NOTE:
LOCATION OF UNDERGROUND STRUCTURES SHOWN ARE BASED ON THE BEST INFORMATION AVAILABLE BUT NO GUARANTEE IS GIVEN THAT ALL EXISTING UTILITIES ARE SHOWN OR THAT THE GIVEN LOCATIONS ARE EXACT. CONFIRMATION OF EXISTENCE AND EXACT LOCATION OF ALL SERVICES MUST BE OBTAINED FROM THE INDIVIDUAL UTILITIES BEFORE PROCEEDING WITH CONSTRUCTION.

B.M. 10-028 87482 - S.E. Cor. McMeane Ave. W. & Winona St., Tbt. on top of 0.05 m sq. x 2.4 m iron tube, 3.6 m W. of E.L. Winona St. & 5.0 m N. of S.L. McMeane Ave. W.
ELEV. 233.050m

CONSTRUCTION COMPLETION DATE: YYYY MM DD

NO.	ISSUED FOR TENDER	REVISIONS	DATE	BY
0	ISSUED FOR TENDER		15/03/25	J.C.

DESIGNED BY: J.H. CHECKED BY: J.C.
DRAWN BY: J.H. APPROVED BY: J.C.
SCALE: HORIZONTAL 1:250 VERTICAL 1:50
DATE: 2015 03 25

ENGINEER'S SEAL

CONSULTANT DRAWING NUMBER: C-204

THE CITY OF WINNIPEG
WATER AND WASTE DEPARTMENT
ENGINEERING DIVISION

2015 WATERMAIN RENEWALS
CONTRACT 2
WABASHA STREET
50>NNL HORTON AVENUE E TO
2 SSL OF EDWARD AVENUE E

SHEET 5 OF 17
CITY DRAWING NUMBER: D-13936