

WATER SERVICE INFORMATION					
ADDRESS	SIZE (mm) MATERIAL (STREET)	SIZE (mm) MATERIAL (PROP.)	SHORT & LONG MEASUREMENT	CORP. LOCATION	REMARKS
122 HORTON AV E	20	20	2.44 EWL OF HSE	-	RECONNECT SERVICE
RESIDENTIAL	-	CU	7.92 FROM HSE FRONT	-	-
123 HORTON AV E	-	-	1.52 EWL OF HSE	-	RECONNECT SERVICE
RESIDENTIAL	-	-	7.92 FROM HSE FRONT	-	-
124 HORTON AV E	20	20	2.01 WEL OF HSE	-	RECONNECT SERVICE
RESIDENTIAL	-	CU	7.62 FROM HSE FRONT	-	-
127 HORTON AV E	-	-	0.61 EWL OF HSE	-	RECONNECT SERVICE
RESIDENTIAL	-	-	8.53 FROM HSE FRONT	-	-
128 HORTON AV E	20	20	3.35 WEL OF HSE	-	RECONNECT SERVICE
RESIDENTIAL	-	CU	7.50 FROM HSE FRONT	-	-
129 HORTON AV E	-	-	2.44 EWL OF HSE	-	RECONNECT SERVICE
RESIDENTIAL	-	-	8.53 FROM HSE FRONT	-	-
130 HORTON AV E	20	20	4.57 EWL OF HSE	-	RECONNECT SERVICE
RESIDENTIAL	-	CU	5.49 E/WPL	-	-
131 HORTON AV E	-	-	3.96 EWL OF HSE	-	RECONNECT SERVICE
RESIDENTIAL	-	-	7.92 FROM HSE FRONT	-	-
134 HORTON AV E	-	-	2.13 EWL OF HSE	-	RECONNECT SERVICE
RESIDENTIAL	-	-	4.45 FROM HSE FRONT	-	-
135 HORTON AV E	-	-	0.61 EWL OF HSE	-	RECONNECT SERVICE
RESIDENTIAL	-	-	7.80 FROM HSE FRONT	-	-
136 HORTON AV E	-	-	-	-	RECONNECT SERVICE
RESIDENTIAL	-	-	-	-	-
137 HORTON AV E	-	-	1.22 EWL OF HSE	-	RECONNECT SERVICE
RESIDENTIAL	-	-	8.23 OUT	-	-
138 HORTON AV E	20	20	2.0 EWL OF HSE	-	RECONNECT SERVICE
RESIDENTIAL	-	CU	-	-	-
140 HORTON AV E	-	-	2.01 EWL OF HSE	-	RECONNECT SERVICE
RESIDENTIAL	-	-	7.80 FROM HSE FRONT	-	-
141 HORTON AV E	-	-	4.15 WEL OF HSE	7.01 FROM	RECONNECT SERVICE
RESIDENTIAL	-	-	1.83 EWL OF HSE	HSE FRONT	-
143 HORTON AV E	-	-	7.32 FROM HSE FRONT	-	RECONNECT SERVICE
RESIDENTIAL	-	-	-	-	-

NOTE: CHAINAGES SHOWN ARE ALONG N. P/L OF HORTON AV E

HORTON AVENUE EAST

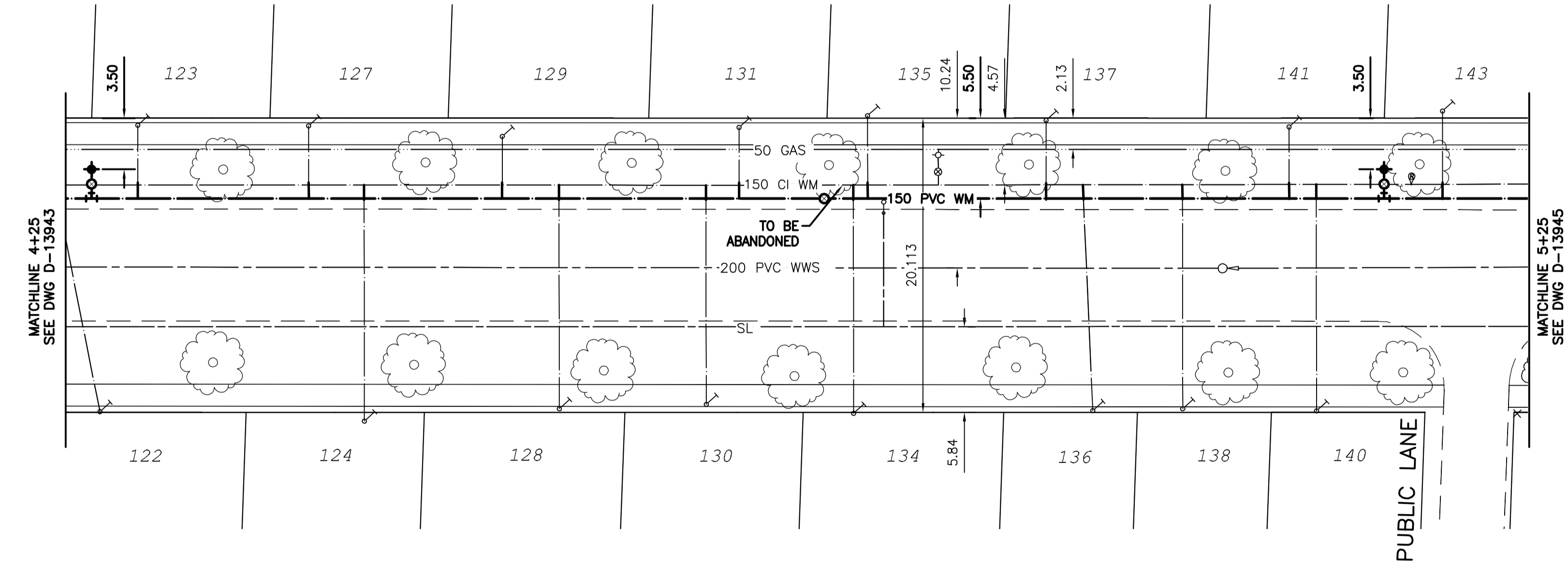
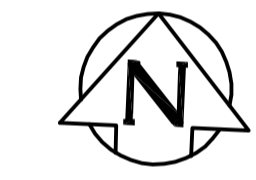

\*SERVICES TO BE RENEWED TO R. ALL OTHERS TO BE RECONNECTED

NOTE: ALL GATE VALVES TO BE INSTALLED CLOCKWISE TO CLOSE

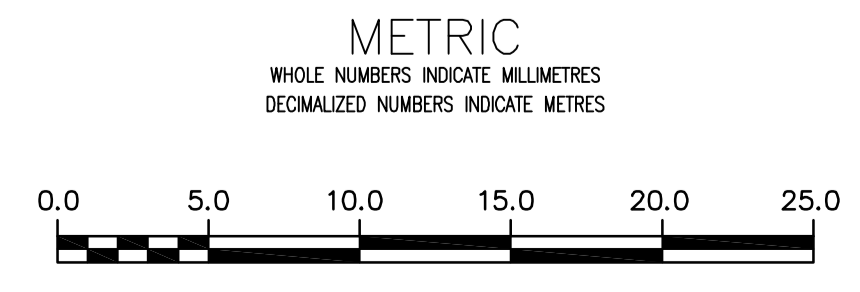

**WARNING**  
IF POWER EQUIPMENT OR EXPLOSIVES ARE TO BE USED FOR EXCAVATION ON THIS PROJECT THE CONTRACTOR MUST:  
1) NOTIFY THE GAS COMPANY OF THE PROPOSED LOCATION OF EXCAVATION.  
2) TAKE PRECAUTION TO AVOID DAMAGE TO GAS COMPANY INSTALLATIONS.  
SEE PROVINCIAL REGULATION 21072 FOR DETAILS

**LOCATION APPROVED**  
UNDERGROUND STRUCTURES  
SUPV. U/G STRUCTURES COMMITTEE DATE  
NOTE:  
LOCATION OF UNDERGROUND STRUCTURES AS SHOWN ARE BASED ON THE BEST INFORMATION AVAILABLE BUT NO GUARANTEE IS GIVEN THAT ALL EXISTING UTILITIES ARE SHOWN OR THAT THE GIVEN LOCATIONS ARE EXACT. CONFIRMATION OF EXISTENCE AND EXACT LOCATION OF ALL SERVICES MUST BE OBTAINED FROM THE INDIVIDUAL UTILITIES BEFORE PROCEEDING WITH CONSTRUCTION.

B.M. 10-028 ELEV. 233.050m	879482 - S.E. Cor. McMeane Ave. W. & Winona St., Tbt. on top of 0.05 m sq x 2.4 m iron tube, 3.6 m W. of E.L. Winona St. & 5.0 m N. of S.L. McMeane Ave. W.		
CONSTRUCTION COMPLETION DATE: YYYY MM DD			
0	ISSUED FOR TENDER	15/03/25	J.C.
NO.	REVISIONS	DATE	BY

DESIGNED BY	J.H.	CHECKED BY	J.C.
DRAWN BY	J.H.	APPROVED BY	J.C.
SCALE:	HORIZONTAL 1:250		
	VERTICAL 1:50		
DATE	2015 03 25	DATE	

ENGINEER'S SEAL  
CONSULTANT DRAWING NUMBER  
C-212

**THE CITY OF WINNIPEG**  
WATER AND WASTE DEPARTMENT  
ENGINEERING DIVISION

2015 WATERMAIN RENEWALS  
CONTRACT 2  
HORTON AVENUE EAST  
112 EEL OF DAY STREET TO  
93 WWL OF WABASHA STEET

SHEET 13 OF 17  
CITY DRAWING NUMBER  
D-13944