

NOTE: CHAINAGES SHOWN ARE ALONG E. R. OF ISBISTER STREET

ISBISTER STREET

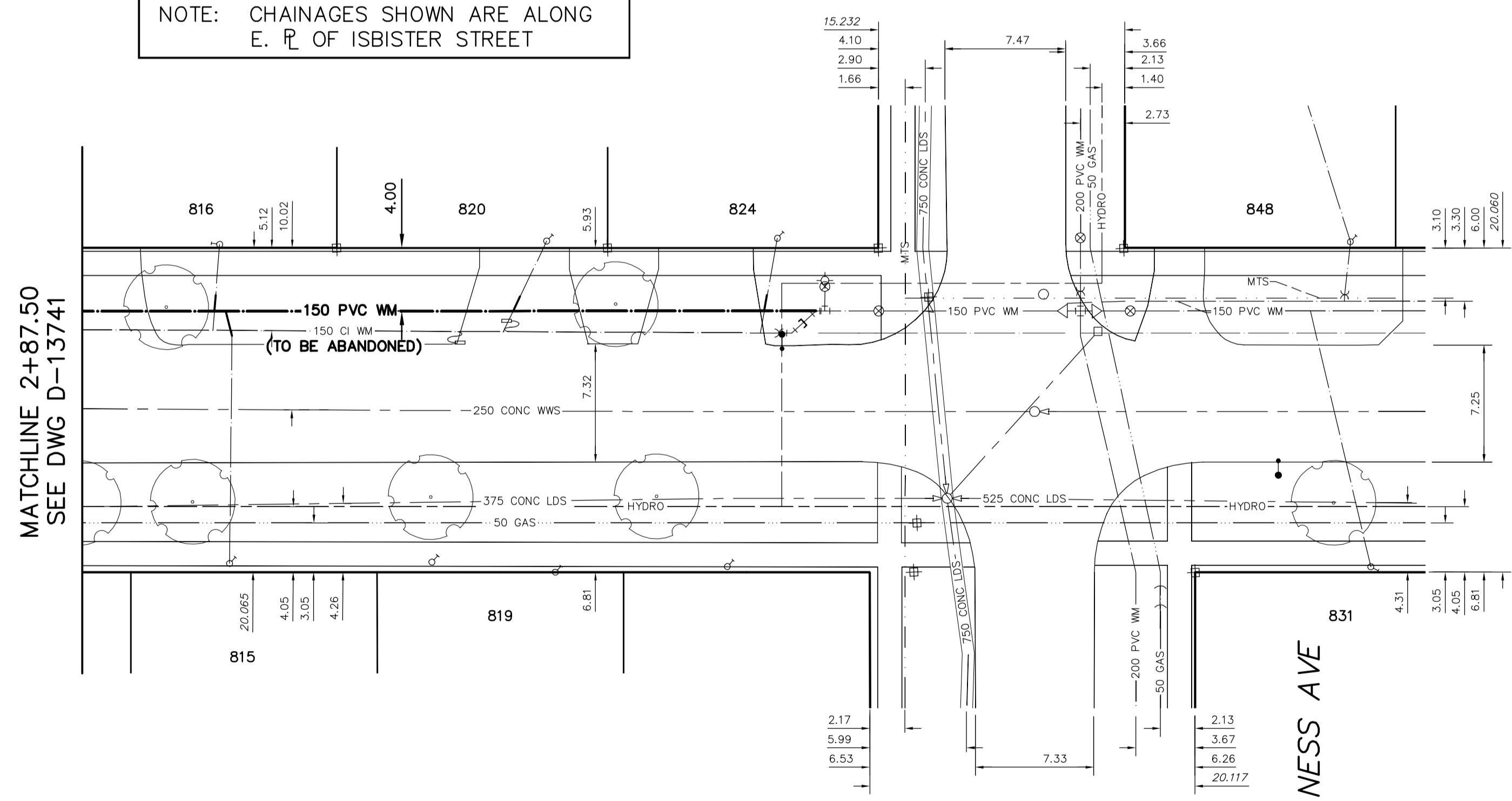

WATER SERVICE INFORMATION

ADDRESS	SIZE (mm) MATERIAL (STREET)	SIZE (mm) MATERIAL (PROP.)	SHORT & LONG MEASUREMENT	CORP. LOCATION	REMARKS
815 ISBISTER ST	20	20	4.66 NSL HSE	-	RECONNECT SERVICE
RESIDENTIAL	CU	CU	39.464 SSL NESS AVE	-	
816 ISBISTER ST	20	20	3.38 NSL HSE	0.5 S OF S/C	RECONNECT SERVICE
RESIDENTIAL	CU	CU	40.911 SSL NESS AVE	-	
819 ISBISTER ST	-	20	1.00 NSL HSE	-	RECONNECT SERVICE
RESIDENTIAL	-	CU	19.448 SSL NESS AVE	-	
820 ISBISTER ST	20	20	2.80 SNL HSE	2.1 S OF S/C	RECONNECT SERVICE
RESIDENTIAL	CU	CU	19.640 SSL NESS AVE	-	
824 ISBISTER ST	20	20	3.90 SNL HSE	1.2 S OF S/C	RECONNECT SERVICE
RESIDENTIAL	CU	CU	5.740 SSL NESS AVE	-	
3770 NESS AVE	-	-	9.1 S OF NSL HSE	-	RECONNECT SERVICE
RESIDENTIAL	-	-	8.800 SSL NESS AVE	-	

*SERVICES TO BE RENEWED TO R. ALL OTHERS TO BE RECONNECTED

FOR INDEX SEE DWG 13738

VALVES TO BE COUNTER-CLOCKWISE TO CLOSE (RED OPERATING NUT)

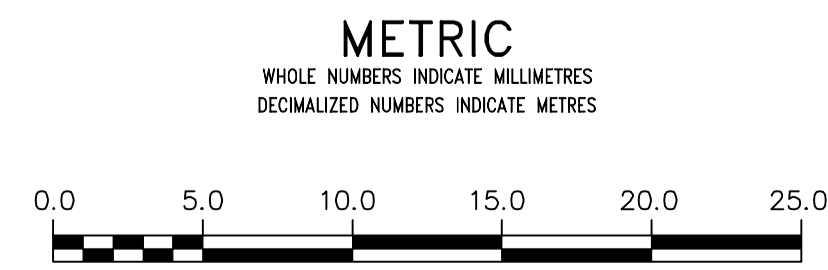

<p>WARNING</p> <p>IF POWER EQUIPMENT OR EXPLOSIVES ARE TO BE USED FOR EXCAVATION ON THIS PROJECT THE CONTRACTOR MUST:</p> <ol style="list-style-type: none"> 1) NOTIFY THE GAS COMPANY OF THE PROPOSED LOCATION OF EXCAVATION. 2) TAKE PRECAUTION TO AVOID DAMAGE TO GAS COMPANY INSTALLATIONS. <p>SEE PROVINCIAL REGULATION 210/72 FOR DETAILS</p>	<p>LOCATION APPROVED UNDERGROUND STRUCTURES</p> <p>SUPV. U/G STRUCTURES COMMITTEE DATE</p> <p>NOTE: LOCATION OF UNDERGROUND STRUCTURES AS SHOWN ARE BASED ON THE BEST INFORMATION AVAILABLE BUT NO GUARANTEE IS GIVEN THAT ALL EXISTING UTILITIES ARE SHOWN OR THAT THE GIVEN LOCATIONS ARE EXACT. CONFIRMATION OF EXISTENCE AND EXACT LOCATION OF ALL SERVICES MUST BE OBTAINED FROM THE INDIVIDUAL UTILITIES BEFORE PROCEEDING WITH CONSTRUCTION.</p>	<p>B.M. ELEV.</p> <p>CONSTRUCTION COMPLETION DATE: YYYY MM DD</p>	<p>ENGINEER'S SEAL</p> <p>ORIGINAL SIGNED BY S.J.R. COUNROYER 15/03/13</p>	<p>DESIGNED BY TS</p> <p>CHECKED BY SC</p> <p>DRAWN BY RS</p> <p>APPROVED BY KZ</p> <p>SCALE: HORIZONTAL 1:250 VERTICAL 1:50</p> <p>RELEASED FOR CONSTRUCTION DATE</p>	<p>2015 WATERMAIN RENEWALS</p> <p>ISBISTER STREET</p> <p>185 N OF FAIRLANE AVENUE (N R) TO NESS AVENUE</p>	<p>SHEET 5 OF 11</p> <p>CITY DRAWING NUMBER</p> <p>D-13742</p>			
							<p>SEE PROVINCIAL REGULATION 210/72 FOR DETAILS</p>	<p>NO. REVISIONS DATE BY</p>	<p>CONSULTANT DRAWING NUMBER</p>
							<p>PLAT DATE: 2015 03 13</p>	<p>BID OPPORTUNITY: 258-2015 CONTRACT NUMBER: 11</p>	<p>FILE PATH: R:\DRAWINGS\WATER\RENEWAL\2015 RENEWAL\CONTRACT 11\ ISBISTER.dwg</p>