

NOTE: CHAINAGES SHOWN ARE ALONG E. R. OF SPRUCE ST

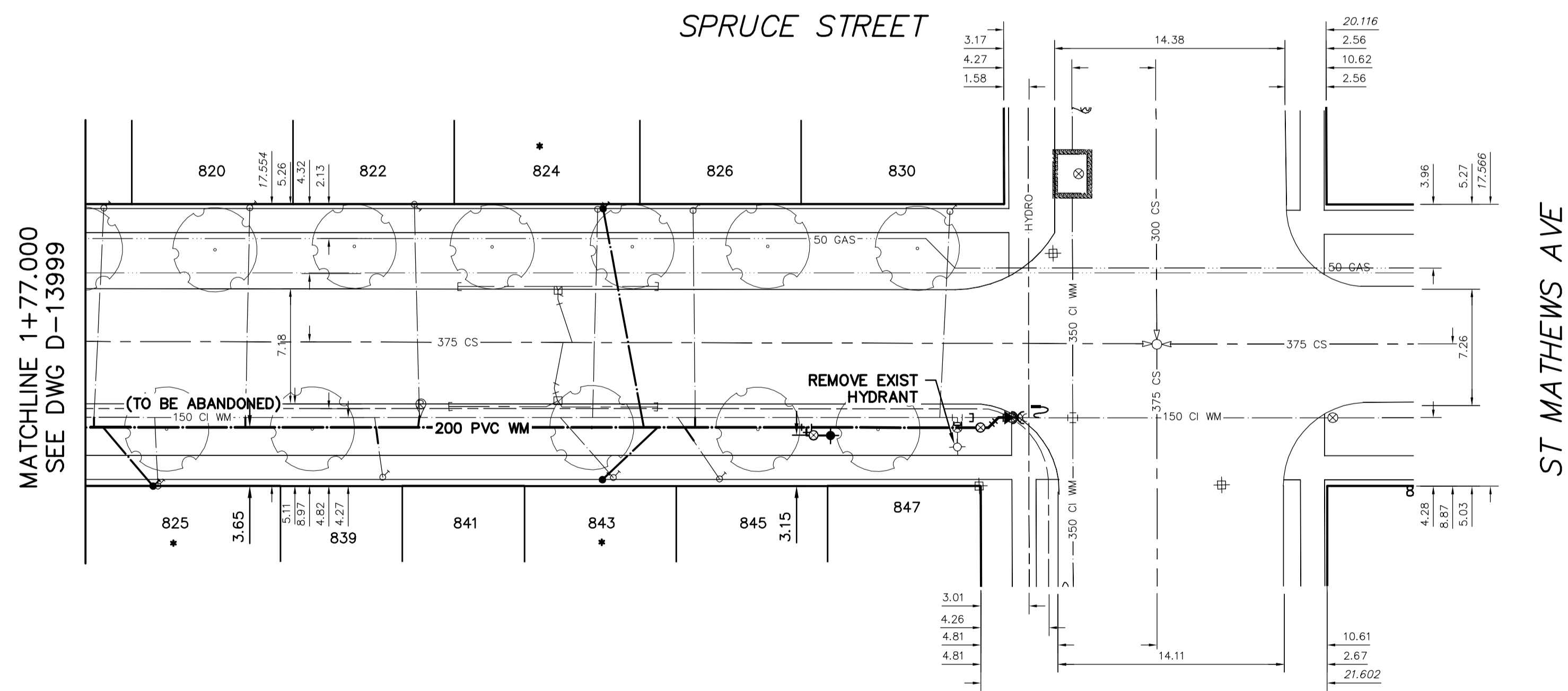

**WATER SERVICE INFORMATION**

ADDRESS	SIZE (mm) MATERIAL (STREET)	SIZE (mm) MATERIAL (PROP.)	SHORT & LONG MEASUREMENT	CORP. LOCATION	REMARKS
818 SPRUCE ST RESIDENTIAL	12 CU	12 LEAD	0.80 SNL HSE	0.7 S OF S/C	RECONNECT SERVICE
820 SPRUCE ST RESIDENTIAL	20 CU	20 CU	5.57 NSL HSE	0.3 S OF S/C	RECONNECT SERVICE
822 SPRUCE ST RESIDENTIAL	12 CU	20 CU	47.472 SSL ST MATHEWS AVE	0.3 S OF S/C	RECONNECT SERVICE
824 SPRUCE ST RESIDENTIAL	12 CU	12 LEAD	1.71 SNL HSE	0.3 S OF S/C	RECONNECT SERVICE
824 SPRUCE ST RESIDENTIAL	12 CU	12 LEAD	36.773 SSL ST MATHEWS AVE	0.3 S OF S/C	RENEW SERVICE TO PL W/20 CU
825 SPRUCE ST RESIDENTIAL	20 CU	20 CU	25.294 SSL ST MATHEWS AVE	0.3 S OF S/C	RENEW SERVICE TO PL W/20 CU
826 SPRUCE ST RESIDENTIAL	20 CU	20 CU	2.67 NSL HSE	OPP OF S/C	RECONNECT SERVICE
826 SPRUCE ST RESIDENTIAL	20 CU	20 CU	52.643 SSL ST MATHEWS AVE	OPP OF S/C	RECONNECT SERVICE
830 SPRUCE ST RESIDENTIAL	20 CU	20 CU	1.7 NSL HSE	OPP OF S/C	RECONNECT SERVICE
830 SPRUCE ST RESIDENTIAL	20 CU	20 CU	19.389 SSL ST MATHEWS AVE	OPP OF S/C	RECONNECT SERVICE
839 SPRUCE ST RESIDENTIAL	20 CU	20 CU	2.91 SNL HSE	0.7 S OF S/C	RECONNECT SERVICE
841 SPRUCE ST RESIDENTIAL	20 CU	20 CU	2.81 SSL ST MATHEWS AVE	0.4 S OF S/C	RECONNECT SERVICE
841 SPRUCE ST RESIDENTIAL	20 CU	20 CU	38.932 SSL ST MATHEWS AVE	0.4 S OF S/C	WYED W/843
843 SPRUCE ST RESIDENTIAL	12 CU	12 LEAD	2.33 SNL HSE	0.4 S OF S/C	RECONNECT SERVICE
843 SPRUCE ST RESIDENTIAL	12 CU	12 LEAD	38.932 SSL ST MATHEWS AVE	0.4 S OF S/C	WYED W/843
845 SPRUCE ST RESIDENTIAL	20 CU	20 CU	3.14 SNL HSE	3.3 S OF S/C	RENEW SERVICE TO PL W/20 CU
847 SPRUCE ST RESIDENTIAL	12 CU	12 LEAD	24.322 SSL ST MATHEWS AVE	0.4 S OF S/C	RECONNECT SERVICE
847 SPRUCE ST RESIDENTIAL	12 CU	12 LEAD	1.02 NSL HSE	2.6 S OF S/C	RECONNECT SERVICE
847 SPRUCE ST RESIDENTIAL	12 CU	12 LEAD	17.734 SSL ST MATHEWS AVE	2.6 S OF S/C	RECONNECT SERVICE
847 SPRUCE ST RESIDENTIAL	12 CU	12 LEAD	9.10 EWL HSE	OPP OF S/C	SERVICED OF ST MATHEWS AVE OUTSIDE LIMITS
847 SPRUCE ST RESIDENTIAL	12 CU	12 LEAD	16.343 EEL SPRUCE ST	OPP OF S/C	SERVICED OF ST MATHEWS AVE OUTSIDE LIMITS

\* SERVICES TO BE RENEWED TO PL ALL OTHERS TO BE RECONNECTED

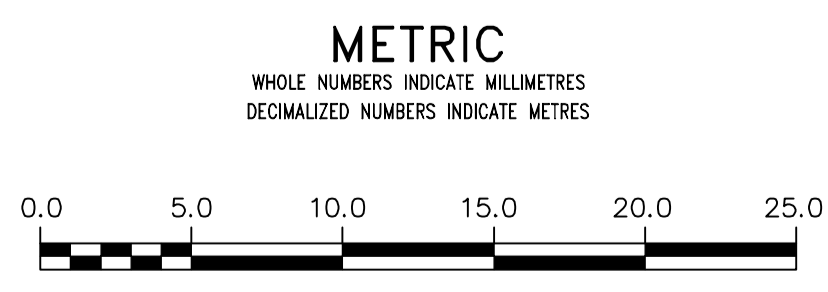

**WARNING**  
IF POWER EQUIPMENT OR EXPLOSIVES ARE TO BE USED FOR EXCAVATION ON THIS PROJECT THE CONTRACTOR MUST:  
1) NOTIFY THE GAS COMPANY OF THE PROPOSED LOCATION OF EXCAVATION.  
2) TAKE PRECAUTION TO AVOID DAMAGE TO GAS COMPANY INSTALLATIONS.  
SEE PROVINCIAL REGULATION 21072 FOR DETAILS

**LOCATION APPROVED UNDERGROUND STRUCTURES**  
SUPV. U/G STRUCTURES COMMITTEE DATE  
NOTE: LOCATION OF UNDERGROUND STRUCTURES AS SHOWN ARE BASED ON THE BEST INFORMATION AVAILABLE BUT NO GUARANTEE IS GIVEN THAT ALL LOCATIONS ARE EXACT. CONFIRMATION OF EXISTENCE AND EXACT LOCATION OF ALL UTILITIES MUST BE OBTAINED FROM THE INDIVIDUAL UTILITIES BEFORE PROCEEDING WITH CONSTRUCTION.

B.M. ELEV.	CONSTRUCTION COMPLETION DATE: YYYY MM DD
NO.	REVISIONS
DATE	BY

DESIGNED BY: MJK	CHECKED BY: SC
DRAWN BY: RS	APPROVED BY: KZ
SCALE: HORIZONTAL 1:250 VERTICAL 1:50	RELEASED FOR CONSTRUCTION
DATE: 2015 05 07	DATE

ENGINEER'S SEAL  
ORIGINAL SIGNED BY S.R.J. COURNOYER  
15/05/07  
CONSULTANT DRAWING NUMBER

**THE CITY OF WINNIPEG**  
WATER AND WASTE DEPARTMENT  
ENGINEERING DIVISION  
2015 WATERMAIN RENEWALS  
SPRUCE STREET  
78 N O F FELIX AVENUE TO ST MATHEWS AVENUE  
SHEET 8 OF 10  
CITY DRAWING NUMBER D-14000

FOR INDEX SEE D-13993 VALVES COUNTER-CLOCKWISE TO CLOSE (RED OPERATING NUT)