

TYPICAL SECTION
SCALE: H - 1:50 V - 1:25

QUANTITY NOTES:

1. APPROXIMATE JOINTS AND SLABS TO BE RENEWED: 760 m²
2. APPROXIMATE SIDEWALK TO BE RENEWED: 1580 m²
3. APPROXIMATE CURB TO BE RENEWED: 350 m
4. AVERAGING PLANING THICKNESS: 50 mm
5. AVERAGE ASPHALT REPLACEMENT THICKNESS: 70 mm
6. APPROXIMATE PROJECT AREA: 20335 m²

CONSTRUCTION NOTES:

1. LEGAL PLAN AND UNDERGROUND INFORMATION FROM CITY OF WINNIPEG LBIS. CONTRACTOR TO VERIFY ALL UNDERGROUNDS IN THE FIELD.
2. CONTRACTOR SHALL TAKE PRECAUTIONARY STEPS TO AVOID DAMAGE FROM CONSTRUCTION ACTIVITIES TO TREES WITHIN THE LIMITS OF CONSTRUCTION.
3. LOCATION OF EXISTING SERVICES TO BE CONFIRMED IN THE FIELD BY THE CONTRACTOR.
4. INSTALL CB LEADS AT MIN. 1.0% SLOPE OR AS DIRECTED BY CONTRACT ADMINISTRATOR.
5. LIMITS OF SIDEWALK RENEWAL TO BE DETERMINED IN THE FIELD BY THE CONTRACT ADMINISTRATOR.
6. LIMITS OF BOULEVARD GRADING TO BE DETERMINED IN THE FIELD BY THE CONTRACT ADMINISTRATOR.
7. TIE-INS TO BE VERIFIED IN THE FIELD BY THE CONTRACT ADMINISTRATOR.
8. JOINT, SLAB, CURB AND SIDEWALK REPAIRS TO BE MARKED OUT IN THE FIELD BY THE CONTRACT ADMINISTRATOR.
9. CONTRACTOR RESPONSIBLE FOR ALL BARRICADES AND SIGNAGE EXCEPT FOR REGULATORY (EG. NO LEFT TURNS) SUPPLIED BY TRAFFIC SERVICES BRANCH.

METRIC

WHOLE NUMBERS INDICATE MILLIMETRES
DECIMALIZED NUMBERS INDICATE METRES

WARNING

- IF POWER EQUIPMENT OR EXPLOSIVES USED FOR EXCAVATION ON THIS PROJECT THE CONTRACTOR:
1. NOTIFIED THE GAS COMPANY OF THE PROPOSED LOCATION OF EXCAVATION.
 2. TOOK PRECAUTION TO AVOID DAMAGE TO GAS COMPANY INSTALLATIONS SEE PROVINCIAL REGULATION 210/72 FOR DETAILS.
 3. OBTAINED EXCAVATION PERMITS PRIOR TO CONSTRUCTION.

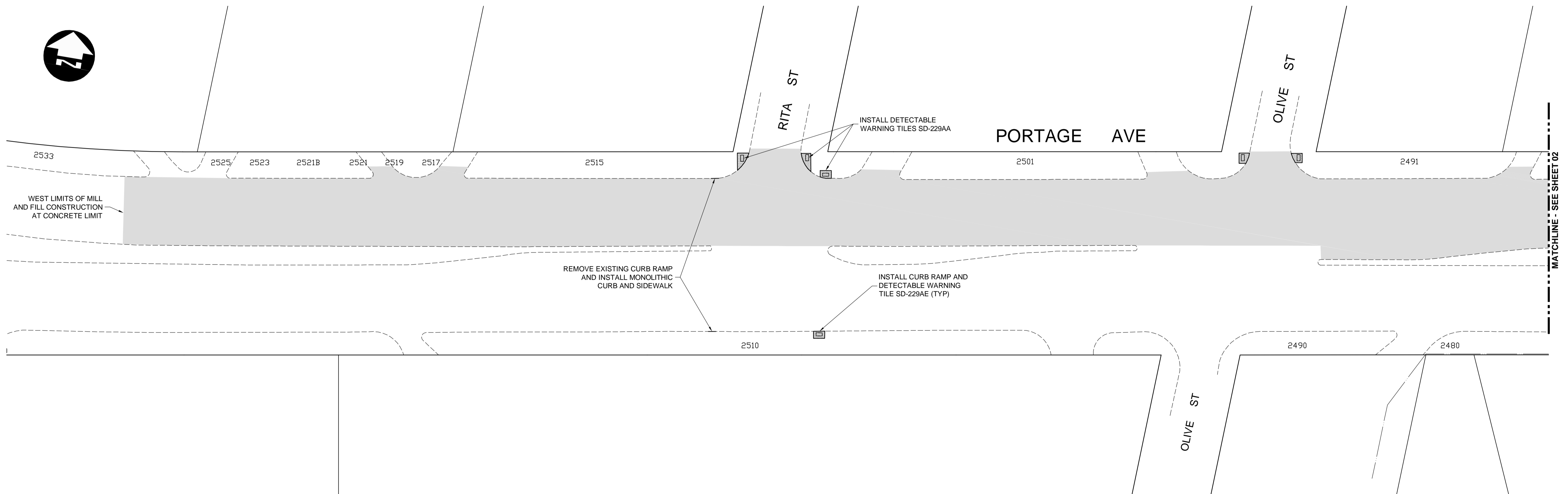

APEGM
Certificate of Authorization
Dillon Consulting Limited (MB)
No. 1789 Date: 04/17/2015

150 WM	WATERMAIN	150 WM	HYDRO	HYDRO	150 WM	WATERMAIN	150 WM	UNDERGROUND STRUCTURES	B.M. ELEV.	DESIGNED BY	AMC		ENGINEER'S SEAL			<p>PORTAGE AVENUE WESTBOUND MILL & FILL</p>	CITY DRAWING NUMBER						
300 LDS	LAND DRAINAGE SEWER	300 LDS	LAND DRAINAGE SEWER	300 LDS	LAND DRAINAGE SEWER	300 LDS	NO. REVISIONS	DATE	BY	DATE	DATE		DATE				DATE	CONSULTANT PROJECT NUMBER	2491 TO 2533 PORTAGE AVENUE WESTBOUND	SHEET	01	OF	05
250 WWS	WASTE WATER SEWER	250 WWS	WASTE WATER SEWER	250 WWS	WASTE WATER SEWER	250 WWS	DATE						15-1674										
100 GAS	GAS	100 GAS	GAS	100 GAS	GAS	100 GAS																	

G:\CAD\151674\Drawings and Figures\Contract\151674-02-COIN-Portage-Mill-Fill.dwg