

TYPICAL SECTION
SCALE: H - 1:50 V - 1:25

QUANTITY NOTES:

1. APPROXIMATE JOINTS AND SLABS TO BE RENEWED: 760 m²
2. APPROXIMATE SIDEWALK TO BE RENEWED: 1580 m²
3. APPROXIMATE CURB TO BE RENEWED: 350 m
4. AVERAGING PLANING THICKNESS: 50 mm
5. AVERAGE ASPHALT REPLACEMENT THICKNESS: 70 mm
6. APPROXIMATE PROJECT AREA: 20335 m²

CONSTRUCTION NOTES:

1. LEGAL PLAN AND UNDERGROUND INFORMATION FROM CITY OF WINNIPEG LBIS. CONTRACTOR TO VERIFY ALL UNDERGROUNDS IN THE FIELD.
2. CONTRACTOR SHALL TAKE PRECAUTIONARY STEPS TO AVOID DAMAGE FROM CONSTRUCTION ACTIVITIES TO TREES WITHIN THE LIMITS OF CONSTRUCTION.
3. LOCATION OF EXISTING SERVICES TO BE CONFIRMED IN THE FIELD BY THE CONTRACTOR.
4. INSTALL CB LEADS AT MIN. 1.0% SLOPE OR AS DIRECTED BY CONTRACT ADMINISTRATOR.
5. LIMITS OF SIDEWALK RENEWAL TO BE DETERMINED IN THE FIELD BY THE CONTRACT ADMINISTRATOR.
6. LIMITS OF BOULEVARD GRADING TO BE DETERMINED IN THE FIELD BY THE CONTRACT ADMINISTRATOR.
7. TIE-INS TO BE VERIFIED IN THE FIELD BY THE CONTRACT ADMINISTRATOR.
8. JOINT, SLAB, CURB AND SIDEWALK REPAIRS TO BE MARKED OUT IN THE FIELD BY THE CONTRACT ADMINISTRATOR.
9. CONTRACTOR RESPONSIBLE FOR ALL BARRICADES AND SIGNAGE EXCEPT FOR REGULATORY (E.G. NO LEFT TURNS) SUPPLIED BY TRAFFIC SERVICES BRANCH.

METRIC

WHOLE NUMBERS INDICATE MILLIMETRES
DECIMALIZED NUMBERS INDICATE METRES

WARNING

- IF POWER EQUIPMENT OR EXPLOSIVES USED FOR EXCAVATION ON THIS PROJECT THE CONTRACTOR:
1. NOTIFIED THE GAS COMPANY OF THE PROPOSED LOCATION OF EXCAVATION.
 2. TOOK PRECAUTION TO AVOID DAMAGE TO GAS COMPANY INSTALLATIONS SEE PROVINCIAL REGULATION 210/72 FOR DETAILS.
 3. OBTAINED EXCAVATION PERMITS PRIOR TO CONSTRUCTION.

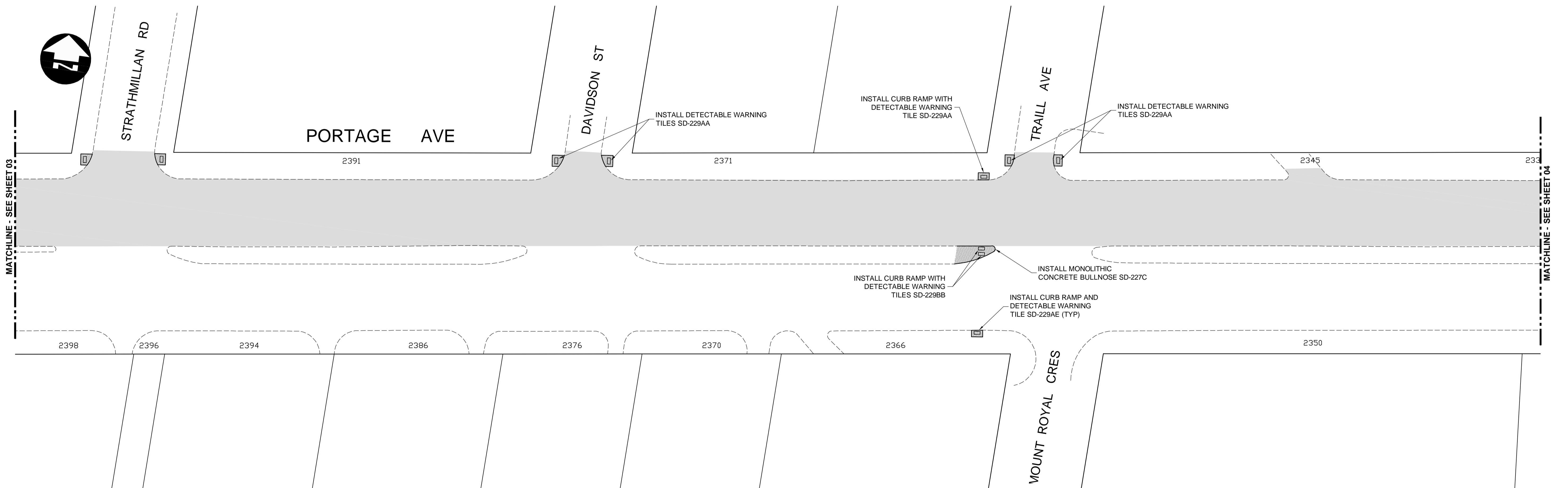

G:\CAD\151674\Drawings and Figures\Contract\151674-02-COIN-Portage-Mill-Fill.dwg

APEGM
Certificate of Authorization
Dillon Consulting Limited (MB)
No. 1789 Date: 04/17/2015

150 WM	WATERMAIN	150 WM	HYDRO	HYDRO	HYDRO	150 WM	WATERMAIN	150 WM
HYDRANT	HYDRANT VALVE	300 LDS	LAND DRAINAGE SEWER	250 WWS	WASTE WATER SEWER	300 LDS	LAND DRAINAGE SEWER	300 LDS
MANHOLE	CATCH BASIN	CURB INLET	JUNCTIONS	CULVERT	100 GAS	GAS	EXISTING	LEGEND-PLAN
PROPOSED	PROPOSED	PROPOSED	PROPOSED	PROPOSED	PROPOSED	PROPOSED	EXISTING	LEGEND-PROFILE

UNDERGROUND STRUCTURES

SUPV. U/G STRUCTURES DATE

LOCATION OF UNDERGROUND STRUCTURES AS SHOWN ARE BASED ON THE BEST INFORMATION AVAILABLE, BUT NO GUARANTEE IS GIVEN THAT ALL EXISTING UTILITIES ARE SHOWN OR THAT THE GIVEN LOCATIONS ARE EXACT. CONFIRMATION OF EXISTENCE AND EXACT LOCATION OF ALL SERVICES MUST BE OBTAINED FROM THE INDIVIDUAL UTILITIES BEFORE PROCEEDING WITH CONSTRUCTION.

B.M. ELEV.	NO.	REVISIONS	DATE	BY
	2	ISSUED FOR TENDER	04/17/15	TJP
	1	ISSUED FOR REVIEW	03/31/15	TJP

DESIGNED BY	AMC
DRAWN BY	TJH
CHECKED BY	TJP
APPROVED BY	DBW
HOR. SCALE	1:400
VERTICAL	-
DATE	04/17/2015

DILLON CONSULTING

RELEASED FOR CONSTRUCTION CONSTRUCTION

ENGINEER'S SEAL

PROVINCE OF MANITOBA
REGISTERED PROFESSIONAL ENGINEER
ORIGINAL STAMPED BY
T.J. PETERS
04/17/2015
Member
22309

CONSULTANT PROJECT NUMBER
15-1674

THE CITY OF WINNIPEG
PUBLIC WORKS DEPARTMENT

Winnipeg

PORTAGE AVENUE WESTBOUND
MILL & FILL

2345 TO 2391 PORTAGE AVENUE
WESTBOUND

CITY DRAWING NUMBER
SHEET 03 OF 05
CONSULTANT DRAWING NUMBER