

TYPICAL SECTION
SCALE: H - 1:50 V - 1:25

QUANTITY NOTES:

1. APPROXIMATE JOINTS AND SLABS TO BE RENEWED: 760 m²
2. APPROXIMATE SIDEWALK TO BE RENEWED: 1580 m²
3. APPROXIMATE CURB TO BE RENEWED: 350 m
4. AVERAGING PLANING THICKNESS: 50 mm
5. AVERAGE ASPHALT REPLACEMENT THICKNESS: 70 mm
6. APPROXIMATE PROJECT AREA: 20335 m²

CONSTRUCTION NOTES:

1. LEGAL PLAN AND UNDERGROUND INFORMATION FROM CITY OF WINNIPEG LBIS. CONTRACTOR TO VERIFY ALL UNDERGROUNDS IN THE FIELD.
2. CONTRACTOR SHALL TAKE PRECAUTIONARY STEPS TO AVOID DAMAGE FROM CONSTRUCTION ACTIVITIES TO TREES WITHIN THE LIMITS OF CONSTRUCTION.
3. LOCATION OF EXISTING SERVICES TO BE CONFIRMED IN THE FIELD BY THE CONTRACTOR.
4. INSTALL CB LEADS AT MIN. 1.0% SLOPE OR AS DIRECTED BY CONTRACT ADMINISTRATOR.
5. LIMITS OF SIDEWALK RENEWAL TO BE DETERMINED IN THE FIELD BY THE CONTRACT ADMINISTRATOR.
6. LIMITS OF BOULEVARD GRADING TO BE DETERMINED IN THE FIELD BY THE CONTRACT ADMINISTRATOR.
7. TIE-INS TO BE VERIFIED IN THE FIELD BY THE CONTRACT ADMINISTRATOR.
8. JOINT, SLAB, CURB AND SIDEWALK REPAIRS TO BE MARKED OUT IN THE FIELD BY THE CONTRACT ADMINISTRATOR.
9. CONTRACTOR RESPONSIBLE FOR ALL BARRICADES AND SIGNAGE EXCEPT FOR REGULATORY (E.G. NO LEFT TURNS) SUPPLIED BY TRAFFIC SERVICES BRANCH.

METRIC

WHOLE NUMBERS INDICATE MILLIMETRES
DECIMALIZED NUMBERS INDICATE METRES

WARNING

IF POWER EQUIPMENT OR EXPLOSIVES USED FOR EXCAVATION ON THIS PROJECT THE CONTRACTOR:

1. NOTIFIED THE GAS COMPANY OF THE PROPOSED LOCATION OF EXCAVATION.
2. TOOK PRECAUTION TO AVOID DAMAGE TO GAS COMPANY INSTALLATIONS SEE PROVINCIAL REGULATION 210/72 FOR DETAILS.
3. OBTAINED EXCAVATION PERMITS PRIOR TO CONSTRUCTION.

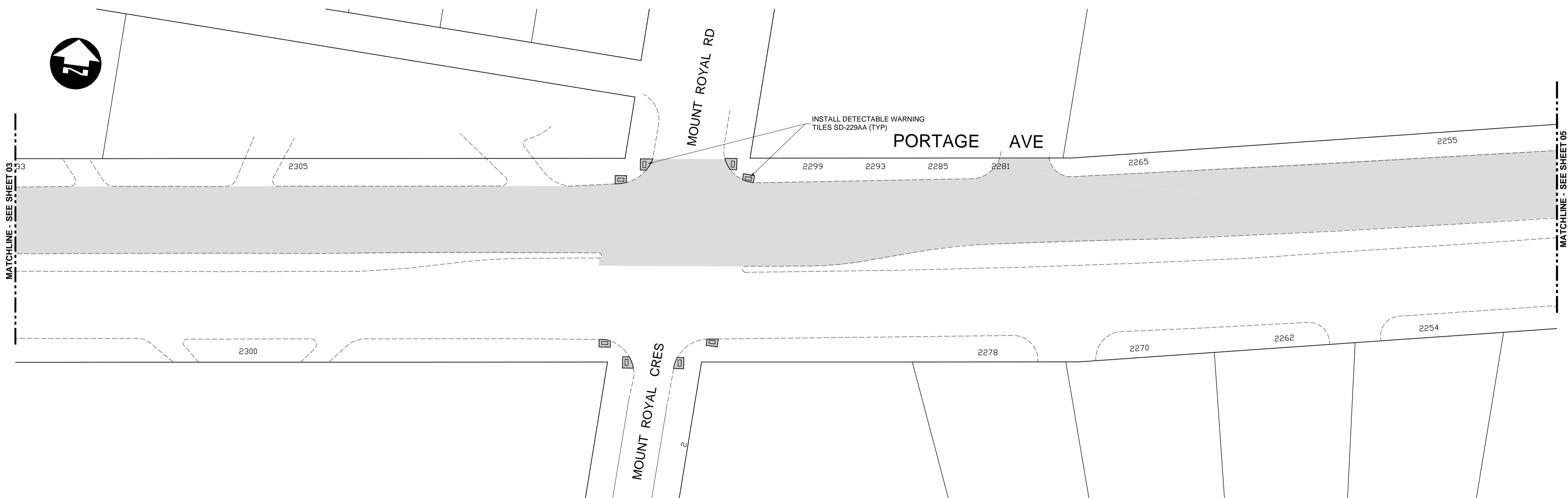

G:\CAD\151674\Drawings and Figures\Contract\151674-02-COIN-Portage-Mill-Fill.dwg

APEGM
Certificate of Authorization
Dillon Consulting Limited (MB)
No. 1789 Date: 04/17/2015

EXISTING	LEGEND-PLAN	PROPOSED	EXISTING	LEGEND-PLAN	PROPOSED	EXISTING	LEGEND-PROFILE	PROPOSED
	WATERMAIN			HYDRO			WATERMAIN	
	HYDRANT			M.T.S.			HYDRANT	
	VALVE			CONCRETE			VALVE	
	LAND DRAINAGE SEWER			ASPHALT			LAND DRAINAGE SEWER	
	WASTE WATER SEWER			PLANING			WASTE WATER SEWER	
	MANHOLE			SIDEWALK			C PROFILE	
	CATCH BASIN			PAVING STONES			NORTH/WEST GUTTER	
	CURB INLET			PARTIAL DEPTH REPAIR			SOUTH/EAST GUTTER	
	JUNCTIONS			PROPERTY LINE			NORTH/WEST DITCH	
	CULVERT			DRAINAGE ARROW			SOUTH/EAST DITCH	
	GAS			CURB RAMP				

UNDERGROUND STRUCTURES

SUPPLY	U/G STRUCTURES	DATE

LOCATION OF UNDERGROUND STRUCTURES AS SHOWN ARE BASED ON THE BEST INFORMATION AVAILABLE. BUT NO GUARANTEE IS GIVEN THAT ALL EXISTING UTILITIES ARE SHOWN OR THAT THE GIVEN LOCATIONS ARE EXACT. CONFIRMATION OF EXISTENCE AND EXACT LOCATION OF ALL SERVICES MUST BE OBTAINED FROM THE INDIVIDUAL UTILITIES BEFORE PROCEEDING WITH CONSTRUCTION.

B.M. ELEV.	DESIGNED BY	AMC
	DRAWN BY	TJH
	CHECKED BY	TJP
	APPROVED BY	DBW
	HOR. SCALE	1:400
	VERTICAL	-
	DATE	04/17/2015
	REVISIONS	

DESIGNED BY: AMC
DRAWN BY: TJH
CHECKED BY: TJP
APPROVED BY: DBW
HOR. SCALE: 1:400
VERTICAL: -
DATE: 04/17/2015

DILLON CONSULTING

ENGINEER'S SEAL
PROVINCE OF MANITOBA
REGISTERED PROFESSIONAL ENGINEER
T.J. PETERS
04/17/2015
Member 22309
CONSULTANT PROJECT NUMBER
15-1674

THE CITY OF WINNIPEG
PUBLIC WORKS DEPARTMENT
Winnipeg

PORTAGE AVENUE WESTBOUND
MILL & FILL

2255 TO 2333 PORTAGE AVENUE
WESTBOUND

CITY DRAWING NUMBER
SHEET 04 OF 05
CONSULTANT DRAWING NUMBER