

NOTE: ALL HARDWARE IS TO BE RATED FOR USE WITH ACQ PRESSURE TREATED LUMBER.

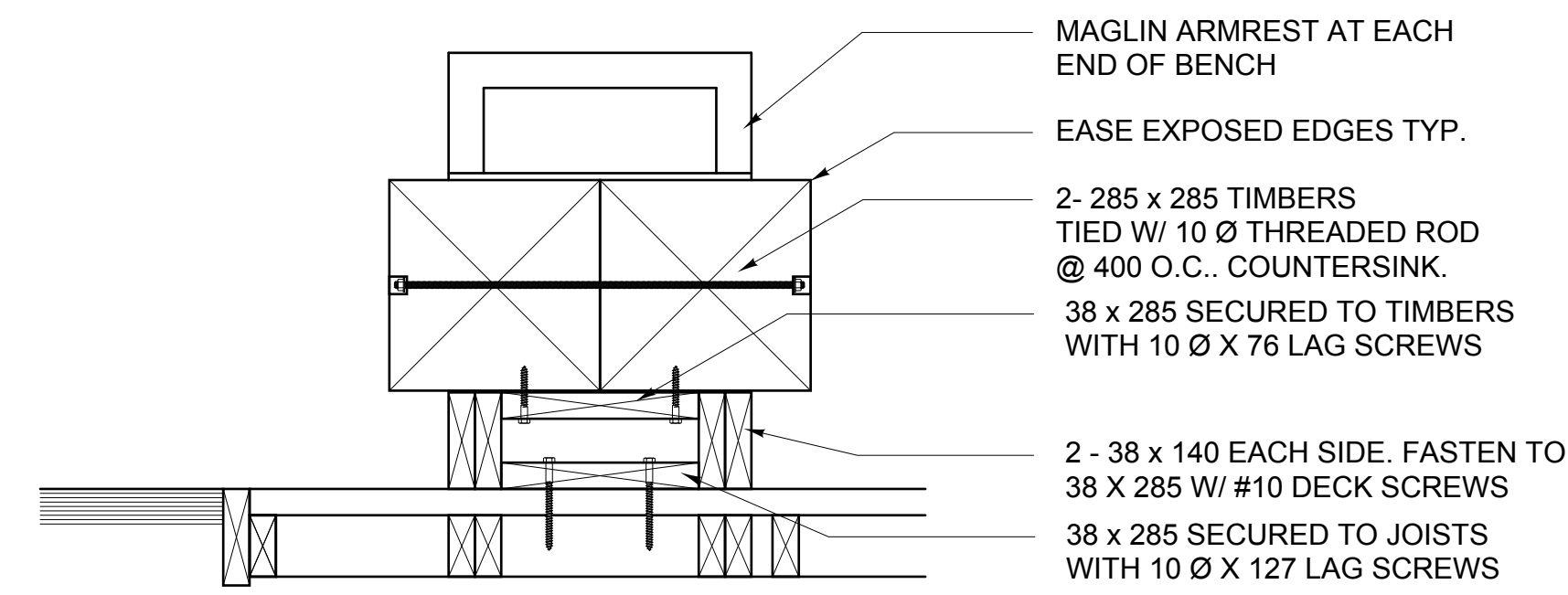

1 **TIMBER BENCH**
L1.4 1:10 @ ARCH D

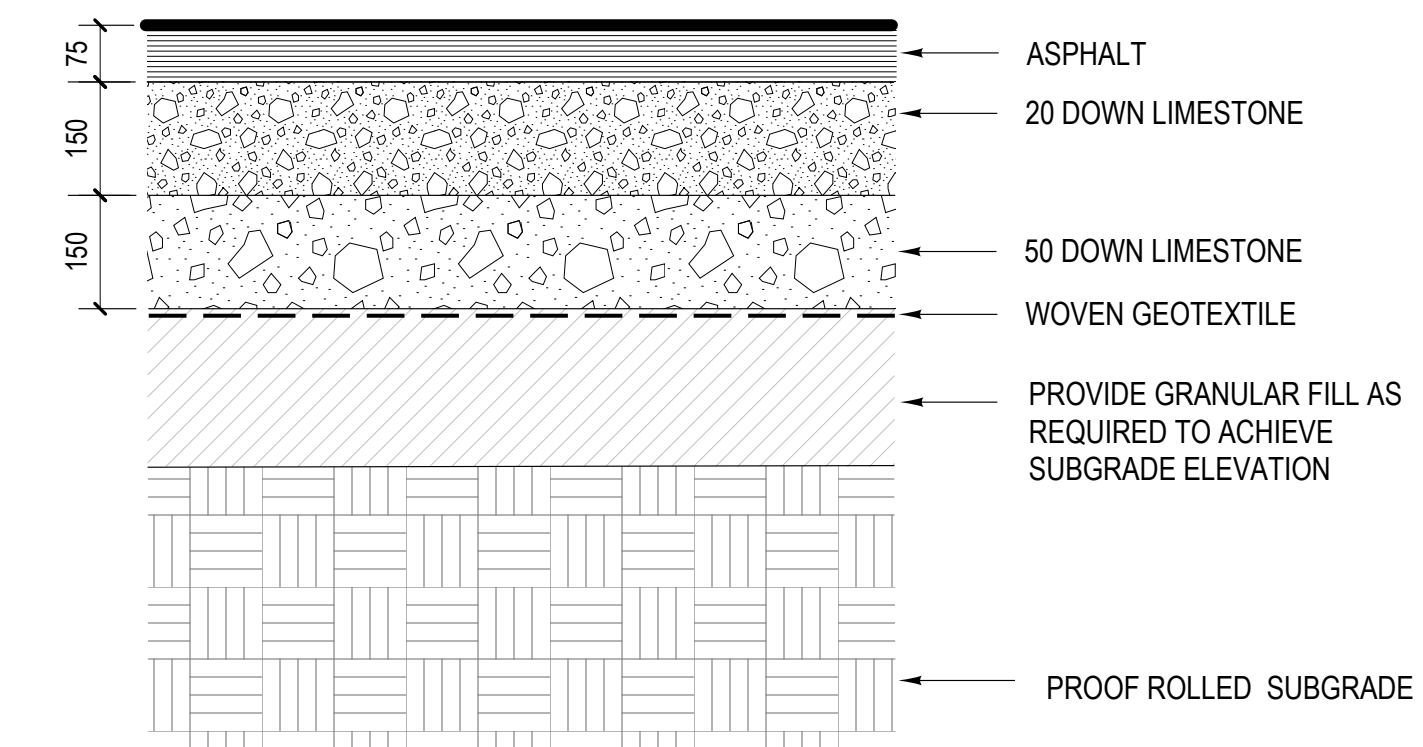
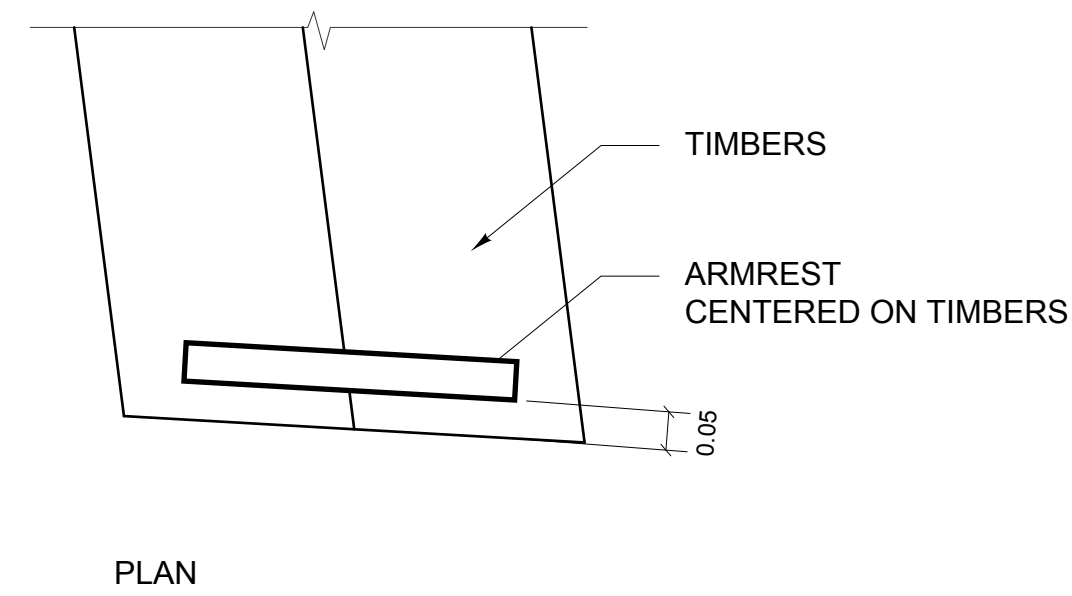

2 **TYPICAL ASPHALT PAVING**
L1.4 1:10 @ ARCH D

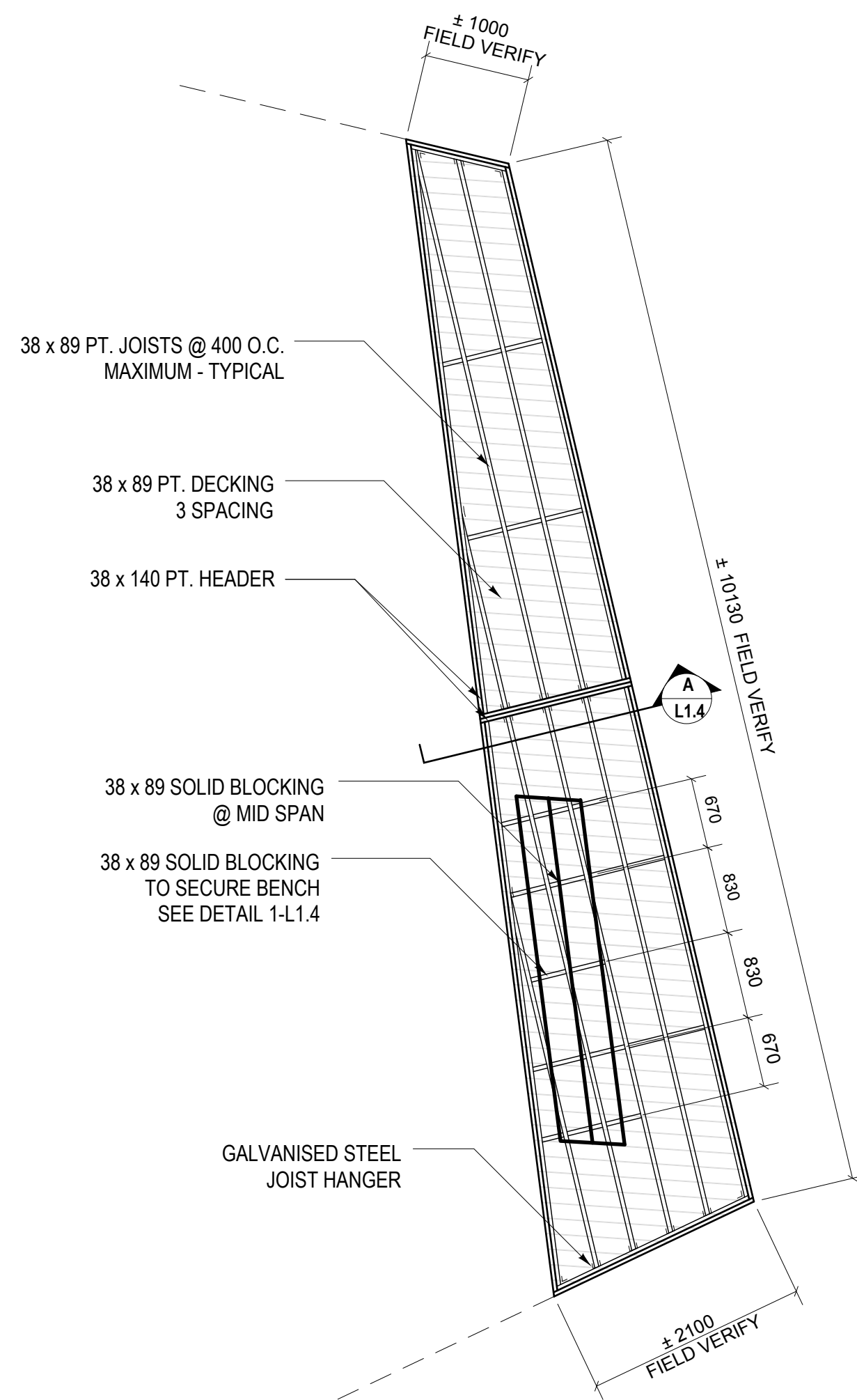

3 **DECK STRUCTURE**
L1.4 1:50 @ ARCH D

NOTE: ALL HARDWARE IS TO BE RATED FOR USE WITH ACQ PRESSURE TREATED LUMBER.

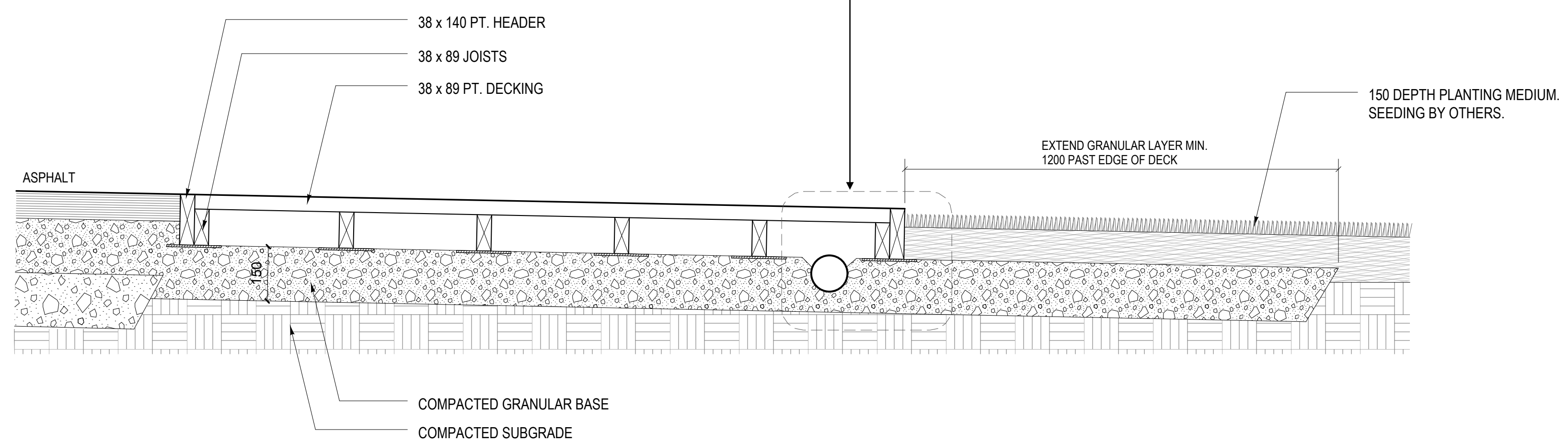

A **SECTION**
L1.4 1:10 @ ARCH D

NOTES

LEGEND

| | |
|-------------------------|----------------|
| ISSUED FOR CONSTRUCTION | JUNE 4, 2015 |
| FOR CLIENT REVIEW | MARCH 26, 2015 |
| ISSUE NOTES | DATE |

THIS DRAWING MUST NOT BE SCALED.
THE GENERAL CONTRACTOR SHALL VERIFY ALL DIMENSIONS, DATUMS AND LEVELS PRIOR TO COMMENCEMENT OF WORK. ALL ERRORS AND OMISSIONS TO BE REPORTED IMMEDIATELY TO THE LANDSCAPE ARCHITECT.
VARIATIONS & MODIFICATIONS TO WORK SHOWN ON THESE DRAWINGS SHALL NOT BE CARRIED OUT WITHOUT WRITTEN PERMISSION FROM THE LANDSCAPE ARCHITECT.
THIS DRAWING IS THE EXCLUSIVE PROPERTY OF THE LANDSCAPE ARCHITECTS AND CAN BE REPRODUCED ONLY WITH THE PERMISSION OF THE LANDSCAPE ARCHITECTS. IN WHICH CASE THE REPRODUCTION MUST BEAR THEIR NAME AS LANDSCAPE ARCHITECTS.

PROFESSIONAL SEALS



PROJECT TITLE

**ASSINIBOINE FOREST
POND OVERLOOK**
WINNIPEG, MANITOBA

SHEET TITLE

DETAILS

| | | |
|--|------------------------------|----------------------------|
| DRAWN AZ | REVIEWED GM | DRAWING NO. L1.4 |
| SCALE AS SHOWN | PROJECT No. 14-040 | |
| DATE PRINTED 5:08 PM Thu, Jun 4, 2015 | | |

