

1 Skate Pad Thickened Edge
D.42-E
Scale 1:10

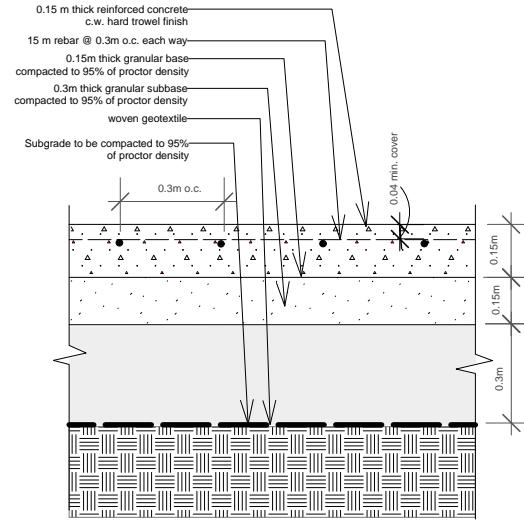

2 Poured in Place Skate Surface
D.42-E
Scale 1:10

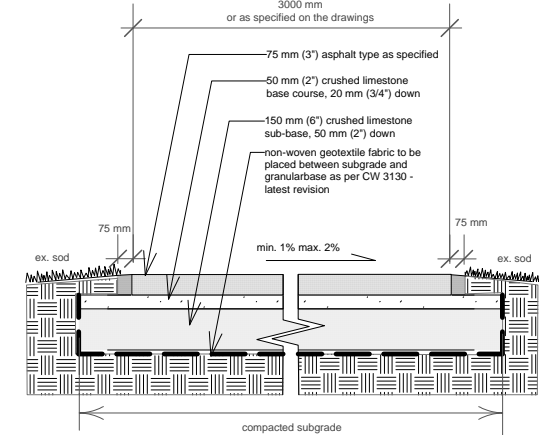

3 Parkway Path Asphalt
D.42-E
nts

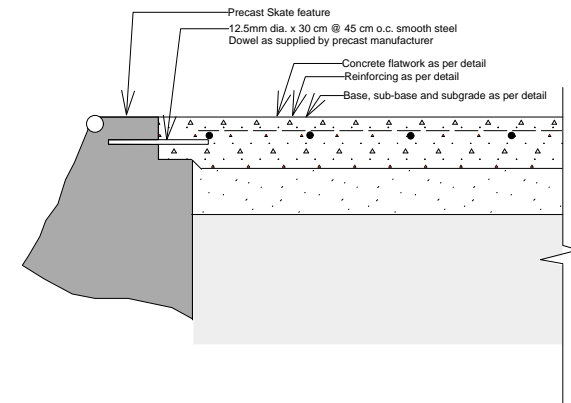

4 Skate Pad Top Shelf (Typ.)
D.42-E
Scale 1:10

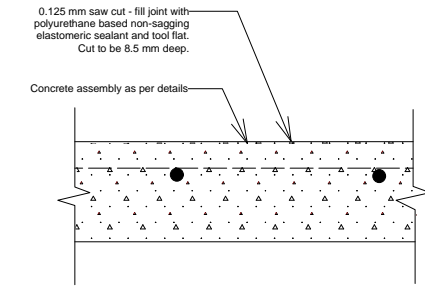

Sawcut

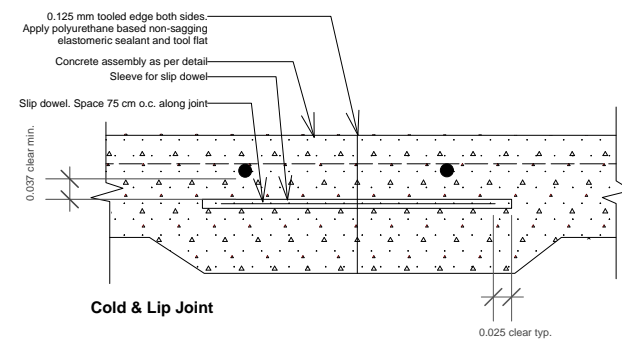

Cold & Lip Joint

5 Concrete Joints (Typ.)
D.42-E
Scale 1:5

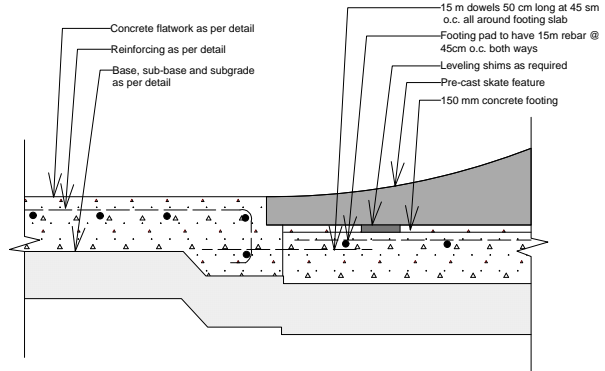

6 Skate Pad Feature Toe Connection (Typ.)
D.42-E
Scale 1:10

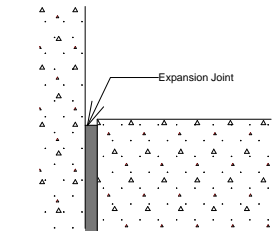

7 Cold Joint Non-Riding Surface
D.42-E
N.T.S.

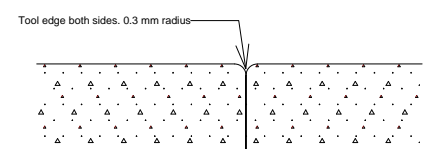

8 Cold Joint Riding Surface
D.42-E
N.T.S.

Concrete Notes:

1. Contractor to provide shop drawings showing all precast fixtures c.w. foundation pads and connection to flatwork slab as well as other fixtures and mounting details (eg. rails)
2. Concrete to be 32 mpa at 28 days
3. Maximum aggregate size 19 mm
4. Air Entraining 6-9%
5. All reinforcing steel to be epoxy-coated
6. Exposure class F1
7. Contractor to provide density testing of the sub-base and the granular base course. Results of testing to be sent directly from the testing lab to the Contract Administrator
8. Contractor to provide concrete testing as per CW Standard Specification

LOCATION OF UNDERGROUND STRUCTURES AS SHOWN ARE BASED ON THE BEST INFORMATION AVAILABLE BUT NO GUARANTEE IS GIVEN THAT ALL EXISTING UTILITIES ARE SHOWN OR THAT THE GIVEN LOCATIONS ARE EXACT. CONFIRMATION OF EXISTENCE AND EXACT LOCATION OF ALL SERVICES MUST BE OBTAINED FROM THE INDIVIDUAL UTILITIES BEFORE PROCEEDING WITH CONSTRUCTION.



THE CITY OF WINNIPEG
Planning, Property and Development Dept.
Planning and Land Use Division
15-30 Fort Street, Winnipeg, MB, (R3C 4X5)

| | | | |
|--------------|--------|--|-------------|
| DESIGNED BY | CH | CHECKED BY | APPROVED BY |
| DRAWN BY | CH | RELEASED FOR CONSTRUCTION | |
| HORIZ. SCALE | | | |
| VERT. SCALE | | | |
| DATE | May/15 | MANAGER, PLANNING AND LAND USE DIVISION | DATE |

| | |
|--|-----------------------|
| DRAWING TITLE | CAD DRAWING NO. |
| Dalhousie Park Skatepark Expansion 205 Killarney Ave. | |
| Details | DRAWING NO. D.42-E |