

NESS AVENUE - WHARTON TO SCHOOL
TYPICAL ROAD RECONSTRUCTION
 HOR 1 : 150, VER 1 : 75

MANHOLE WORK REQUIRED				
LOCATION	TYPE	RIM	NEW RIM	WORK REQUIRED
MH W 1	SD-10	235.813	235.788	ADJUST MH -0.025
MH W 2	SD-10	235.690	235.537	ADJUST MH -0.153
MH L 1	SD-11	235.455	230.489	ADJUST MH +0.034 REMOVE & REPLACE EXISTING 1200 DIM RISERS (3.48)

- CONSTRUCTION NOTES:**
- PLANE EXISTING ASPHALT AND CONSTRUCT NEW ASPHALTIC CONCRETE OVERLAY (AVERAGE THICKNESS 80mm).
 - CONSTRUCT NEW FULL DEPTH ASPHALTIC CONCRETE PAVEMENT.
 - REMOVE EXISTING SIDEWALK AND CONSTRUCT NEW 100mm CONCRETE SIDEWALK.
 - RENEW EXISTING BARRIER CURB (AVG 150mm REVEAL HEIGHT).
 - CONSTRUCT 10.0m x 3.0m NEW EXPOSED 230mm REINFORCED CONCRETE PAVEMENT.
 - RENEW EXISTING 100mm CONCRETE SIDEWALK.
 - INSTALL 150mm SUBDRAINS 6.0m ON EACH SIDE OF CATCHBASIN.
 - INSTALL NEW CURB AND GUTTER INLET C/W CATCHBASIN (SD-024) AND CONNECT NEW 250mm LEAD TO EXISTING LAND DRAINAGE SEWER.
 - INSTALL NEW DETECTABLE WARNING SURFACE TILES.
 - INSTALL NEW CURB AND GUTTER INLET C/W CATCHPIT (SD-023) AND CONNECT NEW 250mm LEAD TO EXISTING CATCHBASIN.
 - REPLACE COVER WITH SOLID COVER.
 - ADJUST MANHOLE TO GRADE.
 - RENEW EXISTING MODIFIED BARRIER CURB (AVG 100mm REVEAL HEIGHT).
 - INSTALL NEW CURB RAMP.
 - REMOVE EXISTING CATCHBASIN.
 - CONSTRUCT NEW MODIFIED BARRIER CURB AND GUTTER (180mm REVEAL HEIGHT).
 - CONSTRUCT NEW BARRIER CURB AND GUTTER (180mm REVEAL HEIGHT).
 - REMOVE EXISTING CATCHPIT.
 - ADJUST EXISTING WATERMAIN VALVE BOX TO GRADE.
 - REMOVE EXISTING CHAIN LINK FENCE.
 - INSTALL 1.22m HIGH CHAIN LINK FENCE.
 - REMOVE AND REPLACE EXISTING MANHOLE RISERS.
 - REMOVE EXISTING ENTRANCE MARKERS, SALVAGE SIGNAGE.
 - REMOVE TREE.
 - STREET LIGHTING TO BE RELOCATED BY OTHERS.
 - INSTALL NEW BOULEVARD CATCHBASIN (SD-025) AND CONNECT LEAD TO EXISTING MANHOLE.
 - RELOCATE MTS PEDESTAL (BY OTHERS)
 - REMOVE EXISTING PAVEMENT AND CONSTRUCT NEW 230mm REINFORCED CONCRETE PAVEMENT.
 - REMOVE TREE.
 - INSTALL NEW MANHOLE.
 - REMOVE AND REPLACE 8.0m OF WOOD FENCE.
 - REMOVE EXISTING FENCE, GRADE AND SOD YARD, CONSTRUCT NEW FENCE AND GATES, RECONSTRUCT PRIVATE SIDEWALK.
 - CONSTRUCT EXPOSED AGGREGATE CONCRETE.
 - INSTALL 100mm THICK CATCHBASIN SIDEWALL INSULATION.

- GENERAL NOTES:**
- PAVEMENT DIMENSIONS ARE TO BACK OF CURB.
 - CHAINAGE IS ALONG CENTRELINE OF NESS AVENUE PAVEMENT.

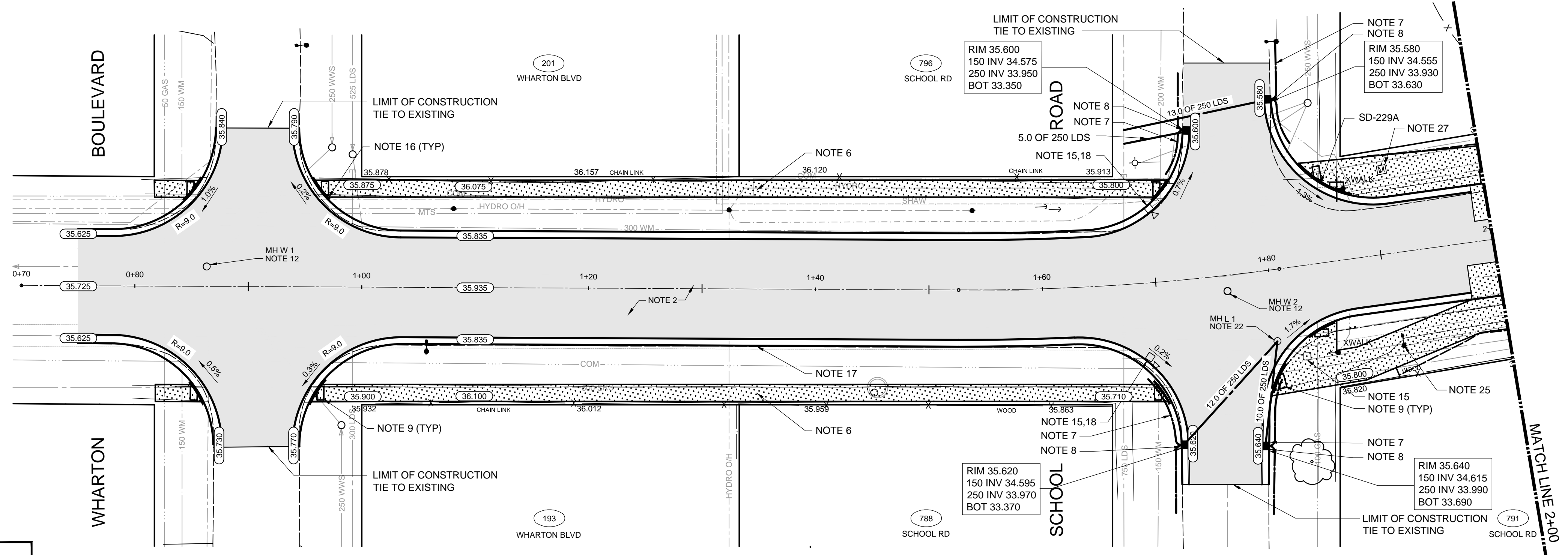
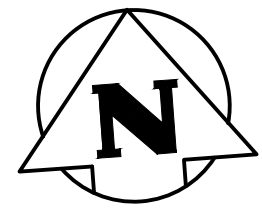

NESS AVENUE

WARNING
 IF POWER EQUIPMENT OR EXPLOSIVES ARE TO BE USED FOR EXCAVATION ON THIS PROJECT THE CONTRACTOR MUST:
 1. NOTIFY THE GAS COMPANY OF THE PROPOSED LOCATION OF EXCAVATION.
 2. TAKE PRECAUTION TO AVOID DAMAGE TO GAS COMPANY INSTALLATIONS. SEE PROVINCIAL REGULATION 1400/02 FOR DETAILS.

EXISTING	LEGEND-PLAN	PROPOSED	EXISTING	LEGEND-PLAN	PROPOSED	EXISTING	LEGEND-PLAN	PROPOSED
150 WM	WATERMAIN	150 WM	SWALE	RIGHT-OF-WAY	LOCATION APPROVED UNDERGROUND STRUCTURES	B.M. ELEV.		
400 FM	FEEDERMAIN	400 FM	MANHOLE	GAS	SUPV. U/G STRUCTURES COMMITTEE			
300 LDS	LAND DRAINAGE SEWER	300 LDS	CATCHBASIN	HYDRO	DATE			
250 WWS	WASTEWATER SEWER	250 WWS	HYDRO BOX	MTS	NOTE: LOCATION OF UNDERGROUND STRUCTURES AS SHOWN ARE BASED ON THE BEST INFORMATION AVAILABLE. BUT NO GUARANTEE IS GIVEN THAT ALL EXISTING UTILITIES ARE SHOWN OR THAT THE GIVEN LOCATIONS ARE EXACT. CONFIRMATION OF EXISTENCE AND EXACT LOCATION OF ALL SERVICES MUST BE OBTAINED FROM THE INDIVIDUAL UTILITIES BEFORE PROCEEDING WITH CONSTRUCTION.			
300 CS	COMBINED SEWER	300 CS	HYDRO POLE	DETECTABLE WARNING TILE				
200 FCM	FORCEMAIN	200 FCM	LIGHT STANDARD	ELEVATION				
	JUNCTIONS		ANCHOR	SIDEWALK				
	HYDRANT		TREE	CURB				
	VALVE		SURVEY BAR	ASPHALT				
	CURB STOP		SIGNAL CONTROLLER	CONCRETE				

DESIGNED BY	CHECKED BY	DATE
GAC	GAC	15.09.24
GMD	EPS	15.09.24
ACCEPTED BY DATE		
ORIGINAL DRAWING SIGNED BY: D.N. BURMEY, P.ENG. 15.09.24		
CONSULTANT DRAWING NO. 1400070800-DWG-C0049		

TETRA TECH

DESIGNED BY: GAC
 CHECKED BY: GAC
 DRAWN BY: GMD
 APPROVED BY: EPS
 HOR. SCALE: 1 : 250
 VERTICAL: 1 : 10
 DATE: 15.09.24

PROVINCE OF MANITOBA
G.A. CHURCHILL
 ORIGINAL SIGNED 15.09.24
 25653
 REGISTERED PROFESSIONAL ENGINEER

THE CITY OF WINNIPEG
 PUBLIC WORKS DEPARTMENT
 ENGINEERING DIVISION

NESS AVENUE AT STURGEON CREEK BRIDGE CONSTRUCTION

NESS AVENUE RECONSTRUCTION
 WHARTON AVENUE TO 12m EAST OF SCHOOL ROAD
 STATION 0+75 TO STATION 2+00

CITY DRAWING NUMBER: P-3465-15-002
 SHEET 49 OF 64

APEGM
 Certificate of Authorization
TETRA TECH WEI Inc.
 No. 5313 Date: April 30, 2016