

**NOTES:**

- ISOLATE EXISTING HYDRO POLES AS DIRECTED BY CONTRACT ADMINISTRATOR
- RENEW EXISTING APPROACHES AS DIRECTED BY CONTRACT ADMINISTRATOR
- ADDITIONAL EXCAVATION AND INSTALLATION OF SUBGRADE GEOGRID TO BE DETERMINED BY CONTRACT ADMINISTRATOR
- ADJUSTMENTS TO PROPOSED CROSSFALL, WHERE REQUIRED, ARE TO BE DETERMINED BY CONTRACT ADMINISTRATOR TO SUIT EXISTING DRIVEWAYS, APPROACHES, ETC.
- ALL LAND DRAINAGE SEWER EXCAVATION TO BE JETTED, FLOODED AND TAMPED AS PER CW2030-R7

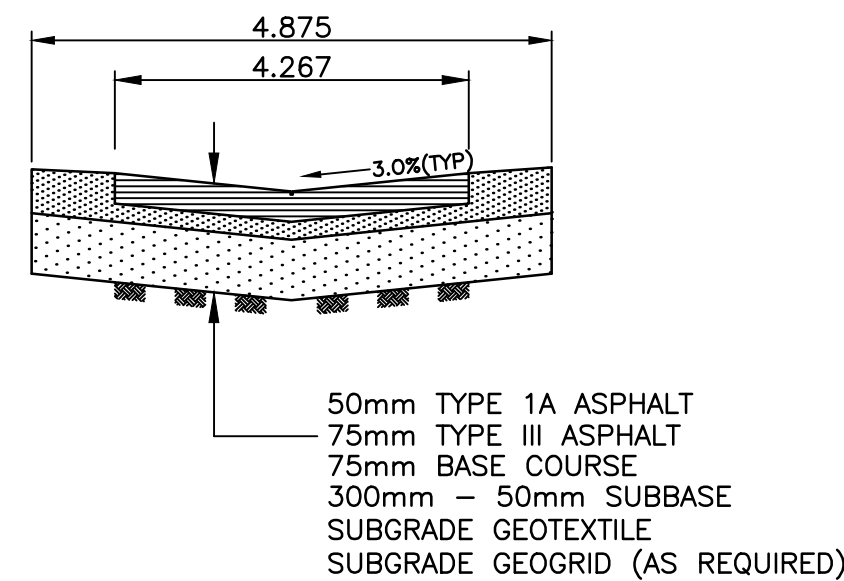

TYPICAL ALLEY CROSS SECTION  
N.T.S.

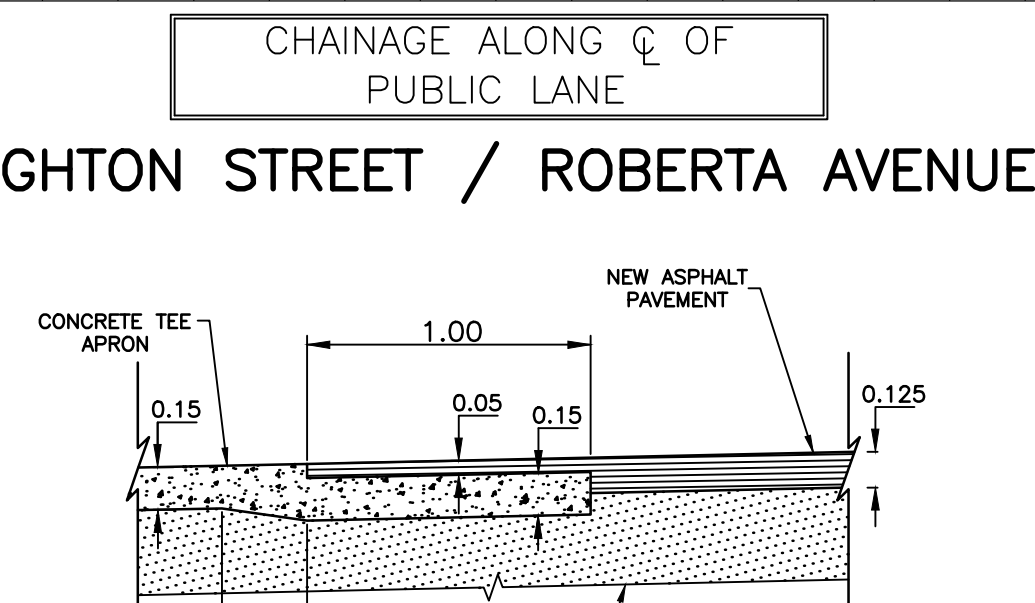

TYPICAL TEE APRON TIE-IN DETAIL  
N.T.S.

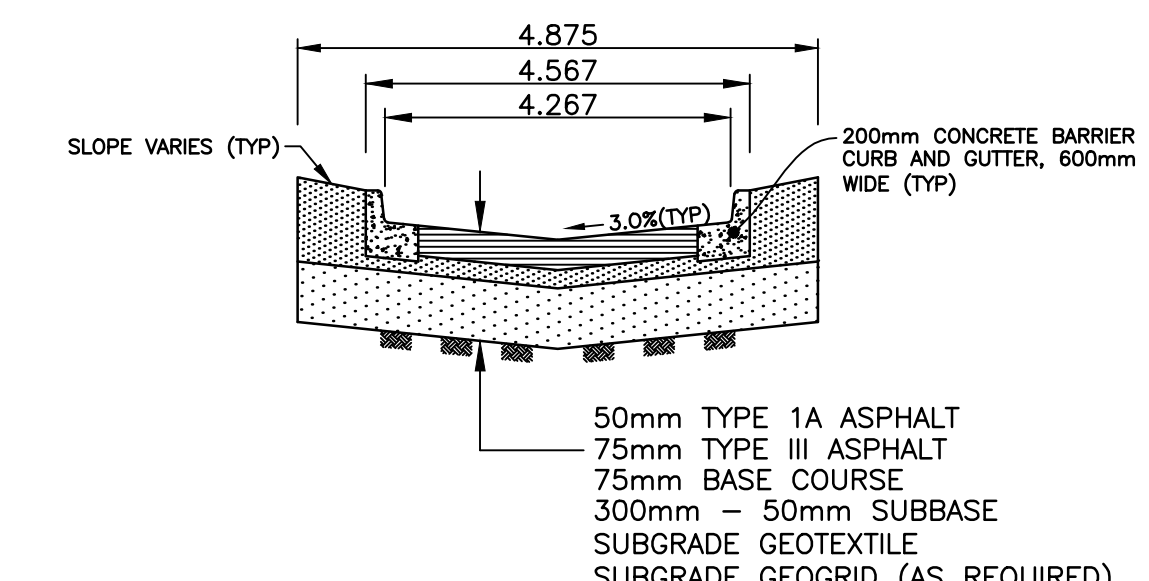

CURB AND GUTTER ALLEY CROSS SECTION  
N.T.S.

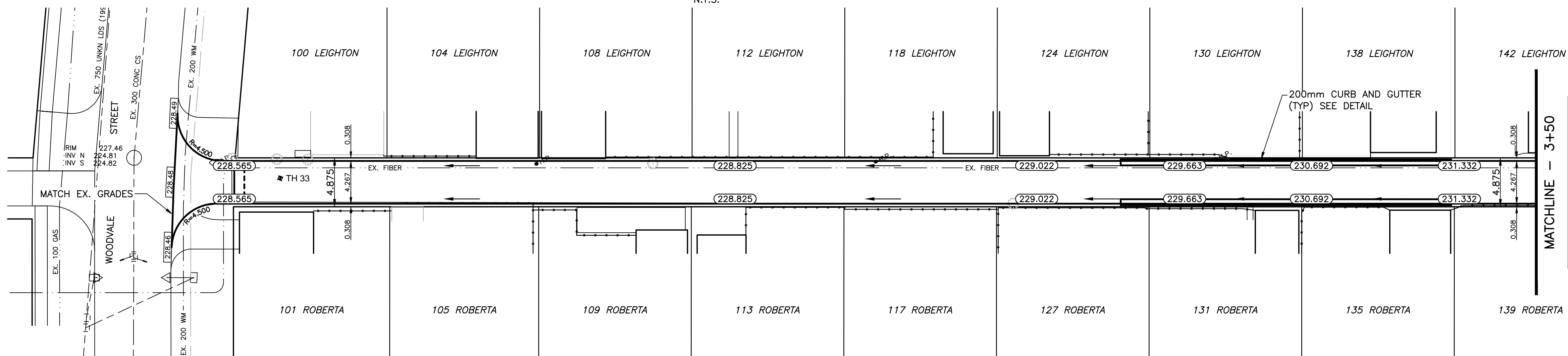

"Description of property limits, and existing and/or proposed features relative to these limits as shown on this drawing do not represent a Legal Survey. WSP makes no representation or guarantee that the property limit information is accurate. WSP accepts no responsibility for damages, if any, suffered by any third party as a result of decisions made or actions based on this drawing."

TEST HOLE DATUM  
TH31 - N 5532910, E 636326  
TH32 - N 5532954, E 636237  
TH33 - N 5533032, E 636077

DESCRIPTION  
NORTHWEST HENDERSON HIGHWAY AND LEIGHTON AVENUE,  
IN MEDIAN TABLET IN 7.8M CONCRETE PILE, 14.3M EAST  
OF WEST LIMIT OF HENDERSON HIGHWAY AND 19.3M  
NORTH OF THE STRAIGHT PRODUCTION EAST OF THE  
NORTH LIMIT OF LEIGHTON AVENUE AND 0.3M B.G.L.

NOTE:  
ROW WIDTH 4.875M  
NEW LANE DESIGN WIDTH 4.267M

METRIC  
WHOLE NUMBERS INDICATE MILLIMETRES  
DECIMALIZED NUMBERS INDICATE METRES



---	WATERMAIN	---	M.T.S.	---	WATERMAIN	---
⊕	HYDRANT	⊕	TRAFFIC SIGNAL	⊕	VALVE	⊕
⊕	VALVE	⊕	CONCRETE/ASPHALT	⊕	LAND DRAINAGE SEWER	⊕
⊕	CURB STOP	⊕	SIDEWALK	⊕	WASTE WATER SEWER	⊕
---	WASTE WATER SEWER	---	CURB RAMP	---	CENTERLINE	---
---	LAND DRAINAGE SEWER	---	PROPERTY LINE	---	SOUTH & EAST GUTTER	---
---	C.B. LEAD	---	ELEVATIONS (32.00)	---	NORTH & WEST GUTTER	---
○	MANHOLE	○	NORTH DRIVEWAY	---	TEST HOLE LOCATION	⊕TH#
□	CATCH BASIN	□	WEST DRIVEWAY	---	S. & E. PAD/GARG.	---
---	GAS	---	SOUTH DRIVEWAY	---	N. & W. PAD/GARG.	---
---	HYDRO	---	EAST DRIVEWAY	---		---
---	EXISTING	---	PROPOSED	---	EXISTING	---
---	LEGEND - PLAN	---	PROPOSED	---	LEGEND - PROFILE	---

LOCATION APPROVED  
UNDERGROUND STRUCTURES

SUPV. U/G STRUCTURES DATE COMMITTEE

NOTE:  
LOCATION OF UNDERGROUND STRUCTURES AS SHOWN ARE BASED ON THE BEST INFORMATION AVAILABLE BUT NO GUARANTEE IS GIVEN THAT ALL EXISTING UTILITIES ARE SHOWN OR THAT THE GIVEN LOCATIONS ARE EXACT. CONFIRMATION OF EXISTENCE AND EXACT LOCATION OF ALL SERVICES MUST BE OBTAINED FROM THE INDIVIDUAL UTILITIES BEFORE PROCEEDING WITH CONSTRUCTION.

B.M. 12-010, 318 (654318) ELEV. 230.101			
DESIGNED BY	A.B.	CHECKED BY	S.M.
DRAWN BY	A.B.	APPROVED BY	I.McK.
HOR. SCALE:	1:250	RELEASED FOR CONSTRUCTION	---
VERT. SCALE:	1:25	DATE	---
DATE	MAY 2015	DATE	---

1600 BUFFALO PLACE  
WINNIPEG, MB, R3T 6B8  
PHONE: 204-477-6650  
FAX: 204-474-2864  
WWW.WSPGROUP.COM

CONSULTANT DRAWING NO.  
141-24150-00-39

THE CITY OF WINNIPEG  
PUBLIC WORKS DEPARTMENT

2015 LOCAL IMPROVEMENTS - CONTRACT 2  
LEIGHTON AVENUE / ROBERTA AVENUE LANE  
FROM STATION 1+00 TO STATION 2+25  
ASPHALT PAVEMENT

CITY DRAWING NO.  
SHEET 1 of 3  
487-2015