

CHAINAGE ALONG C OF PUBLIC LANE
LILLIAN AVENUE/ CROMWELL STREET

NOTES:

- ISOLATE EXISTING HYDRO POLES AS DIRECTED BY CONTRACT ADMINISTRATOR
- RENEW EXISTING APPROACHES AS DIRECTED BY CONTRACT ADMINISTRATOR
- ADDITIONAL EXCAVATION AND INSTALLATION OF SUBGRADE GEOGRID TO BE DETERMINED BY CONTRACT ADMINISTRATOR
- ADJUSTMENTS TO PROPOSED CROSSFALL, WHERE REQUIRED, ARE TO BE DETERMINED BY CONTRACT ADMINISTRATOR TO SUIT EXISTING DRIVEWAYS, APPROACHES, ETC.

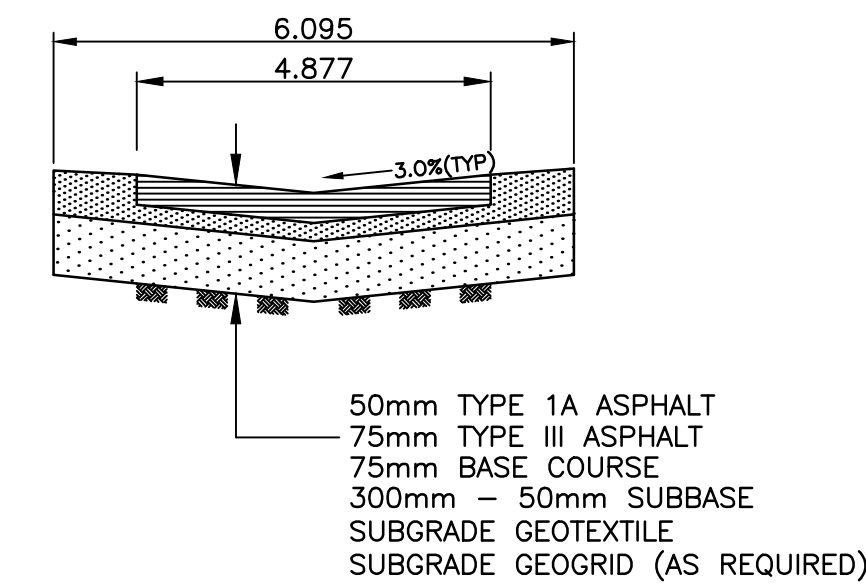

TYPICAL ALLEY CROSS SECTION
N.T.S.

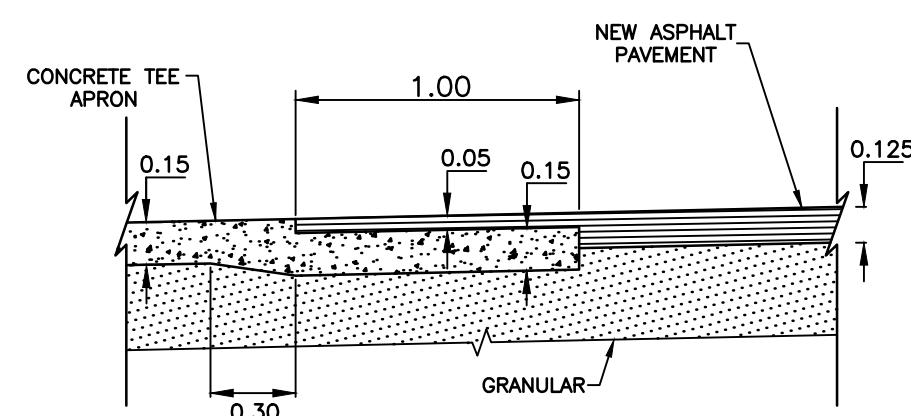

TYPICAL TEE APRON TIE-IN DETAIL
N.T.S.

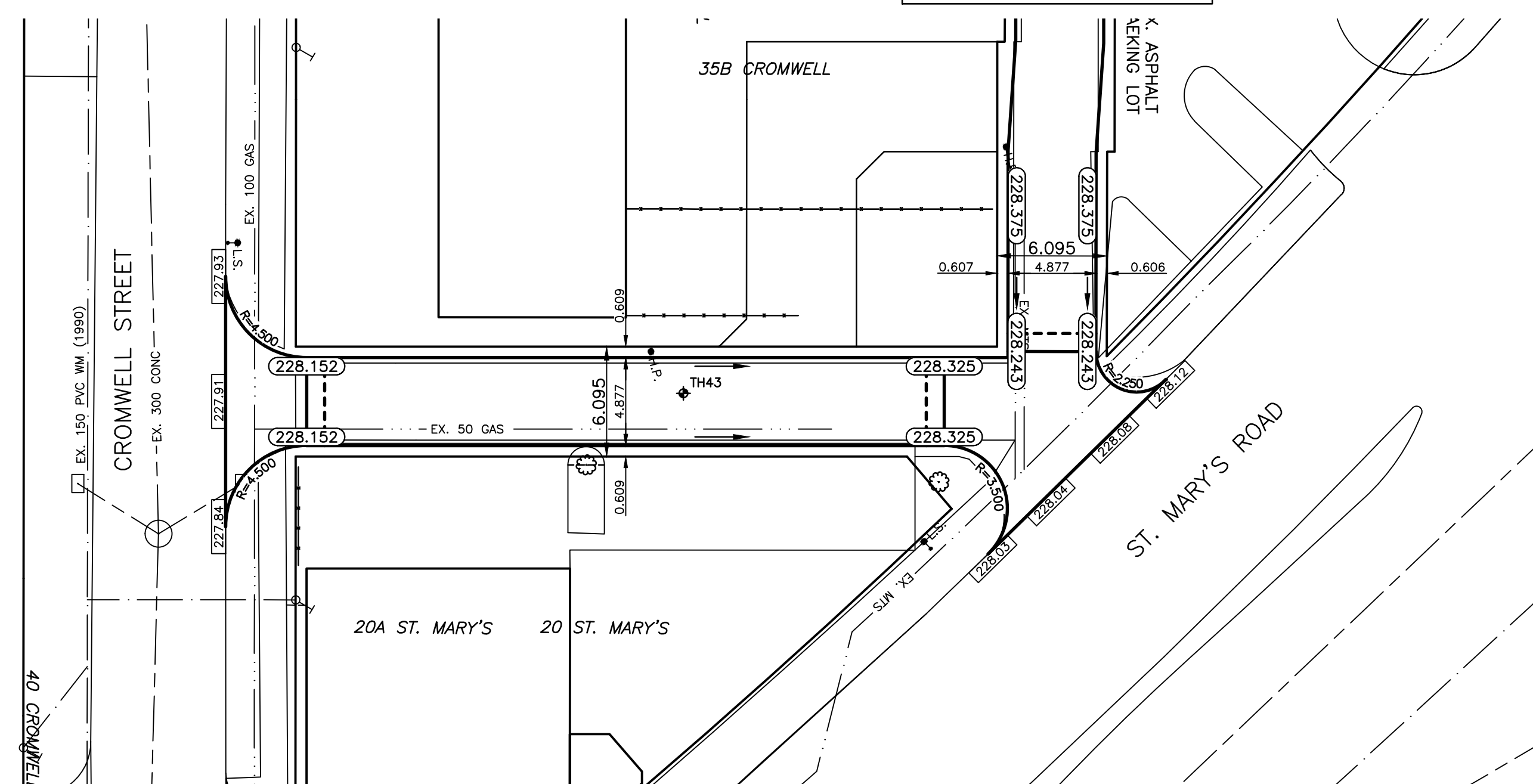

FOR CONTINUATION SEE
DWG 141-24150-00-47

"Description of property limits, and existing and/or proposed features relative to these limits as shown on this drawing do not represent a Legal Survey. WSP makes no representation or guarantee that the property limit information is accurate. WSP accepts no responsibility for damages, if any, suffered by any third party as a result of decisions made or actions based on this drawing."

DESCRIPTION
D.B.M. IN CORONATION PARK EAST OF ST. MARY'S ROAD,
7M SOUTH OF PRODUCTION OF NORTH LIMIT OF WALKER
STREET (NORTH CURB), 25M EAST OF EAST CURB ON ST.
MARY'S ROAD AND 12M EAST OF 1ST LAMP STANDARD
EAST OF ST. MARY'S ROAD, SOUTH OF PATH.

ROW WIDTH 6.095M
NEW LANE DESIGN WIDTH 4.877M

METRIC
WHOLE NUMBERS INDICATE MILLIMETRES
DECIMALIZED NUMBERS INDICATE METRES



EXISTING	LEGEND - PLAN	PROPOSED	EXISTING	LEGEND - PLAN	PROPOSED	EXISTING	LEGEND - PROFILE	PROPOSED
---	WATERMAIN	---	---	M.T.S.	---	---	WATERMAIN	---
⊕	HYDRANT	⊕	---	TRAFFIC SIGNAL	---	⊕	VALVE	⊕
⊕	VALVE	⊕	---	CONCRETE/ASPHALT	---	---	LAND DRAINAGE SEWER	---
⊕	CURB STOP	⊕	---	SIDEWALK	---	---	WASTE WATER SEWER	---
---	WASTE WATER SEWER	---	---	CURB RAMP	---	---	CENTERLINE	---
---	LAND DRAINAGE SEWER	---	---	PROPERTY LINE	---	---	SOUTH & EAST GUTTER	---
---	C.B. LEAD	---	---	ELEVATIONS	(32.00)	---	NORTH & WEST GUTTER	---
○	MANHOLE	○	---			---	TEST HOLE LOCATION	⊕TH#
□	CATCH BASIN	□	---			---	S. & E. PAD/GARG.	---
---	GAS	---	---			---	N. & W. PAD/GARG.	---
---	HYDRO	---	---			---		---

LOCATION APPROVED
UNDERGROUND STRUCTURES

SUPV. U/G STRUCTURES DATE COMMITTEE

NOTE:
LOCATION OF UNDERGROUND STRUCTURES AS SHOWN ARE BASED ON THE BEST INFORMATION AVAILABLE BUT NO GUARANTEE IS GIVEN THAT ALL EXISTING UTILITIES ARE SHOWN OR THAT THE GIVEN LOCATIONS ARE EXACT. CONFIRMATION OF EXISTENCE AND EXACT LOCATION OF ALL SERVICES MUST BE OBTAINED FROM THE INDIVIDUAL UTILITIES BEFORE PROCEEDING WITH CONSTRUCTION.

NO.	REVISIONS	DATE	BY
3	ISSUED FOR APPROVAL/TENDER	05/27/15	A.B.
2	W&W 70% DESIGN REVIEW	03/31/15	A.B.
1	70% REVIEW	02/10/15	A.B.

WSP
1600 BUFFALO PLACE
WINNIPEG, MB, R3T 6B8
PHONE: 204-477-6650
FAX: 204-474-2864
WWW.WSPGROUP.COM

DESIGNED BY P.R. CHECKED BY R.H.
DRAWN BY P.R. APPROVED BY I.McK.
HOR. SCALE: 1:250
VERT. SCALE: 1:25
DATE MAY 2015

ENGINEERS SEAL

CONSULTANT DRAWING NO.
141-24150-00-43

THE CITY OF WINNIPEG
PUBLIC WORKS DEPARTMENT

2015 LOCAL IMPROVEMENTS - CONTRACT 2
LILLIAN AVENUE / CROMWELL AVENUE LANE
SOUTH/NORTH LANE BOUNDED BY ST. MARY'S ROAD AND CROMWELL STREET
ASPHALT PAVEMENT

CITY DRAWING NO.
SHEET 2 OF 2
487-2015