

**NOTES:**

- ISOLATE EXISTING HYDRO POLES AS DIRECTED BY CONTRACT ADMINISTRATOR
- RENEW EXISTING APPROACHES AS DIRECTED BY CONTRACT ADMINISTRATOR
- ADDITIONAL EXCAVATION AND INSTALLATION OF SUBGRADE GEOGRID TO BE DETERMINED BY CONTRACT ADMINISTRATOR
- ADJUSTMENTS TO PROPOSED CROSSFALL, WHERE REQUIRED, ARE TO BE DETERMINED BY CONTRACT ADMINISTRATOR TO SUIT EXISTING DRIVEWAYS, APPROACHES, ETC.
- ALL LAND DRAINAGE SEWER EXCAVATION TO BE JETTED, FLOODED AND TAMPED AS PER CW2030-R7

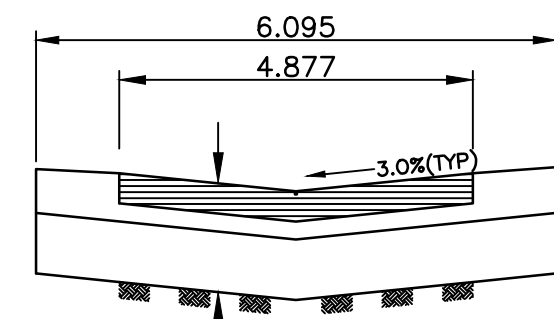

50mm TYPE 1A ASPHALT  
 75mm TYPE III ASPHALT  
 75mm BASE COURSE  
 300mm - 50mm SUBBASE  
 SUBGRADE GEOTEXTILE  
 SUBGRADE GEOGRID (AS REQUIRED)

**TYPICAL ALLEY CROSS SECTION**  
 N.T.S.

CHAINAGE ALONG C/L OF PUBLIC LANE  
**PINEDALE AVENUE / BIRCHDALE AVENUE**

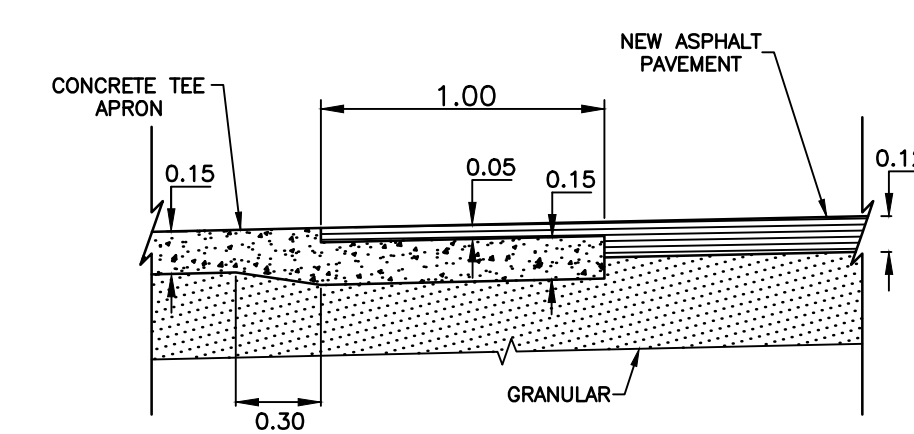

**TYPICAL TEE APRON TIE-IN DETAIL**  
 N.T.S.

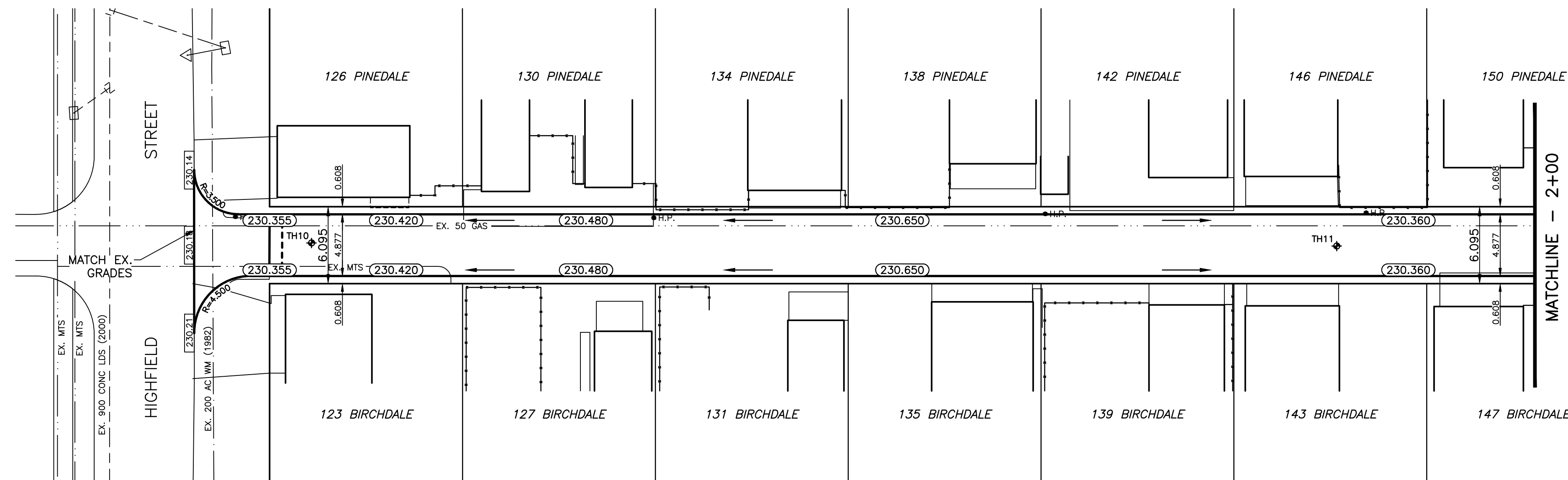

"Description of property limits, and existing and/or proposed features relative to these limits as shown on this drawing do not represent a Legal Survey. WSP makes no representation or guarantee that the property limit information is accurate. WSP accepts no responsibility for damages, if any, suffered by any third party as a result of decisions made or actions based on this drawing."

**TEST HOLE DATUM**  
 TH10 - N 5526487, E 634305  
 TH11 - N 5526559, E 634307  
 TH12 - N 5526642, E 634309

**DESCRIPTION**  
 WEST SIDE BIRCHDALE AVENUE AT CONISTON STREET, TABLET IN EAST CONCRETE FOUNDATION OF NORDALE SCHOOL NO.99 BIRCHDALE AVENUE, 2.0M NORTH AND 0.3M BELOW CONCRETE BLOCK OF SOUTHEAST CORNER OF BUILDING.

ROW WIDTH 6.095M  
 NEW LANE DESIGN WIDTH 4.877M

METRIC  
 WHOLE NUMBERS INDICATE MILLIMETRES  
 DECIMALIZED NUMBERS INDICATE METRES



	WATERMAIN		M.T.S.		WATERMAIN
	HYDRANT		TRAFFIC SIGNAL		VALVE
	VALVE		CONCRETE/ASPHALT		LAND DRAINAGE SEWER
	CURB STOP		SIDEWALK		WASTE WATER SEWER
	WASTE WATER SEWER		CURB RAMP		CENTERLINE
	LAND DRAINAGE SEWER		PROPERTY LINE		SOUTH & EAST GUTTER
	C.B. LEAD		ELEVATIONS		NORTH & WEST GUTTER
	MANHOLE				TEST HOLE LOCATION
	CATCH BASIN				S. & E. PAD/GARG.
	GAS				N. & W. PAD/GARG.
	HYDRO				
EXISTING	LEGEND - PLAN	PROPOSED	EXISTING	LEGEND - PLAN	PROPOSED
			EXISTING	LEGEND - PROFILE	PROPOSED

**LOCATION APPROVED**  
 UNDERGROUND STRUCTURES

SUPV. U/G STRUCTURES DATE COMMITTEE

NOTE:  
 LOCATION OF UNDERGROUND STRUCTURES AS SHOWN ARE BASED ON THE BEST INFORMATION AVAILABLE BUT NO GUARANTEE IS GIVEN THAT ALL EXISTING UTILITIES ARE SHOWN OR THAT THE GIVEN LOCATIONS ARE EXACT. CONFIRMATION OF EXISTENCE AND EXACT LOCATION OF ALL SERVICES MUST BE OBTAINED FROM THE INDIVIDUAL UTILITIES BEFORE PROCEEDING WITH CONSTRUCTION.

B.M. 34-006	ELEV. 230.904
NO.	REVISIONS
1	70% REVIEW
2	W&W 70% DESIGN REVIEW
3	ISSUED FOR APPROVAL/TENDER
	DATE
	BY

<b>WSP</b>		1600 BUFFALO PLACE WINNIPEG, MB, R3T 6B8 PHONE: 204-477-6650 FAX: 204-474-2864 WWW.WSPGROUP.COM	
DESIGNED BY	A.B.	CHECKED BY	S.M.
DRAWN BY	A.B.	APPROVED BY	I.McK.
HOR. SCALE:	1:250	RELEASED FOR CONSTRUCTION	
VERT. SCALE:	1:25	DATE	
DATE	MAY 2015		

ENGINEERS SEAL
CONSULTANT DRAWING NO. 141-24150-00-49

**THE CITY OF WINNIPEG**  
 PUBLIC WORKS DEPARTMENT

**2015 LOCAL IMPROVEMENTS - CONTRACT 2**  
 PINEDALE AVENUE / BIRCHDALE AVENUE LANE  
 FROM HIGHFIELD STREET TO STA. 2+00  
 ASPHALT PAVEMENT

CITY DRAWING NO. SHEET 1 OF 2  
 487-2015