

**DESIGN ROADWAY SECTION @ 12+40**  
SCALE: 1:150 HOR 1:75 VER

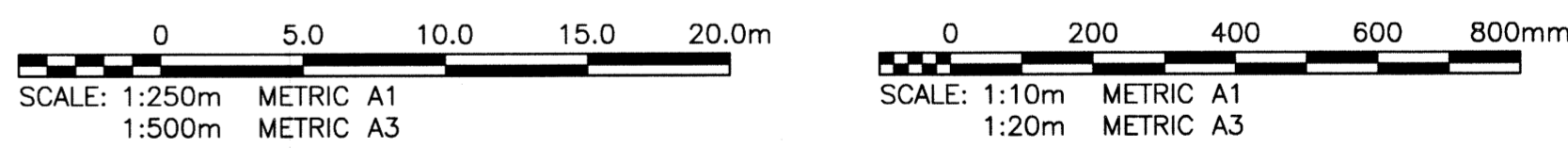
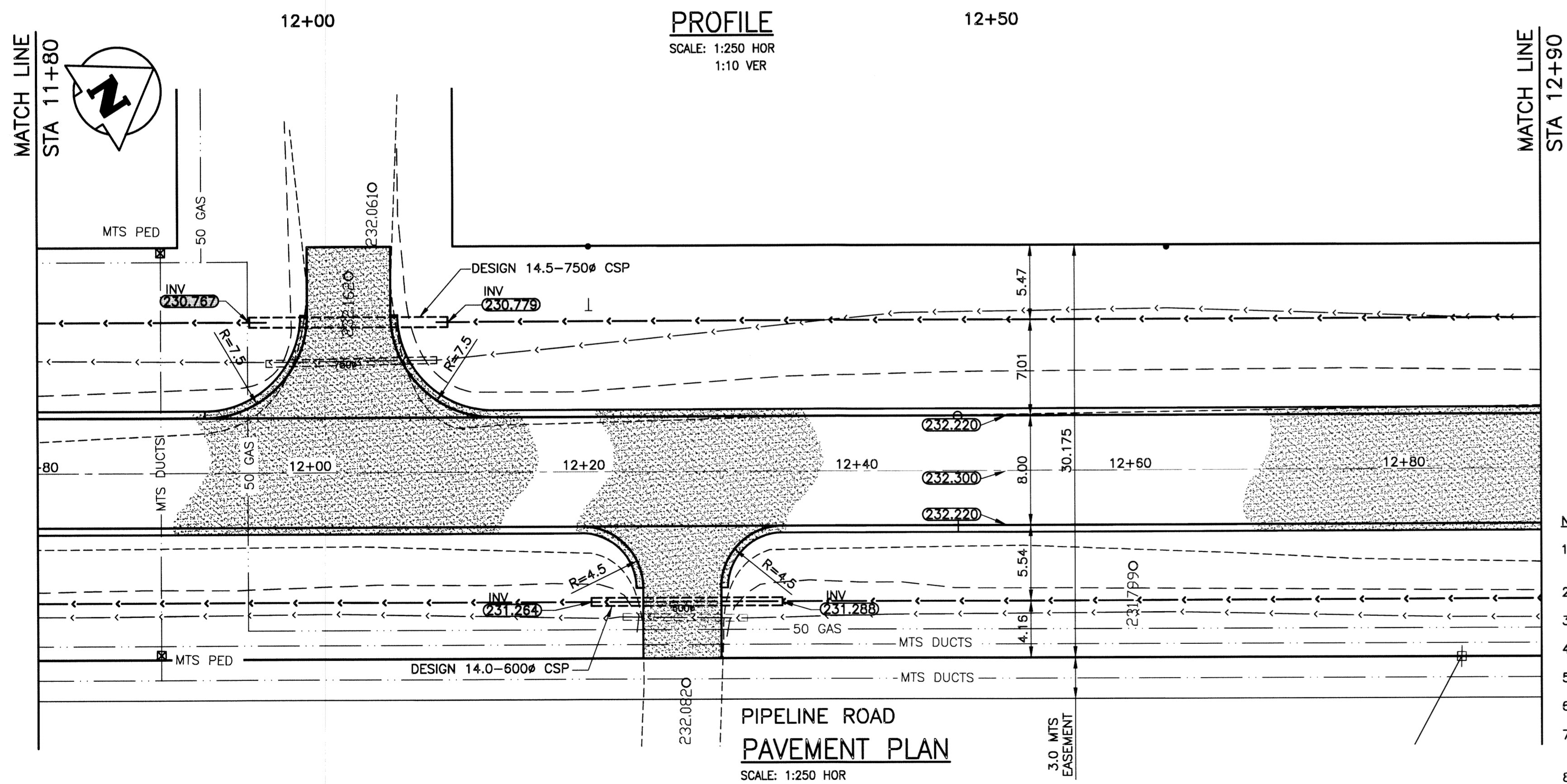

- NOTES:**
1. ALL WORKS TO BE IN ACCORDANCE WITH THE LATEST REVISION OF THE CITY OF WINNIPEG STANDARD CONSTRUCTION SPECIFICATIONS.
  2. STATION CHAINAGE IS BASED ON CENTRELINE OF PROPOSED ROADWAY.
  3. REGRADE EXISTING PRIVATE APPROACHES AS REQUIRED.
  4. CONTACT MANITOBA HYDRO TO LOWER FIBRE OPTIC CABLE WHERE REQUIRED.
  5. REGRADE EXISTING DITCHES AS DIRECTED BY CONTRACT ADMINISTRATOR.
  6. RENEW EXISTING APPROACHES AS DIRECTED BY CONTRACT ADMINISTRATOR.
  7. NEW CULVERTS TO BE INSTALLED UNDER ALL APPROACHES AS DIRECTED BY CONTRACT ADMINISTRATOR.
  8. CHIP-SEAL SURFACE TREATMENT ON APPROACHES AND TRAFFIC LANE ONLY.

**APEGN**  
Certificate of Authorization  
KGS Group  
No. 245

**METRIC**  
WHOLE NUMBERS INDICATE MILLIMETRES  
DECIMALIZED NUMBERS INDICATE METRES

**WARNING**

1. NOTIFY THE GAS COMPANY OF THE PROPOSED LOCATION OF EXCAVATION.
2. TAKE PRECAUTION TO AVOID DAMAGE TO GAS COMPANY INSTALLATIONS.
3. SEE PROVINCIAL REGULATION 210/72 FOR DETAILS.
4. AVOID DAMAGE TO EXISTING MANITOBA HYDRO EASEMENT WITHIN THE LIMITS OF CONSTRUCTION.
5. TAKE PRECAUTION TO AVOID DAMAGE TO MTS UNDERGROUND CABLES.

EXISTING	LEGEND-PLAN	PROPOSED	EXISTING	LEGEND-PLAN	PROPOSED	EXISTING	LEGEND-PROFILE	PROPOSED
300 LDS	LAND DRAINAGE SEWER	300 LDS	---	BACK OF CURB	---	---	---	---
250 WWS	WASTE WATER SEWER	250 WWS	---	CONCRETE	---	---	---	---
---	GAS	---	---	GRAVEL ROAD	---	---	---	---
---	HYDRO	---	---	SHOULDER	---	---	---	---
---	M.T.S.	---	---	DITCH	---	---	---	---
150 WM	WATERMAIN	150 WM	---	SIDEWALK	---	---	---	---
---	HYDRANT	---	---	PROPERTY LINE	---	---	---	---
---	VALVE	---	---	CULVERT	---	---	---	---
---	MANHOLE	---	---	GUY WIRE	---	---	---	---
---	CATCH BASIN	---	---	TREE	---	---	---	---
---	CURB INLET	---	---	SURVEY BAR	---	---	---	---
---	LIGHT STANDARD	---	---	GEODETIC BENCHMARK	---	---	---	---
---	POLES - MTS Hydro	---	---	ELEVATION	---	---	---	---

**LOCATION APPROVED UNDERGROUND STRUCTURES**

SUPV. U/G STRUCTURES COMMITTEE DATE

**NOTE:**  
LOCATION OF UNDERGROUND STRUCTURES AS SHOWN ARE BASED ON THE BEST INFORMATION AVAILABLE BUT NO GUARANTEE IS GIVEN THAT ALL EXISTING UTILITIES ARE SHOWN OR THAT THE GIVEN LOCATIONS ARE EXACT. CONFIRMATION OF EXISTENCE AND EXACT LOCATION OF ALL SERVICES MUST BE OBTAINED FROM THE INDIVIDUAL UTILITIES BEFORE PROCEEDING WITH CONSTRUCTION.

NO.	REVISIONS	DATE	BY
0	ISSUED FOR CONSTRUCTION	15/06/11	BJM

DESIGNED BY	MK	CHECKED BY	BJM
DRAWN BY	GEL	APPROVED BY	[Signature]
HOR. SCALE:	1:250	RELEASED FOR CONSTRUCTION:	
VERTICAL:	1:10	DATE	2015/02/02

ENGINEER'S SEAL

**KGS GROUP CONSULTING ENGINEERS**

PROFESSIONAL ENGINEER  
N. KOLAYENKO  
Member 24588  
JUNE 11/2015

**THE CITY OF WINNIPEG**  
PUBLIC WORKS DEPARTMENT  
ENGINEERING DIVISION

PROJECT TITLE: **PIPELINE ROAD PAVEMENT RECONSTRUCTION**  
100±m SOUTH OF MOLLARD AVENUE TO GARDEN VIEW DRIVE  
STA 11+80 TO STA 12+90

SHEET OF: **02** OF **16**

COMPUTER FILE NAME: **PIPELINE-PL0T**

CITY DRAWING NUMBER: **013**

CONSULTANT DRAWING NO.: **14-0107-010\_013**

U:\MS\14-0107-010-010-010-DWG.dwg - Job: 0013 Plotted By: dweber 05/11/2015 11:48:52 am