

PROFILE
SCALE: 1:250 HOR
1:10 VER

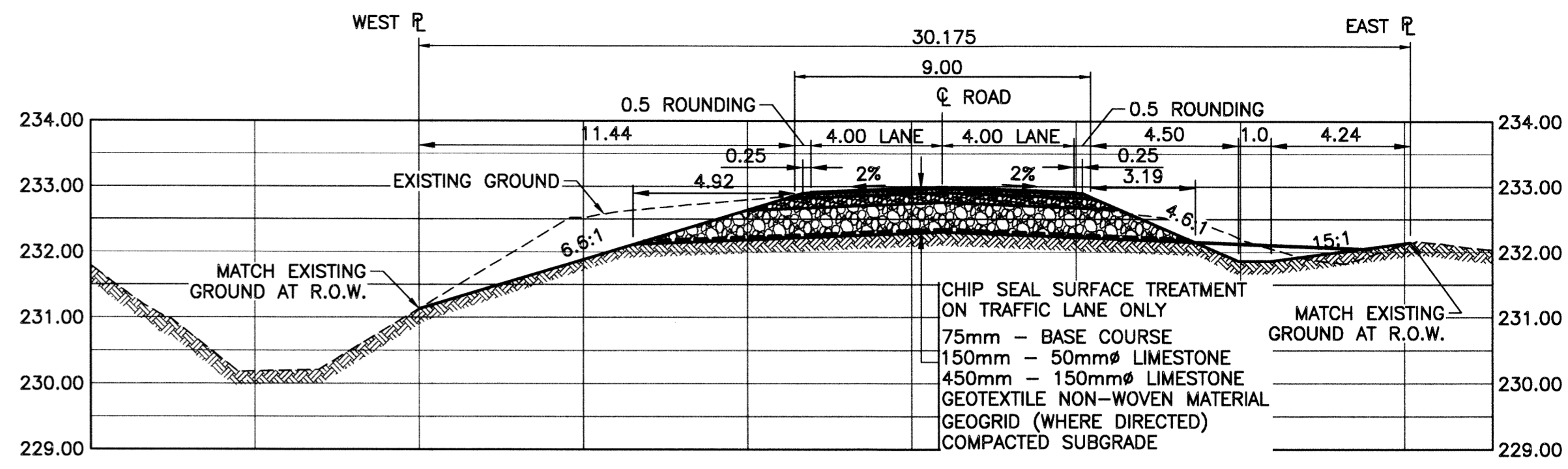

DESIGN ROADWAY SECTION @ 25+50
SCALE: 1:150 HOR 1:75 VER

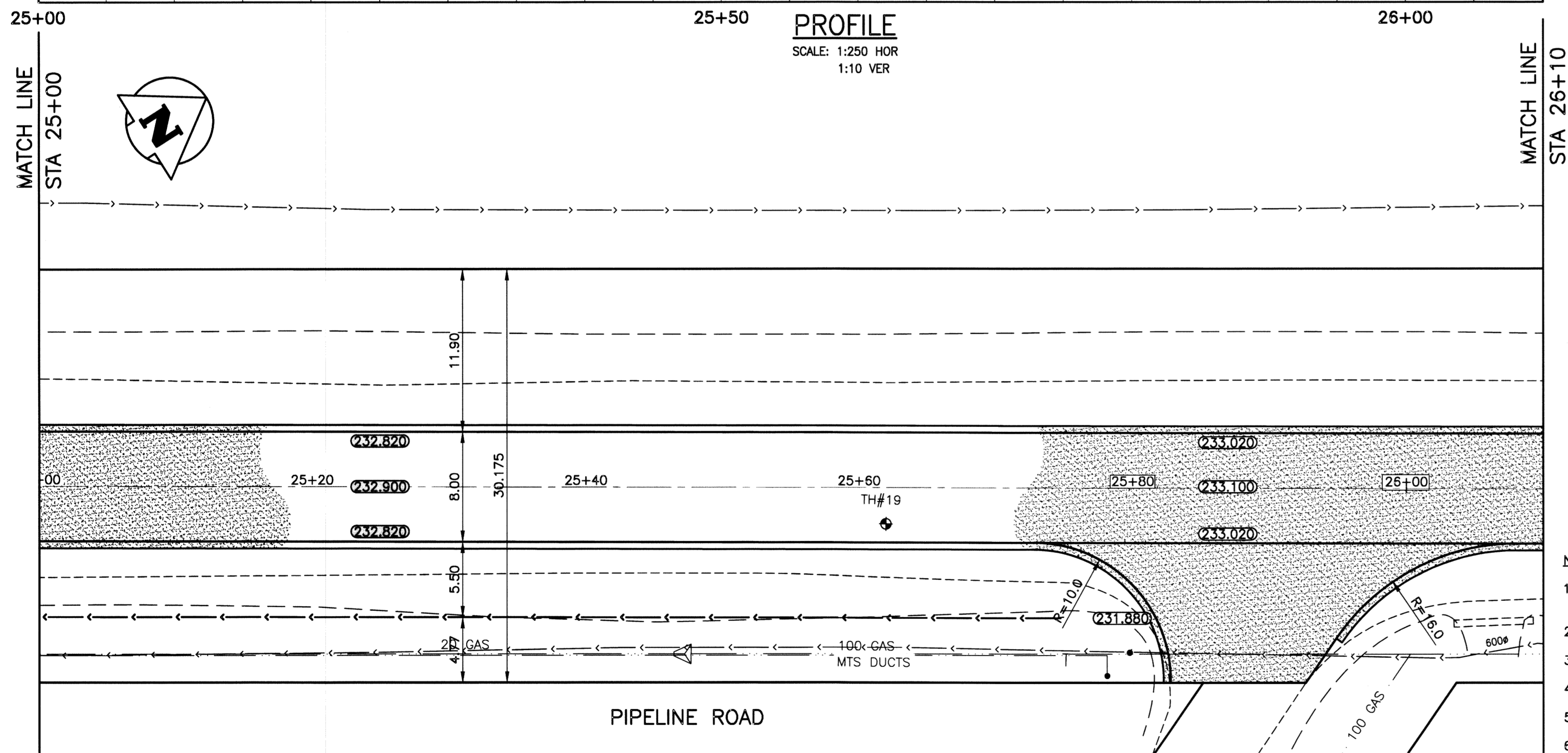

PAVEMENT PLAN
SCALE: 1:250 HOR

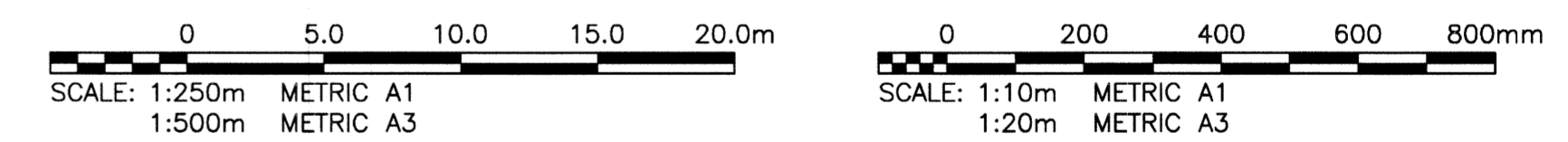

- NOTES:**
- ALL WORKS TO BE IN ACCORDANCE WITH THE LATEST REVISION OF THE CITY OF WINNIPEG STANDARD CONSTRUCTION SPECIFICATIONS.
 - STATION CHAINAGE IS BASED ON CENTRELINE OF PROPOSED ROADWAY.
 - REGRADE EXISTING PRIVATE APPROACHES AS REQUIRED.
 - CONTACT MANITOBA HYDRO TO LOWER FIBRE OPTIC CABLE WHERE REQUIRED.
 - REGRADE EXISTING DITCHES AS DIRECTED BY CONTRACT ADMINISTRATOR.
 - RENEW EXISTING APPROACHES AS DIRECTED BY CONTRACT ADMINISTRATOR.
 - NEW CULVERTS TO BE INSTALLED UNDER ALL APPROACHES AS DIRECTED BY CONTRACT ADMINISTRATOR.
 - CHIP-SEAL SURFACE TREATMENT ON APPROACHES AND TRAFFIC LANE ONLY.

APEGN
Certificate of Authorization
KGS Group
No. 245

METRIC
WHOLE NUMBERS INDICATE MILLIMETRES
DECIMALIZED NUMBERS INDICATE METRES

WARNING

- NOTIFY THE GAS COMPANY OF THE PROPOSED LOCATION OF EXCAVATION.
- TAKE PRECAUTION TO AVOID DAMAGE TO GAS COMPANY INSTALLATIONS.
- SEE PROVINCIAL REGULATION 210/72 FOR DETAILS.
- AVOID DAMAGE TO EXISTING MANITOBA HYDRO EASEMENT WITHIN THE LIMITS OF CONSTRUCTION.
- TAKE PRECAUTION TO AVOID DAMAGE TO MTS UNDERGROUND CABLES.

EXISTING	LEGEND-PLAN	PROPOSED	EXISTING	LEGEND-PLAN	PROPOSED	EXISTING	LEGEND-PROFILE	PROPOSED
300 LBS	LAND DRAINAGE SEWER	300 LBS	---	BACK OF CURB	---	---	---	---
250 WWS	WASTE WATER SEWER	250 WWS	---	CONCRETE	---	---	---	---
---	GAS	---	---	GRAVEL ROAD	---	---	---	---
---	HYDRO	---	---	SHOULDER	---	---	---	---
---	M.T.S.	---	---	DITCH	---	---	---	---
150 WM	WATERMAIN	150 WM	---	SIDEWALK	---	---	---	---
---	HYDRANT	---	---	PROPERTY LINE	---	---	---	---
---	VALVE	---	---	CULVERT	---	---	---	---
---	MANHOLE	---	---	GUY WIRE	---	---	---	---
---	CATCH BASIN	---	---	TREE	---	---	---	---
---	CURB INLET	---	---	SURVEY BAR	---	---	---	---
---	LIGHT STANDARD	---	---	GEODETIC BENCHMARK	---	---	---	---
---	POLES	---	---	ELEVATION	---	---	---	---
---	---	---	---	---	---	---	---	---

LOCATION APPROVED UNDERGROUND STRUCTURES

SUPV. U/G STRUCTURES DATE COMMITTEE

NOTE:
LOCATION OF UNDERGROUND STRUCTURES AS SHOWN ARE BASED ON THE BEST INFORMATION AVAILABLE BUT NO GUARANTEE IS GIVEN THAT ALL EXISTING UTILITIES ARE SHOWN OR THAT THE GIVEN LOCATIONS ARE EXACT. CONFIRMATION OF EXISTENCE AND EXACT LOCATION OF ALL SERVICES MUST BE OBTAINED FROM THE INDIVIDUAL UTILITIES BEFORE PROCEEDING WITH CONSTRUCTION.

NO.	REVISIONS	DATE	BY
0	ISSUED FOR CONSTRUCTION	15/06/11	Bjll4

KGS GROUP
CONSULTING ENGINEERS

DESIGNED BY: MK
DRAWN BY: GEL
CHECKED BY: [Signature]
APPROVED BY: [Signature]

HOR. SCALE: 1:250
VERTICAL: 1:10

RELEASED FOR CONSTRUCTION: [Signature]
DATE: 2015/02/02

ENGINEER'S SEAL

MIKOLAYENKO
24588
PROFESSIONAL ENGINEER

CONSULTANT DRAWING NO. 14-0107-010_025

THE CITY OF WINNIPEG
PUBLIC WORKS DEPARTMENT
ENGINEERING DIVISION

PROJECT TITLE: PIPELINE ROAD PAVEMENT RECONSTRUCTION
100±m SOUTH OF MOLLARD AVENUE TO GARDEN VIEW DRIVE
STA 25+00 TO STA 26+10

SHEET 13 OF 16
COMPUTER FILE NAME: PIPELINE-PL0T
CITY DRAWING NUMBER: 025

U:\MSA\14-0107-010\14-0107-010_CALL.dwg - lab: 0325 Plotted by: eweber 06/11/2015 [Thu 9:40 am]