

TENNIS COURT LAYOUT
SCALE 1:150

GENERAL NOTES

- CONTRACTOR TO CONFIRM ALL DIMENSIONS AND REPORT ANY DISCREPANCIES TO CONTRACT ADMINISTRATOR PRIOR TO CONSTRUCTION. SITE SURVEY IS AVAILABLE ON REQUEST.
- LAYOUT TO BE APPROVED BY PROJECT LANDSCAPE ARCHITECT PRIOR TO ANY CONSTRUCTION OR REMOVALS.
- ALL DIMENSIONS ARE IN METRIC UNLESS OTHERWISE NOTED.
- REFER ALSO TO WRITTEN SPECIFICATIONS.
- USE SPECIFIED BACKFILL IN ALL TRENCHES RUNNING BELOW ALL STRUCTURES, PAVING, WALKWAYS, ETC.
- REFER TO GRADING PLAN FOR LOCATION OF ALL CURB CUTS, CATCH BASINS, ETC.
- LOCATION OF ALL UTILITIES SHOWN FOR ILLUSTRATION ONLY. CONTRACTOR MUST CONTACT ALL UTILITIES REGARDING RULES FOR WORKING IN THE AREA OF THE UTILITIES PRIOR TO COMMENCEMENT OF ANY WORK. CONTRACTOR MUST CONFIRM LOCATION OF ALL UTILITIES PRIOR TO CONSTRUCTION.
- ALL EXISTING ROADS, SIDEWALKS, CURBS, FENCING, PAVING, SODDED BOULEVARD, AND APPROACHES, ETC. TO REMAIN TO BE PROTECTED DURING CONSTRUCTION TO THE CITY OF WINNIPEG STANDARDS AT THE CONTRACTORS OWN COSTS.
- ALL EXISTING ROADS, SIDEWALKS, FENCING, SODDED BOULEVARD, AND APPROACHES, ETC. DAMAGED DURING CONSTRUCTION TO BE REPAIRED TO THE CITY OF WINNIPEG STANDARDS AT THE CONTRACTORS OWN COSTS.
- ALL EXISTING TREES, SHRUB BEDS, MULCH BEDS, AND SOD TO REMAIN TO BE PROTECTED DURING CONSTRUCTION TO THE CITY OF WINNIPEG STANDARDS. AREAS DAMAGED DURING CONSTRUCTION TO BE REPAIRED TO THE CITY OF WINNIPEG STANDARDS AT THE CONTRACTORS OWN COST.
- CONTRACTOR IS RESPONSIBLE FOR ALL EXCAVATIONS, REMOVALS, DISPOSALS, AND ROUGH GRADING AS REQUIRED TO CONSTRUCT ALL WORKS AS SHOWN ON PLAN, DETAILS AND SPECIFICATIONS.
- LANDSCAPE CONTRACTOR TO COORDINATE ALL WORK WITH CIVIL CONTRACTORS.
- FILL ALL HOLES AND LOW AREAS TO DESIGN SUBGRADE WITH COMPACTED FILL (SUITABLE TO SURFACE FINISH), FOR SODDED/PLANTED AREAS USE COMPACTED CLEAN EARTH FILL SUITABLE FOR PLANT GROWTH. FOR PAVED AREAS USE COMPACTED GRANULAR BASE (REFER TO SPECIFICATIONS).
- CONTRACTOR TO INSPECT ASPHALT SURFACE OF COURT WITH CITY OF WINNIPEG AND CONFIRM EXTENT OF ANY FULL DEPTH REPAIR REQUIRED. CONTRACTOR TO CONFIRM EXISTING DEPTH OF ASPHALT IS MINIMUM 75mm.
 - SCARIFY 25-40mm DEPTH FOR ENTIRE SURFACE.
 - REPAIR FULL DEPTH AREAS AS REQUIRED NOTED ABOVE.
 - EXISTING FENCE POSTS TO REMAIN IN PLACE FOR CONSTRUCTION. CONTRACTOR TO REMOVE AND REINSTALL FENCE FABRIC AS REQUIRED FOR CONSTRUCTION.
 - CONTRACTOR TO DETERMINE THE SIZE OF EQUIPMENT REQUIRED TO WORK IN EXISTING CONDITIONS.

LEGEND

- NEW ASPHALT PATHWAY
- RESURFACED ASPHALT
- APPROXIMATE LIMIT OF RECONSTRUCTED ASPHALT PATHWAY
- SUPPLY & INSTALL SOD
- SPRAY PAD AREAS TO BE ADDRESSED UNDER SEPARATE CONTRACT
- PROPOSED CATCH PIT
- EXISTING LIGHT POLE
- PROPOSED LIGHT POLE
- DETAIL KEY**
- DETAIL NUMBER SHEET NUMBER
- EXISTING DECIDUOUS TREE
- EXISTING CONIFEROUS TREE
- PROPOSED DECIDUOUS TREE

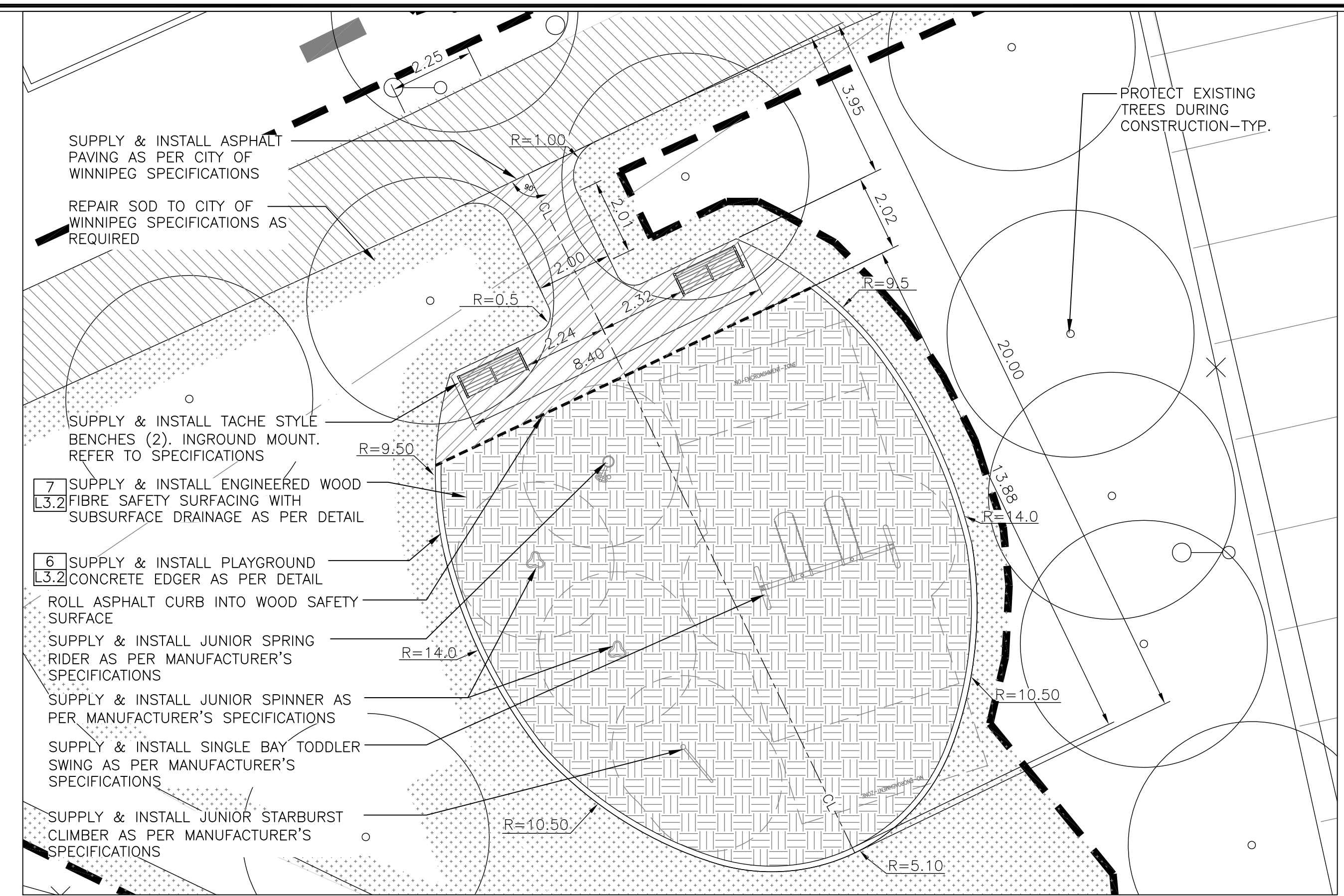

PLAYGROUND LAYOUT
SCALE 1:100

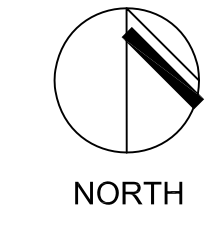

ISSUED FOR TENDER	MAR 12 2016	AH
99% CITY REVIEW	APR 23 2015	AH
No.	Revisions	Date
Date	Scale	By
27-03-15	AS NOTED	
Designed By	Drawn By	Checked By
AH	GML	AH

Seals



Project Title
PARK CITY WEST COMMUNITY CENTRE

Sheet Title
TENNIS COURT & PLAYGROUND LAYOUT

Project No. 14-030 Drawing No. L1.2