

GENERAL NOTES

- REFER TO CIVIL ENGINEER'S DRAWINGS FOR DEMOLITION, LAYOUT AND GRADING INFORMATION.
- ALL UTILITIES ARE SHOWN AS INFORMATION ONLY. CONTRACTOR TO CONFIRM LOCATION OF ALL UTILITIES ON SITE PRIOR TO CONSTRUCTION.
- CONTRACTOR SHALL PROVIDE QUALIFIED CREW TO LAY OUT STREETSCAPING ELEMENTS. THE CREW SHALL BE EQUIPPED WITH ALL THE NECESSARY EQUIPMENT TO PROVIDE HORIZONTAL AND VERTICAL LAYOUT IN ACCORDANCE WITH THE DRAWINGS AND SPECIFICATIONS.
- CONTRACTOR TO STAKE OUT LOCATION OF ALL WORKS FOR APPROVAL BY CONTRACT ADMINISTRATOR PRIOR TO ANY REMOVALS OR CONSTRUCTION.
- CONTRACTOR SHALL CONFIRM ALL DIMENSIONS ON SITE AND REPORT ANY DISCREPANCIES TO THE CONTRACT ADMINISTRATOR PRIOR TO CONSTRUCTION.
- DURING CONSTRUCTION CONTRACTOR TO PROTECT TO CITY OF WINNIPEG STANDARDS ALL EXISTING TREES, SIDEWALKS, CURBS, UTILITIES AND PAVING TO REMAIN. AREAS DAMAGED DURING CONSTRUCTION TO BE REPAIRED TO CITY OF WINNIPEG STANDARDS AT NO COST TO THE CITY.
- CONTRACTOR IS RESPONSIBLE FOR ALL REMOVALS AS REQUIRED TO CONSTRUCT ALL WORKS AS SHOWN ON THE DRAWINGS. ALL ITEMS TO BE REMOVED MUST BE DISPOSED OF LEGALLY OFF SITE. ALL ITEMS DESIGNATED FOR RE-USE SHALL BE CAREFULLY REMOVED AND STOCKPILED IN A PROTECTED PLACE - SEE SPECIFICATIONS.
- ALL WORK TO BE DONE IN ACCORDANCE WITH CITY OF WINNIPEG STANDARD CONSTRUCTION SPECIFICATIONS UNLESS OTHERWISE INDICATED.

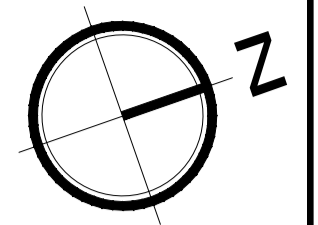

MATERIALS LEGEND:

	APPROX LIMIT OF CONSTRUCTION		INDICATOR STRIP - SEE DTL. 2/L4.1		PLANTING BED
	EXISTING TREES TO BE RETAINED & PRUNED		EXISTING PAVERS		BENCH - WALL MOUNTED
	EXISTING LIGHT STANDARD		PERMEABLE UNIT PAVERS SEE DTL. 3/L4.1		BENCH - SURFACE MOUNTED SEE DTL. 5/L4.1
	CIP CONC SIDEWALK SIM TO CW3310 & SD228A SAW CUT		BLACK GRANITE MULCH		

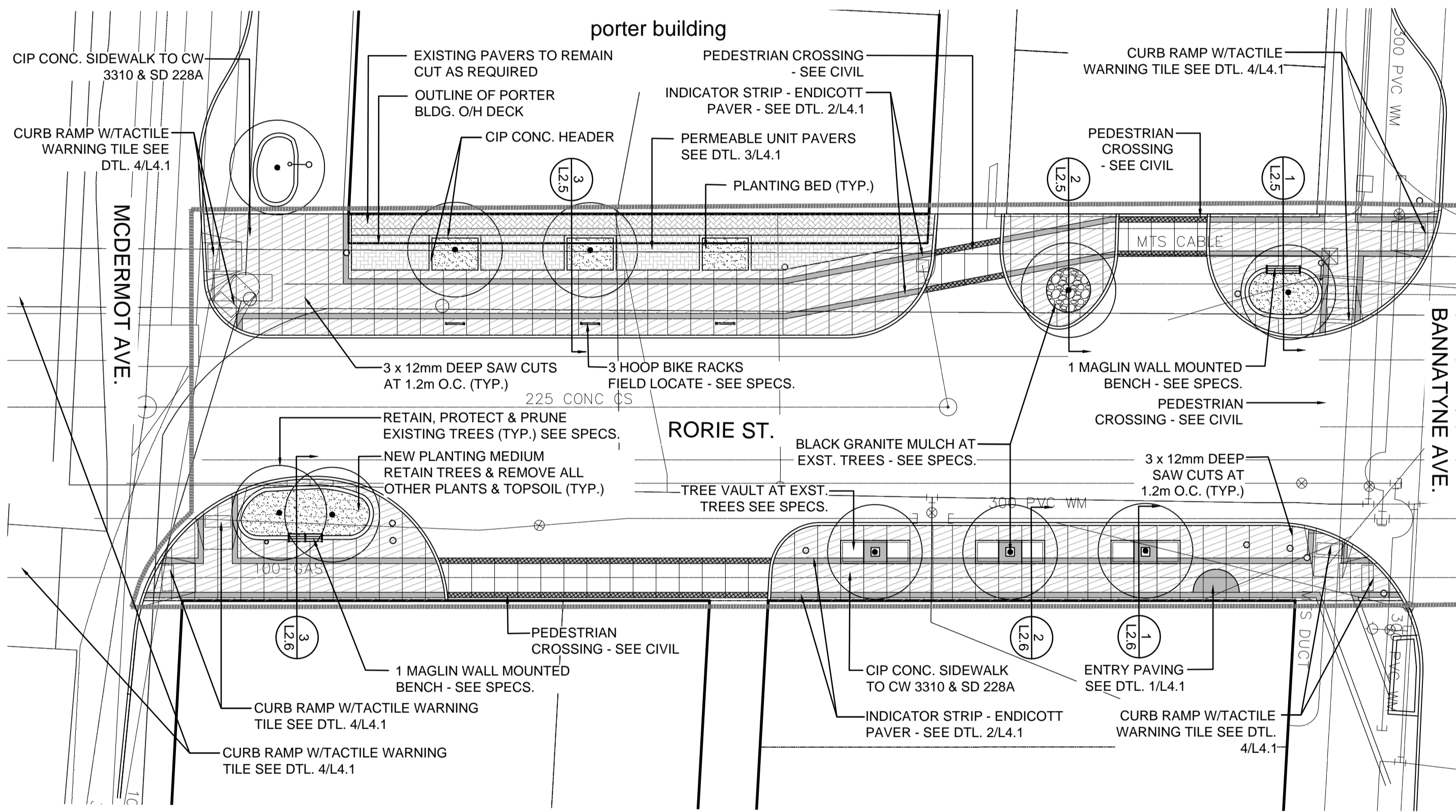

1 RORIE WEST SIDE FROM BANNATYNE TO MCDERMOT - MATERIALS PLAN
SCALE: 1:200

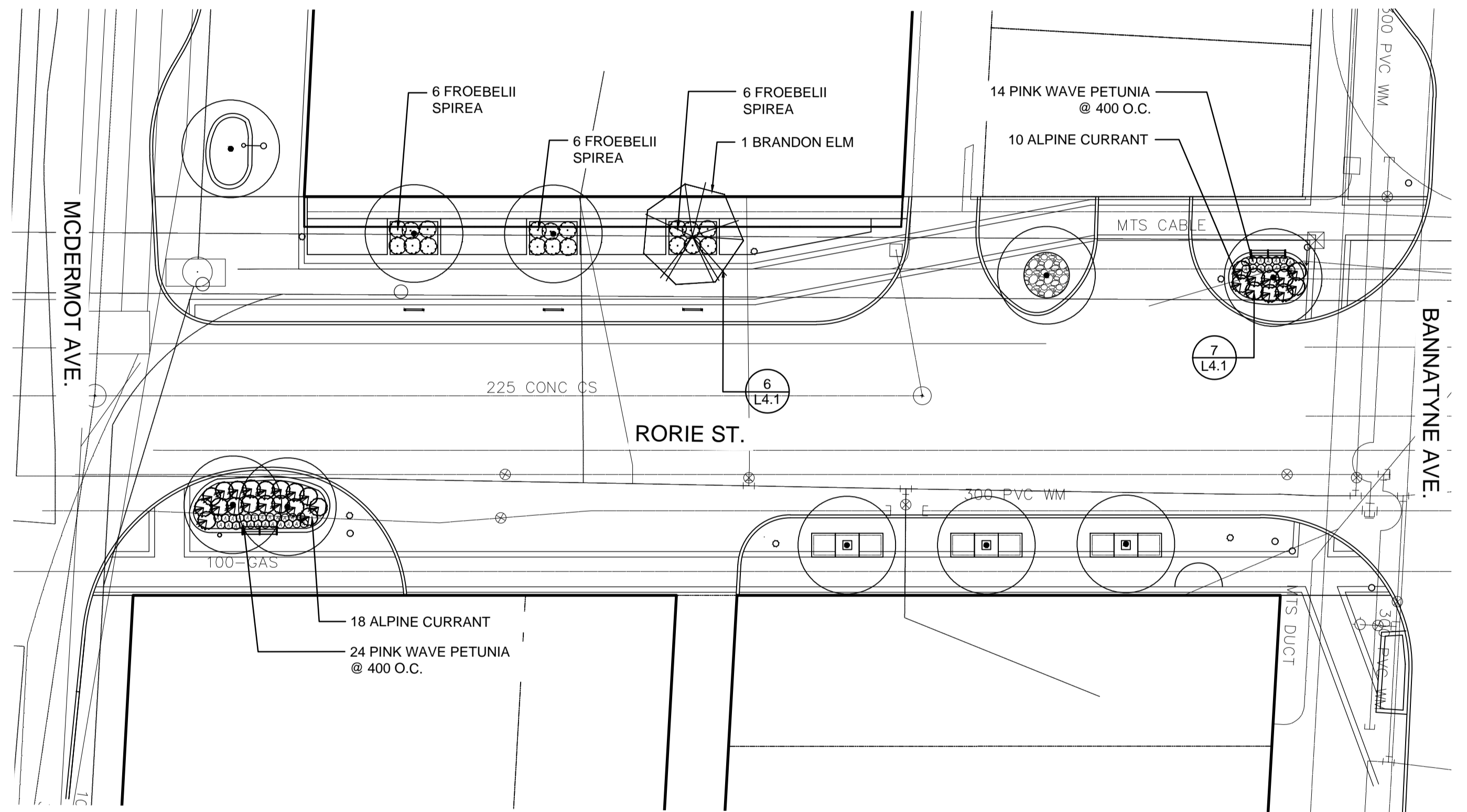

2 RORIE FROM BANNATYNE TO MCDERMOT - PLANTING PLAN
SCALE: 1:200

SURVEY LEGEND:

---	WATERMAIN	---	ANCHOR
---	LAND DRAINAGE SEWER	#111	CIVIC ADDRESS
---	WASTE WATER SEWER	⊕	IRON BAR
---	HYDRO	•••	LIGHT STANDARD
---	M.T.S.	⊙	HYDRO POLE
---	GAS	□	CURB RAMP
---	SIGNALS	---	EDGE OF SIDEWALK
○	MANHOLE	---	PROPERTY LINE
□	CATCH BASIN	---	EDGE OF PAVEMENT
△	CURB INLET	---	MODIFIED BARRIER CURB
▽	UTILITIES ADJUSTED	---	BARRIER CURB
⊥	PLUG	---	BARRIER CURB & GUTTER
⊕	HYDRANT	---	EDGE OF CONCRETE
⊗	VALVE	---	EDGE OF GRAVEL
⊙	CURB STOP	---	SIDEWALK
230.99	GROUND GRADE	---	CONCRETE
---	PAVEMENT GRADE	31.00	ASPHALT
---	LOT GRADE	31.00	ASPHALT OVERLAY
---	EXISTING	---	LEGEND-PLAN
---	PROPOSED	---	PROPOSED
---	EXISTING	---	LEGEND-PROFILE
---	PROPOSED	---	PROPOSED

LOCATIONS APPROVED UNDERGROUND STRUCTURES

SIGNED BY: _____ DATE: _____

SUPV/UG STRUCTURES: _____ DATE: _____

LOCATION OF UNDERGROUND STRUCTURES AS SHOWN ARE BASED ON THE BEST INFORMATION AVAILABLE BUT NO GUARANTEE IS GIVEN THAT ALL EXISTING UTILITIES ARE SHOWN OR THAT THE GIVEN LOCATIONS ARE EXACT CONFIRMATION OF EXISTENCE AND EXACT LOCATION OF ALL SERVICES MUST BE OBTAINED FROM THE INDIVIDUAL UTILITIES BEFORE PROCEEDING

G.B.M. ELEV.	
DESIGNED BY	JH
CHECKED BY	GM
DRAWN BY	JH
APPROVED BY	GM
ISSUED FOR TENDER	28/07/15 JH
ISSUED TO U/G STRUCTURES FOR REVIEW	21/7/15 JH
NO. REVISIONS	

HTFC
PLANNING & DESIGN
100-115 Bannatyne Avenue East, Winnipeg, MB R2B 0R5
PHONE: 204-944-5999

ENGINEER'S SEAL: [Signature]

CONSULTANT ACAD DWG. NO. L1.2

AS NOTED AS NOTED
JULY 21, 2015

THE CITY OF WINNIPEG
PUBLIC WORKS DEPARTMENT
ENGINEERING SERVICES DIVISION

CITY OF WINNIPEG

CITY DRAWING NUMBER: SHEET 5 OF 15

BID NO. 669-2015

RORIE FROM BANNATYNE TO MCDERMOT MATERIALS & PLANTING PLAN

Jul 27, 2015 - 4:50pm
 \\p1\hfc\file_server\2015\15-043_East_Exchange_Phase_3\ACAD\15-043_Layou.dwg - tab:L1.2