

- REFERENCE NOTES**
- PAVEMENT DIMENSIONS ARE TO BACK OF CURB
  - BASELINE IS 12.0M SOUTH OF NORTH PROPERTY LINE
  - PROPERTY LINES OBTAINED FROM THE CITY OF WINNIPEG L.B.I.S., AND NO SCALE FACTOR WAS APPLIED
  - REFER TO AECOM FIELD BOOK NO. 4821, 4822 & 4823

- CONSTRUCTION NOTES:**
- PLANE EXISTING ASPHALT AND CONSTRUCT NEW ASPHALTIC PAVEMENT OVERLAY TYPE 1A (AVERAGE THICKNESS 85mm)
  - REMOVE EXISTING PAVEMENT AND CONSTRUCT NEW 200mm REINFORCED CONCRETE PAVEMENT c/w 85mm TYPE 1A ASPHALTIC OVERLAY
  - REMOVE EXISTING CONCRETE SIDEWALK AND CONSTRUCT NEW 100mm SIDEWALK c/w PAVING STONE BAND (SEE DETAIL 1)
  - RENEW EXISTING MONOLITHIC CURB RAMP (10mm HT. INTEGRAL)
  - CONSTRUCT NEW MODIFIED BARRIER CURB (150mm AVG. HT. REVEAL DOWELLED)
  - REMOVE EXISTING BARRIER CURB
  - RENEW EXISTING BARRIER CURB (100mm AVG. HT. REVEAL)
  - ADJUST EXISTING CATCH BASIN/MANHOLE TO GRADE
  - REMOVE EXISTING FRAME AND COVER AND PLACE NEW FRAME AND COVER (AP-004 AND AP-005)
  - INSTALL NEW CAST IRON RISER RING
  - INSTALL NEW DETECTABLE SURFACE WARNING TILES
  - REMOVE AND INSTALL NEW MTS MANHOLE FRAME AND COVER c/w 50mm CAST IRON RISER RING
  - ADJUST EXISTING HYDRO MANHOLE (BY OTHERS)
  - ADJUST EXISTING CURB STOP TO GRADE
  - ADJUST EXISTING VALVE BOX
  - REMOVE EXISTING CATCHBASIN AND CURB INLET
  - INSTALL NEW CURB AND GUTTER INLET c/w CATCHBASIN (SD-024) AND CONNECT TO EXISTING LEAD
  - INSTALL NEW CATCHBASIN (SD-024) c/w NEW FRAME AND GRATED COVER (AP-004 AND AP-006)
  - REGRADE EXISTING PAVING STONES
  - REMOVE EXISTING TREE WELL
  - REMOVE AND REINSTALL EXISTING BENCH (BY OTHERS)
  - REMOVE AND REINSTALL EXISTING GARBAGE BIN (BY OTHERS)
  - REMOVE AND REINSTALL EXISTING BUS SHELTER (BY OTHERS)
  - INSTALL PAVING STONE (SEE DETAIL 2)
  - INSTALL STREET LIGHTING CONDUIT AS DIRECTED. NEW LIGHT STANDARD BASES INSTALLED BY OTHERS
  - ABANDON EXISTING 200mm LDS

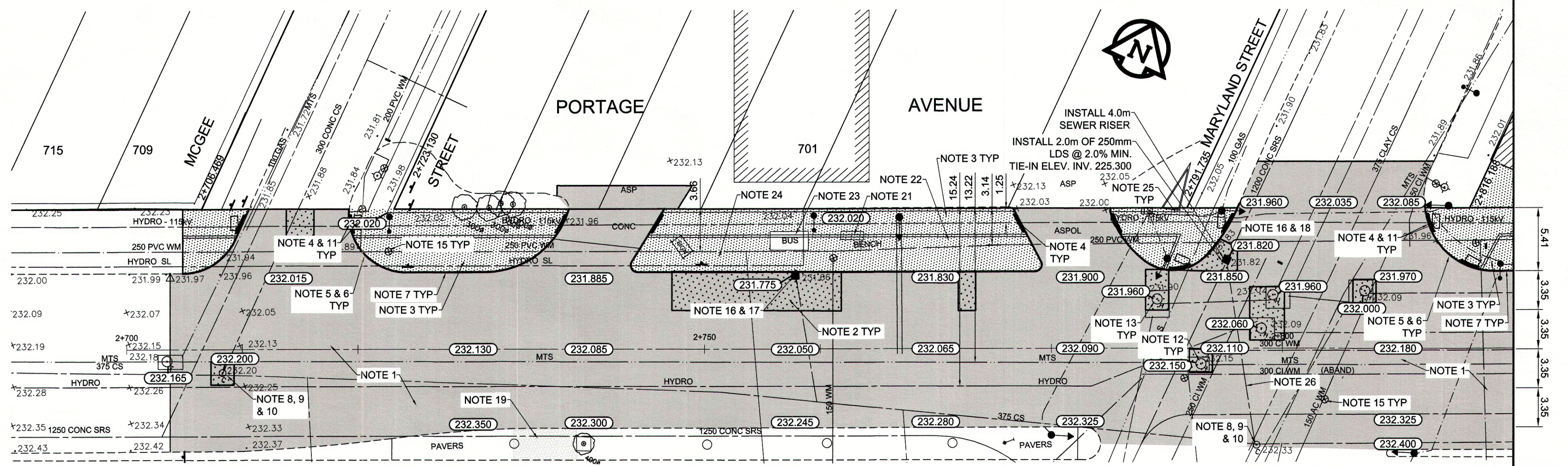

EXISTING	LEGEND - PLAN	PROPOSED	EXISTING	LEGEND - PLAN	PROPOSED	EXISTING	LEGEND - PROFILE	PROPOSED
150 mm W.M.	WATERMAIN	150 mm W.M.	HYDRO	HYDRO	150 mm W.M.	---	C PROFILE	---
300mm L.D.S.	VALVE	300mm L.D.S.	M.T.S.	M.T.S.	300mm L.D.S.	---	NORTH/WEST GUTTER	---
250mm W.W.S.	LAND DRAINAGE SEWER	250mm W.W.S.	CONCRETE	CONCRETE	250mm W.W.S.	---	MEDIAN GUTTER	---
	WASTEWATER SEWER		ASPHALT	ASPHALT		---	N/W PROPERTY LINE	---
	MANHOLE		PROPERTY LINE	PROPERTY LINE		---	S/E PROPERTY LINE	---
	CATCH BASIN		SURVEY BAR	SURVEY BAR		---		---
	CURB INLET		ELEVATION	ELEVATION		---		---
	BUILDING OUTLINE		TREE	TREE		---		---
	CULVERT		SIDEWALK RAMP	SIDEWALK RAMP		---		---
	GAS		CONCRETE SIDEWALK	CONCRETE SIDEWALK		---		---
			FENCE	FENCE		---		---

**LOCATION APPROVED UNDERGROUND STRUCTURES**

DATE: \_\_\_\_\_

NOTE: LOCATION OF UNDERGROUND STRUCTURES AS SHOWN ARE BASED ON THE BEST INFORMATION AVAILABLE. BUT NO GUARANTEE IS GIVEN THAT ALL EXISTING UTILITIES ARE SHOWN OR THAT THE GIVEN LOCATIONS ARE EXACT. CONFIRMATION OF EXISTENCE AND EXACT LOCATION OF ALL SERVICES MUST BE OBTAINED FROM THE INDIVIDUAL UTILITIES BEFORE PROCEEDING WITH CONSTRUCTION.

NO.	REVISIONS	DATE	BY
0	ISSUED FOR TENDER	2015/07/30	BC
A	ISSUED FOR REVIEW	2015/07/24	KWR

**AECOM**

DESIGNED BY: BC  
CHECKED BY: KWR  
DRAWN BY: RT, PB  
APPROVED BY: [Signature]  
HOR. SCALE: 1:250  
VERTICAL: 1:10  
RELEASED FOR CONSTRUCTION BY: [Signature]  
DATE: 2014/03/25

**METRIC**  
WHOLE NUMBERS INDICATE MILLIMETRES  
DECIMALIZED NUMBERS INDICATE METRES

**THE CITY OF WINNIPEG**  
PUBLIC WORKS DEPARTMENT  
ENGINEERING DIVISION

**PORTAGE AVENUE**  
MCGEE STREET TO FURBY STREET  
PAVEMENT REHABILITATION

WESTBOUND TRAFFIC LANES  
PLAN AND PROFILE  
MCGEE STREET TO STATION 2+820

CITY DRAWING NUMBER: P-3469-04  
SHEET 04 OF 10

ENGINEER'S SEAL: [Professional Engineer Seal]  
CONSULTANT DRAWING NO.: CT-04