

WESTBOUND

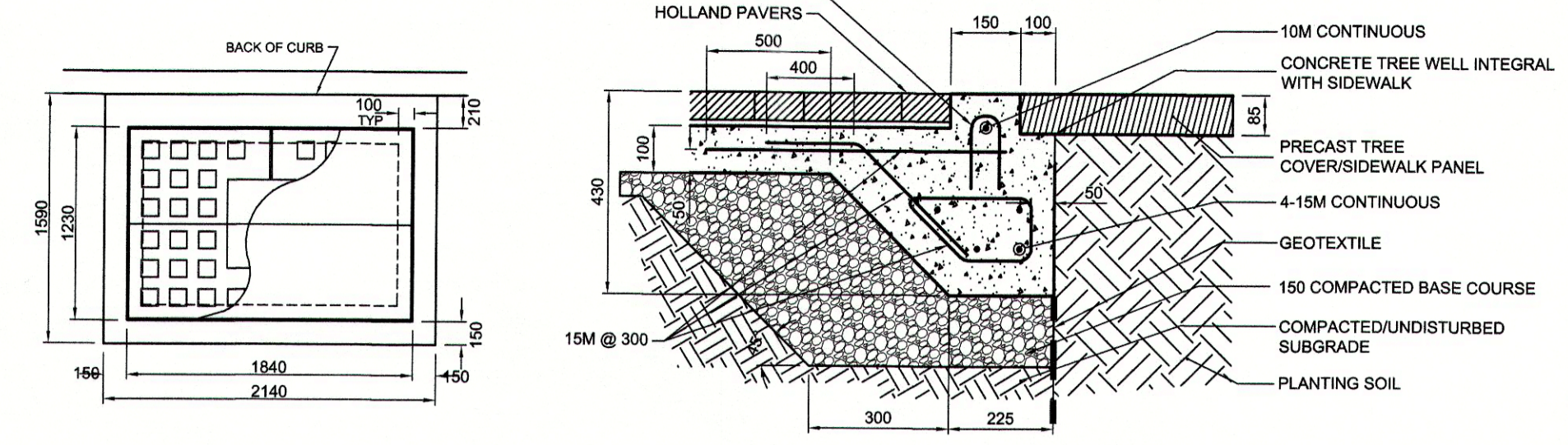

TREE WELL DETAIL 3

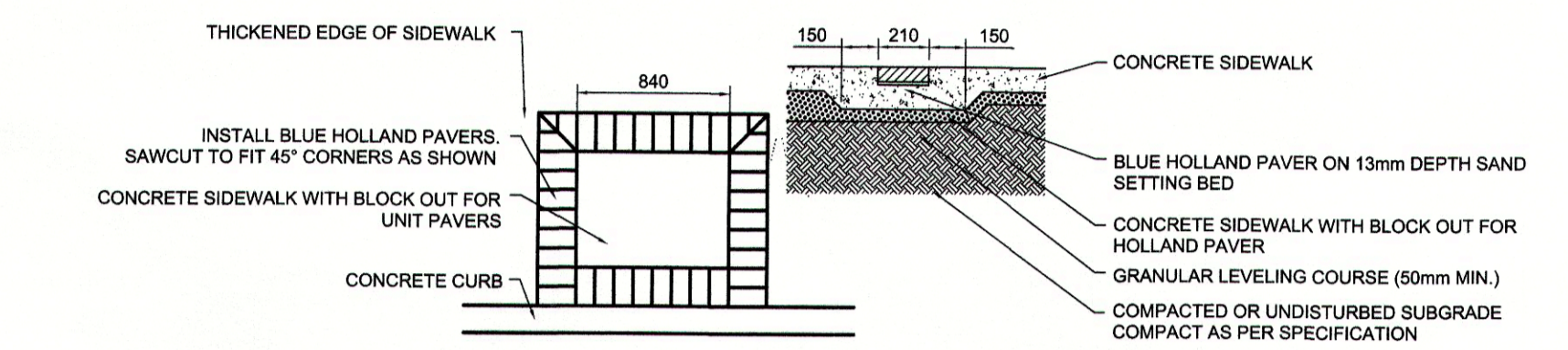

SIDEWALK DETAIL 1

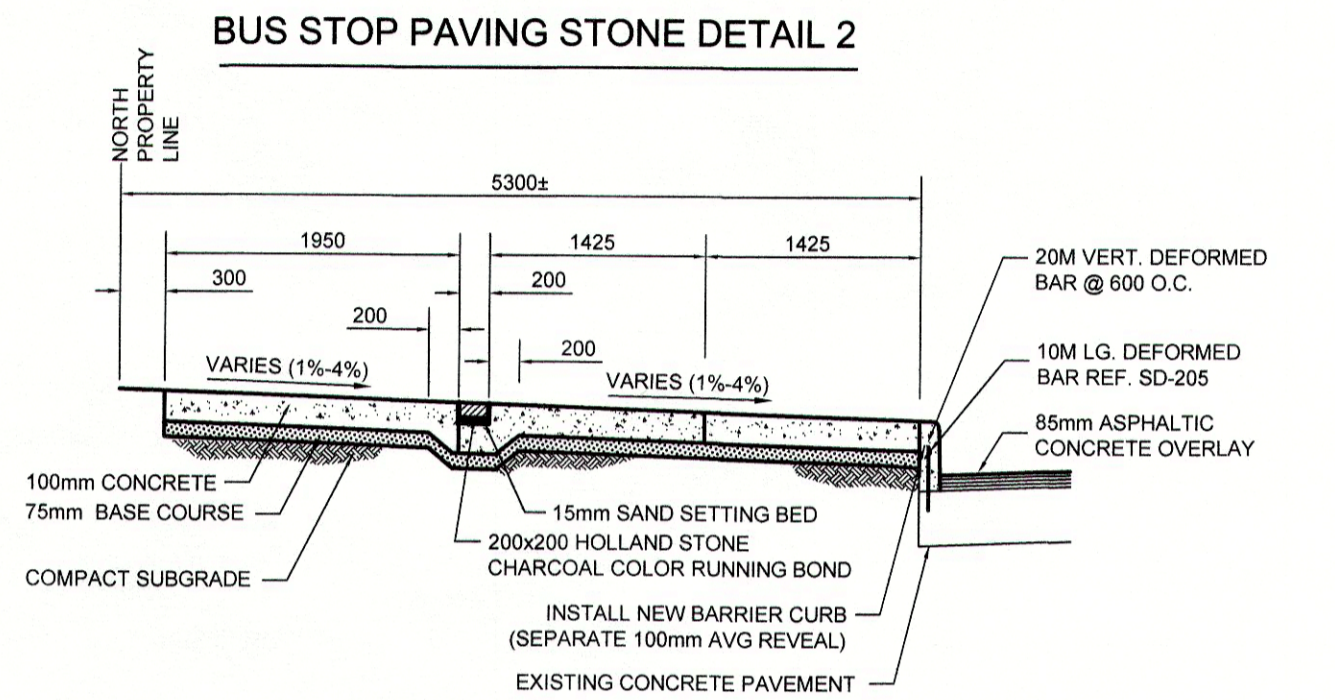

BUS STOP PAVING STONE DETAIL 2

- REFERENCE NOTES**
- PAVEMENT DIMENSIONS ARE TO BACK OF CURB
 - BASELINE IS 12.0M SOUTH OF NORTH PROPERTY LINE
 - PROPERTY LINES OBTAINED FROM THE CITY OF WINNIPEG L.B.I.S., AND NO SCALE FACTOR WAS APPLIED
 - REFER TO AECOM FIELD BOOK NO. 4821, 4822 & 4823

- CONSTRUCTION NOTES:**
- PLANE EXISTING ASPHALT AND CONSTRUCT NEW ASPHALTIC PAVEMENT OVERLAY TYPE 1A (AVERAGE THICKNESS 85mm)
 - REMOVE EXISTING PAVEMENT AND CONSTRUCT NEW 200mm REINFORCED CONCRETE PAVEMENT c/w 85mm TYPE 1A ASPHALT OVERLAY
 - REMOVE EXISTING CONCRETE SIDEWALK AND CONSTRUCT NEW 100mm SIDEWALK c/w PAVING STONE BAND (SEE DETAIL 1)
 - RENEW EXISTING MONOLITHIC CURB RAMP (10mm HT. INTEGRAL)
 - CONSTRUCT NEW MODIFIED BARRIER CURB (150mm AVG. HT. REVEAL, DOWELLED)
 - REMOVE EXISTING BARRIER CURB
 - RENEW EXISTING BARRIER CURB (100mm AVG. HT. REVEAL)
 - ADJUST EXISTING CATCH BASIN MANHOLE TO GRADE
 - REMOVE EXISTING FRAME AND COVER AND PLACE NEW FRAME AND COVER (AP-004 AND AP-005)
 - INSTALL NEW CAST IRON RISER RING
 - INSTALL NEW DETECTABLE SURFACE WARNING TILES
 - REMOVE AND INSTALL NEW MTS MANHOLE FRAME AND COVER c/w 50mm CAST IRON RISER RING
 - ADJUST EXISTING HYDRO MANHOLE (BY OTHERS)
 - ADJUST EXISTING CURB STOP TO GRADE
 - ADJUST EXISTING VALVE BOX
 - REMOVE EXISTING CATCHBASIN AND CURB INLET
 - INSTALL NEW CURB AND GUTTER INLET c/w CATCHBASIN (SD-024) AND CONNECT TO EXISTING LEAD
 - REGRADE EXISTING PAVING STONES
 - REMOVE EXISTING TREE WELL
 - CONSTRUCT NEW CONCRETE TREEWELL (SEE DETAIL 3)
 - REMOVE AND REINSTALL EXISTING BENCH (BY OTHERS)
 - REMOVE AND REINSTALL EXISTING GARBAGE BIN (BY OTHERS)
 - INSTALL PAVING STONE (SEE DETAIL 2)
 - INSTALL STREET LIGHTING CONDUIT AS DIRECTED. NEW LIGHT STANDARD BASES INSTALLED BY OTHERS

MATCHLINE 2+820

MATCHLINE 2+940

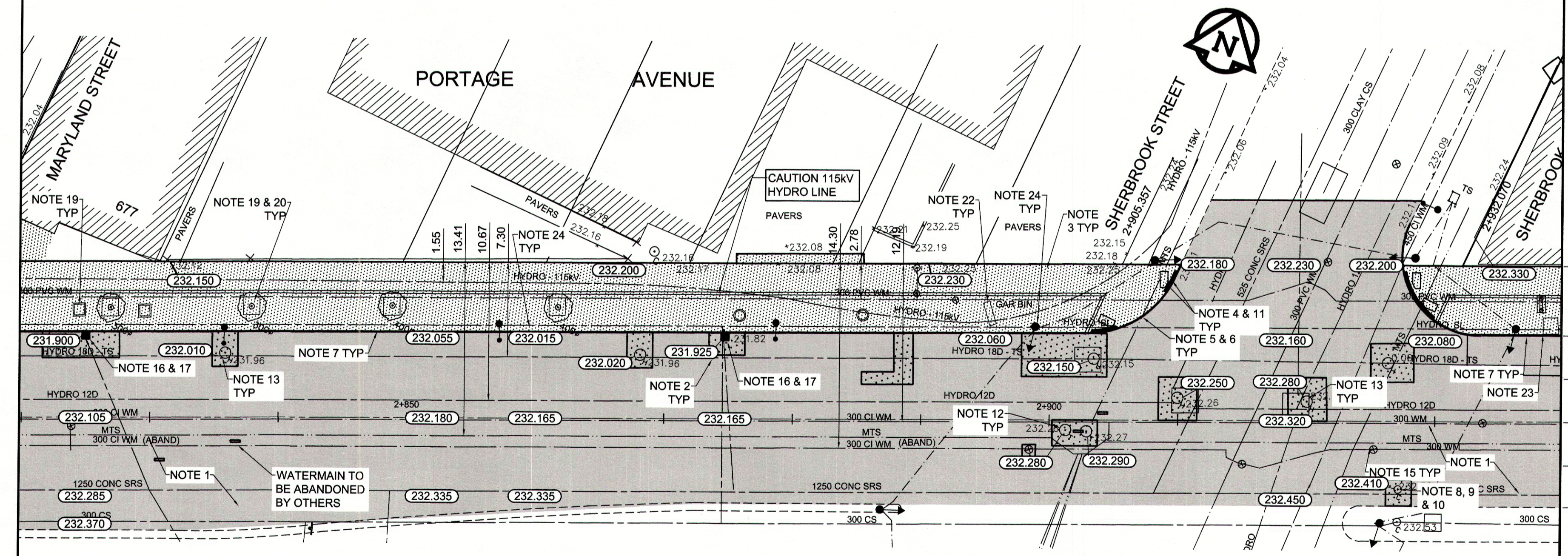

EXISTING	LEGEND - PLAN	PROPOSED	EXISTING	LEGEND - PLAN	PROPOSED	EXISTING	LEGEND - PROFILE	PROPOSED
150 mm W.W.M.	WATERMAIN	150 mm W.W.M.	Hydro	Hydro	Hydro	⊗	C PROFILE	---
Hydrant	HYDRANT	Hydrant	M.T.S.	M.T.S.	M.T.S.	⊙	NORTH/WEST GUTTER	---
Valve	VALVE	Valve	CONCRETE	CONCRETE	CONCRETE	⊚	MEDIAN GUTTER	---
300mm L.D.S.	LAND DRAINAGE SEWER	300mm L.D.S.	ASPHALT	ASPHALT	ASPHALT	⊛	N/W PROPERTY LINE	---
250mm W.W.S.	WASTEWATER SEWER	250mm W.W.S.	PROPERTY LINE	PROPERTY LINE	PROPERTY LINE	⊜	S/E PROPERTY LINE	---
Manhole	MANHOLE	Manhole	SURVEY BAR	SURVEY BAR	SURVEY BAR	⊝		
Catch Basin	CATCH BASIN	Catch Basin	ELEVATION	ELEVATION	ELEVATION	⊞		
Curb Inlet	CURB INLET	Curb Inlet	TREE	TREE	TREE	⊟		
Building Outline	BUILDING OUTLINE	Building Outline	SIDEWALK RAMP	SIDEWALK RAMP	SIDEWALK RAMP	⊠		
Culvert	CULVERT	Culvert	CONCRETE SIDEWALK	CONCRETE SIDEWALK	CONCRETE SIDEWALK	⊡		
Gas	GAS	Gas	FENCE	FENCE	FENCE	⊢		

LOCATION APPROVED UNDERGROUND STRUCTURES

DATE: _____

NOTE: LOCATION OF UNDERGROUND STRUCTURES AS SHOWN ARE BASED ON THE BEST INFORMATION AVAILABLE. BUT NO GUARANTEE IS GIVEN THAT ALL EXISTING UTILITIES ARE SHOWN OR THAT THE GIVEN LOCATIONS ARE EXACT. CONFIRMATION OF EXISTENCE AND EXACT LOCATION OF ALL SERVICES MUST BE OBTAINED FROM THE INDIVIDUAL UTILITIES BEFORE PROCEEDING WITH CONSTRUCTION.

NO.	REVISIONS	DATE	BY
0	ISSUED FOR TENDER	2015/07/30	BC
A	ISSUED FOR REVIEW	2015/07/24	KWR

AECOM

DESIGNED BY: BC
CHECKED BY: KWR
DRAWN BY: RT, PB
APPROVED BY: _____

HOR. SCALE: 1:250
VERTICAL: 1:10

RELEASED FOR CONSTRUCTION BY: _____
DATE: JUL 20 2015

ENGINEER'S SEAL

PROVINCE OF MANITOBA

REGISTERED PROFESSIONAL ENGINEER

FINDLAY
Member
23820
2013/07/13

CONSULTANT DRAWING NO. CT-05

METRIC

WHOLE NUMBERS INDICATE MILLIMETRES
DECIMAL NUMBERS INDICATE METRES

THE CITY OF WINNIPEG

PUBLIC WORKS DEPARTMENT
ENGINEERING DIVISION

PORTAGE AVENUE
MCGEE STREET TO FURBY STREET
PAVEMENT REHABILITATION

WESTBOUND TRAFFIC LANES
PLAN AND PROFILE
STATION 2+820 TO STATION 2+940

CITY DRAWING NUMBER P-3469-05
SHEET 05 OF 10