

EASTBOUND STREETSCAPING

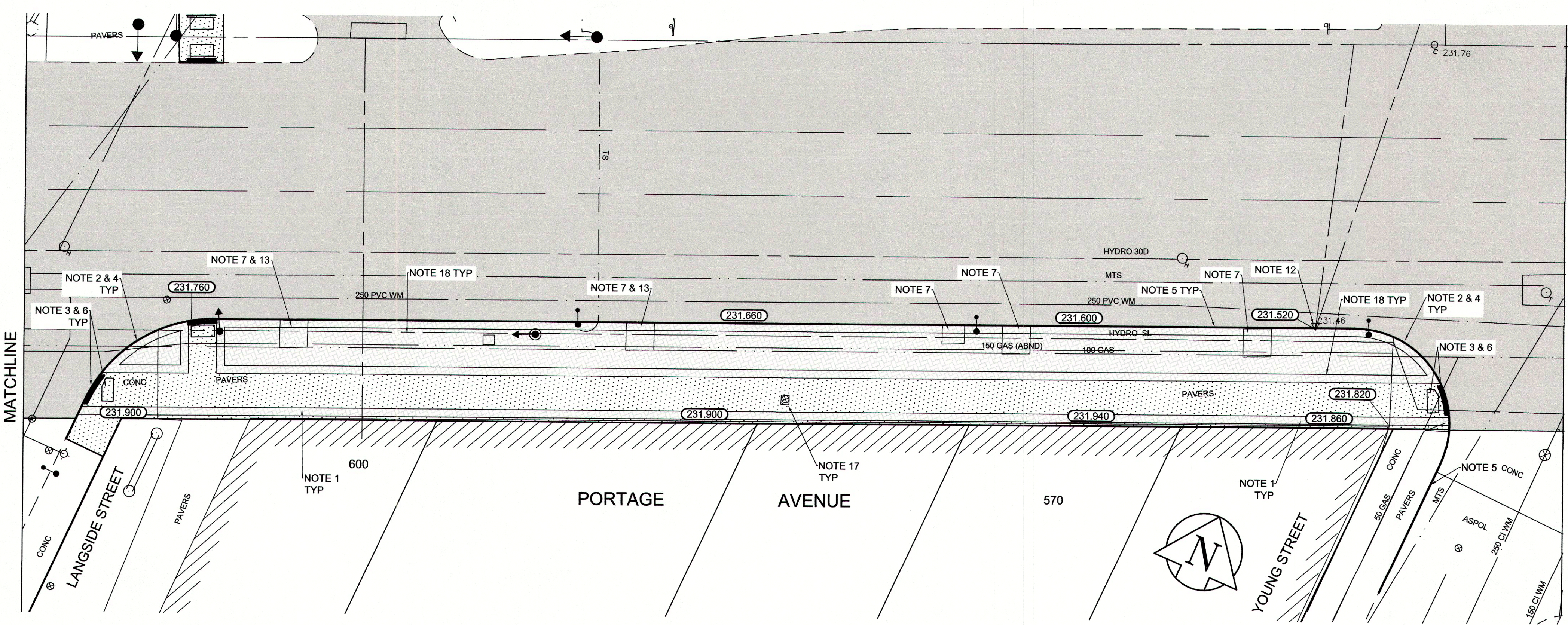

EASTBOUND STREETSCAPING

CONSTRUCTION NOTES

1. REMOVE EXISTING CONCRETE AND PAVING STONE SIDEWALK AND CONSTRUCT NEW 100mm SIDEWALK c/w PAVING STONE (SEE DETAIL 1 AND 2 ON CT-09)
2. CONSTRUCT NEW MODIFIED BARRIER CURB (150mm AVG. HT. REVEAL, DOWELLED)
3. RENEW EXISTING MONOLITHIC CURB RAMP (10mm HT. REVEAL, SEPARATE)
4. REMOVE EXISTING BARRIER CURB
5. RENEW EXISTING BARRIER CURB (100mm AVG. HT. REVEAL)
6. INSTALL NEW DETECTABLE SURFACE WARNING TILE
7. REMOVE EXISTING TREE WELL
8. CONSTRUCT NEW CONCRETE TREE WELL (SEE DETAIL 3 ON CT-09)
9. REMOVE AND REINSTALL EXISTING BENCH (BY OTHERS)
10. REMOVE AND REINSTALL EXISTING GARBAGE BIN (BY OTHERS)
11. INSTALL BUS PAD AND RELATED PAVING STONES (SEE DETAIL 4 ON CT-09)
12. ADJUST EXISTING CATCHBASIN AND CURB INLET
13. REMOVE AND REINSTALL EXISTING PLANTER
14. REMOVE AND REINSTALL EXISTING BUS SHELTER (BY OTHERS)
15. REMOVE AND REINSTALL EXISTING BIKE RACKS
16. ADJUST EXISTING CURB STOP
17. ADJUST EXISTING VALVE BOX
18. INSTALL STREET LIGHT CONDUIT AS DIRECTED. NEW LIGHT STANDARD BASES INSTALLED BY OTHERS
19. SEE DETAILS 5 AND 6 ON CT-09 FOR PAVER TREATMENT AT NEW CONCRETE BASES
20. ABANDON EXISTING HYDRO MANHOLE (BY OTHERS)

150 mm W.M.	WATERMAIN	150 mm W.M.	HYDRO	---	x	PROFILE	---
300mm L.D.S.	LAND DRAINAGE SEWER	300mm L.D.S.	M.T.S.	---	o	SOUTH/EAST GUTTER	---
250mm W.W.S.	WASTEWATER SEWER	250mm W.W.S.	CONCRETE	---	o	MEDIAN GUTTER	---
o	MANHOLE	o	ASPHALT	---	o	NW PROPERTY LINE	---
□	CATCH BASIN	235.750	PROPERTY LINE	---	o	S/E PROPERTY LINE	---
▽	CURB INLET	500e	SURVEY BAR	---	o	ELEVATION	(35.750)
+	JUNCTIONS	---	TREE	---	o	SIDEWALK RAMP	---
---	CULVERT	---	SURVEY BAR	---	o	CONCRETE SIDEWALK	---
---	GAS	---	ELEVATION	---	o	FENCE	---
---	EXISTING	---	SIDEWALK RAMP	---	o	LEGEND - PLAN	PROPOSED
---	LEGEND - PLAN	---	CONCRETE SIDEWALK	---	o	LEGEND - PROFILE	PROPOSED
---	PROPOSED	---	FENCE	---	o	LEGEND - PROFILE	PROPOSED

LOCATION APPROVED UNDERGROUND STRUCTURES

SUPV. U/G STRUCTURES COMMITTEE DATE

NOTE: LOCATION OF UNDERGROUND STRUCTURES AS SHOWN ARE BASED ON THE BEST INFORMATION AVAILABLE. BUT NO GUARANTEE IS GIVEN THAT ALL EXISTING UTILITIES ARE SHOWN OR THAT THE GIVEN LOCATIONS ARE EXACT. CONFIRMATION OF EXISTENCE AND EXACT LOCATION OF ALL SERVICES MUST BE OBTAINED FROM THE INDIVIDUAL UTILITIES BEFORE PROCEEDING WITH CONSTRUCTION.

B.M. 89R581	S.W. corner Portage Ave. & Sprague St. 10m on pipe.		
ELEV. 232.540	4.8m E. of W.L. Sprague St. produced from the W. along the S.L. of Portage Ave.		
0	ISSUED FOR TENDER	2015/07/30	BC
A	ISSUED FOR REVIEW	2015/07/24	KWR
NO.	REVISIONS	DATE	BY

AECOM

DESIGNED BY: KWR

CHECKED BY: KWR

DRAWN BY: RT,PB

APPROVED BY:

HOR. SCALE: 1:150

VERTICAL:

RELEASED FOR CONSTRUCTION BY:

DATE: 2015/07/24

ENGINEER'S SEAL

PROVINCE OF MANITOBA

REGISTERED PROFESSIONAL ENGINEER

JAN FINDLAY

Member 23820

CONSULTANT DRAWING NO. CT-08

THE CITY OF WINNIPEG

PUBLIC WORKS DEPARTMENT

ENGINEERING DIVISION

PORTAGE AVENUE

FURBY STREET TO SPENCE STREET

SIDEWALK STREETSCAPING

EASTBOUND SIDEWALK STREETSCAPING

FURBY STREET TO YOUNG STREET

CITY DRAWING NUMBER P-3469-08

SHEET 08 OF 10