

Ownership of Documents:
 Drawings and specifications as instruments of service are and shall remain the property of the Architect whether the project for which they are made is executed or not. They are not to be used by the owner on other projects or extensions to this project except by agreement in writing and with appropriate compensation to the Architect.

This drawing shall not be scaled. Follow given dimensions only.

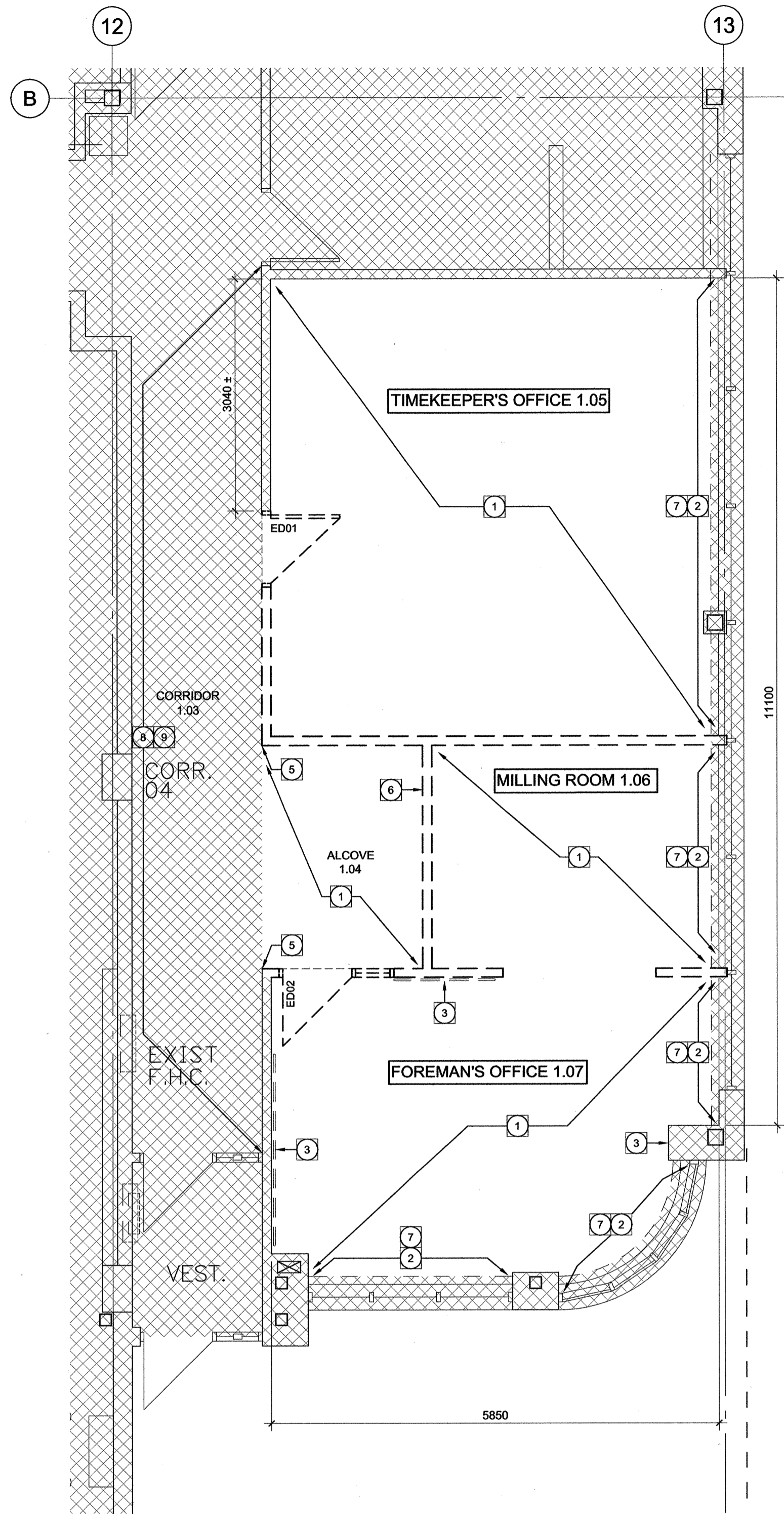
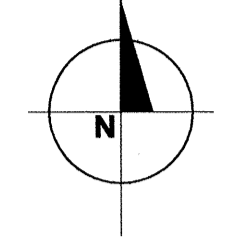

1 DEMOLITION FLOOR PLAN
 Scale 1:50

GENERAL NOTES:

1. ITEMS SHOWN AS DASHED/BROKEN LINES ARE TO BE REMOVED AND DISCARDED.
2. COORDINATE WORK INDICATED WITH WORK SHOWN ON MECHANICAL AND ELECTRICAL DRAWINGS.
3. CITY OF WINNIPEG TENANT INTENDS TO VACATE THE SPACE FOR THE DURATION OF THE CONSTRUCTION. G.C. TO PROVIDE TIME FOR RELOCATION INTO HISHER SCHEDULE.

DEMOLITION FLOOR PLAN NOTES:

- 1 REMOVE FLOORING AND WALL BASE
- 2 REMOVE VERTICAL BLINDS
- 3 REMOVE CHAIR RAIL
- 4 SALVAGE SHORT WIRE RADIO FOR REUSE
- 5 REMOVE FULL HEIGHT CORNER GUARDS. TURN OVER TO OWNER.
- 6 UNASSIGNED.
- 7 REMOVE PLASTIC LAMINATE FINISHED WINDOW SILLS FROM AREA OF WORK. SALVAGE ONE SILL TO USE AS TEMPLATE.
- 8 REMOVE RESILIENT WALL BASE FROM EAST WALL OF CORRIDOR 1.03.
- 9 REMOVE WALL HUNG ARTIFACTS, ACCESSORIES AND NON-PERMANENT EQUIPMENT TO PREPARE WALL FOR NEW PAINT FINISH.

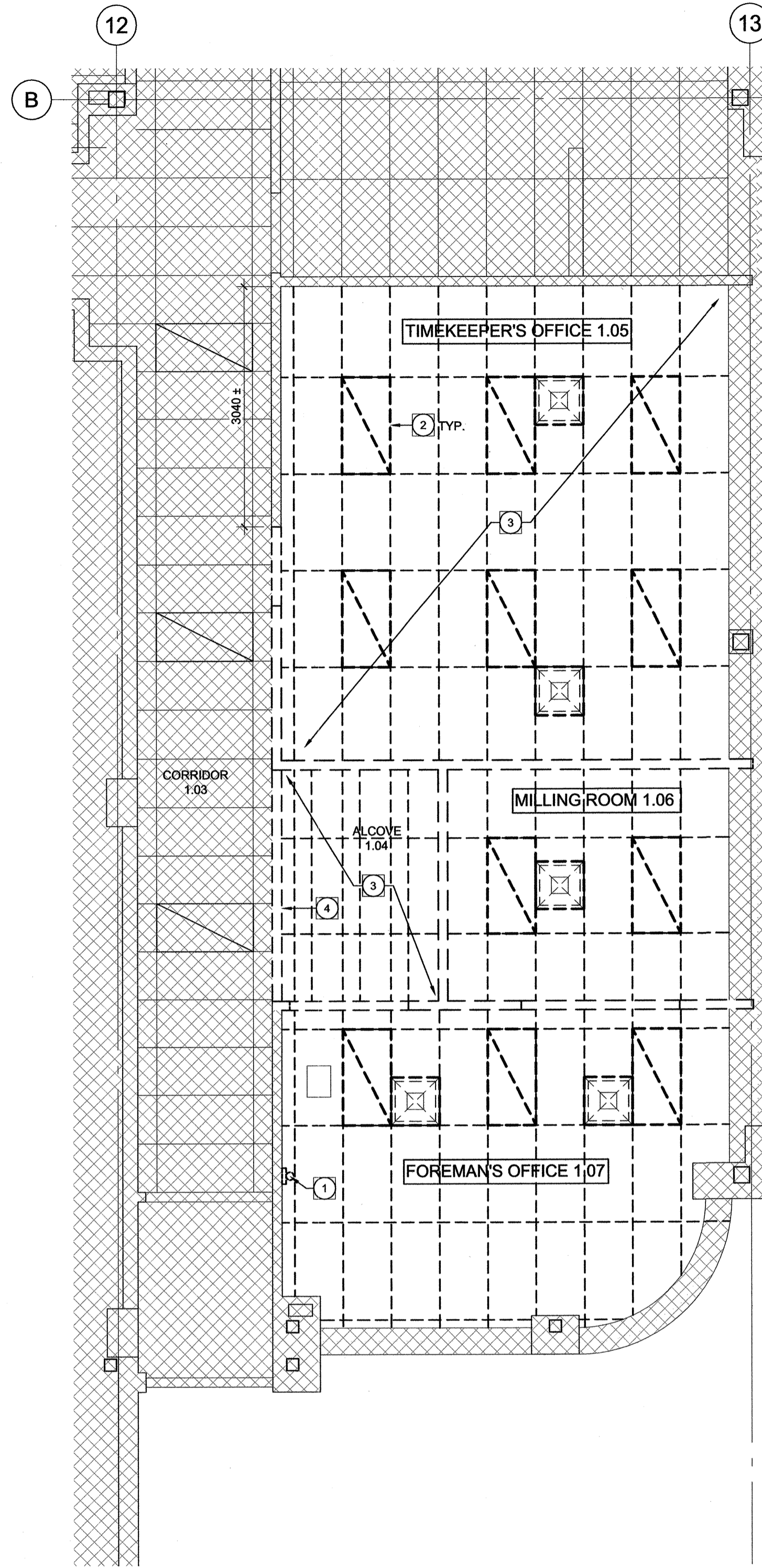

2 DEMOLITION REFLECTED CEILING PLAN
 Scale 1:50

DEMOLITION REFLECTED CEILING PLAN NOTES:

- 1 REMOVE EMERGENCY LIGHT.
- 2 REMOVE LIGHT FIXTURES AND DISCARD(TYPICAL).
- 3 REMOVE CEILING SUSPENSION SYSTEM AND ACOUSTIC TILE.
- 4 REMOVE GWB BULKHEAD. TEMPORARILY SUPPORT CORRIDOR SUSPENSION SYSTEM UNTIL NEW PARTITION IS INSTALLED.

ISSUED FOR

ISSUED FOR CONSTRUCTION AUGUST 24, 2015

SEAL

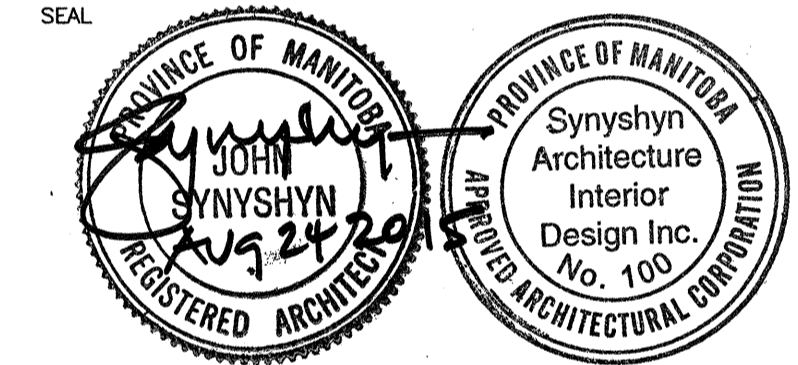

ARCHITECT / PRIME CONSULTANT

SYNYSHYN
 ARCHITECTURE + INTERIOR DESIGN INC.

MANITOBA • ALBERTA
 T: 204.947-1100
 F: 204.956-5742

603-63 Albert Street info@synyshyn.com
 Winnipeg, Manitoba
 R3B 1G4 Canada www.synyshyn.com

ENGINEERING CONSULTANT

ENGINEERING CONSULTANT

PROJECT TITLE
 CENTRAL YARDS FIELD
 SERVICES BUILDING

**1220 PACIFIC AVENUE
 OFFICE RENOVATION**

1220 PACIFIC AVE. WINNIPEG MANITOBA
 DRAWING TITLE

723-2015 DEMOLITION FLOOR
 PLAN AND REFLECTED CEILING
 PLAN_A1-R0

DESIGNED BY JN DRAWN BY JN

ISSUE DATE 08-24-2015 REVISION No. 0

PROJECT No. 15004 DRAWING No. A-1