

PT. No.	ITEM	QTY	DESCRIPTION	REFERENCE'S DWG
1.	CORRIDOR UNIT TOP PANEL	1	0.051 ALUMINIUM PLATE 19"x36"	ST-145 3 OF 3
2.	CORRIDOR UNIT LEFT PANEL	1	0.051 ALUMINIUM PLATE 19"x32"	ST-145 3 OF 3
3.	CORRIDOR UNIT RIGHT PANEL	1	0.051 ALUMINIUM PLATE 19"x32"	ST-145 3 OF 3
4.	CORRIDOR UNIT BOTTOM PANEL	1	0.051 ALUMINIUM PLATE 19"x36"	ST-145 3 OF 3
5.	HANGER UNIT END PANEL	2	1/4 ALUMINIUM PLATE 4"x10 1/2"	ST-145 3 OF 3
6.	HANGER UNIT END COVER	1	1/4 GAUGE ALUMINIUM PLATE ø4"	ST-145 3 OF 3
7.	SPACERS	4	3/8" ALUMINIUM SPACER PLATE 4"x4"	ST-145 3 OF 3
8.	LAMP SUPPORT	1	0.051 ALUMINIUM CHANNEL 4 5/8"x13"	ST-145 3 OF 3
9.	BULB HANGER	1	0.051 ALUMINIUM 1/2"x11 5/8"	ST-145 3 OF 3
10.	CHANNEL 8" LONG	4	1/6 GAUGE GALVANIZED STEEL	ST-145 3 OF 3
11.	LAMP SUPPORT BRACKET	1	0.051 ALUMINIUM 1"x9"	ST-145 3 OF 3
12.	DOOR RETAINER BRACKET	1	0.051 ALUMINIUM 1 1/2"x2 3/4"	ST-145 3 OF 3
13.	DOOR RETAINER ROD	1	ø1/4" STAINLESS STEEL ROD	ST-145 3 OF 3
14.	SIDEWALL REINFORCING PLATE	2	1/4" OR TWO 1/8" STAINLESS STEEL THICK PLATES WELDED TOGETHER 2 1/2"x12"	ST-145 3 OF 3
15.	SODIUM LAMP SOCKET BRACKET ASSEMBLY	1	(5) 1/8" ALUMINIUM PLATE 2"x8" (5) 1/8" ALUMINIUM PLATE 1 3/4"x4" (5) 1/4" ALUMINIUM PLATE 2 1/2"x3 1/2"	ST-145 3 OF 3
16.	ALUMINIUM TUBING	1	2-13/16" O.D. 6061-T6 ALUMINIUM TUBING AND 36 1/4" LONG	ST-145 2 OF 3
17.	ALUMINIUM BLOCKS	2	ALUMINIUM BLOCKS 5/16"x1"x1"	ST-145 2 OF 3
18.	JUNCTION BOX	1	4"x4" (DEEP) C/W COVER	ST-145 2 OF 3
19.	SODIUM BALLAST	1	SEE GENERAL NOTE #4	ST-145 2 OF 3
20.	CABLE		(TO BE SUPPLIED BY CITY)	ST-145 2 OF 3
21.	DOWNLIGHTER LENS	1	1/8" LEXAN 14 5/8"x21" (CLEAR)	ST-145 1 OF 3
22.	SODIUM LAMP	1	(TO BE SUPPLIED BY CITY)	ST-145 2 OF 3
23.	EX-12 SECTION ( LEFT & RIGHT)	4	1"x1 7/8"x1/4" EX-12 SECTION 32 3/8" LONG	ST-145 2 OF 3
24.	EX-12 SECTION (TOP & BOTTOM)	4	1"x1 7/8"x1/4" EX-12 SECTION 36 1/4" LONG	ST-145 2 OF 3
25.	STAINLESS STEEL PIANO HINGE	1	STAINLESS STEEL PIANO HINGE 31 1/4"	ST-145 1 OF 3
26.	TERMINAL BLOCK	1		ST-145 2 OF 3
27.	SHIPPING BLOCK	2	2"x14"x1/2" WOOD BLOCK	
R	ALUMINIUM RIVETS		3/16" ALUMINIUM RIVET	ST-145 2 OF 3

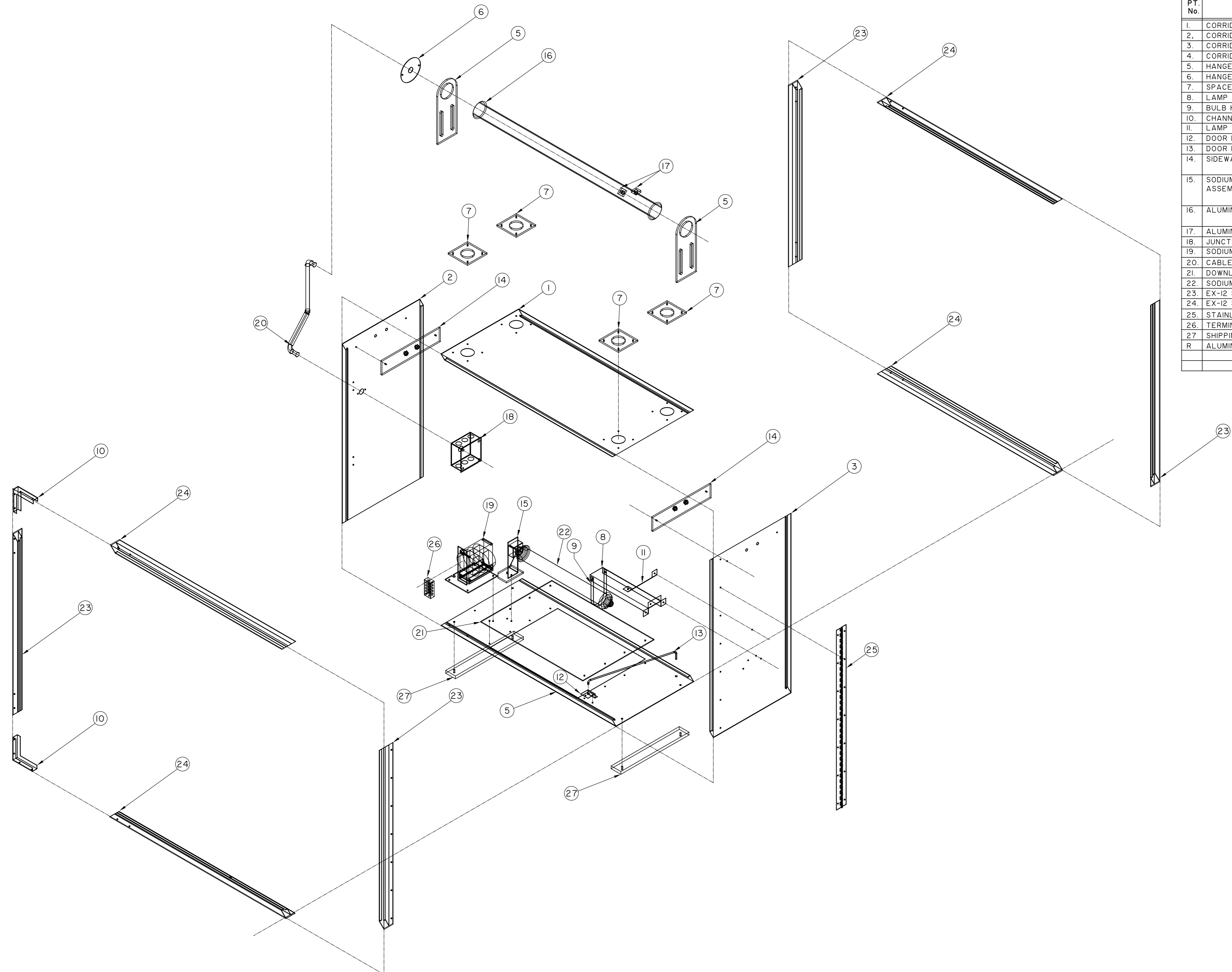

ASSEMBLY VIEW

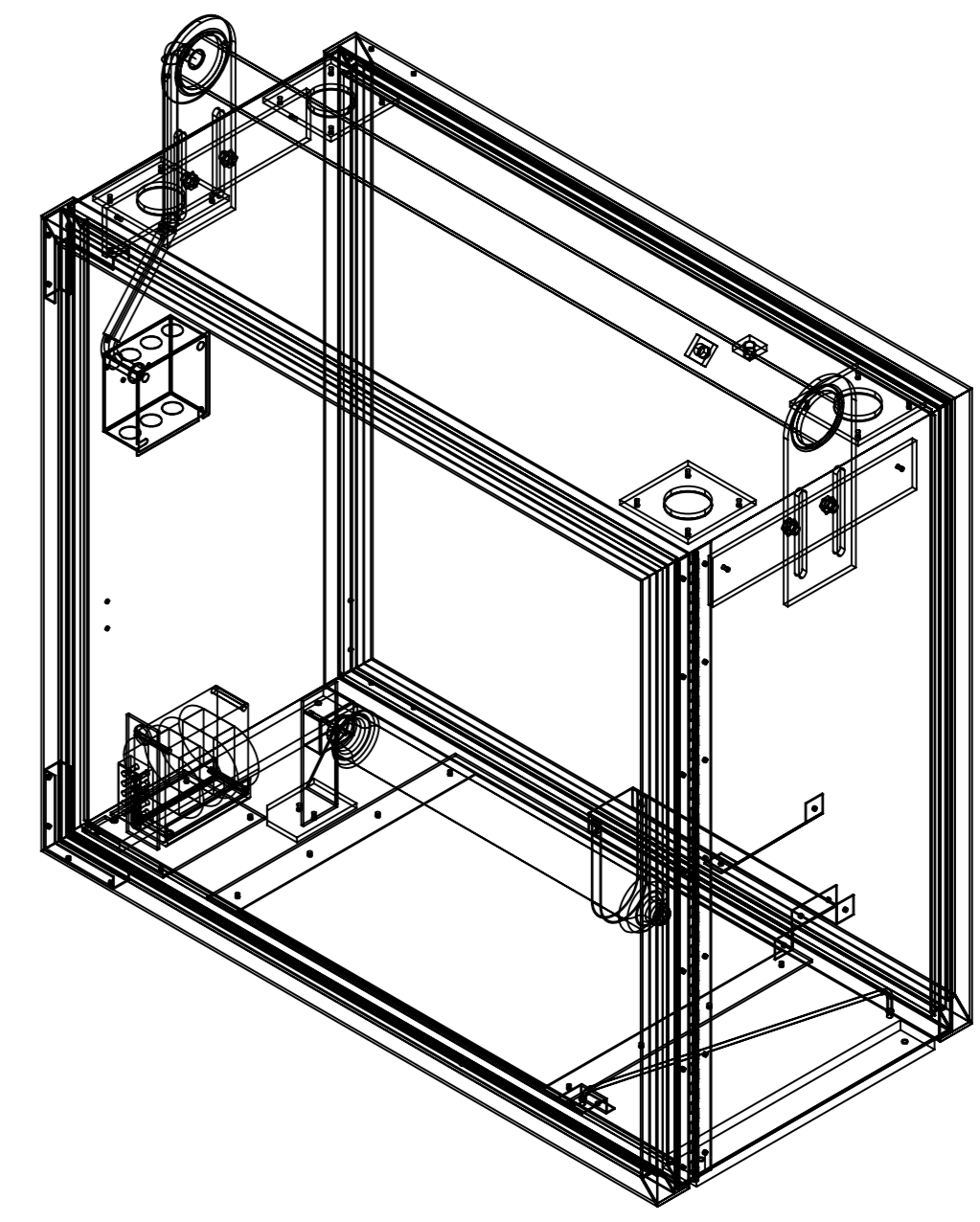

ISOMETRIC VIEW

TRAFFIC SIGNALS SYSTEM MANAGEMENT ENGINEER		DATE
MANAGER OF TRANSPORTATION ENGINEERING		DATE
1.	01.04.05 REDRAWN FROM MANUAL DWG. #M-456	
No.	DATE	REVISIONS
BY	DRAWN BY SW	2001.04.05 PRELIM. CHK.
		DATE



**THE CITY OF WINNIPEG**  
**PUBLIC WORKS DEPARTMENT**  
**TRANSPORTATION ENGINEERING DIVISION**

INTERNALLY ILLUMINATED PEDESTRIAN  
CORRIDOR SIGN UNIT 36" x 32"  
ASSEMBLY DRAWING

SCALE  
1/8"=1"  
DRAWING NO.  
ST-145  
1 OF 3

C:\WORKS\CLIP\CHANCE\ST-145-145.DWG