

**CONSTRUCTION NOTES:**

- ALL DIMENSIONS ARE TO BACK OF CURB.
- ISOLATE MISCELLANEOUS ITEMS IN NEW CONCRETE WORKS AS PER SD-228C OR DETAIL 2 IF ALIGNED WITH PAVING BAND.
- LEGAL PLAN AND UNDERGROUND INFORMATION FROM CITY OF WINNIPEG LBIS. CONTRACTOR TO VERIFY ALL UNDERGROUNDS IN THE FIELD.
- CONTRACTOR TO TAKE PRECAUTIONARY STEPS TO AVOID DAMAGE FROM CONSTRUCTION ACTIVITIES TO TREES WITHIN THE LIMITS OF CONSTRUCTION.
- LOCATION OF EXISTING SERVICES TO BE CONFIRMED IN THE FIELD BY THE CONTRACTOR.
- INSTALL CB LEADS AT MIN. 1.0% SLOPE OR AS DIRECTED BY CONTRACT ADMINISTRATOR.
- LIMITS OF SIDEWALK RENEWAL TO BE FINALIZED IN THE FIELD BY THE CONTRACT ADMINISTRATOR.
- LIMITS OF BOULEVARD GRADING TO BE FINALIZED IN THE FIELD BY THE CONTRACT ADMINISTRATOR.
- MONOLITHIC CURB AND SIDEWALK SP-228B REVEAL HEIGHT IS 150 mm UNLESS OTHERWISE DIRECTED BY THE CONTRACT ADMINISTRATOR.
- SEE SHEET 14 FOR TYPICAL CROSS SECTIONS AND DETAILS.
- PLANE EXISTING ASPHALT OVERLAY WITHIN LIMITS OF CONSTRUCTION TO DEPTH INDICATED BY THE CONTRACT ADMINISTRATOR.
- ADJUST ALL WATER VALVES, MANHOLES, AND DRAINAGE INLETS WITHIN LIMITS OF CONSTRUCTION.

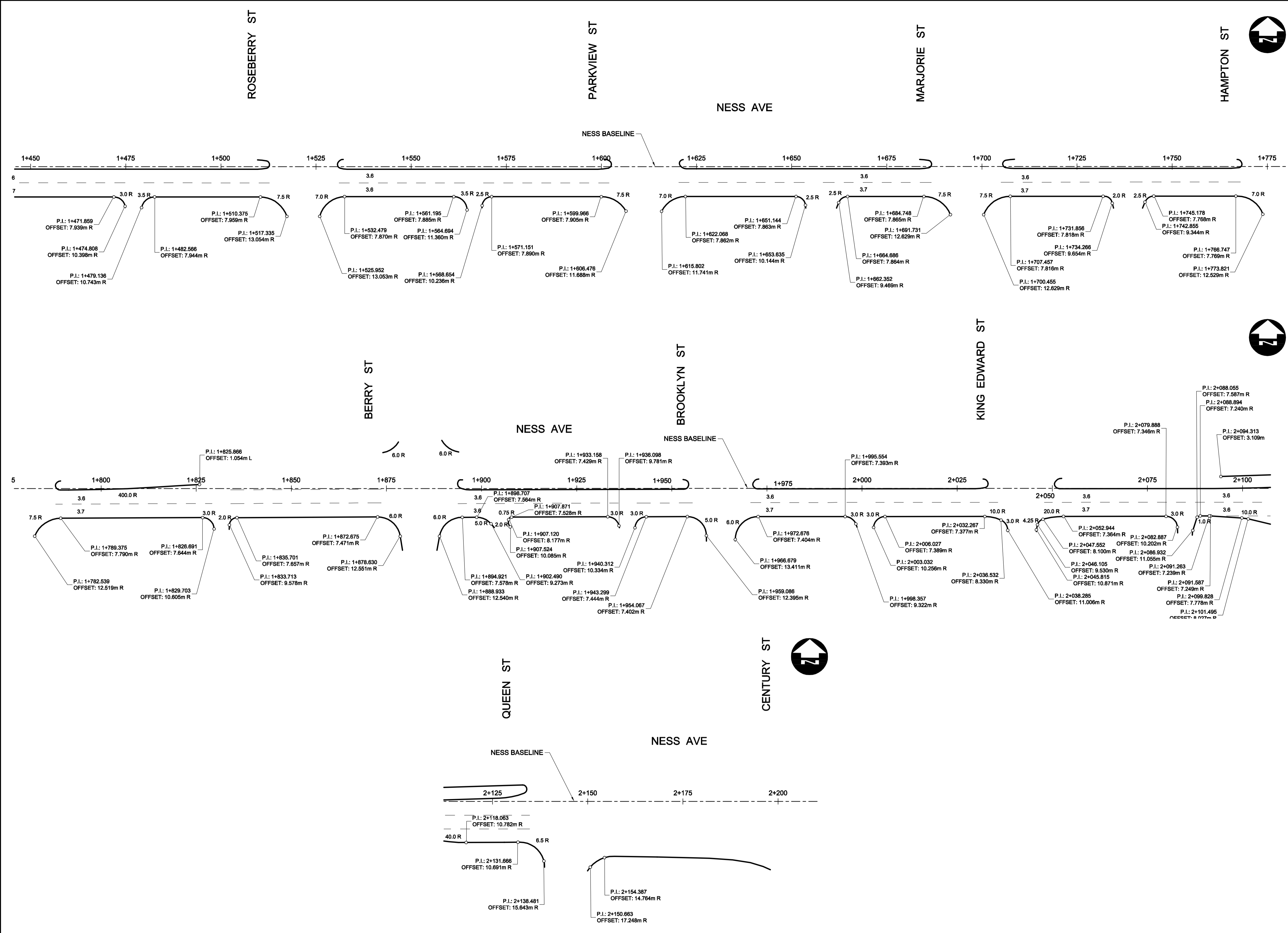

**METRIC**

WHOLE NUMBERS INDICATE MILLIMETRES  
DECIMALIZED NUMBERS INDICATE METRES

**WARNING**

- IF POWER EQUIPMENT OR EXPLOSIVES USED FOR EXCAVATION ON THIS PROJECT THE CONTRACTOR:
- NOTIFY THE GAS COMPANY OF THE PROPOSED LOCATION OF EXCAVATION.
  - TAKE PRECAUTION TO AVOID DAMAGE TO GAS COMPANY INSTALLATIONS SEE PROVINCIAL REGULATION 210/72 FOR DETAILS.
  - OBTAIN EXCAVATION PERMITS PRIOR TO CONSTRUCTION.

**APEGM**  
Certificate of Authorization  
**Dillon Consulting Limited (MB)**  
No. 1789 Date: 01/12/2015

**THE CITY OF WINNIPEG**  
PUBLIC WORKS DEPARTMENT

NESS AVE E/B REHABILITATION  
OVERDALE ST TO QUEEN ST

CITY DRAWING NUMBER: P-3465- 2  
SHEET 2 OF 17

HORIZONTAL GEOMETRY  
2 OF 2

CONSULTANT DRAWING NUMBER

150 WM	WATERMAIN	150 WM	HYDRO	HYDRO	HYDRO	150 WM	WATERMAIN	150 WM
+	HYDRANT	+	MTS	MTS	MTS	+	HYDRANT	+
+	VALVE	+	CONCRETE	CONCRETE	CONCRETE	+	VALVE	+
300 LDS	LAND DRAINAGE SEWER	300 LDS	ASPHALT	ASPHALT	ASPHALT	300 LDS	LAND DRAINAGE SEWER	300 LDS
250 WWS	WASTE WATER SEWER	250 WWS	PLANING	PLANING	PLANING	250 WWS	WASTE WATER SEWER	250 WWS
○	MANHOLE	○	SIDEWALK	SIDEWALK	SIDEWALK	○	MANHOLE	○
□	CATCH BASIN	□	PAVING STONES	PAVING STONES	PAVING STONES	□	CATCH BASIN	□
▽	CURB INLET	▽	PARTIAL DEPTH REPAIR	PARTIAL DEPTH REPAIR	PARTIAL DEPTH REPAIR	▽	CURB INLET	▽
+	JUNCTIONS	+	PROPERTY LINE	PROPERTY LINE	PROPERTY LINE	+	JUNCTIONS	+
+	CULVERT	+	DRAINAGE ARROW	DRAINAGE ARROW	DRAINAGE ARROW	+	CULVERT	+
100 GAS	GAS	100 GAS	CURB RAMP	CURB RAMP	CURB RAMP	100 GAS	GAS	100 GAS
EXISTING	LEGEND-PLAN	PROPOSED	EXISTING	LEGEND-PLAN	PROPOSED	EXISTING	LEGEND-PROFILE	PROPOSED

**UNDERGROUND STRUCTURES**

SUPV. U/G STRUCTURES DATE

LOCATION OF UNDERGROUND STRUCTURES AS SHOWN ARE BASED ON THE BEST INFORMATION AVAILABLE, BUT NO GUARANTEE IS GIVEN THAT ALL EXISTING UTILITIES ARE SHOWN OR THAT THE GIVEN LOCATIONS ARE EXACT. CONFIRMATION OF EXISTENCE AND EXACT LOCATION OF ALL SERVICES MUST BE OBTAINED FROM THE INDIVIDUAL UTILITIES BEFORE PROCEEDING WITH CONSTRUCTION.

B.M. ELEV.			
DESIGNED BY	PMW		
DRAWN BY	PMW		
CHECKED BY	TS		
APPROVED BY	DBW		
HOR. SCALE	1:500		
VERTICAL			
1	ISSUED FOR TENDER	01/12/15	DBW
NO.	REVISIONS	DATE	BY

DESIGNED BY: PMW  
DRAWN BY: PMW  
CHECKED BY: TS  
APPROVED BY: DBW  
HOR. SCALE: 1:500  
VERTICAL: [blank]

ENGINEER'S SEAL  
PROVINCE OF MANITOBA  
ORIGINAL STAMPED BY  
**D.B. WIEBE**  
01/12/2015  
Member  
22480  
REGISTERED PROFESSIONAL ENGINEER

RELEASED FOR CONSTRUCTION CONSTRUCTION

CONSULTANT PROJECT NUMBER  
**15-1674**

G:\CAD\151674\Drawings and Figures\Contract\151674-01-COIN-C-HORZ-GEOMETRY-NESS.dwg