

PARTIAL MAIN FLOOR PLAN - AREA OF WORK
SCALE: 1/4"=1'-0"

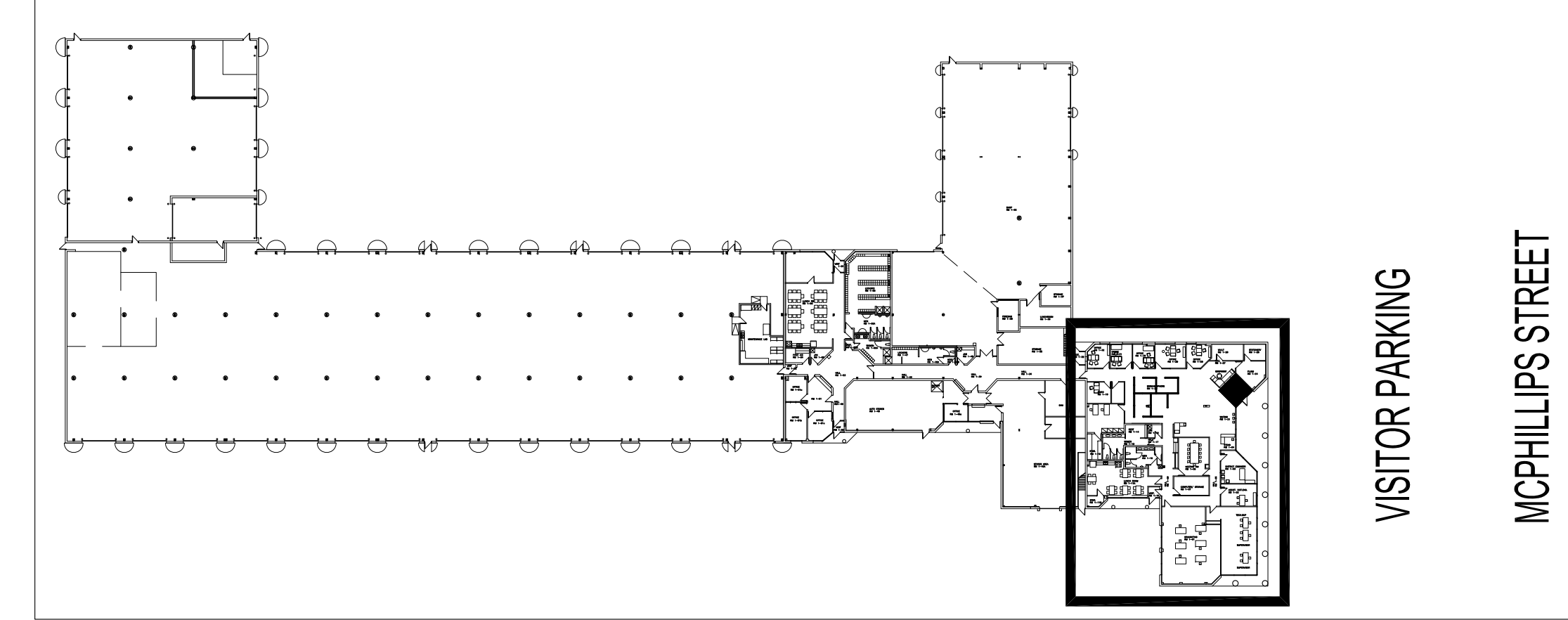

KEY PLAN
SCALE: NTS

DRAWING LIST	
SHEET No:	SHEET TITLE
A0	KEY PLAN/AREA OF WORK
A1	DEMOLITION PLAN
A2	NEW CONSTRUCTION

NOTES -

THESE DRAWINGS SHALL NOT BE SCALED.

THE CONTRACTOR SHALL VISIT THE SITE AND SATISFY ONESELF ALL DIMENSIONS, DATUM, AND DETAILED INFORMATION SHOWN ARE CORRECT.

ALL PRODUCTS AND MATERIALS TO BE USED AND INSTALLED SHALL CONFORM WITH MANUFACTURERS SPECIFICATIONS & APPLICABLE CODES.

THE CONTRACTOR SHALL BE RESPONSIBLE TO PATCH AND MAKE GOOD ALL EXISTING CONSTRUCTION AFFECTED BY THE REMOVAL OF ALL ITEMS FORMING THE PART OF THE RENOVATION WORK.

WHERE NEW FLOORING AND BASE IS TO BE INSTALLED IN EXISTING AREAS (REFER TO FLOOR PLAN AND ROOM SCHEDULE), THE EXISTING FLOORING SURFACE AND BASE MUST BE REMOVED, UNLESS OTHERWISE NOTED. ALL FLOOR SURFACES SHALL BE PREPARED IN ACCORDANCE TO MANUFACTURERS RECOMMENDATIONS FOR INSTALLATION OF NEW FLOOR.

WHERE PAINTING OF EXISTING WALLS IS INDICATED ON THE ROOM SCHEDULE, THESE WALLS MUST BE CLEANED OF ANY EXISTING WALL COVERING, PATCHED & PREPARED TO ACCEPT NEW MATERIAL, UNLESS OTHERWISE NOTED.

ALL PAINTS AND ADHESIVES USED TO BE LOW VOC.

ALL CONSTRUCTION TO BE HOARDED VIA 6MM POLY AND DRYWALL FOR DUST CONTROL WITHIN PROJECT SPACE.

CONTRACTOR TO ENSURE WORKSITE IS KEPT CLEAN OF DUST AND DEBRIS AT THE END OF EACH WORKDAY.

NO.	REVISION/DESCRIPTION	BY	DATE
0	ISSUED FOR BID	CEA	2015.09.25

DRAWN BY	CHECKED BY	APPROVED
CEA	CEA	CEA
DATE: 2015.09.25	USER APPROVAL	

THE CITY OF WINNIPEG
PLANNING, PROPERTY & DEVELOPMENT DEPARTMENT
PROPERTY MANAGEMENT BRANCH
MUNICIPAL ACCOMMODATIONS DIV.
3RD FLOOR, 65 GARRY ST. R3C 4K4

PROJECT
FPS TRAINING
CARPET & BLIND RENO

2546 McPHILLIPS STREET
SHEET TITLE

KEY PLAN/AREA OF WORK

SCALE	PROJECT NO.	SHEET NO.
AS SHOWN	2015-107	A0