

LEGEND

	EXISTING	NEW
SEWER MH	○	●
SEWER PLUG	⊥	
SEWER CB	□	
SEWER STRUCT	□	
WM	—	—
WM VALVE	⊗	⊗
WM HYDRANT	⊕	⊕
GAS	—	—
HYDRO	—	—
HYDRO POLE	●HP	●HP
HYDRO STR	□	□
HYDRO POLE	●H	●H
HYDRO TRANSFORMER	⊗	⊗
BOLLARD	⊗	⊗
TREE	⊗	⊗
CULVERT	—	—
DITCH	—	—
ROAD	—	—
FENCE	—	—

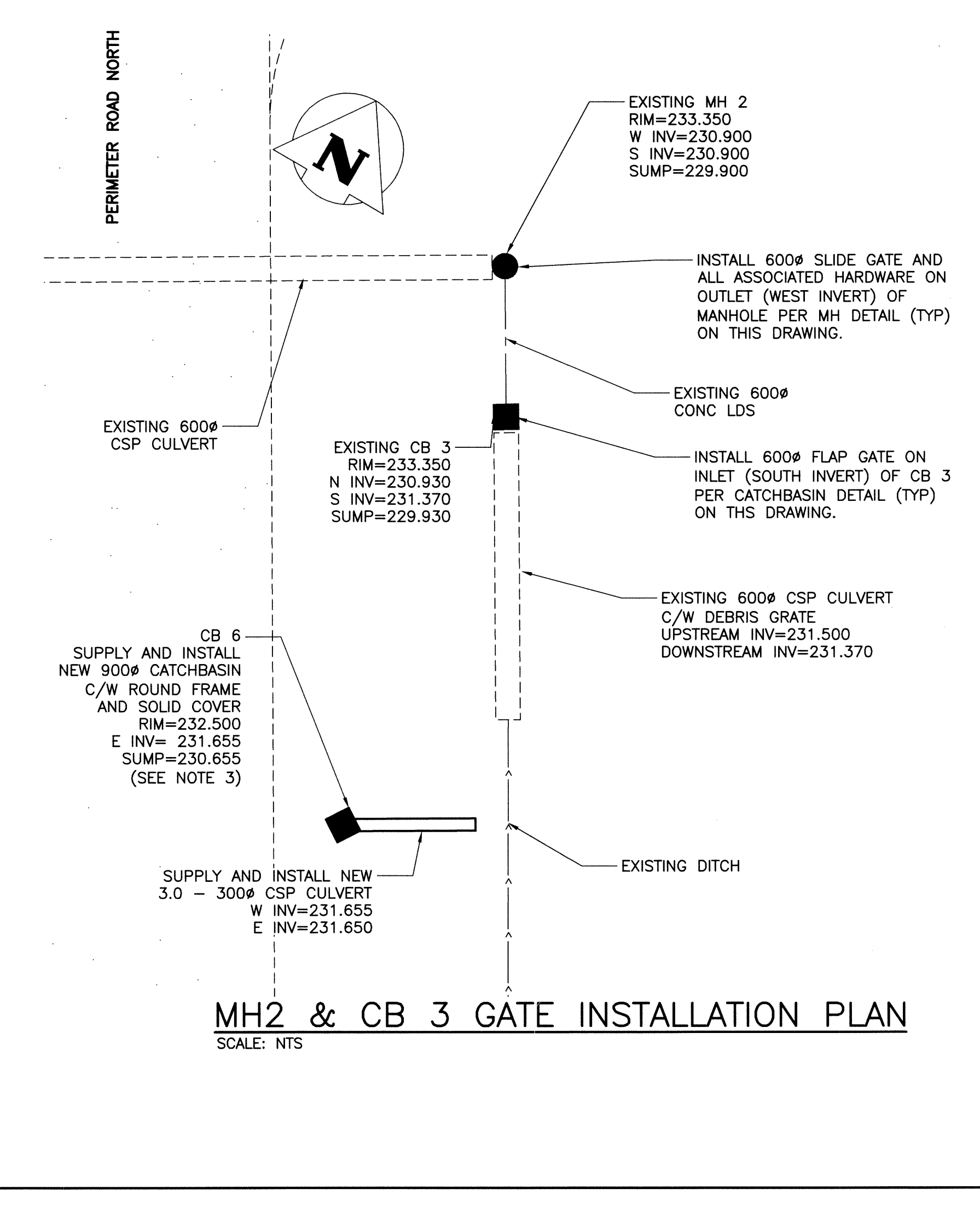

- NOTES:**
- ALL WORK SHALL BE PERFORMED IN ACCORDANCE WITH THE LATEST REVISION OF THE CITY OF WINNIPEG STANDARD CONSTRUCTION SPECIFICATIONS.
 - SLIDE GATES AND FLAP GATES WERE SUPPLIED IN CONTRACT 1. CONTRACT 3 WORK CONSISTS OF INSTALLATION OF GATES IN RESPECTIVE MANHOLES AND CATCHBASINS AS INDICATED ON DRAWING.
 - NEW CATCHBASIN TO BE INSTALLED OFFLINE FROM DITCH UPSTREAM OF FLAP GATE TO PROVIDE SUMP FOR PUMPING OVERFLOW AS REQUIRED WHEN FLAP GATE IS CLOSED.
 - MANHOLE MH3 WILL REQUIRE BOTH SLIDE GATE AND FLAP GATE INSTALLED WITHIN.
 - INSTALLATION OF NEW OFFLINE CATCHBASINS SHALL INCLUDE BACKFILL AROUND INLET PIPE AND AROUND CB TO MATCH 4:1 DITCH SIDE SLOPE.
 - SLIDE GATES AND FLAP GATES AND ALL ACCESSORIES SHOWN ON DRAWINGS SHALL BE INSTALLED IN ACCORDANCE WITH MANUFACTURER'S SPECIFICATIONS. CONTRACTOR SHALL MAKE ARRANGEMENTS TO HAVE A QUALIFIED FIELD REPRESENTATIVE FROM THE GATE SUPPLIER/MANUFACTURER BE PRESENT DURING FIELD TESTING AND INSPECT THE INSTALLATION DURING AND AFTER COMPLETION AND PROVIDE A CERTIFICATE OF SATISFACTORY INSTALLATION TO THE CONTRACT ADMINISTRATOR.
 - SLIDE GATES SHALL BE TESTED FOR LEAKAGE IN THE CONTRACTOR ADMINISTRATOR'S PRESENCE FOLLOWING INSTALLATION TO ENSURE COMPLIANCE WITH ALLOWABLE LEAKAGE RATE INDICATED IN AWWWA C560-07.
 - WATER USED FOR TESTING PURPOSES MUST BE CHLORINE FREE. POTABLE DRINKING WATER SHALL BE DE-CHLORINATED IF USED FOR TESTING PURPOSES. CONTRACTOR SHALL BE RESPONSIBLE FOR SUPPLYING WATER FOR TESTING PURPOSES.
 - IF A SLIDE GATES FAILS FIELD LEAKAGE TEST THE CONTRACTOR SHALL UNDERTAKE ADJUSTMENTS, REPLACEMENTS OR OTHER MODIFICATIONS RECOMMENDED BY SLIDE GATE SUPPLIER/MANUFACTURER'S FIELD REPRESENTATIVE AND REPEAT THE TEST. THE SEQUENCE SHALL BE REPEATED UNTIL THE GATE PASSES THE ALLOWABLE LEAKAGE RATE.

MANHOLE/CB LAYOUT CO-ORDINATES

ITEM #	EASTING (X)	NORTHING (Y)	REMARKS
CB 5	636674.648	5517428.834	CATCH BASIN 5
CB 6	636710.158	5517365.448	CATCH BASIN 6

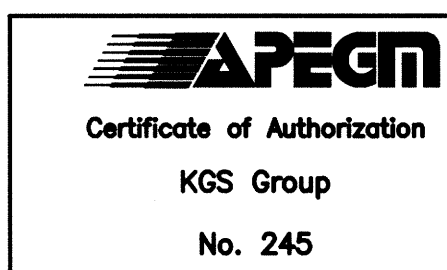
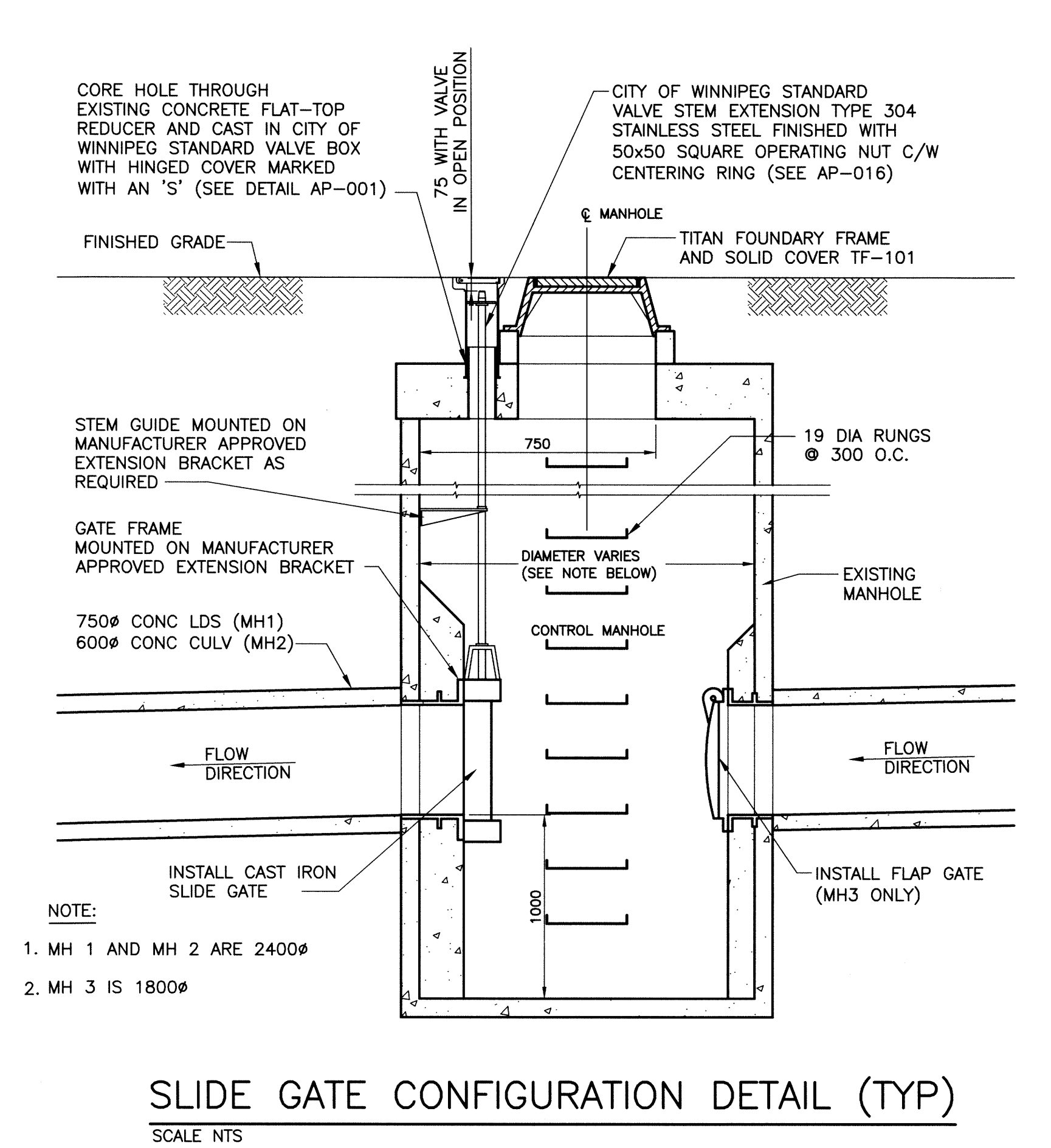

B.M. BRASS PLATE LOCATED IN GRADE BEAM OF ADMINISTRATION BUILDING
ELEV. 234.059

NO.	REVISIONS	DATE	DESIGN	CHECK
00	ISSUED FOR ADD. 1 - B.O. 899-2015	02/2016	BJM	BJM

CH2MHILL.

SNC-LAVALIN

DESIGNED BY: BJM
DRAWN BY: DMW
SCALE: AS NOTED
DATE: 2016/02/16

CHECKED BY: RJH
APPROVED BY: BJM
RELEASED FOR CONSTRUCTION BY:
DATE:

CONSULTANT NO.: 13-0338-002



THE CITY OF WINNIPEG
Winnipeg WATER AND WASTE DEPARTMENT

SOUTH END WATER POLLUTION CONTROL CENTRE
SEWPPC UPGRADE/EXPANSION PROJECT
CIVIL
SITE DRAINAGE OUTLET PLAN AND DETAILS

CITY DRAWING NUMBER: 1-0102-CDRN-Y001
SHEET: 003
REV: 00
SIZE: A1