

**1** DETAIL  
1:20  
SGAD-S003

CO-ORDINATE EMBEDMENT AND ANCHORAGE OF EQUIPMENT WITH EQUIPMENT SUPPLIER BEFORE SENDING ANY SHOP DRAWINGS, TYP

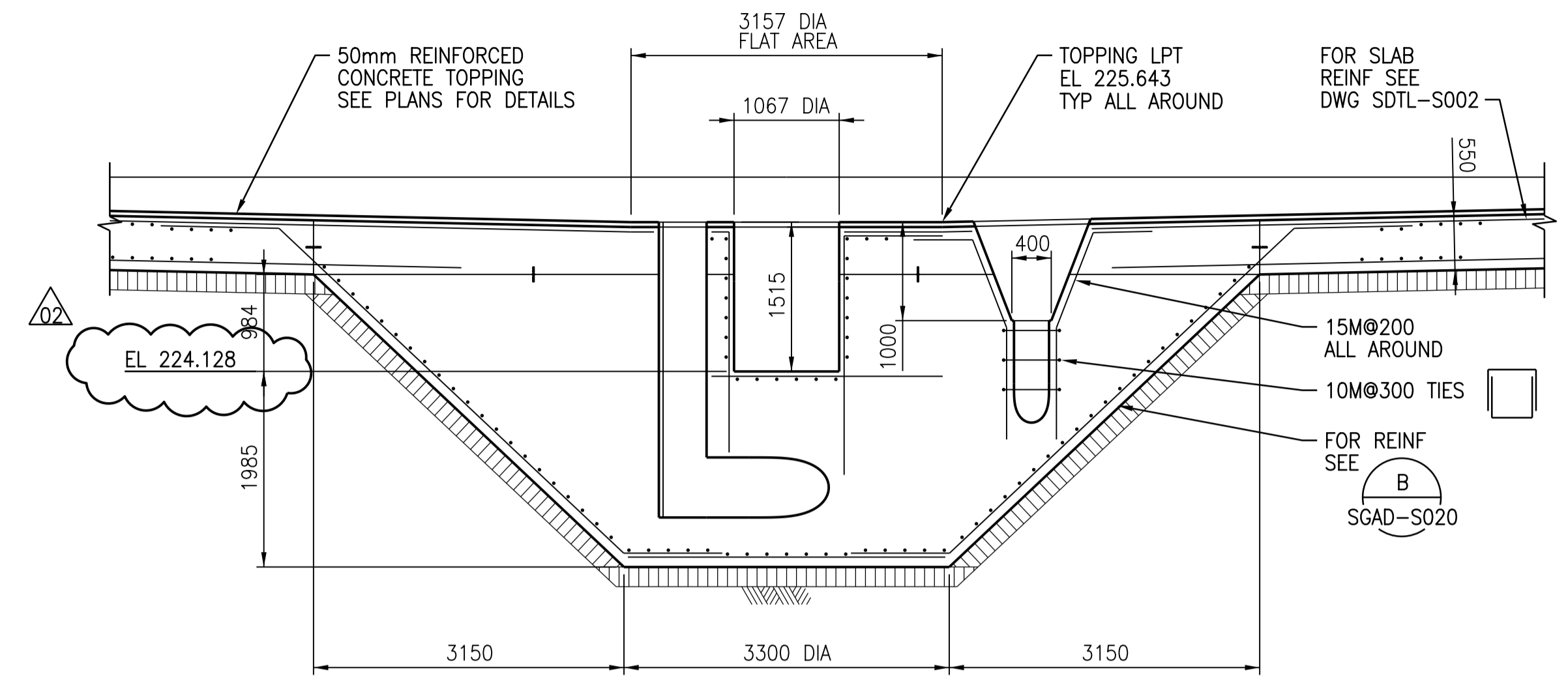

**2** DETAIL  
1:50

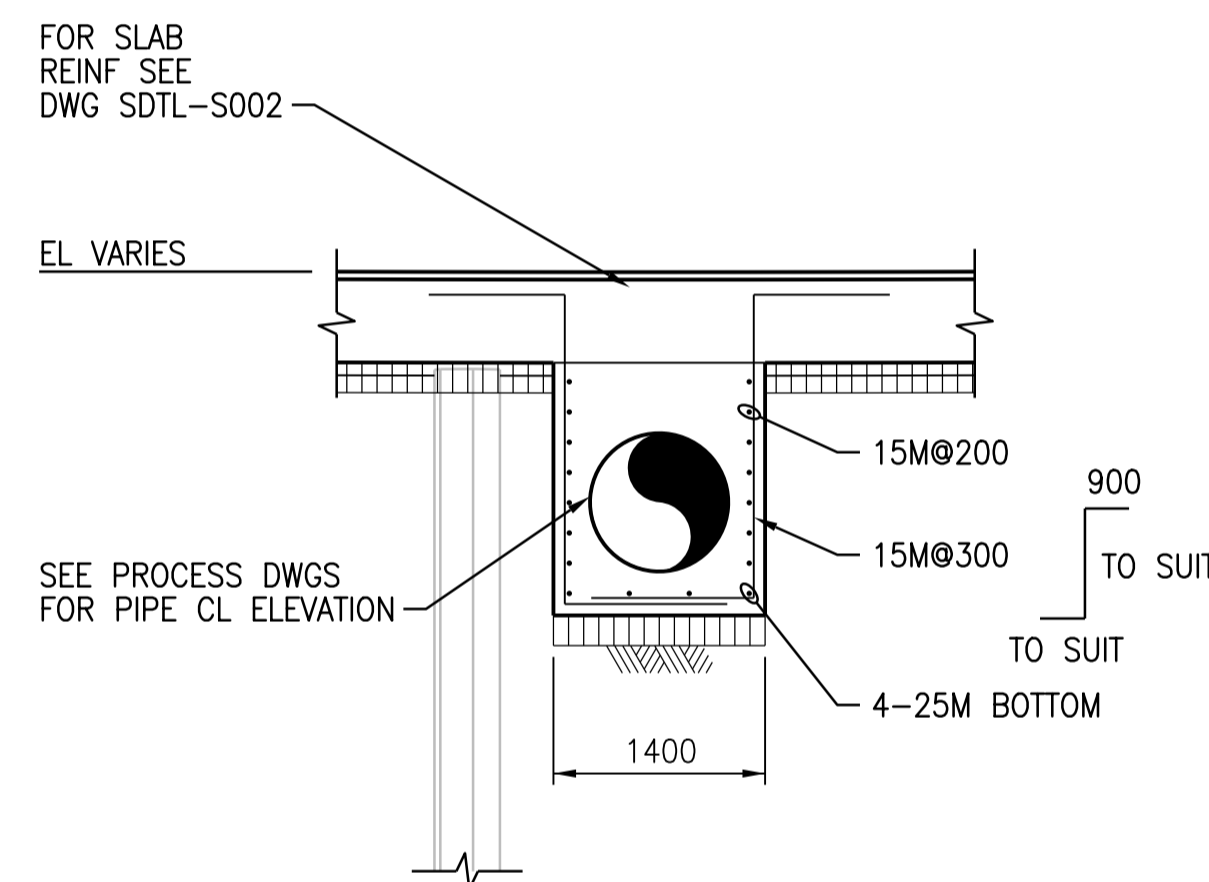

**3** DETAIL  
1:50  
SGAD-S003

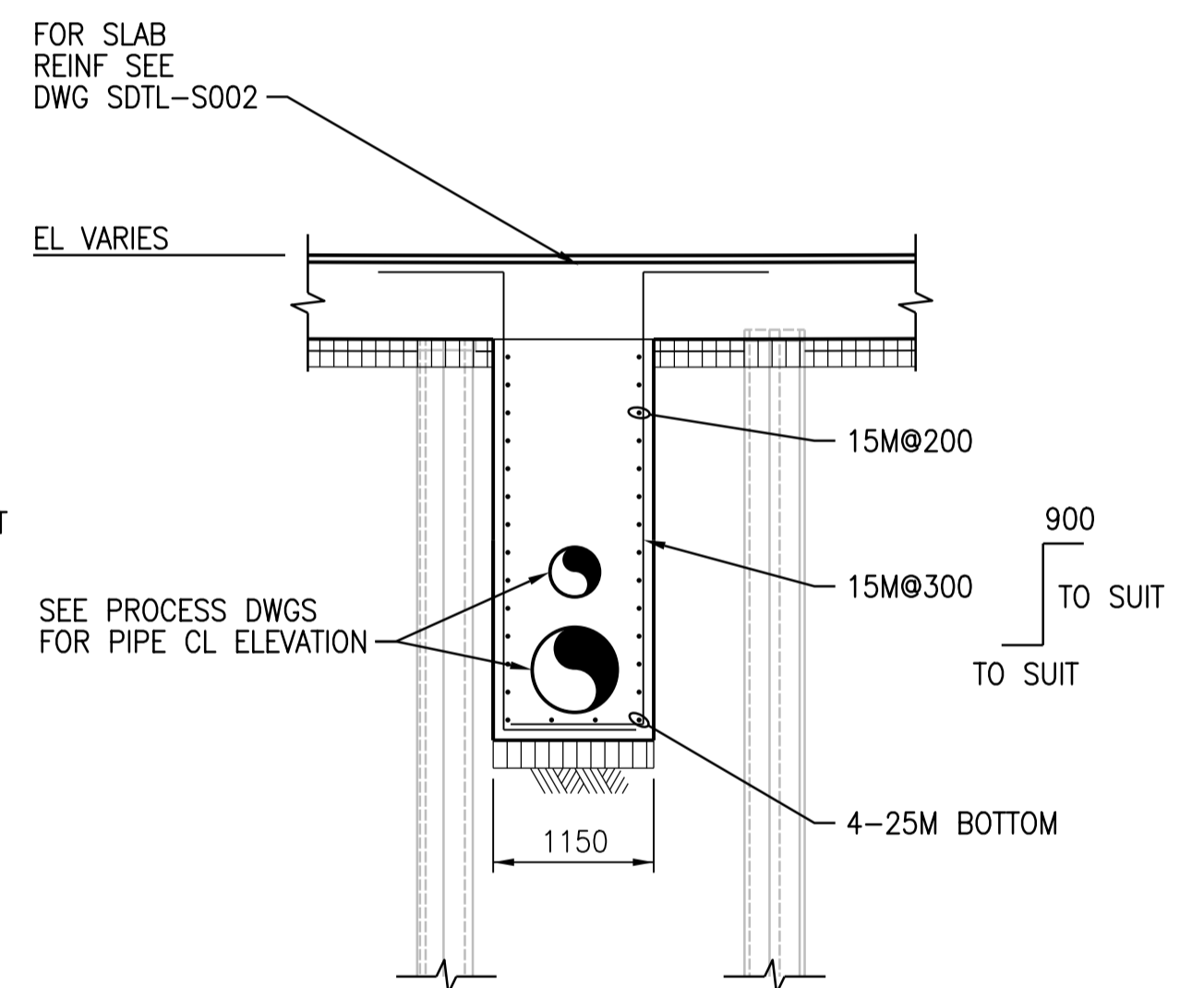

**4** DETAIL  
1:50  
SGAD-S003



<b>CH2MHILL</b> SNC-LAVALIN DESIGNED BY: A THAKKAR DRAWN BY: G. OMORI SCALE: AS NOTED DATE: 2016/01/29 CONSULTANT NO.: 474248				<b>KCS GROUP</b> CHECKED BY: R. PARIKH APPROVED BY: H.T. FREIHAMMER ISSUED FOR CONSTRUCTION BY: T. TURZAK DATE: 2016/01/29			
02	ISSUED FOR ADD. 4 - B.O. 899-2015	03/2016	G.O.	J.C.			
01	ISSUED FOR ADD. 2 - B.O. 899-2015	02/2016	G.O.	J.C.			
00	ISSUED FOR TENDER - B.O. 899-2015	01/2016	G.O.	J.C.			
NO.	REVISIONS	DATE	DESIGN	CHECK			

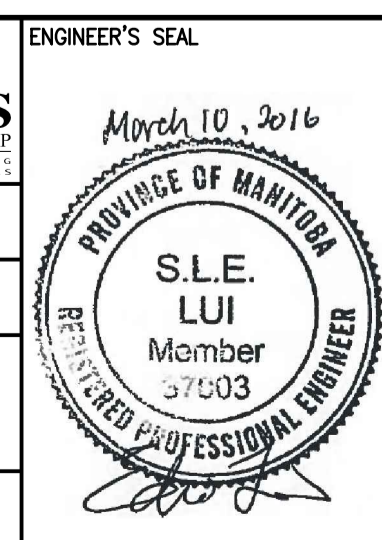

**THE CITY OF WINNIPEG**  
Winnipeg WATER AND WASTE DEPARTMENT

SOUTH END WATER POLLUTION CONTROL CENTRE  
SEWPCC UPGRADING/EXPANSION PROJECT  
STRUCTURAL  
SECONDARY CLARIFIERS 4 AND 5  
DETAILS

CITY DRAWING NUMBER: 1-0102-SDTL-S003  
SHEET: 001  
REV: 02  
SIZE: A1