

**1** DETAIL  
1:20  
SGAD-S003

CO-ORDINATE EMBEDMENT AND ANCHORAGE OF EQUIPMENT WITH EQUIPMENT SUPPLIER BEFORE SENDING ANY SHOP DRAWINGS, TYP

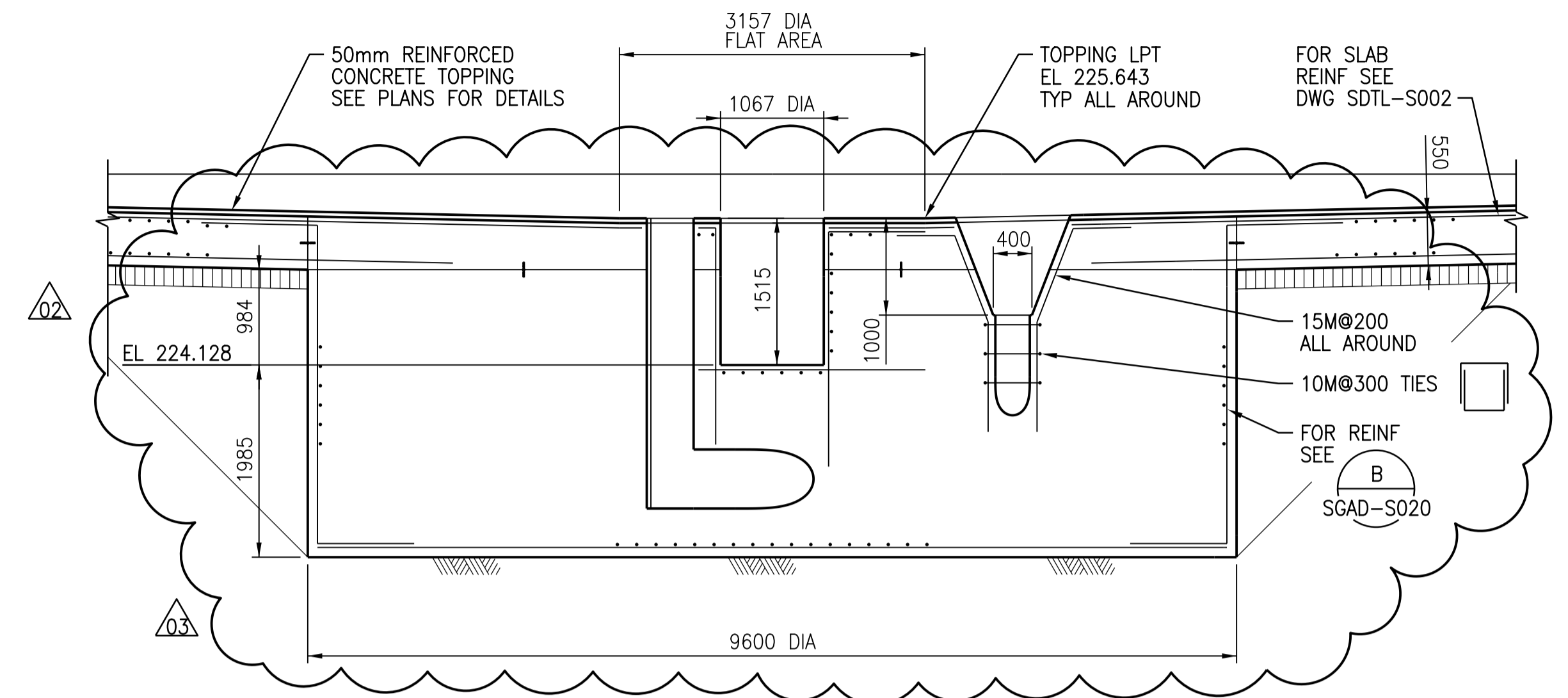

**2** DETAIL  
1:50

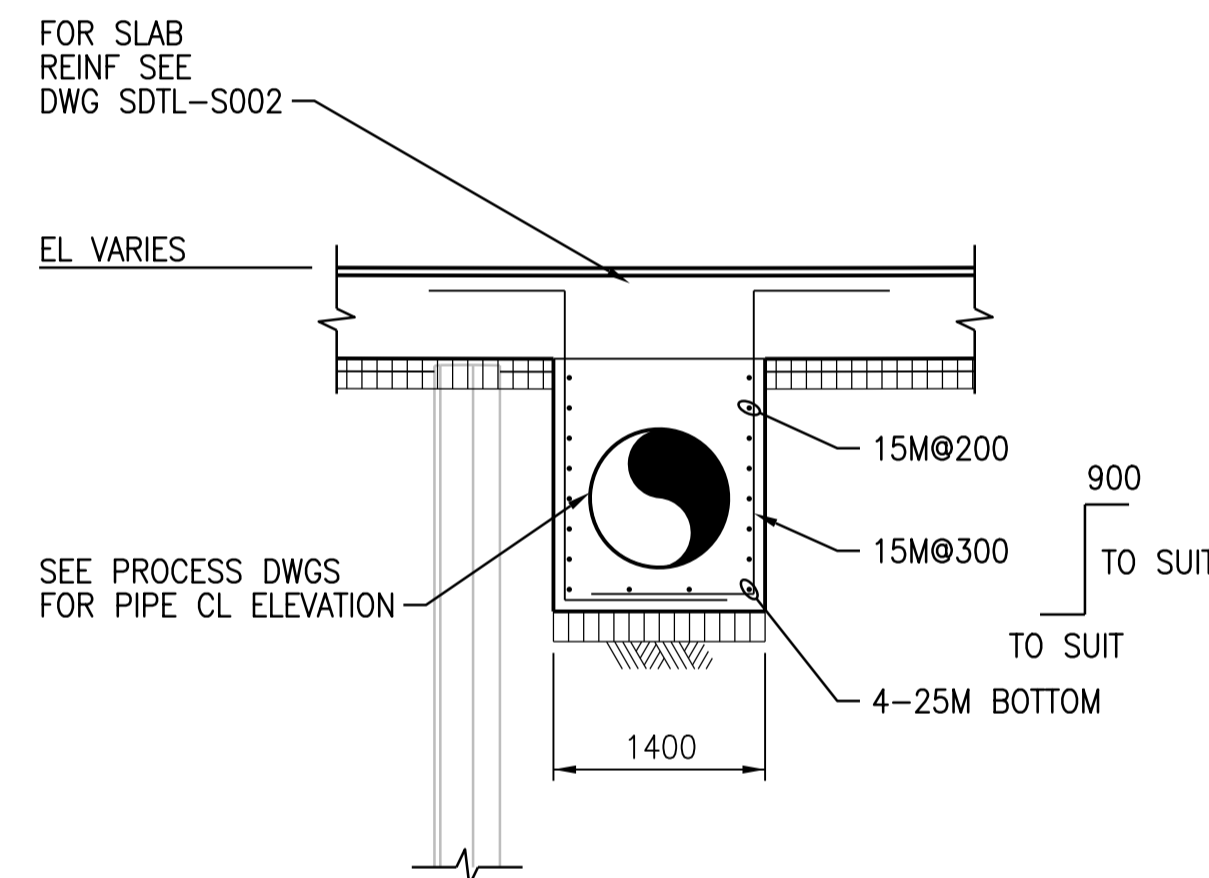

**3** DETAIL  
1:50  
SGAD-S003

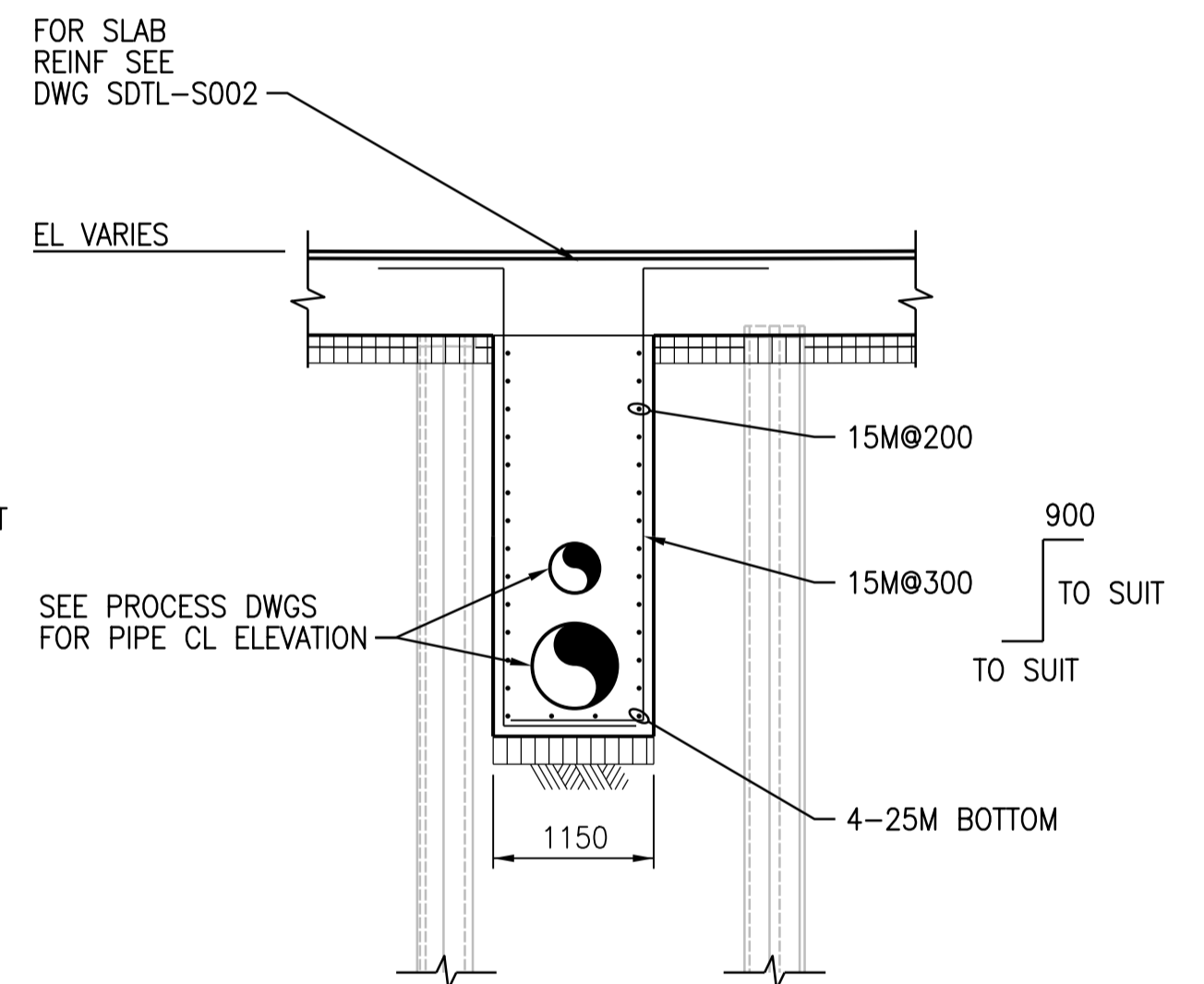

**4** DETAIL  
1:50  
SGAD-S003



NO.	REVISIONS	DATE	DESIGN	CHECK
03	ISSUED FOR ADD. 5 - B.O. 899-2015	03/2016	G.O.	J.C.
02	ISSUED FOR ADD. 4 - B.O. 899-2015	03/2016	G.O.	J.C.
01	ISSUED FOR ADD. 2 - B.O. 899-2015	02/2016	G.O.	J.C.
00	ISSUED FOR TENDER - B.O. 899-2015	01/2016	G.O.	J.C.

<b>CH2MHILL</b>		<b>KCS GROUP</b>	
SNC-LAVALIN		ENGINEER'S SEAL	
DESIGNED BY: A THAKKAR	CHECKED BY: R. PARIKH		
DRAWN BY: G. OMORI	APPROVED BY: H.T. FREIHAMMER		
SCALE: AS NOTED	ISSUED FOR CONSTRUCTION BY: T. TURZAK		
DATE: 2016/01/29		DATE: 2016/01/29	
CONSULTANT NO.: 474248			

**THE CITY OF WINNIPEG**  
WATER AND WASTE DEPARTMENT

SOUTH END WATER POLLUTION CONTROL CENTRE  
SEWPCC UPGRADING/EXPANSION PROJECT  
STRUCTURAL  
SECONDARY CLARIFIERS 4 AND 5  
DETAILS

CITY DRAWING NUMBER: 1-0102-SDTL-S003  
SHEET: 001  
REV: 03  
SIZE: A1