

PLAN VIEW  
1 : 40

GENERAL NOTES:

- 1. THE ELECTRICAL CONTRACTOR SHALL COORDINATE THE EXACT SIZE OF ALL ELECTRICAL EQUIPMENT WITH THE VENDOR SHOP DRAWINGS AND THE CONCRETE SUBCONTRACTOR PRIOR TO POURING THE CONCRETE HOUSEKEEPING PAD.
2. ALL WIRING ASSOCIATED WITH RECEPTACLES ARE TO BE RUN IN CONDUIT.
3. THERE ARE STRUCTURAL EXPANSION JOINTS IN THE FACILITY (NOT SHOWN ON ELECTRICAL). PROVIDE EXPANSION COUPLINGS AND FITTINGS FOR ALL CONDUIT CROSSING THE JOINTS. DO NOT LOCATE RIGID DEVICES ACROSS OR ON TOP OF THE EXPANSION JOINTS.
4. EQUIPMENT WITH NO CIRCUIT NUMBERS SHOWN ARE TO BE FED FROM THE 600VAC MCC. TYPICAL.
5. ALL CONDUIT SHALL BE RIGID, THREADED ALUMINUM CONDUIT, EXCEPT FOR CONDUIT RUNS WITHIN THE ELECTRICAL ROOM, WHICH CAN BE EMT. THE ELECTRICAL ROOM IS NON-HAZARDOUS.
6. TEST AND ADJUST THE AUDIBILITY OF THE PUBLIC ADDRESS SYSTEM TO BEST SUIT THE SPACE.
7. FOR SYMBOL LEGEND, REFER TO DRAWING 1-0102-EDTL-A001.
8. ALL ELECTRICAL DISTRIBUTION EQUIPMENT, INCLUDING 600VAC SWITCHGEAR, DRY TYPE TRANSFORMERS, PANELBOARDS, MCCS, HARMONICS FILTERS, UPS ARE TO BE SCHNEIDER ELECTRIC EQUIPMENT. PHYSICAL SIZES SHOWN ARE BASED ON SCHNEIDER EQUIPMENT. BATTERY BANK SIZE SHOWN IS BASED ON LUMACELL ARGES CENTRAL SYSTEM.

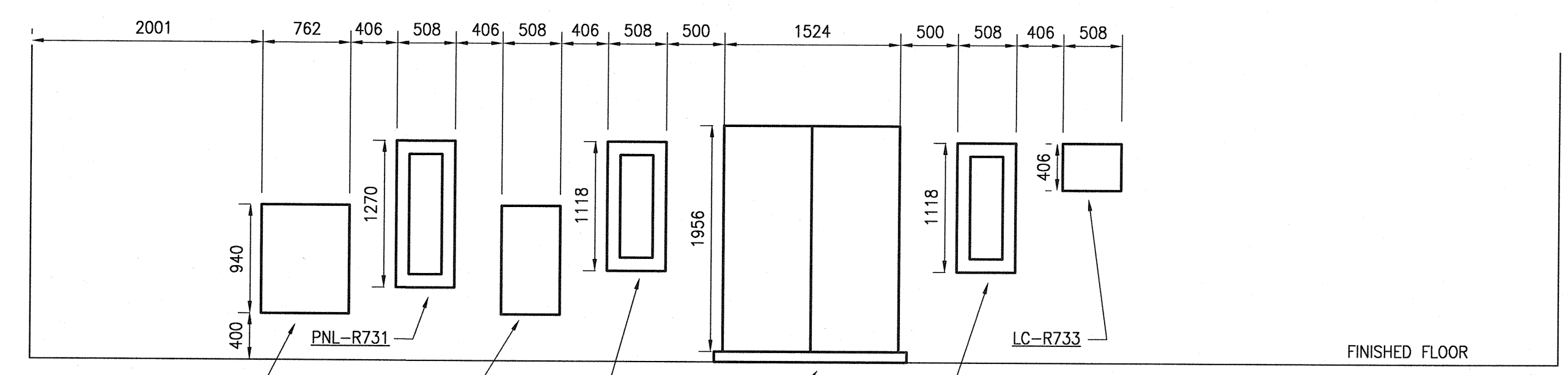
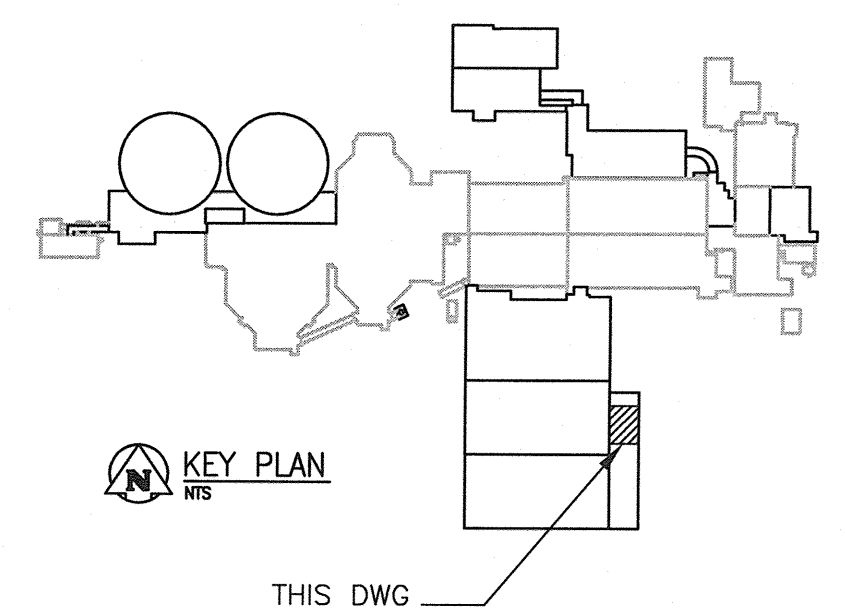

A EQUIPMENT ELEVATION  
1 : 40

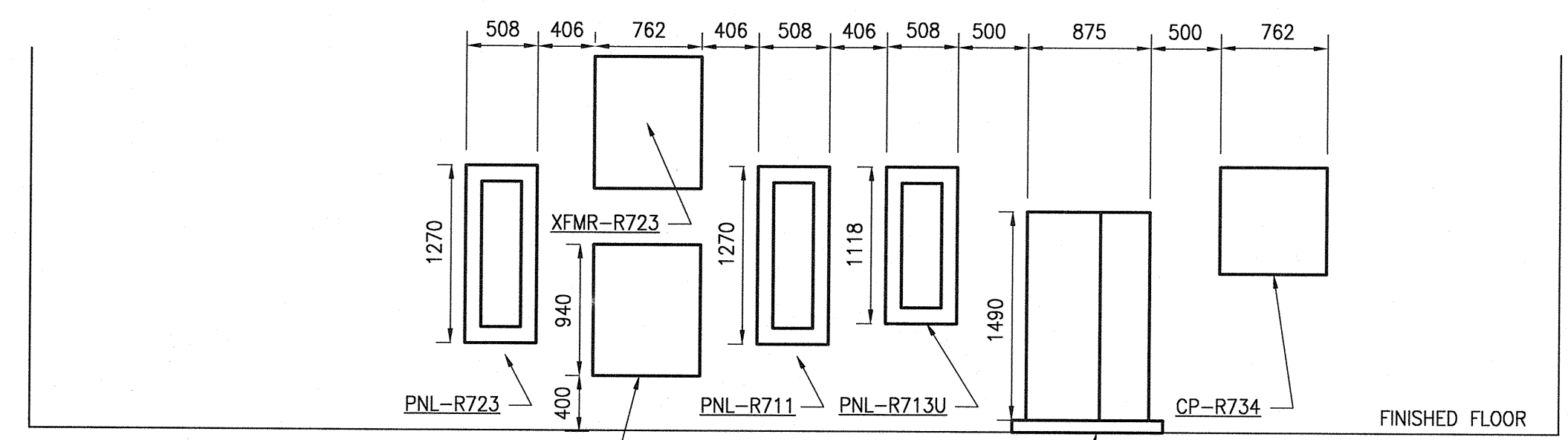

B EQUIPMENT ELEVATION  
1 : 40

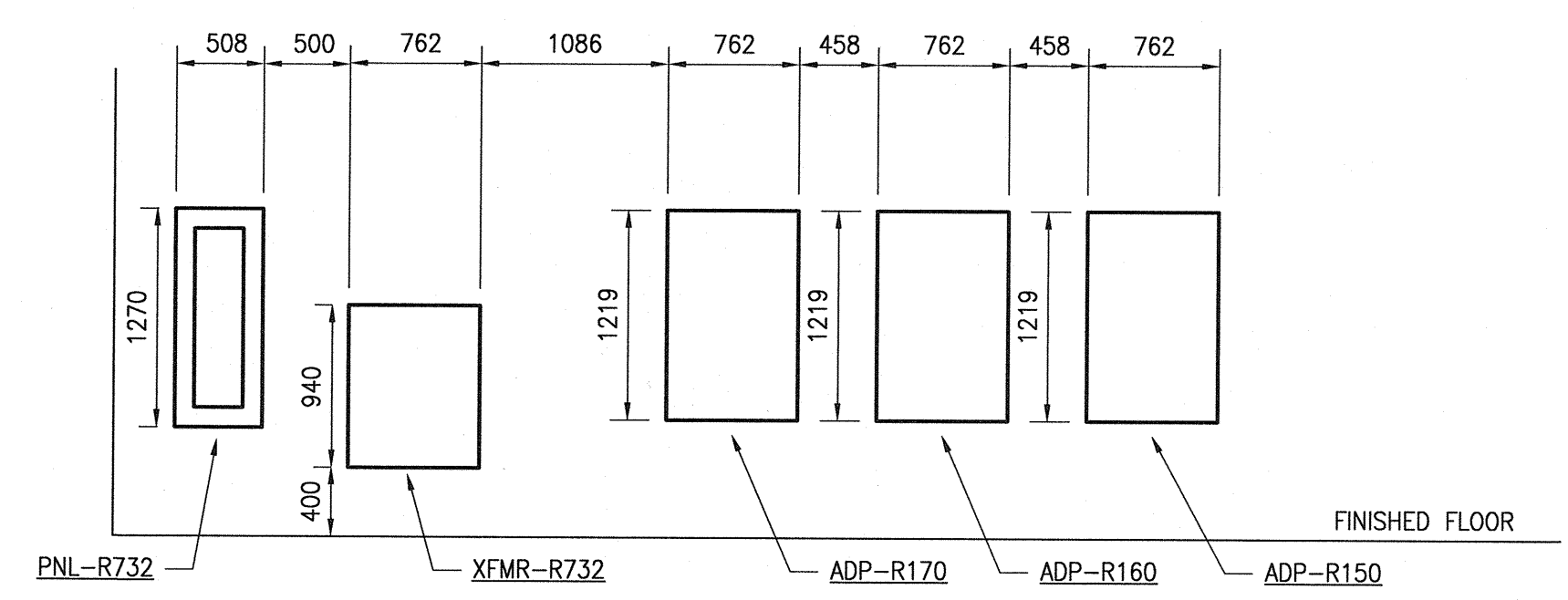

C EQUIPMENT ELEVATION  
1 : 40

SPECIFIC NOTES:

- 1 PROVIDE HOUSEKEEPING PAD 89mm HIGH, EXTEND 100mm ON EACH SIDE OF THE EQUIPMENT WITH 19mm CHAMFERED EDGES. PROVIDE REINFORCEMENT AND ANCHOR PAD TO FLOOR SLAB.
2 PROVIDE SPEAKER ASSOCIATED WITH FACILITY PUBLIC ADDRESS SYSTEM. MOUNT SPEAKER CLEAR OF OBSTRUCTIONS. REFER TO DRAWING 1-0102-ESCH-R001 FOR SPEAKER AND BACKBOX MODEL. PROVIDE CABLING AND CONDUIT. CONNECT TO PUBLIC ADDRESS CCT #XXXX. REFER TO DWG XXX.
3 MOUNT TRANSFORMERS ON WALL AT LEAST 400mm ABOVE FINISHED FLOOR. PROVIDE ALL MOUNTING HARDWARE AS REQUIRED.
4 THE NETWORK ACCESS POINT (NAP-R911) DEVICE TO BE MOUNTED AT 150mm BELOW THE CEILING.
5 REFER TO DWG. EWDG-R006 FOR WIRING OF ACU-R641-1 AND ACU-R641-2.
6 REFER TO DWG. EWDG-R006 FOR WIRING OF ACU-R642-1 AND ACU-R642-2.
7 OUTDOOR RECEPTACLE SWITCH. PROVIDE LAMACOID ABOVE SWITCH INDICATING CIRCUIT IDENTIFIER "R732-24A" AND RECEPTACLE DESCRIPTION. RECEPTACLE DESCRIPTION TO INDICATE "EXTERIOR RECEPTACLES NORTHEAST, NORTHWEST, & NORTH SIDE OF BUILDING"
8 OUTDOOR RECEPTACLE SWITCH. PROVIDE LAMACOID ABOVE SWITCH INDICATING CIRCUIT IDENTIFIER "R732-14A" AND RECEPTACLE DESCRIPTION. RECEPTACLE DESCRIPTION TO INDICATE "EXTERIOR RECEPTACLES EAST, WEST, & SOUTHWEST SIDE OF BUILDING"
9 OUTDOOR RECEPTACLE SWITCH. PROVIDE LAMACOID ABOVE SWITCH INDICATING CIRCUIT IDENTIFIER "R732-16A" AND RECEPTACLE DESCRIPTION. RECEPTACLE DESCRIPTION TO INDICATE "EXTERIOR RECEPTACLES SOUTH & SOUTHEAST SIDE OF BUILDING"
10 PROVIDE CONCRETE FLOOR HOLE PENETRATION (150mm BY 800mm) TO ALLOW FOR CONDUIT PENETRATION TO THE GALLERY BELOW.
11 THREE GANG SWITCH FOR CONTROL OF OUTDOOR RECEPTACLES AT THE BIOREACTORS (1, 2 & 3). PROVIDE LAMACOID ABOVE SWITCH INDICATING CIRCUIT IDENTIFIER AND RECEPTACLE DESCRIPTION FOR EACH BIOREACTOR (E.G "R732-23A" & "EXTERIOR RECEPTACLES - BIOREACTOR 1").
12 PROVIDE CONCRETE FLOOR HOLE PENETRATION (305mm BY 800mm) TO ALLOW FOR CABLE TRAY PENETRATION TO THE GALLERY BELOW.

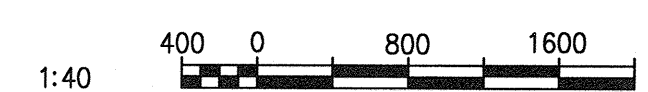

Table with columns for NO., REVISIONS, DATE, DESIGN, CHECK. Row 00 ISSUED FOR TENDER - B.O. 899-2015 01/2016 WE DEB

Table with columns for DESIGNED BY (V. ELIMBAN), CHECKED BY (D. BECKER), DRAWN BY (M.J. PERSSON), APPROVED BY (E. RYCZKOWSKI), DATE (2014/12/04), DATE (2016/01/29). Includes CH2MHILL and KGS GROUP logos.



THE CITY OF WINNIPEG WATER AND WASTE DEPARTMENT. SOUTH END WATER POLLUTION CONTROL CENTRE SEWPCC UPGRADING/EXPANSION PROJECT ELECTRICAL - POWER LAYOUT BIOREACTORS/BLOWER BUILDING ELECTRICAL ROOM LAYOUT. CITY DRAWING NUMBER 1-0102-EGAD-R001 SHEET 001 REV. 00 SIZE A1