



ANYTHONY AVE

ANDREWS STREET

97.6 OF 1050 CONCRETE CS TO BE LINED
S-MA00011640 (FULLY DETERIORATED)

98.0 OF 1050 CONCRETE CS TO BE LINED
S-MA00011635 (FULLY DETERIORATED)

SEWER JUNCTION INFORMATION FROM SEWER VIDEO INSPECTION		
SEWER ID S-MA00011635		
DISTANCE FROM MH ID S-MH00010045		
DISTANCE	DIAMETER	CLOCK
48.4	150	10
48.4	150	1

SEWER JUNCTION INFORMATION FROM SEWER VIDEO INSPECTION		
SEWER ID S-MA00011640		
DISTANCE FROM MH ID S-MH00010017		
DISTANCE	DIAMETER	CLOCK
48.9	150	1
49.1	150	11

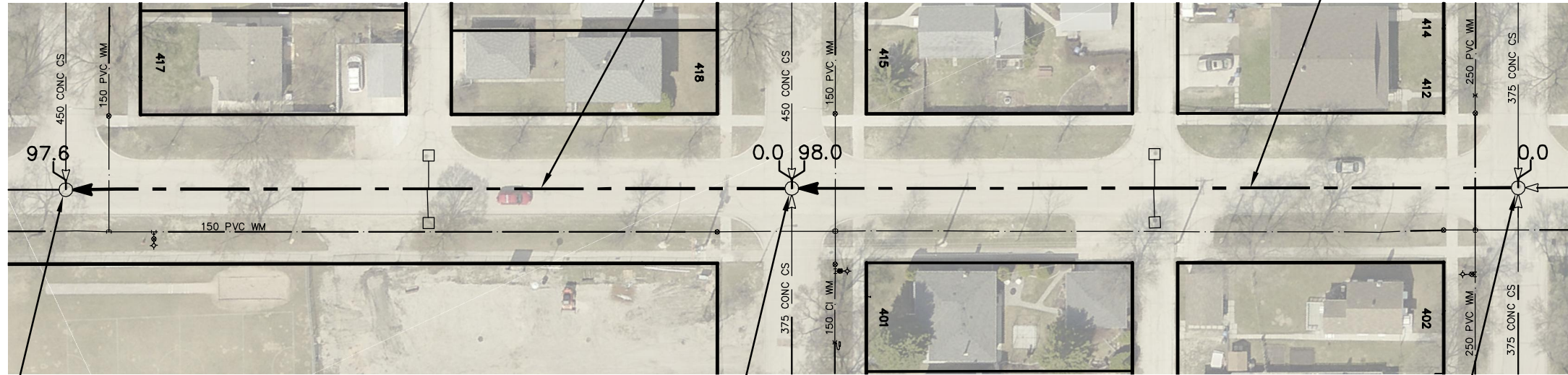

S-MH00010016
RIM 231.06
INV W 225.60
INV N 224.96
INV S 224.96

S-MH00010017
RIM 231.00
INV W 225.60
INV E 225.60
INV N 225.06
INV S 225.06

S-MH00010045
RIM 231.35
INV W 225.71
INV E 225.73
INV N 225.29
INV S 225.29

PERTH AVE

HARTFORD AVE

WARNING

IF POWER EQUIPMENT OR EXPLOSIVES ARE TO BE USED FOR EXCAVATION ON THIS PROJECT THE CONTRACTOR MUST:

- 1) NOTIFY THE GAS COMPANY OF THE PROPOSED LOCATION OF EXCAVATION.
- 2) TAKE PRECAUTION TO AVOID DAMAGE TO GAS COMPANY INSTALLATIONS.

SEE PROVINCIAL REGULATION 210/72 FOR DETAILS

FOR INDEX SEE
11020

METRIC

WHOLE NUMBERS INDICATE MILLIMETRES
DECIMALIZED NUMBERS INDICATE METRES

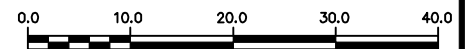

LOCATION APPROVED
UNDERGROUND STRUCTURES

SUPV. U/G STRUCTURES COMMITTEE DATE

NOTE:

LOCATION OF UNDERGROUND STRUCTURES AS SHOWN ARE BASED ON THE BEST INFORMATION AVAILABLE BUT NO GUARANTEE IS GIVEN THAT ALL EXISTING UTILITIES ARE SHOWN OR THAT THE GIVEN LOCATIONS ARE EXACT. CONFIRMATION OF EXISTENCE AND EXACT LOCATION OF ALL SERVICES MUST BE OBTAINED FROM THE INDIVIDUAL UTILITIES BEFORE PROCEEDING WITH CONSTRUCTION.

B.M. ELEV.			
CONSTRUCTION COMPLETION DATE: YYYY MM DD			
DESIGNED BY	NC		
CHECKED BY	SC		
DRAWN BY	RJ		
APPROVED BY	KZ		
SCALE:			
HORIZONTAL	1:750		
VERTICAL			
RELEASED FOR CONSTRUCTION	KAS ZUREK		
NO.	REVISIONS	DATE	BY

DATE 2016 01 29
PLOT DATE: 2016 01 29

ENGINEER'S SEAL

ORIGINAL
SIGNED BY
N.M.
CONTI
16/01/28

CONSULTANT DRAWING NUMBER



THE CITY OF WINNIPEG
WATER AND WASTE DEPARTMENT
ENGINEERING DIVISION

2015 SEWER RENEWALS
BY CIPP LINING

ANDREWS STREET
MH AT HARTFORD AVENUE TO
MH AT ST ANTHONY AVENUE

SHEET 5 OF 56

CITY DRAWING NUMBER

11024