

# EAST GATE

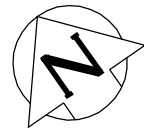

4.5 OF 375 SDR35 PVC SEWER REPAIR SD-022B), INCLUDING 2 SERVICE CONNECTIONS.

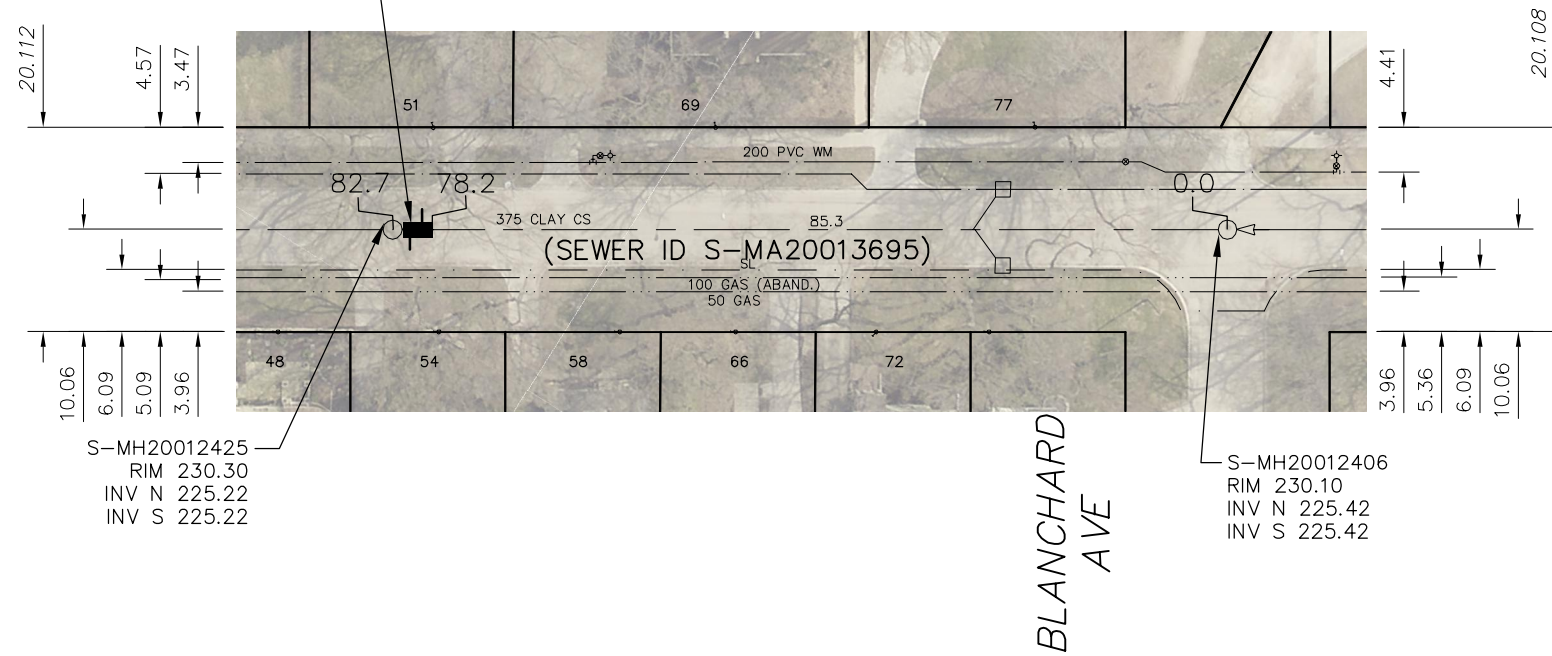

SEWER JUNCTION INFORMATION FROM SEWER VIDEO INSPECTION		
SEWER ID S-MA20013695		
DISTANCE FROM MH ID S-MH20012406		
DISTANCE	DIAMETER	CLOCK
18.4	150	1
22.1	150	10
22.7	150	1
44.3	150	11
53.0	150	10
55.4	150	1
62.4	150	11
79.2	150	2
80.4	150	11

### WARNING

IF POWER EQUIPMENT OR EXPLOSIVES ARE TO BE USED FOR EXCAVATION ON THIS PROJECT THE CONTRACTOR MUST:

- 1) NOTIFY THE GAS COMPANY OF THE PROPOSED LOCATION OF EXCAVATION.
- 2) TAKE PRECAUTION TO AVOID DAMAGE TO GAS COMPANY INSTALLATIONS.

SEE PROVINCIAL REGULATION 210/72 FOR DETAILS

**METRIC**  
WHOLE NUMBERS INDICATE MILLIMETRES  
DECIMALIZED NUMBERS INDICATE METRES

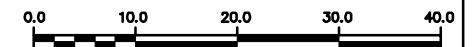

### LOCATION APPROVED UNDERGROUND STRUCTURES

SUPV. U/G STRUCTURES COMMITTEE DATE

NOTE:  
LOCATION OF UNDERGROUND STRUCTURES AS SHOWN ARE BASED ON THE BEST INFORMATION AVAILABLE BUT NO GUARANTEE IS GIVEN THAT ALL EXISTING UTILITIES ARE SHOWN OR THAT THE GIVEN LOCATIONS ARE EXACT. CONFIRMATION OF EXISTENCE AND EXACT LOCATION OF ALL SERVICES MUST BE OBTAINED FROM THE INDIVIDUAL UTILITIES BEFORE PROCEEDING WITH CONSTRUCTION.

B.M. ELEV.			
NO.	REVISIONS	DATE	BY

DESIGNED BY	<b>TS</b>	CHECKED BY	<b>SC</b>
DRAWN BY	<b>RS</b>	APPROVED BY	<b>KZ</b>
SCALE:	<b>1: 750</b>	RELEASED FOR CONSTRUCTION	
HORIZONTAL			
VERTICAL			
DATE	<b>2015 12 16</b>	DATE	

ENGINEER'S SEAL  
  
ORIGINAL SIGNED BY S.R.J. COURNOYER 12/07/15  
  
CONSULTANT DRAWING NUMBER

**THE CITY OF WINNIPEG**  
WATER AND WASTE DEPARTMENT  
ENGINEERING DIVISION

2015 SEWER RENEWALS  
BY EXTERNAL POINT REPAIR  
**EAST GATE**  
MH AT BLANCHARD AVENUE TO  
1ST MH N OF BLANCHARD AVENUE

SHEET 14 OF 41  
CITY DRAWING NUMBER  
**11131**