

PARK LANE AVENUE

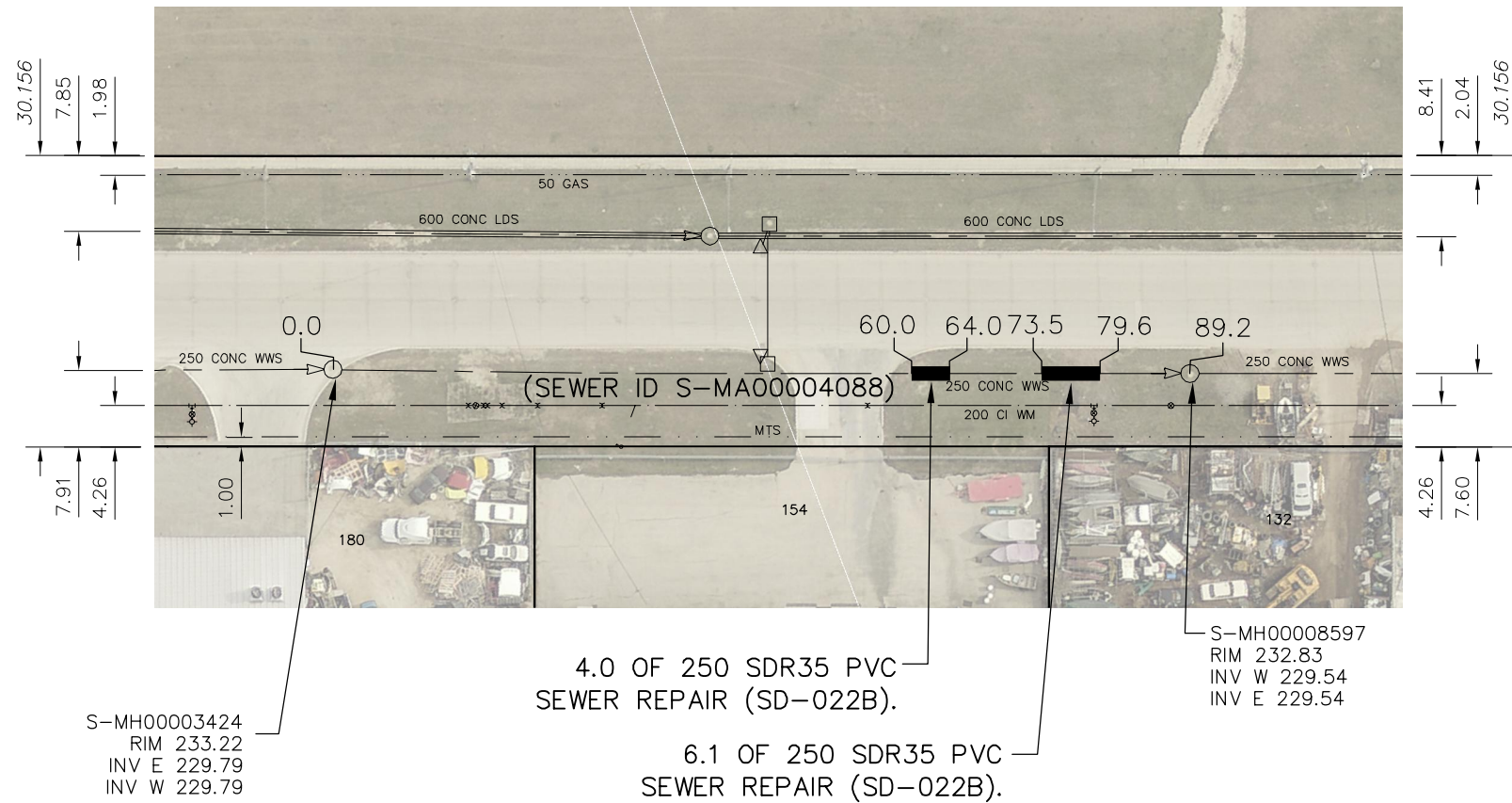

SEWER JUNCTION INFORMATION FROM SEWER VIDEO INSPECTION		
SEWER ID S-MA00004088		
DISTANCE FROM MH ID S-MH00003424		
DISTANCE	DIAMETER	CLOCK
30.9	150	2

WARNING

IF POWER EQUIPMENT OR EXPLOSIVES ARE TO BE USED FOR EXCAVATION ON THIS PROJECT THE CONTRACTOR MUST:

- 1) NOTIFY THE GAS COMPANY OF THE PROPOSED LOCATION OF EXCAVATION.
- 2) TAKE PRECAUTION TO AVOID DAMAGE TO GAS COMPANY INSTALLATIONS.

SEE PROVINCIAL REGULATION 210/72 FOR DETAILS

METRIC
WHOLE NUMBERS INDICATE MILLIMETRES
DECIMALIZED NUMBERS INDICATE METRES



LOCATION APPROVED UNDERGROUND STRUCTURES SUPV. U/G STRUCTURES COMMITTEE _____ DATE _____ NOTE: LOCATION OF UNDERGROUND STRUCTURES AS SHOWN ARE BASED ON THE BEST INFORMATION AVAILABLE BUT NO GUARANTEE IS GIVEN THAT ALL EXISTING UTILITIES ARE SHOWN OR THAT THE GIVEN LOCATIONS ARE EXACT. CONFIRMATION OF EXISTENCE AND EXACT LOCATION OF ALL SERVICES MUST BE OBTAINED FROM THE INDIVIDUAL UTILITIES BEFORE PROCEEDING WITH CONSTRUCTION.	B.M. ELEV.			ENGINEER'S SEAL		 THE CITY OF WINNIPEG WATER AND WASTE DEPARTMENT ENGINEERING DIVISION 2015 SEWER RENEWALS BY EXTERNAL POINT REPAIR PARK LANE AVENUE 4TH MH OF KING EDWARD STREET TO 5TH MH E OF KING EDWARD STREET	SHEET 30 OF 41 CITY DRAWING NUMBER 11147
	DESIGNED BY TS	CHECKED BY SC	ORIGINAL SIGNED BY S.R.J. COURNOYER 12/07/15		CONSULTANT DRAWING NUMBER		
		DRAWN BY RS	APPROVED BY KZ				
		SCALE: HORIZONTAL 1:750	RELEASED FOR CONSTRUCTION				
		VERTICAL					
NO.	REVISIONS	DATE	BY	DATE 2015 12 16	DATE		

PLOT DATE: 2015 12 16

BID OPPORTUNITY: 971-2015
CONTRACT NUMBER: 4

FILE PATH: R:\DRAWINGS\SEWER\2015 RENEWALS\RENEWALS & ASSOCIATED WORKS\Contract 4\Contract 4_Final\
FILE NAME: PARK_S-MA00004088.dwg