

KILDONAN DRIVE

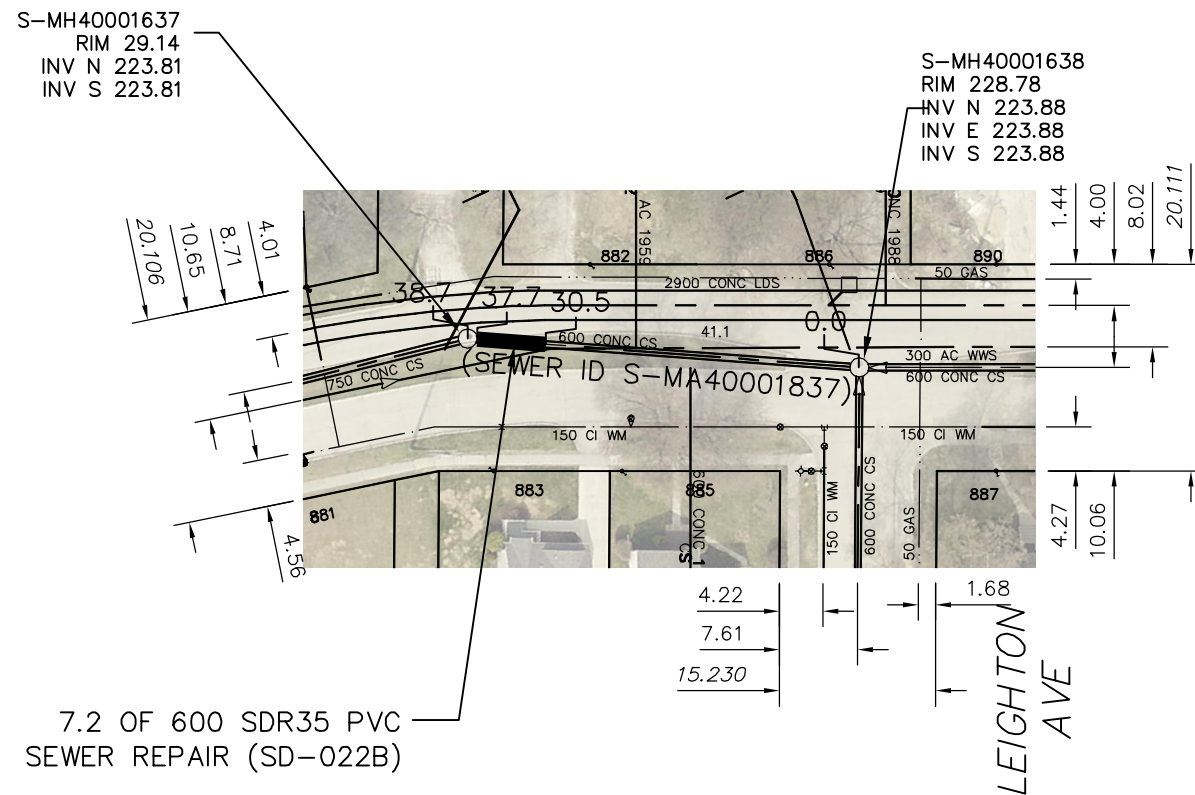

SEWER JUNCTION INFORMATION FROM SEWER VIDEO INSPECTION		
SEWER ID S-MA40001837		
DISTANCE FROM MH ID S-MH40001638		
DISTANCE	DIAMETER	CLOCK
23.8	150	1
27.5	150	10
35.3	150	12

7.2 OF 600 SDR35 PVC
SEWER REPAIR (SD-022B)

FOR INDEX SEE
11159

WARNING

IF POWER EQUIPMENT OR EXPLOSIVES ARE TO BE USED FOR EXCAVATION ON THIS PROJECT THE CONTRACTOR MUST:

- 1) NOTIFY THE GAS COMPANY OF THE PROPOSED LOCATION OF EXCAVATION.
- 2) TAKE PRECAUTION TO AVOID DAMAGE TO GAS COMPANY INSTALLATIONS.

SEE PROVINCIAL REGULATION 210/72 FOR DETAILS

METRIC

WHOLE NUMBERS INDICATE MILLIMETRES
DECIMALIZED NUMBERS INDICATE METRES



LOCATION APPROVED
UNDERGROUND STRUCTURES

SUPV. U/G STRUCTURES COMMITTEE DATE

NOTE:

LOCATION OF UNDERGROUND STRUCTURES AS SHOWN ARE BASED ON THE BEST INFORMATION AVAILABLE BUT NO GUARANTEE IS GIVEN THAT ALL EXISTING UTILITIES ARE SHOWN OR THAT THE GIVEN LOCATIONS ARE EXACT. CONFIRMATION OF EXISTENCE AND EXACT LOCATION OF ALL SERVICES MUST BE OBTAINED FROM THE INDIVIDUAL UTILITIES BEFORE PROCEEDING WITH CONSTRUCTION.

B.M.
ELEV.

NO.	REVISIONS	DATE	BY

DESIGNED BY	TS	CHECKED BY	SC
DRAWN BY	RS	APPROVED BY	KZ
SCALE:	1:750	RELEASED FOR CONSTRUCTION	
HORIZONTAL			
VERTICAL			
DATE	2015 12 16	DATE	

PLOT DATE: 2015 12 16

ENGINEER'S SEAL

ORIGINAL
SIGNED BY
S.R.J.
COURNOYER
12/07/15

CONSULTANT DRAWING NUMBER

-

BID OPPORTUNITY: 998-2015
CONTRACT NUMBER: 4A



THE CITY OF WINNIPEG

WATER AND WASTE DEPARTMENT
ENGINEERING DIVISION

2015 SEWER RENEWALS
BY EXTERNAL POINT REPAIR
KILDONAN DRIVE
MH AT LEIGHTON AVENUE TO
1ST MH S OF LEIGHTON AVENUE

SHEET 24 OF 49

CITY DRAWING NUMBER

11184

FILE PATH: R:\DRAWINGS\SEWER\2015 RENEWALS\RENEWALS & ASSOCIATED WORKS\Contract 4A\
FILE NAME: KILDONAN_S-MA40001837-1.dwg