

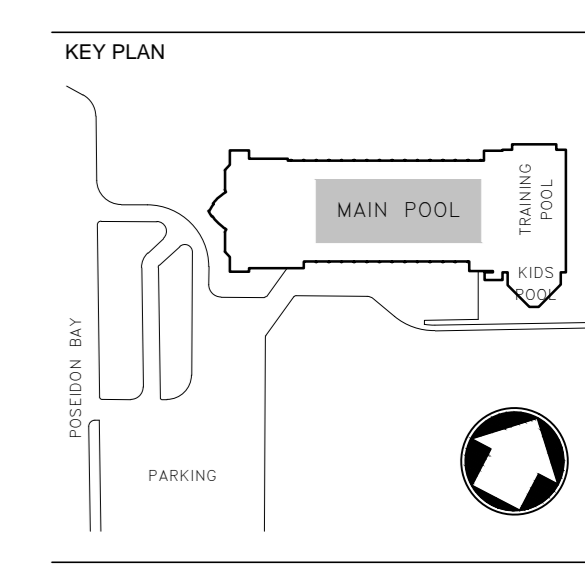

THIS DRAWING IS NOT TO BE SCALED.
REFER TO APPROPRIATE SAFETY, STRUCTURAL, MECHANICAL, ELECTRICAL, AND PLUMBING CODES AND STANDARDS FOR CONSTRUCTION. THE CONTRACTOR SHALL BE RESPONSIBLE FOR OBTAINING ALL NECESSARY PERMITS AND APPROVALS FROM THE CITY OF WINNIPEG. THE CONTRACTOR SHALL VERIFY AND ACCEPT RESPONSIBILITY FOR ALL DIMENSIONS AND CONDITIONS OF THE SITE AND SHALL NOTIFY THE APPROPRIATE CONTRACT ADMINISTRATOR OF ANY VARIATIONS FROM THE SUPPLIER INFORMATION.



SEAL

TRUE NORTH CONSTRUCTION NORTH

REVISIONS	No.	DATE	DESCRIPTION

GENERAL VIDEO DISPLAY/FRONT END SPECS:

DESCRIPTION: SINGLE SIDED LED DISPLAY USING A SEALED MODULE SYSTEM WITH REDUNDANCY AND DIAGNOSTICS DIRECT IP COMMUNICATION OPTION. WILL HAVE A FRONT END COMPUTER TO INTERFACE WITH THE TIMING AND SCORING SYSTEMS, SCHEDULE, AND SHOW DIFFERENT MEDIAS.

VIEWING SIZE: SAME AS CABINET SIZE

CABINET SIZE: 4.20m HIGH X 6.70m LONG X 0.20m DEEP

BOX CONSTRUCTION: ALUMINUM WITH POWDER COAT, BLACK

PIXEL PITCH: 10mm RGB

LED DISPLAY MATRIX: 416 PIXELS H X 672 PIXELS W. 279,552 TOTAL PIXELS

VIEWING ANGLE: 160 DEGREES H X 140 DEGREES V

WEIGHT: 800kg

OPERATING TEMP: -40°C TO 50°C

MODULE PROTECTION: YES, WATERPROOF, SEALED MODULES AND CABLES

MAX.ADG. WATTAGE: 12,000W MAX. 3,750W AVERAGE

BRIGHTNESS: 9,000 nits

SERVICE: REAR SERVICE

WARRANTY: 5 YEARS PARTS ONLY

COMMERCIAL RACK STYLE COMPUTER:

- 3.4GHZ QUAD-CORE PROCESSOR
- 16GB RAM
- 3GB VIDEO CARD TO SUPPORT 6 DISPLAYS
- CD/DVD DRIVE
- 1 TB HARD DRIVE
- QUAD - INPUT SERIAL CARD TO INTERFACE WITH TIMING SYSTEMS
- 2 - 22" MONITORS
- KEYBOARD AND MOUSE
- FIBRE PATCH CONNECTORS
- INTERNET ACCESS

INPUT RACK: 2 - SDI, 1 - DVI, 1 - HDMI

OUTPUT RACK: 2 - SDI, 1 - DVI, 1 - HDMI, 1 - RCA CONNECTION (TO BE CONNECTED TO EXISTING FACILITY PA SYSTEM)

UPS UNIT

SOFTWARE:

- SCHEDULER - DAILY, WEEKLY, MONTHLY LOOPS MADE UP OF PRE-RECORDED VIDEO, STILL SHOTS, TEXT, ETC.
- EVENT FILE DISPLAY - TO ALLOW AN EVENT GROUP TO INSTALL SPONSOR ADS, PRE-RECORDED VIDEO, STILL SHOTS, TEXT, ETC FOR THEIR EVENT
- INTERFACE WITH THE QUANTUM AND ARES 21 TIMING CONTROLLERS FOR SWIMMING AND WATER POLO
- INTERFACE WITH DIVING AND SYNCHRO SWIMMING SPORTS
- WARM UP COUNTDOWN CLOCK
- INSTALL A SCALER TO ALLOW INTERFACE WITH BUILDING LCD SCREENS

GENERAL STRUCTURAL AND ELECTRICAL REQUIREMENTS:

EXISTING ELECTRICAL:

- IN THE FILTRATION ROOM THERE IS A SUB PANEL WITH A 208V 3-PHASED 50AMP BREAKER TO SUPPLY POWER TO THE DISPLAY BOARD
- REUSE THE EXISTING BREAKER, WIRING AND CONNECTORS FOR THE NEW DISPLAY
- THE CONTRACTOR IS RESPONSIBLE TO HIRE A CERTIFIED ELECTRICIAN IN THE PROVINCE OF MANITOBA TO DISCONNECT THE EXISTING BOARD
- ENSURE THAT A LOCK OUT IS PLACED ON THE BREAKER FOR THE DURATION OF THE CONTRACT UNTIL THE NEW DISPLAY IS INSTALLED, CONNECTED AND READY TO START

EXISTING STRUCTURAL:

- THE CONTRACTOR IS RESPONSIBLE TO RETAIN A STRUCTURAL ENGINEER LICENSED IN THE PROVINCE OF MANITOBA TO INSPECT THE EXISTING WALL STRUCTURE TO BE ABLE TO SUPPORT THE NEW VIDEO DISPLAY
- THE CONTRACTOR IS TO DESIGN THE MOUNTING SYSTEM TO UTILIZE THE EXISTING ANCHORS TO THE BUILDING
- THE STRUCTURAL ENGINEER WILL REVIEW THE EXISTING WALL DETAILS, INSPECT THE SITE AND GENERATE A REPORT TO THE CONDITION OF THE EXISTING MOUNTING AND ANCHORING SYSTEM
- IF ADDITIONS ARE REQUIRED THEN THE STRUCTURAL ENGINEER WILL GENERATE THE REQUIRED DRAWINGS TO MAKE THE MODIFICATIONS TO SUIT THE NEW INSTALLATION
- THE COST OF MATERIAL, GENERATION AND INSTALLATION OF THE NEW ANCHORING WILL BE RESPONSIBILITY OF CONTRACTOR

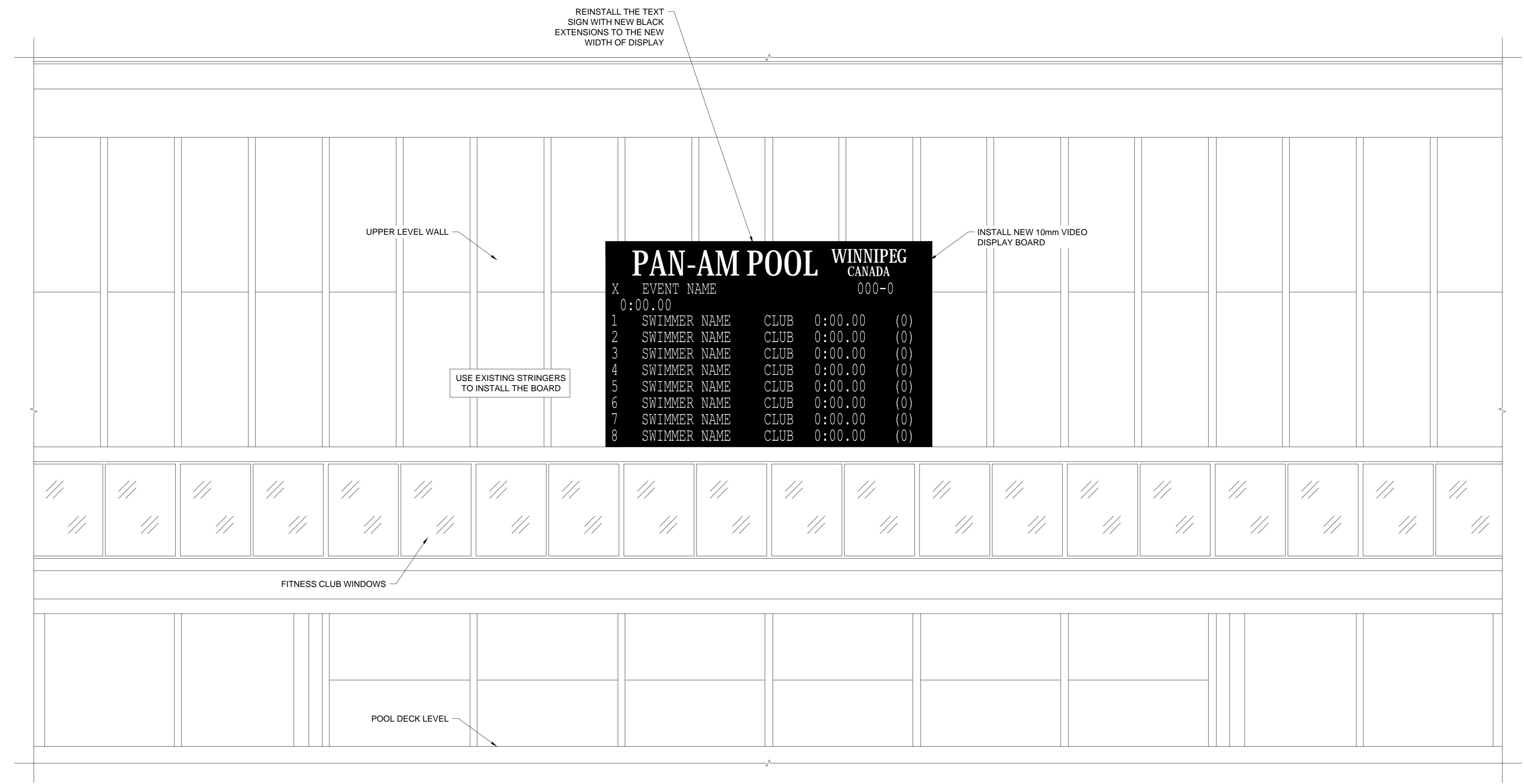

10mm VIDEO DISPLAY - NEW BOARD LOCATION - ELEVATION 2/150 AQ102

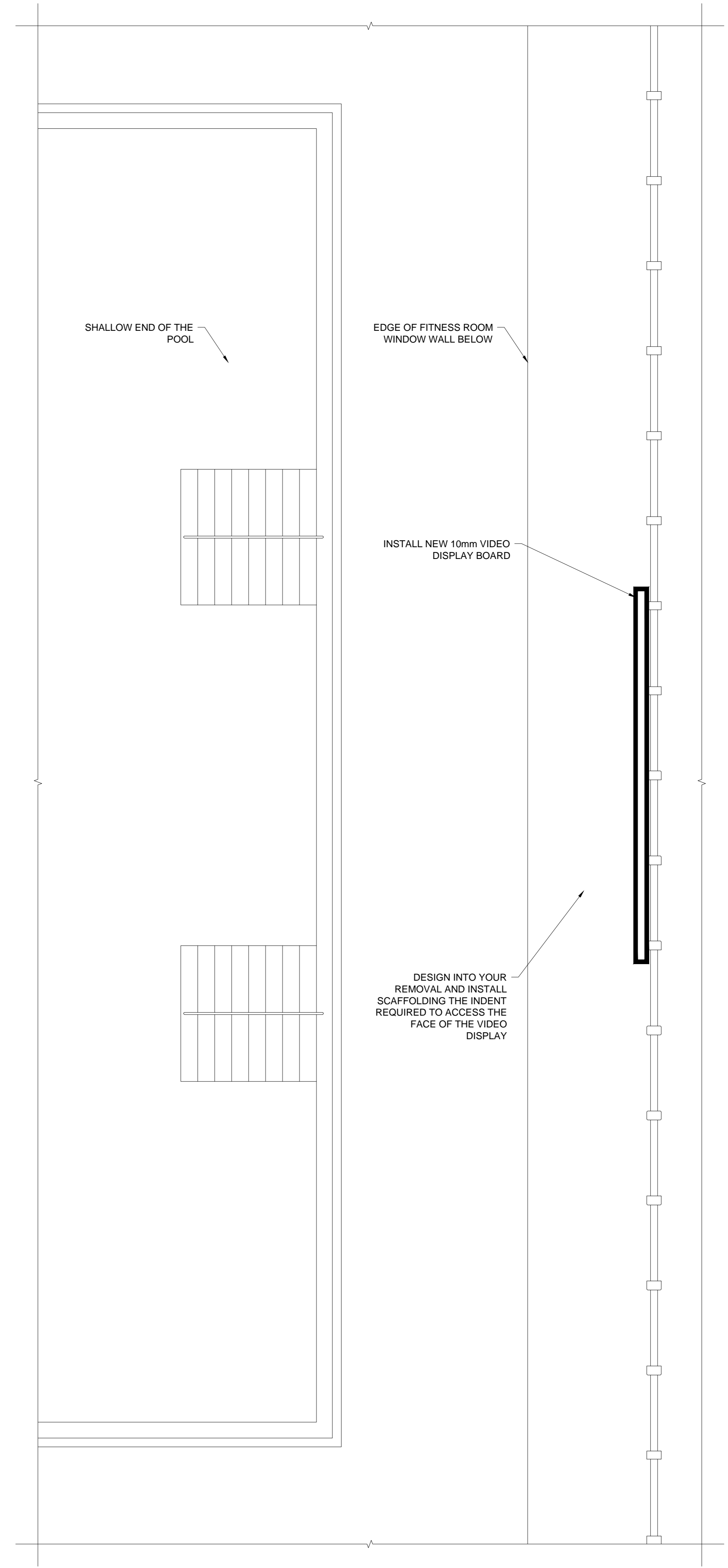

10mm VIDEO DISPLAY - NEW BOARD LOCATION - PLAN 1/150 AQ102

0 NOV. 18/16 ISSUED FOR BID

No. DATE DESCRIPTION

PROJECT: PAN AM POOL - WINNIPEG VIDEO DISPLAY BOARD REPLACEMENT

ISSUED:

DRAWN BY: DJ REVIEWED BY: TH

DATE: OCT 2016 SCALE: AS NOTED

PROJECT NO: PAN-W-011-14

SHEET TITLE:

10mm VIDEO DISPLAY - NEW BOARD LOCATION

SHEET NUMBER: **AQ102**