

WOLSELEY AVENUE

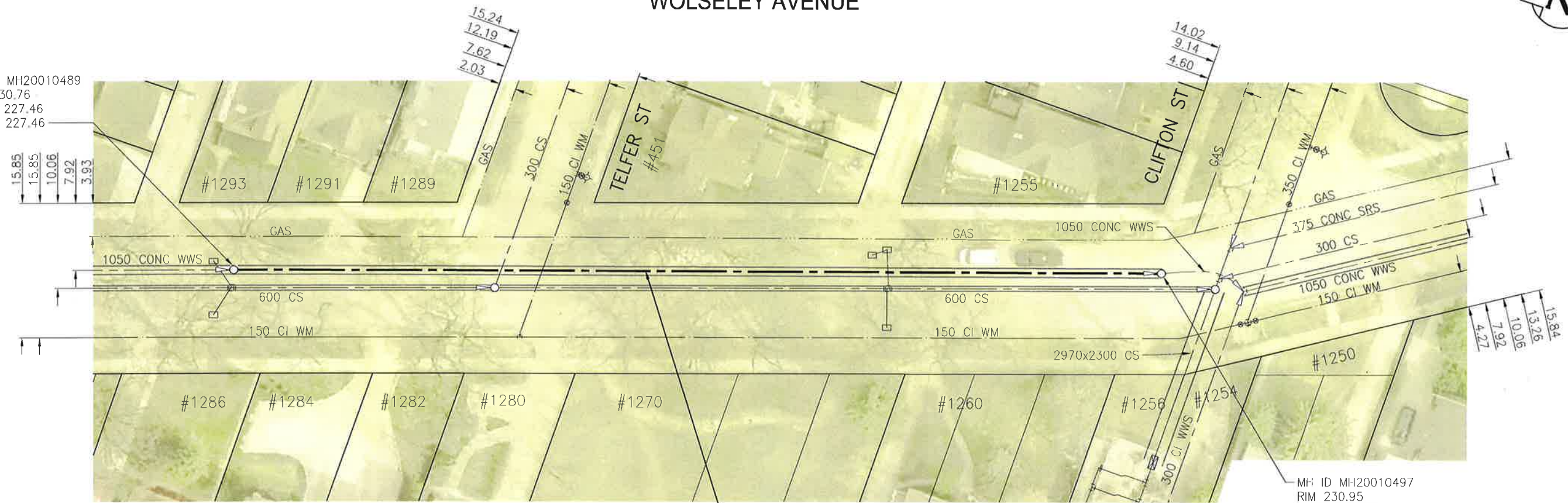

MH ID MH20010489
RIM 230.76
INV E 227.46
INV W 227.46



MH ID MH20010497
RIM 230.95
INV E 227.41
INV W 227.41

109.2 OF 1050 WWS TO BE LINED
(SEWER ID MA20011507)
FULLY DETERIORATED

SEWER JUNCTION INFORMATION FROM SEWER VIDEO INSPECTION		
SEWER ID S-MA20011507		
DISTANCE FROM MH20010489		
DISTANCE	DIAMETER	CLOCK
NO SERVICE JUNCTIONS		

WARNING

IF POWER EQUIPMENT OR EXPLOSIVES ARE TO BE USED FOR EXCAVATION ON THIS PROJECT THE CONTRACTOR MUST:
1) NOTIFY THE GAS COMPANY OF THE PROPOSED LOCATION OF EXCAVATION.
2) TAKE PRECAUTION TO AVOID DAMAGE TO GAS COMPANY INSTALLATIONS.
SEE PROVINCIAL REGULATION 140/92 FOR DETAILS

APEGM
Certificate of Authorization
Stantec Consulting Ltd.
No. 1301

METRIC
WHOLE NUMBERS INDICATE MILLIMETRES
DECIMALIZED NUMBERS INDICATE METRES
1:500
BID OPPORTUNITY NO. 1083-2016

LOCATION APPROVED UNDERGROUND STRUCTURES		B.M.	ELEV.
SUPV. U/G STRUCTURES COMMITTEE	DATE		
NOTE: LOCATION OF UNDERGROUND STRUCTURES AS SHOWN ARE BASED ON THE BEST INFORMATION AVAILABLE BUT NO GUARANTEE IS GIVEN THAT ALL EXISTING UTILITIES ARE SHOWN OR THAT THE GIVEN LOCATIONS ARE EXACT. CONFIRMATION OF EXISTENCE AND EXACT LOCATION OF ALL SERVICES MUST BE OBTAINED FROM THE INDIVIDUAL UTILITIES BEFORE PROCEEDING WITH CONSTRUCTION.			
NO.	REVISIONS	DATE	BY

Stantec
905 Waverley Street, Winnipeg, Manitoba
Tel 204-489-5900 Fax 204-453-9012

DESIGNED BY	JH	CHECKED BY	CD
DRAWN BY	SC	APPROVED BY	RS
HOR. SCALE:	1:500	RELEASED FOR CONSTRUCTION:	
VERTICAL:		DATE	Feb. 28/17

ENGINEER'S SEAL
PROVINCE OF MANITOBA
R.M. SHERLOCK
REGISTERED PROFESSIONAL ENGINEER
MEMBER 24045

CONSULTANT DRAWING NO.
C-108

THE CITY OF WINNIPEG
WATER AND WASTE DEPARTMENT

2016 SEWER RENEWALS BY CIPP LINING
CONTRACT 2
WOLSELEY AVENUE
1ST MH E OF STILES ST TO
MH AT CLIFTON ST S (W PL)

SHEET	OF
9	25
CAD FILE DRAWING NUMBER 16320c-108-894.DWG	
CITY DRAWING NUMBER 11363	

V:\1112\octive\111216320\0300_drawing\0302_sheet_files\02_civil\16320c-108-894.dwg