

ASBESTOS INVENTORY CONTROL



BID OPPORTUNITY 1179-2016

APPENDIX 2

Building Name:	Billy Mosienko Arena	Inspection Date:	February 16, 2016
Building Code:	AR-08	Inspected By:	James Neufeld & Ryan Matthews
Building Address:	709 Keewatin Street	Construction Date:	1975

Material Location	Material Description	Drawing Label	Material Condition	Testing Status	Date M/Y	Test %	Est. %
Front Lobby	Asphalt Plank Floor (1' x 4' Planks)	APF	Good	TESTED	Nov'12	3	
Women's Washroom	Asphalt Plank Flooring (1' x 4' Planks)	APF	Good				3
	Pipe Fitting Insulation	PF	Good	TESTED	Nov'12	0	
Meeting/Lecture Room	Pipe Fitting Insulation	PF	Good	TESTED	Nov'12	0	
	12x12 Floor Tile	F12	Good	TESTED		2-5	
East Corridor	12x12 Floor Tile	F12	Good	TESTED		2-5	
West Corridor	12x12 Floor Tile	F12	Good	TESTED		2-5	
Mechanical/Furnace Room (east)	Pipe Fitting Insulation	PF	Good				
Control Office	Pipe Fitting Insulation	PF	Good				
Program Office	Asphalt Plank Floor (1' x 4' Planks)	APF	Good				3
	Asphalt Plank Floor (1' x 4' Planks) - under carpet	APF	Good				3
First Aid Room - beside office	12x12 Floor Tile	F12	Good	TESTED		2-5	
Canteen	12x12 Floor Tile	F12	Good	TESTED		2-5	
	Pipe Fitting Insulation	PF	Good				
Canteen Storage Room	12x12 Floor Tile	F12	Good			2-5	
Men's Washroom	Pipe Fitting Insulation	PF	Good	TESTED	Nov'12	0	
	Asphalt Plank Flooring	APF	Good				3
Men's Washroom Supply Room	Pipe Fitting Insulation	PF	Good				0
Old Skate Sharpening Room	12x12 Floor Tile	F12	Good	TESTED		2-5	
	Duct Insulation	DI	Good				
	Pipe Insulation	PI	Good				0
Staff Room/Kitchen	12x12 Floor Tile	F12	Good	TESTED		2-5	
	Duct Insulation	DI	Good				
Hot Water Tank/Mechanical Room	Pipe Fitting Insulation	PF	Good	TESTED	Nov'12	0	
Rink Corridor	Asphalt Plank Floor (1' x 2' Planks - 1 Row 1' x 4' Planks)	APF	Good			3	
	Asphalt Plank Floor (1' x 2' Planks)						0
Dressing Rooms 1 - 4	Asphalt Plank Flooring (1' x 2' Planks)		Good				0
Dressing Room 4	Asphalt Plank Floor (1' x 4' Planks 1 Row under Benches)	APF	Good			3	

Material Location	Material Description	Drawing Label	Material Condition	Testing Status	Date M/Y	Test %	Est. %
	Asphalt Plank Floor (1' x 2' Planks)						0
Dressing Rms 1 & 2 Washroom / 3 & 4 Washroom	Asphalt Plank Floor (1' x 4' Planks)	APF	Good				3
	Pipe Fitting Insulation	PF	Good				0
Dressing Room 1 & 2 Shower Rm	Pipe Fitting Insulation	PF	Good	TESTED	Nov'12	0	
Referee Room (Washroom)	Asphalt Plank Flooring (1' x 4' Planks)	APF	Good				3
	Pipe Fitting Insulation	PF	Good				0
Dressing Room 3 & 4 Shower Rm	Pipe Fitting Insulation	PF	Good	TESTED	Nov'12	0	
Tractor Room	Pipe Fitting Insulation	PF	Good	TESTED	Nov'12	0	
Plant Room	Pipe Fitting Insulation	PF	Good	TESTED	Nov'12	0	
Exterior block walls of ice shed and wall between ice shed and front portion (south) of building	Contains Vermiculite Insulation (Which May Contain Asbestos)	VE	Good	TESTED			Trace
Exterior block walls of lobby, washrooms and meeting room of building - south portion	Walls randomly inspected and appeared to be empty						

NOTES:

1. Asbestos inspections and inventory updates are conducted annually.
2. There may be asbestos containing materials present that were not located during asbestos inspections.
3. Floor tile and sheet flooring installed before 1990 may contain asbestos and must be treated as an asbestos containing material.
4. Vermiculite insulation may contain pockets of asbestos. All vermiculite insulation must be treated as an asbestos containing material.
5. For asbestos related inquiries, call Central Control at 986-2382

AR-08

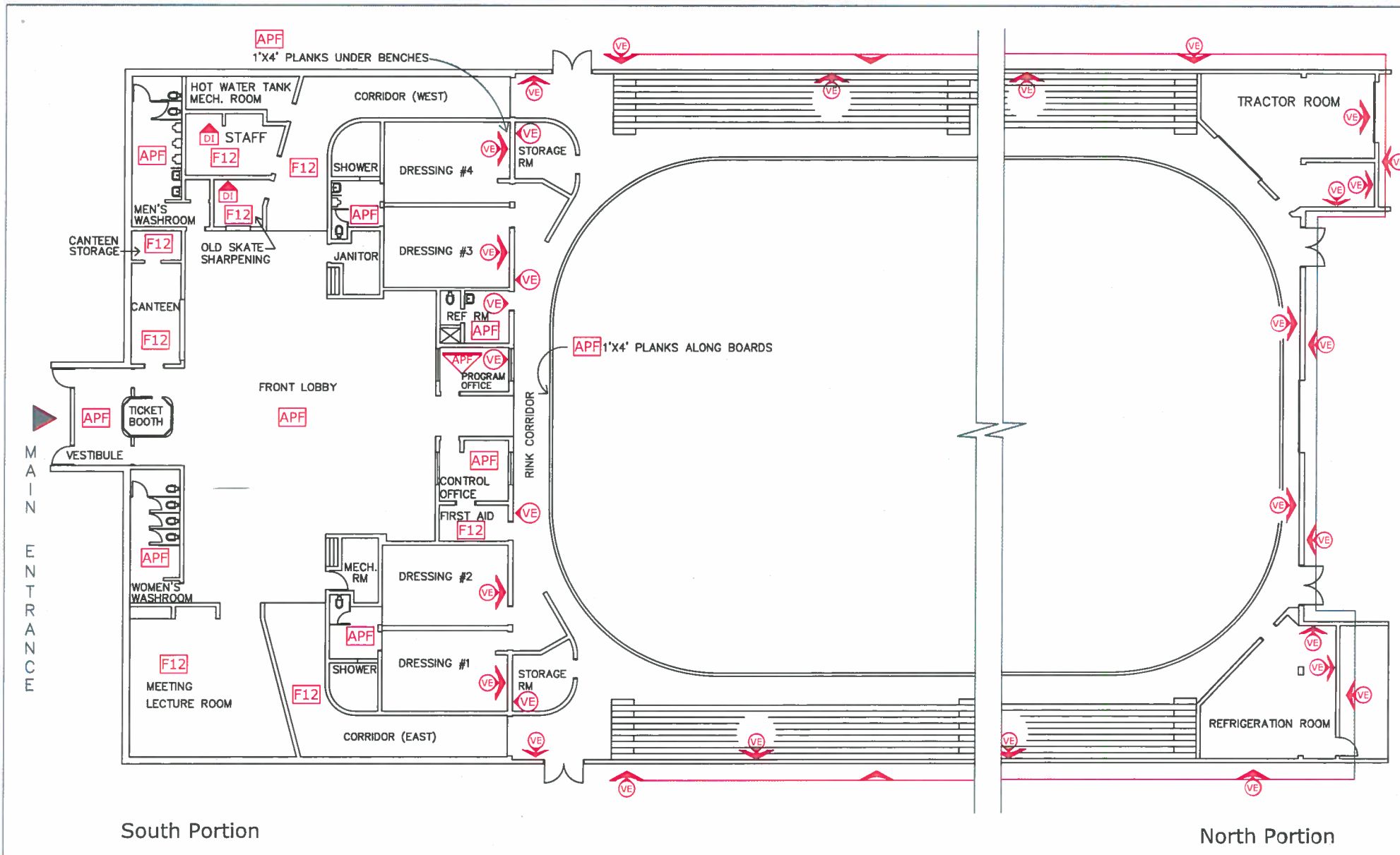

South Portion

North Portion

LEGEND	GENERAL LABELS	ON CEILING	ABOVE CEILING	UNDER FLOORING	WALL DETAIL	ENCAPSULATED ASBESTOS
?? =	??	??	??	??	??	??
AF:ASBESTOS FABRIC	FS:SHEET FLOORING	SC:STIPPLE CEILING				
APF: ASPHALT PLANK FLOOR	F9:9X9 FLOOR TILE	SO:SPRAY ON				
BR:BOILER REFRACTORY	F12: 12X12 FLOOR TILE	ST:STUCCO				
CA:CAULKING	HB:HARDBOARD	TI:TANK INSULATION				
C12: 12X12 CEILING TILE	MA:MASTIC	TP:TRANSITE PIPE				
C24: 24X24 CEILING TILE	PF:PIPE FITTING INSULATION	VE:VERMICULITE				
C48: 24X48 CEILING TILE	PI:PIPE INSULATION					
DC:DRYWALL COMPOUND	PL:PLASTER					
DI:DUCT INSULATION	RD:ROOF DRAIN					

NOTES:
 1. THERE MAY BE ASBESTOS CONTAINING MATERIALS PRESENT THAT WERE NOT LOCATED DURING BUILDING INSPECTIONS
 2. REFER TO THE ASBESTOS INVENTORY SURVEY SHEET FOR MORE INFORMATION
 3. DO NOT DISTURB ASBESTOS. FOR HANDLING PROCEDURES CALL CENTRAL CONTROL AT 986-2382

ASBESTOS LOCATIONS			
BUILDING:		Billy Moslenko Arena AR - 08 709 Keewatin Street Winnipeg, Manitoba	
REVISED BY:	DATE:	SCALE:	SHEET #:
A.B.	DECEMBER 6, 2013	N.T.S.	1/2

CITY OF WINNIPEG
 PLANNING, PROPERTY & DEVELOPMENT
 DEPARTMENT
 MUNICIPAL ACCOMMODATIONS DIVISION
 4th FLOOR - 185 KING STREET
 WINNIPEG, MANITOBA R3B 1J1
 PHONE: (204) 986-7266
 FAX: (204) 986-7311