

0+90.37 EXIST 250X150X250X150 CROSS
 0+91.326 NE R. OF PORTAGE AVE
 0+94.00 INSTALL 250X250X200 TEE
 0+94.50 EXIST 150 COUPLING
 0+94.50 EXIST 150 COUPLING
 0+98.75 EXIST 150 COUPLING
 0+98.75 EXIST 150 COUPLING
 0+98.84 ABANDON EXIST 150 VALVE
 0+99.60 EXIST 150 COUPLING
 1+00.00 NW R. OF PORTAGE AVE, INSTALL 200 VALVE
 1+00.65 REMOVE EXIST HYDRANT ASSEMBLY
 1+01.00 EXIST 150 COUPLING
 1+03.00 INSTALL HYDRANT ASSEMBLY (SD-006)

1+56.75 EXIST 200 COUPLING
 1+57.00 EXIST 200-150 REDUCER
 1+57.75 EXIST 200-45° BEND
 1+57.75 EXIST 200-45° BEND
 1+60.00 INSTALL 200-45° BEND
 1+61.00 INSTALL 200-45° BEND
 1+62.00 REMOVE EXIST 200-45° BEND & CONNECT TO EXIST 200 AC WM W/COUPLING

NOTE: CHAINAGES SHOWN ARE ALONG E. R. OF TORONTO ST

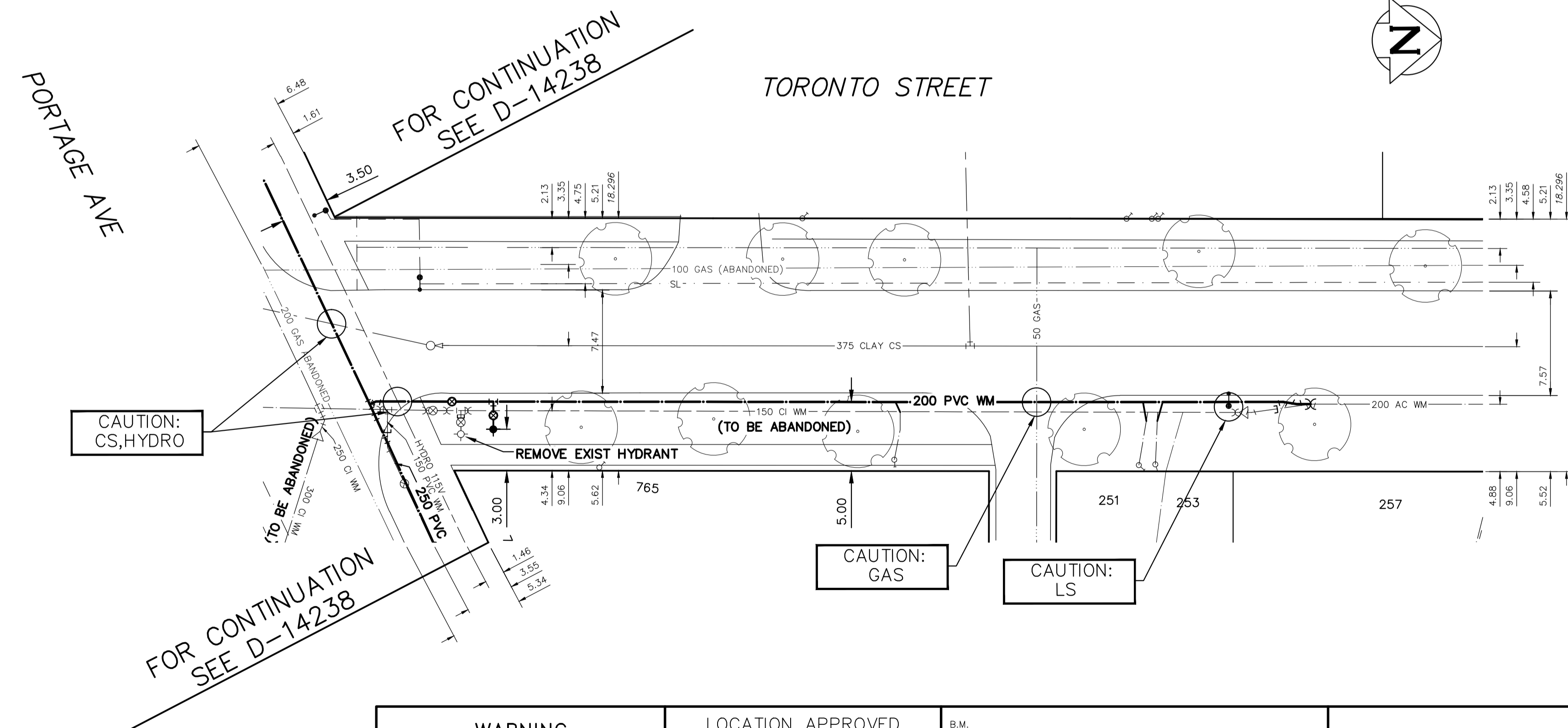

CAUTION: CS, HYDRO

CAUTION: GAS

CAUTION: LS

WATER SERVICE INFORMATION

ADDRESS	SIZE (mm) MATERIAL (STREET)	SIZE (mm) MATERIAL (PROP.)	SHORT & LONG MEASUREMENT	CORP. LOCATION	REMARKS
251 TORONTO ST RESIDENTIAL	20 CU	20 CU	-	-	RECONNECT SERVICE
253 TORONTO ST RESIDENTIAL	20 CU	20 CU	5.81 NSL HSE	0.2 N OF S/C	RECONNECT SERVICE
257 TORONTO ST COMMERCIAL	25 CU	25 CU	17.06 NSL BLDG	0.6 S OF S/C	OUTSIDE LIMITS

* SERVICES TO BE RENEWED TO R. ALL OTHERS TO BE RECONNECTED

FOR INDEX SEE D-14227

NOTE: ALL VALVES TO BE INSTALLED COUNTERCLOCKWISE TO CLOSE

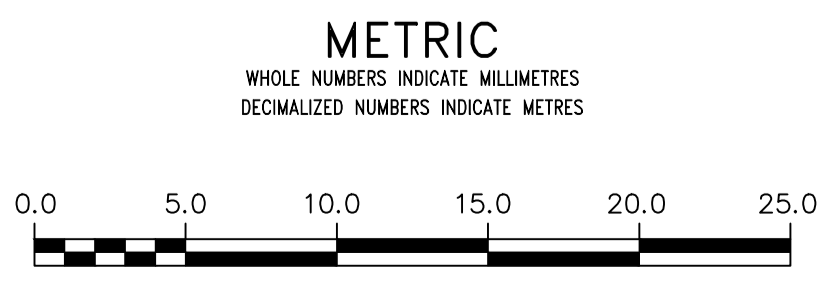

WARNING
 IF POWER EQUIPMENT OR EXPLOSIVES ARE TO BE USED FOR EXCAVATION ON THIS PROJECT THE CONTRACTOR MUST:
 1) NOTIFY THE GAS COMPANY OF THE PROPOSED LOCATION OF EXCAVATION.
 2) TAKE PRECAUTION TO AVOID DAMAGE TO GAS COMPANY INSTALLATIONS.
 SEE PROVINCIAL REGULATION 210/72 FOR DETAILS

LOCATION APPROVED UNDERGROUND STRUCTURES
 SUPV. U/G STRUCTURES COMMITTEE DATE
 NOTE:
 LOCATION OF UNDERGROUND STRUCTURES AS SHOWN ARE BASED ON THE BEST INFORMATION AVAILABLE BUT NO GUARANTEE IS GIVEN THAT ALL EXISTING UTILITIES ARE SHOWN OR THAT THE GIVEN LOCATIONS ARE EXACT. CONFIRMATION OF EXISTENCE AND EXACT LOCATION OF ALL UTILITIES MUST BE OBTAINED FROM THE INDIVIDUAL UTILITIES BEFORE PROCEEDING WITH CONSTRUCTION.

NO.	REVISIONS	DATE	BY

DESIGNED BY	TS	CHECKED BY	SC
DRAWN BY	RS	APPROVED BY	KZ
SCALE:	HORIZONTAL 1:250 VERTICAL 1:50		
DATE	2016 03 24	DATE	2016 03 24

ENGINEER'S SEAL
 ORIGINAL SIGNED BY
 S.R.J. COUNROYER
 16-03-24
 CONSULTANT DRAWING NUMBER

THE CITY OF WINNIPEG
 WATER AND WASTE DEPARTMENT
 ENGINEERING DIVISION
 2016 WATER MAIN RENEWALS
 CONTRACT 7
 TORONTO STREET
 PORTAGE AVENUE TO
 75 N OF PORTAGE AVENUE

SHEET 11 OF 12
 CITY DRAWING NUMBER
 D-14237