

234.00
233.60
233.20
232.80
232.40
232.00

234.00
233.60
233.20
232.80
232.40
232.00

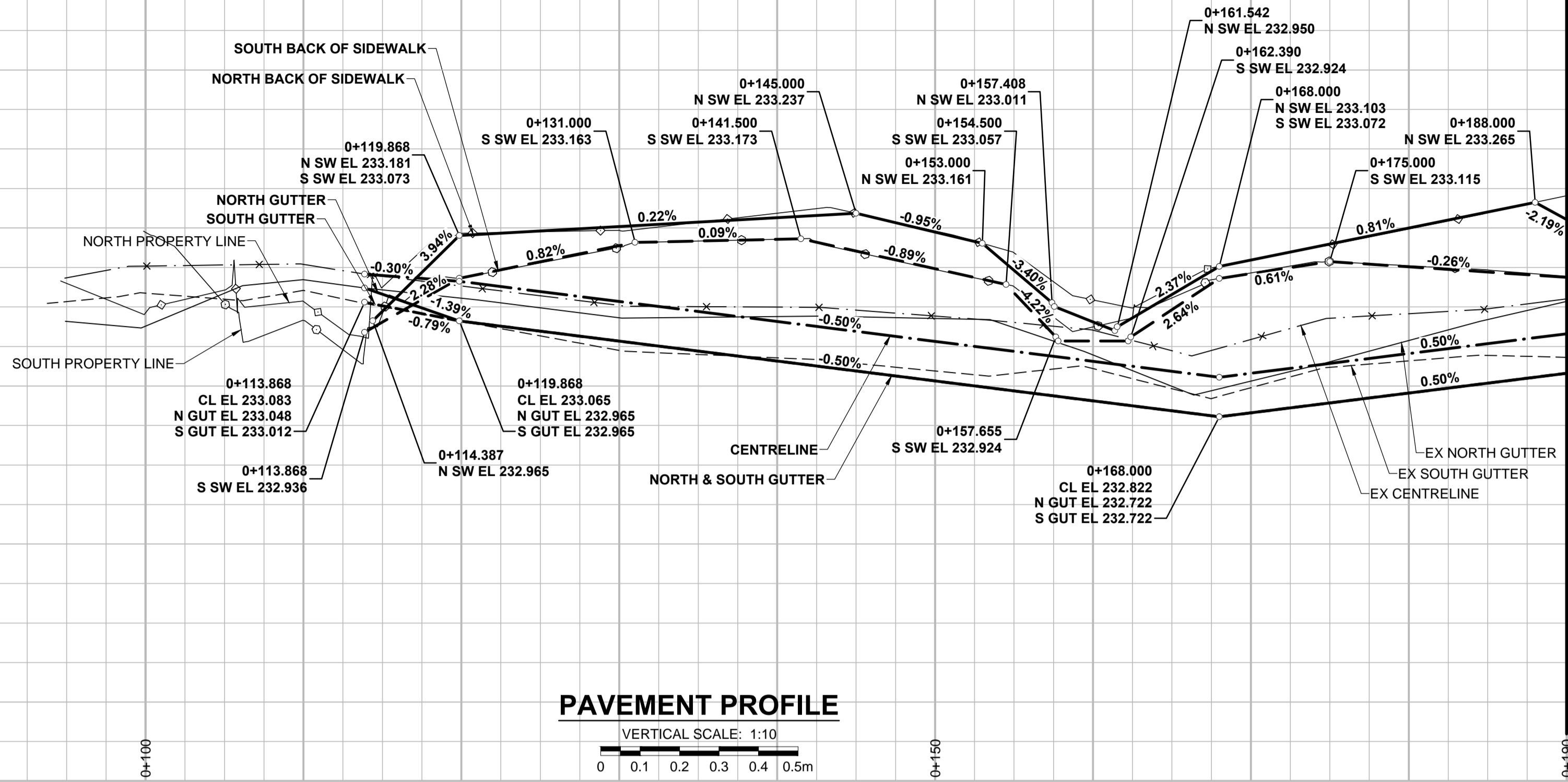

PAVEMENT PROFILE

VERTICAL SCALE: 1:10
0 0.1 0.2 0.3 0.4 0.5m

NOTES

1. ADJUST MH AND CB RIMS TO NEW GRADES.
2. LAMP STANDARDS, HYDRO POLES, AND ANCHORS THAT REQUIRE TEMPORARY SUPPORT, REMOVAL OR REPLACEMENT, TO BE DONE SO AT THE EXPENSE OF THE CONTRACTOR AS NECESSARY.
3. CONTRACTOR TO REGRADE/RENEW EXISTING PRIVATE SIDEWALKS TO LIMITS AS SHOWN. SIDEWALKS TO BE RENEWED WITH CONCRETE UNLESS NOTED OTHERWISE.
4. CONTRACTOR TO TAKE PRECAUTIONARY STEPS TO PROTECT EXISTING TREES WITHIN THE LIMITS OF CONSTRUCTION FROM DAMAGE FROM CONSTRUCTION ACTIVITIES AS OUTLINED IN THE SPECIFICATIONS.
5. CONTRACTOR TO CONFIRM THE LOCATION OF ALL UTILITIES/SERVICES IN THE FIELD PRIOR TO CONSTRUCTION.
6. CB SD-023 & SD-024 OFFSETS ARE DIMENSIONED TO BOC. CB SD-025 OFFSETS ARE DIMENSIONED O/C.
7. IN GENERAL, PAVEMENT AND SIDEWALK AREAS TO BE REMOVED. MATCH RECONSTRUCTION LIMITS.
8. REFER TO BID OPPORTUNITY FOR DETAILS REGARDING TRAFFIC MANAGEMENT.
9. ALL EXISTING LONG WATER SERVICES TO BE INSULATED (SD-018). REFER TO BID OPPORTUNITY FOR FURTHER REQUIREMENTS.
10. ALL COSTS, MATERIALS AND LABOR ASSOCIATED WITH THE RESTORATION OF THE CATHODIC PROTECTED WATERMAIN WILL BE THE RESPONSIBILITY OF THE CONTRACTOR.
11. ADD 200.000m TO ABBREVIATED ELEVATIONS TO OBTAIN GEODETIC ELEVATIONS.

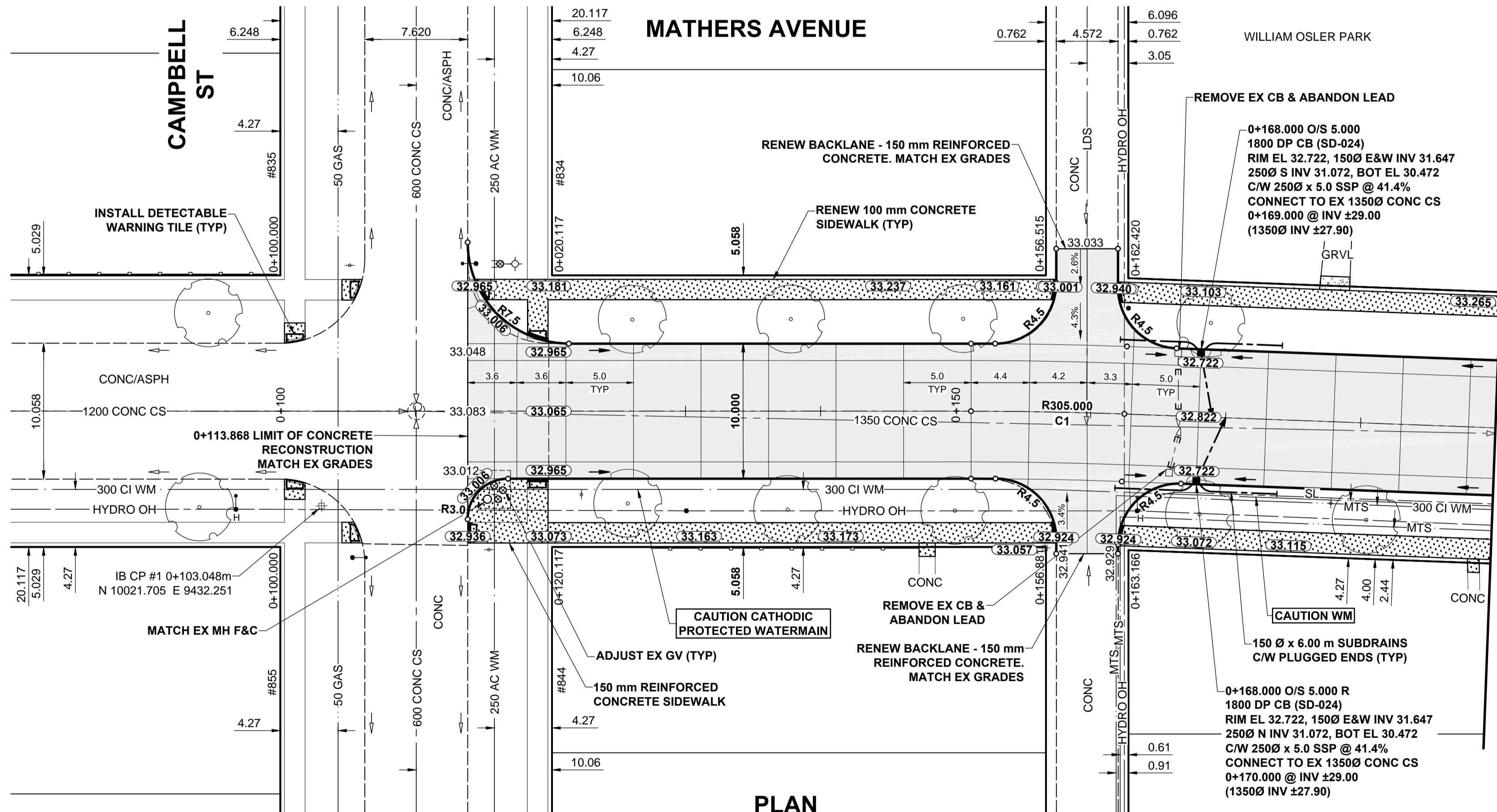

PLAN

SCALE: 1:250
0 5 10 15m



CONTROL LINE - CURVES				
CURVE	RADIUS	LENGTH	DELTA	TANGENT
C1	305.000	11.356	2°08'00"	5.679

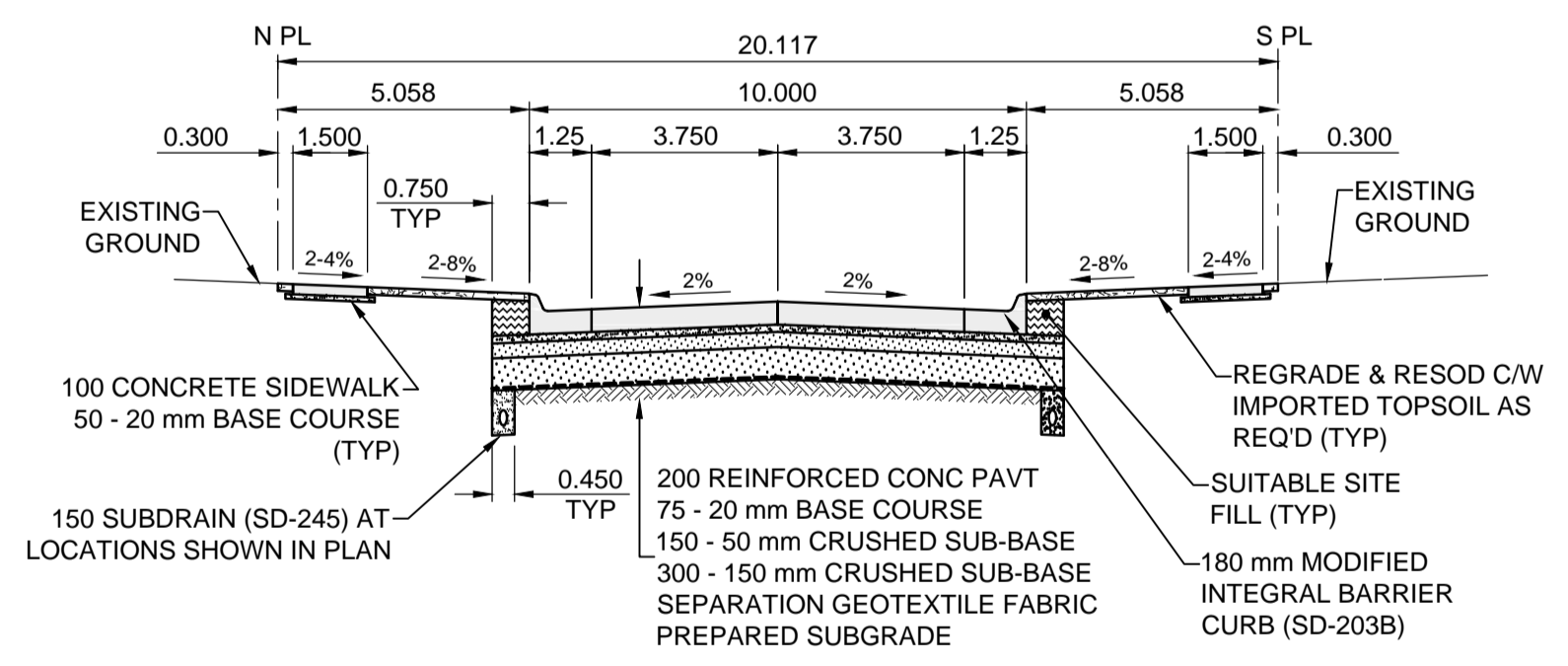

TYPICAL PAVEMENT SECTION

CONCRETE PAVEMENT STRUCTURE
SCALE: NTS

METRIC
WHOLE NUMBERS INDICATE MILLIMETRES
DECIMALIZED NUMBERS INDICATE METRES

EXISTING	NEW	EXISTING	NEW	EXISTING	NEW	EXISTING	NEW

LOCATION APPROVED
UNDERGROUND STRUCTURES

DATE: _____

NOTE:
LOCATION OF UNDERGROUND STRUCTURES AS SHOWN ARE BASED ON THE BEST INFORMATION AVAILABLE BUT NO GUARANTEE IS GIVEN THAT ALL EXISTING UTILITIES ARE SHOWN OR THAT THE GIVEN LOCATIONS ARE EXACT. CONFIRMATION OF EXISTENCE AND EXACT LOCATION OF ALL SERVICES MUST BE OBTAINED FROM THE INDIVIDUAL UTILITIES BEFORE PROCEEDING WITH CONSTRUCTION.

BM 51-009	N.W. Cor. Mathers Ave. & Queenston St.	ELEV 233.133 m	Bress plug in 10.5 m Conc. pile 2.7 m S. of N.L. Mathers Ave. & 2.7 m E. of W.L. Queenston St.												
<table border="1"> <tr> <th>No.</th> <th>REVISIONS</th> <th>DATE</th> <th>BY</th> </tr> <tr> <td>B</td> <td>ISSUED FOR TENDER</td> <td>16/04/14</td> <td>JGK</td> </tr> <tr> <td>A</td> <td>ISSUED FOR CLIENT REVIEW</td> <td>16/03/18</td> <td>JGK</td> </tr> </table>				No.	REVISIONS	DATE	BY	B	ISSUED FOR TENDER	16/04/14	JGK	A	ISSUED FOR CLIENT REVIEW	16/03/18	JGK
No.	REVISIONS	DATE	BY												
B	ISSUED FOR TENDER	16/04/14	JGK												
A	ISSUED FOR CLIENT REVIEW	16/03/18	JGK												



DESIGNED BY	JGK	CHECKED BY	WRJ
DRAWN BY	DML	APPROVED BY	BWB
RELEASED FOR CONSTRUCTION			
HOR SCALE: 1:250 VERT SCALE: 1:10			
DATE: 16/03/09			



THE CITY OF WINNIPEG
PUBLIC WORKS DEPARTMENT
ENGINEERING DIVISION

2016 LOCAL STREETS PACKAGE
MATHERS AVENUE
CAMPBELL ST TO ASH ST
CONCRETE RECONSTRUCTION
HORIZONTAL AND VERTICAL ALIGNMENT
CAMPBELL ST TO STA 0+190

CITY DRAWING NUMBER: N/A
SHEET 1 OF 17
DRAWING No. 1
REV B

CONSULTANT FILE NAME: W160015-Mathers-PP-01.dwg

BID OPPORTUNITY No. 180-2016