

ISO A1 - 594mm x 841mm

K:\Proj\16015-Hector\Drawings\16015-Hector-PP-03.dwg - Last Saved: 4/28/2016 3:51 PM by: lheard - Plotted: 5/2/2016 2:30 PM by: Dave Lane

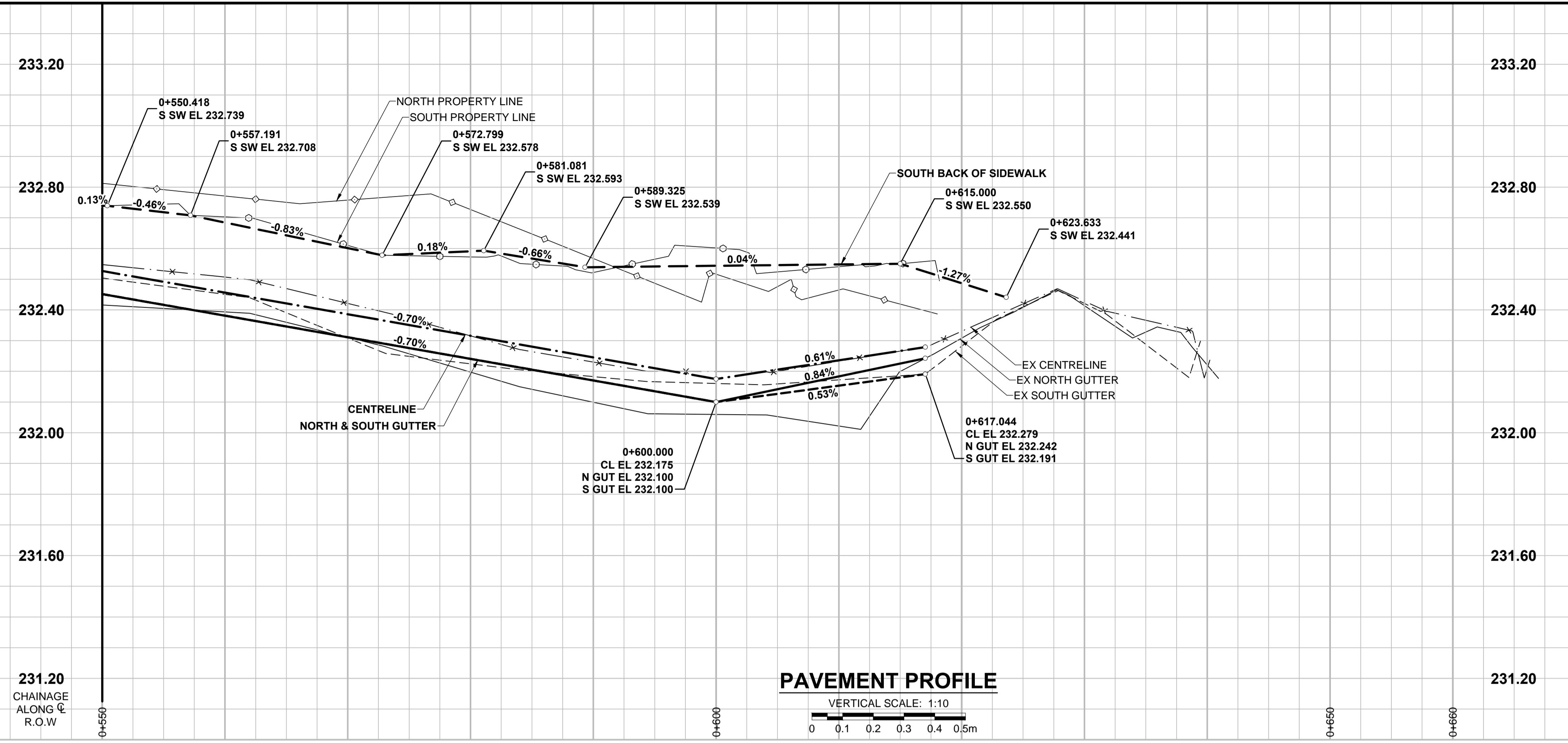

- NOTES**
- ADJUST MH AND CB RIMS TO NEW GRADES.
 - LAMP STANDARDS, HYDRO POLES, AND ANCHORS THAT REQUIRE TEMPORARY SUPPORT, REMOVAL OR REPLACEMENT, TO BE DONE SO AT THE EXPENSE OF THE CONTRACTOR AS NECESSARY.
 - CONTRACTOR TO REGRADE/RENEW EXISTING PRIVATE SIDEWALKS TO LIMITS AS SHOWN. SIDEWALKS TO BE RENEWED WITH CONCRETE UNLESS NOTED OTHERWISE.
 - CONTRACTOR TO TAKE PRECAUTIONARY STEPS TO PROTECT EXISTING TREES WITHIN THE LIMITS OF CONSTRUCTION FROM DAMAGE FROM CONSTRUCTION ACTIVITIES AS OUTLINED IN THE SPECIFICATIONS.
 - CONTRACTOR TO CONFIRM THE LOCATION OF ALL UTILITIES/SERVICES IN THE FIELD PRIOR TO CONSTRUCTION.
 - CB SD-023 & SD-024 OFFSETS ARE DIMENSIONED TO BOC. CB SD-025 OFFSETS ARE DIMENSIONED O/C.
 - IN GENERAL, PAVEMENT AND SIDEWALK AREAS TO BE REMOVED. MATCH RECONSTRUCTION LIMITS.
 - REFER TO BID OPPORTUNITY FOR DETAILS REGARDING TRAFFIC MANAGEMENT.
 - ALL EXISTING LONG WATER SERVICES TO BE INSULATED (SD-018). REFER TO BID OPPORTUNITY FOR FURTHER REQUIREMENTS.
 - ADD 200.000m TO ABBREVIATED ELEVATIONS TO OBTAIN GEODETIC ELEVATIONS.

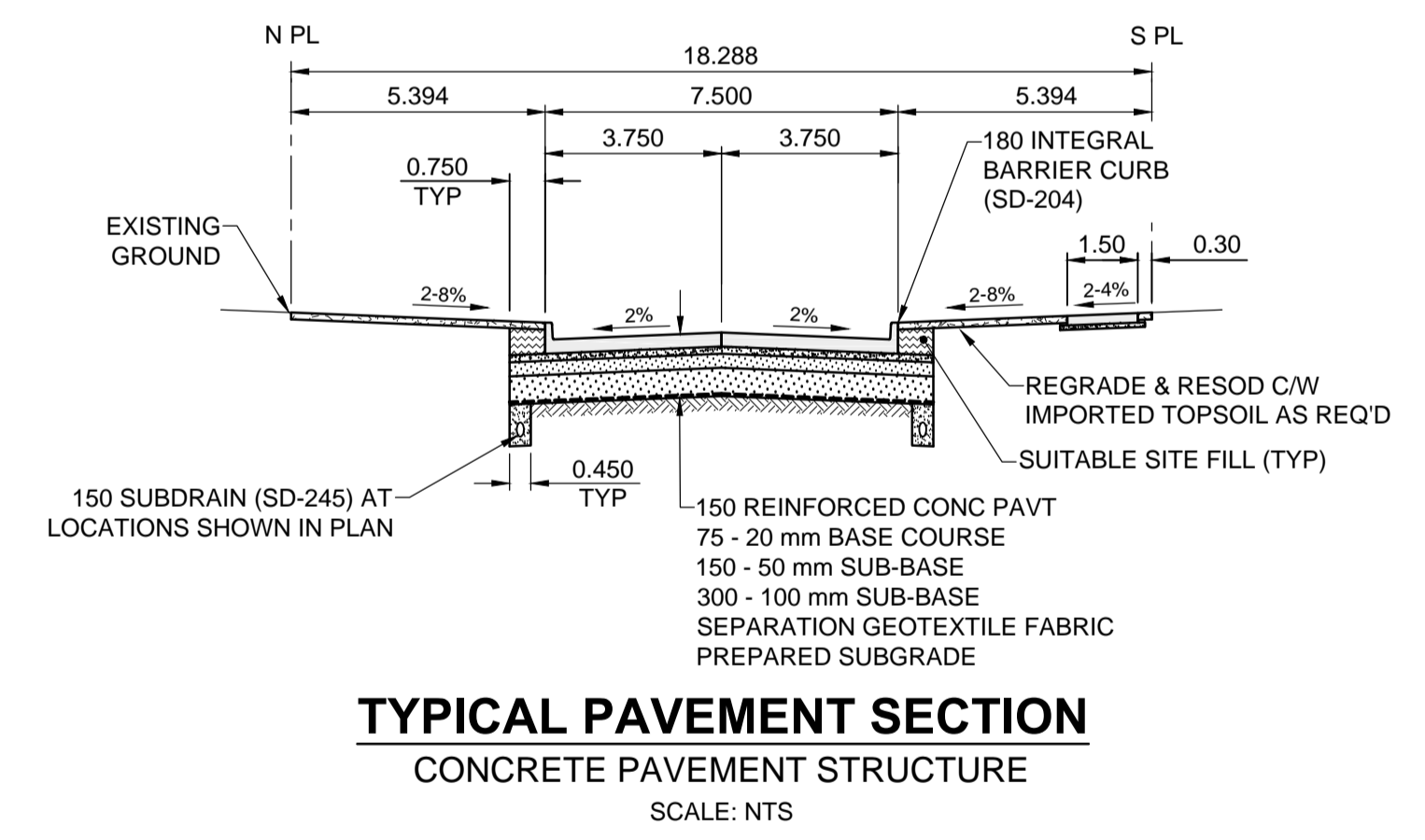
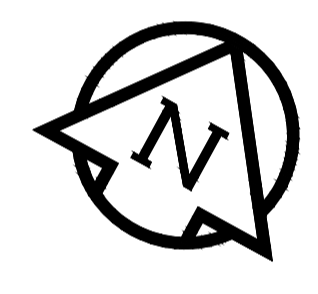
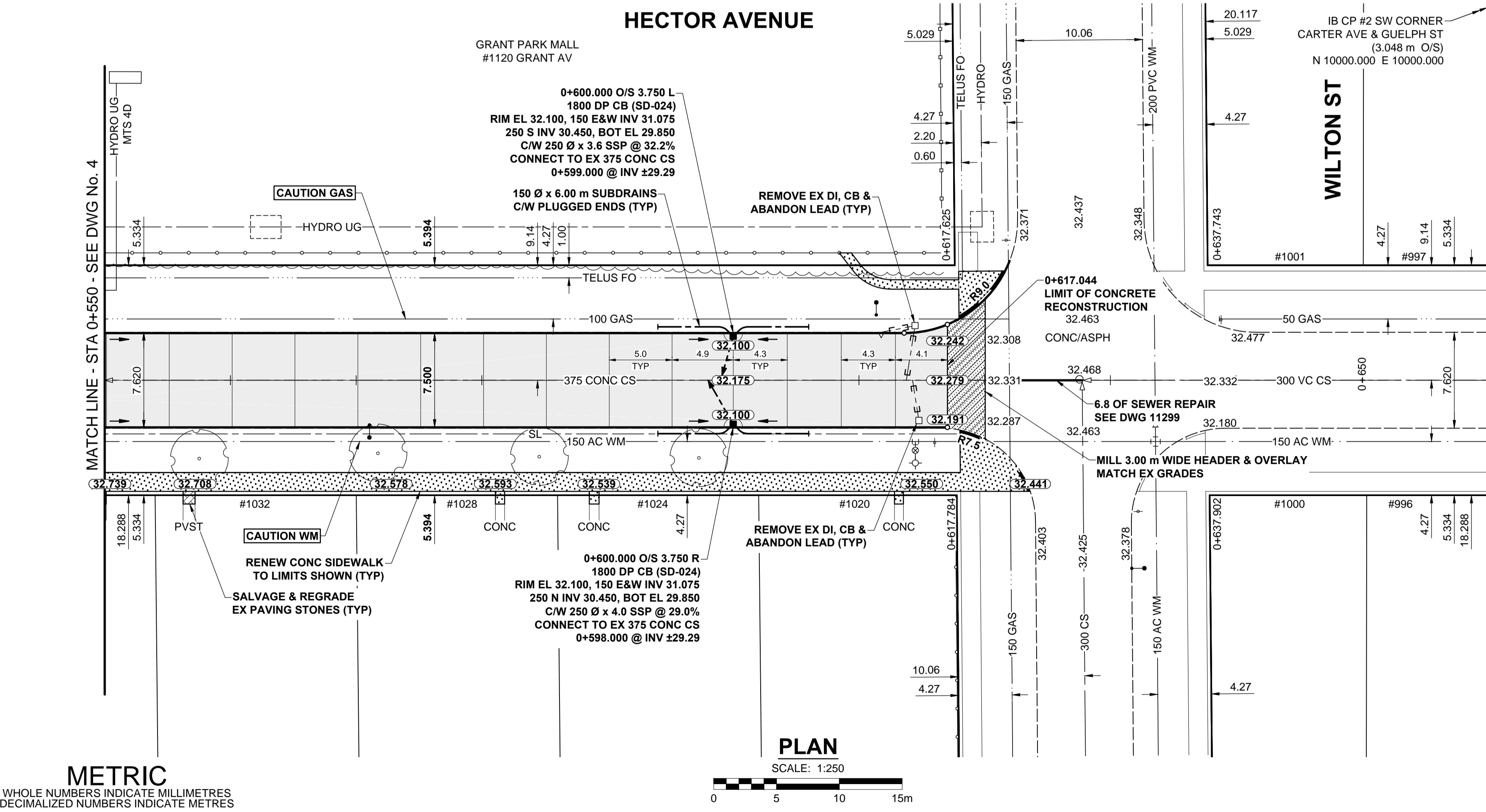

METRIC
WHOLE NUMBERS INDICATE MILLIMETRES
DECIMALIZED NUMBERS INDICATE METRES

EXISTING		NEW		EXISTING		NEW		EXISTING		NEW	
	GAS		MANHOLE		CONCRETE PAVEMENT		CATCH BASIN/CATCH PIT		CONC SIDEWALK/MEDIAN		PAVING STONE
	HYDRO HANDWELL/PEDESTAL		TREE		ASPHALT PAVEMENT		CURB INLET WITH BOX		GRAVEL		RAMP CURB
	CATV/FIBRE OPTIC		TEST HOLE		PLANING/REMOVAL		PROPERTY LINE		FENCE		TRAFFIC SIGN
	TRAFFIC SIGNALS/PIT		SURVEY BAR		BOC/EDGE OF PAVEMENT		ELEVATION		TRAFFIC SIGN		
	LAND DRAINAGE SEWER		FENCE		ELEVATION		TRAFFIC SIGN				
	SANITARY/COMBINED SEWER		BOC/EDGE OF PAVEMENT		ELEVATION		TRAFFIC SIGN				
	CB LEAD/SSP/DCP		ELEVATION		TRAFFIC SIGN						
	WATERMAIN		TRAFFIC SIGN								
	SUBDRAIN										
	DITCH										

LOCATION APPROVED
UNDERGROUND STRUCTURES

SUPR. U/G STRUCTURES COMMITTEE DATE

NOTE:
LOCATION OF UNDERGROUND STRUCTURES AS SHOWN ARE BASED ON THE BEST INFORMATION AVAILABLE BUT NO GUARANTEE IS GIVEN THAT ALL EXISTING UTILITIES ARE SHOWN OR THAT THE GIVEN LOCATIONS ARE EXACT. CONFIRMATION OF EXISTENCE AND EXACT LOCATION OF ALL SERVICES MUST BE OBTAINED FROM THE INDIVIDUAL UTILITIES BEFORE PROCEEDING WITH CONSTRUCTION.

NO.	REVISIONS	DATE	BY
C	REVISED FOR ADDENDUM 1	16/05/03	JGK
B	ISSUED FOR TENDER	16/04/26	JGK
A	ISSUED FOR CLIENT REVIEW	16/04/19	JGK

DESIGNED BY	CHECKED BY	DRAWN BY	APPROVED BY	RELEASED FOR CONSTRUCTION
JGK	WJR	KMB	BWB	

HOR SCALE: 1:250
VERT SCALE: 1:10
DATE: 16/04/19

PROFESSIONAL'S SEAL
PROVINCE OF MANITOBA
REGISTERED PROFESSIONAL ENGINEER
J.G. KENNEDY
Member 22326

CONSULTANT FILE NAME
W16015-Hector-PP-03.dwg

THE CITY OF WINNIPEG
PUBLIC WORKS DEPARTMENT
ENGINEERING DIVISION

2016 LOCAL STREETS PACKAGE
HECTOR AVENUE
HECTOR BAY E (W LEG) TO WILTON ST
CONCRETE RECONSTRUCTION
HORIZONTAL AND VERTICAL ALIGNMENT
STA 0+550 TO WILTON ST

CITY DRAWING NUMBER: N/A
SHEET 5 OF 14
DRAWING No. REV: 5 C

BID OPPORTUNITY No. 181-2016