

ISO A1 - 594mm x 841mm
 M:\P\W\1500224\Drawings\5 Sheets\W150022 St James-PP-07.dwg
 Last Saved: 10/31/2016 2:34 PM by DDaszpod
 Plotted: 10/31/2016 2:38 PM by DDaszpod

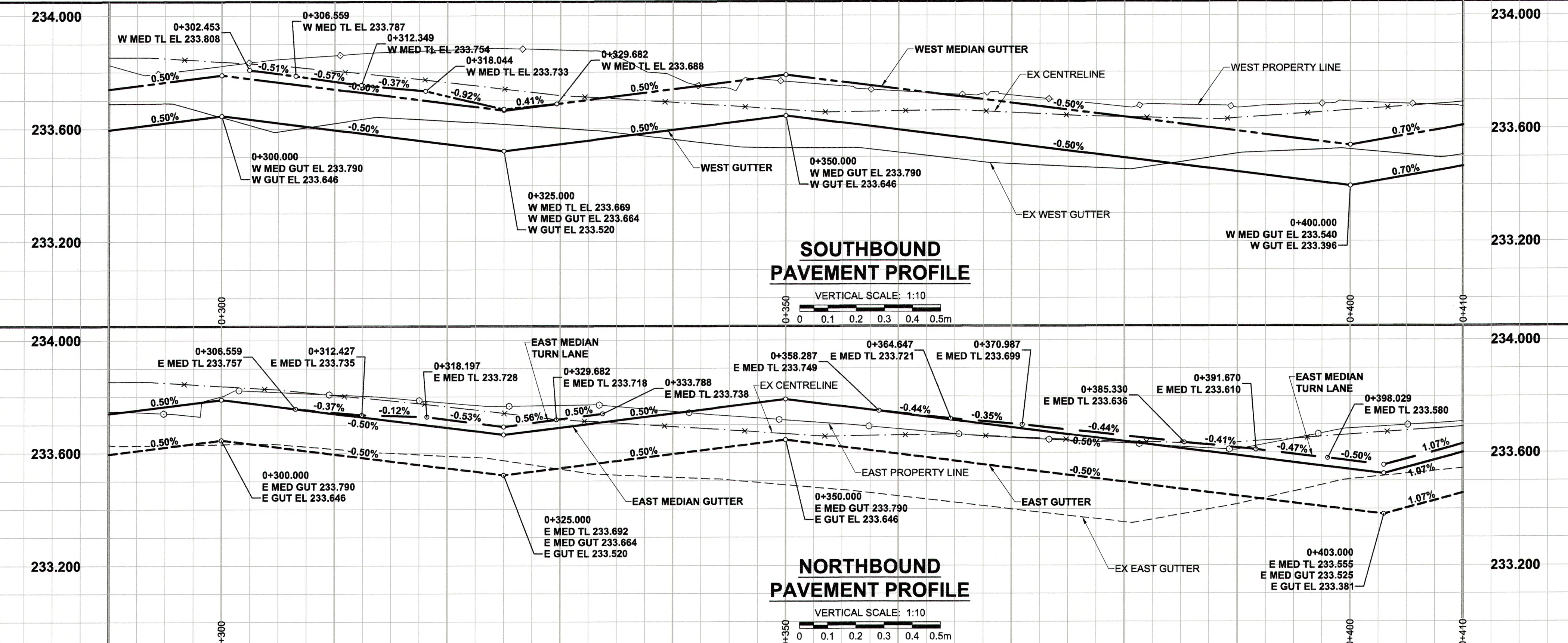

CHAINAGE ALONG WEST

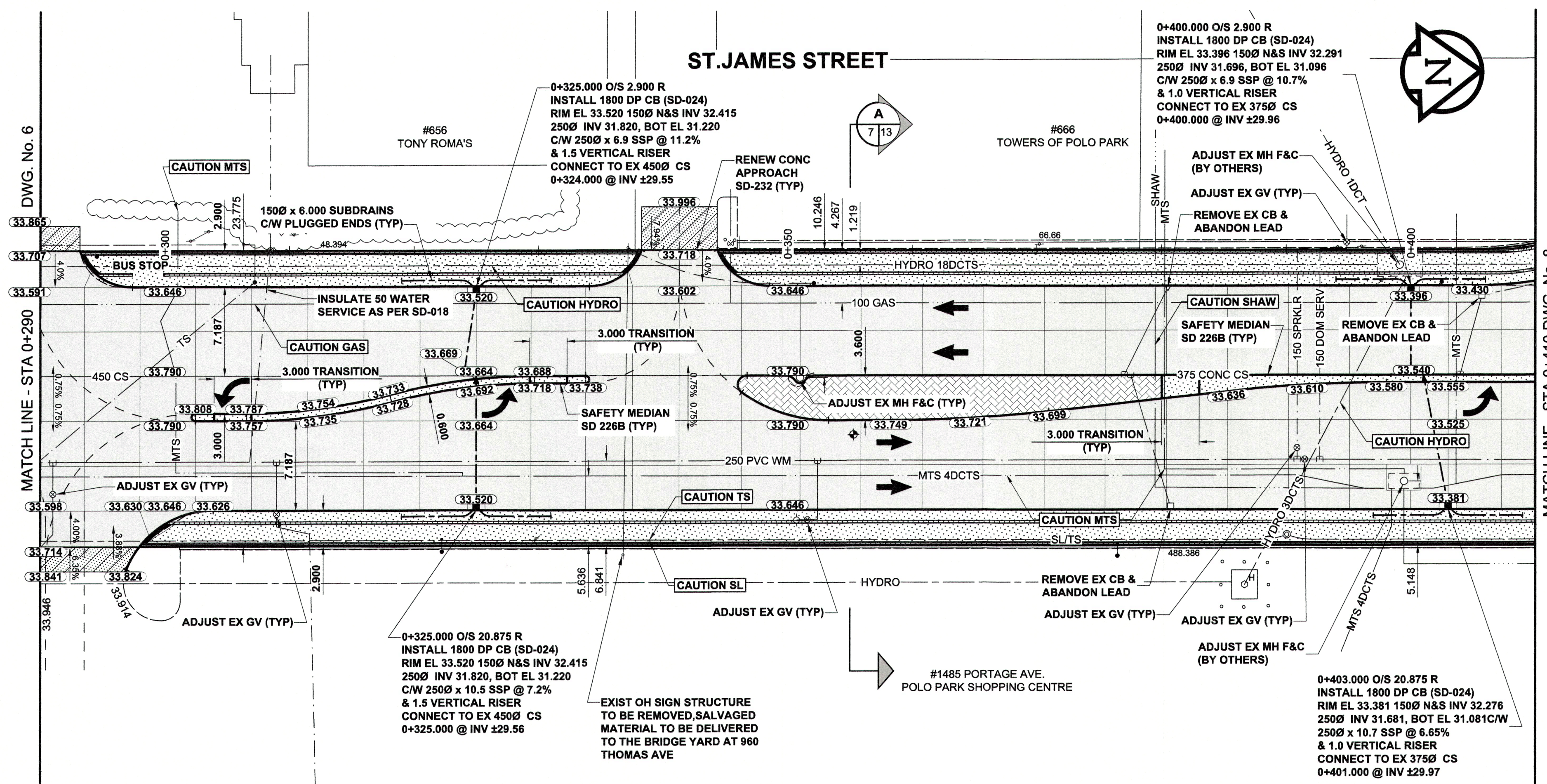

- NOTES**
- ADJUST MH AND CB RIMS TO NEW GRADES.
 - CONTRACTOR TO REGRADE/RENEW EXIST PRIVATE SIDEWALKS TO LIMITS AS SHOWN. SIDEWALKS TO BE RENEWED WITH CONCRETE UNLESS NOTED OTHERWISE.
 - CONTRACTOR TO TAKE PRECAUTIONARY STEPS TO PROTECT EXISTING TREES WITHIN THE LIMITS OF CONSTRUCTION FROM DAMAGE FROM CONSTRUCTION ACTIVITIES AS OUTLINED IN THE SPECIFICATIONS.
 - MODIFIED BARRIER CURBS TO BE CONSTRUCTED AT ALL INTERSECTION RADII, BACK LANE RADII AND BULLNOSES.
 - CONTRACTOR TO CONFIRM THE LOCATION OF ALL UTILITIES/SERVICES IN THE FIELD PRIOR TO CONSTRUCTION.
 - ADD 200.00m TO ABBREVIATED ELEVATIONS TO OBTAIN GEODETIC ELEVATIONS.
 - CB SD-024 OFFSETS ARE DIMENSIONED TO BOC. CB SD-025 OFFSETS ARE DIMENSIONED O/C.
 - SEE DRAWING No. 13 FOR STREETSCAPING DETAILS.
 - ALL DIMENSIONS TO BACK OF CURB.

METRIC
 WHOLE NUMBERS INDICATE MILLIMETRES
 DECIMALIZED NUMBERS INDICATE METRES

	GAS		MANHOLE
	MTS / PEDESTAL		CATCH BASIN / CATCH PIT
	HYDRO / CABINET		CURB INLET WITH BOX
	CATV / FIBRE OPTIC		TREE
	TRAFFIC SIGNALS / PIT		TEST HOLE
	LAND DRAINAGE SEWER		PROPERTY LINE
	SANITARY/COMBINED SEWER		SURVEY BAR
	CB LEAD / SSP / DCP		FENCE
	WATER MAIN		BOC / EDGE OF PAVEMENT
	SUBDRAIN		ELEVATION (33.333)
	DITCH		TRAFFIC SIGN
	EXISTING		NEW

LOCATION APPROVED UNDERGROUND STRUCTURES

DATE: _____

NOTE:
 LOCATION OF UNDERGROUND STRUCTURES AS SHOWN ARE BASED ON THE BEST INFORMATION AVAILABLE BUT NO GUARANTEE IS GIVEN THAT ALL EXISTING UTILITIES ARE SHOWN OR THAT THE GIVEN LOCATIONS ARE EXACT. CONFIRMATION OF EXISTENCE AND EXACT LOCATION OF ALL SERVICES MUST BE OBTAINED FROM THE INDIVIDUAL UTILITIES BEFORE PROCEEDING WITH CONSTRUCTION.

BM 36-032	ELEV 234.325 m
No. REVISIONS	DATE
0	16/11/02 RPB
1	16/11/02 RPB

MORRISON HERSHFIELD

DESIGNED BY: WRJ
 CHECKED BY: RPB
 DRAWN BY: DID
 APPROVED BY: BWB
 RELEASED FOR CONSTRUCTION
 DATE: 16/11/02

PROFESSIONAL'S SEAL
 PROVINCE OF MANITOBA
 R.P. BRUCE
 REGISTERED PROFESSIONAL ENGINEER

THE CITY OF WINNIPEG
 PUBLIC WORKS DEPARTMENT
 ENGINEERING DIVISION

2016 REGIONAL STREET RENEWAL PROGRAM
ST. JAMES STREET
 RECONSTRUCTION
 PORTAGE AVENUE TO MAROONS ROAD
 HORIZONTAL AND VERTICAL ALIGNMENT
 STA 0+290 TO STA 0+410

CITY DRAWING NUMBER: P-3475-7
 SHEET: 7 OF 13
 DRAWING No.: _____ REV: _____

APECM
 Certificate of Authorization
 MORRISON HERSHFIELD
 No. 1736

BID OPPORTUNITY No. 19-2016